

Fitting instructions

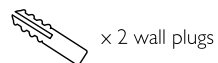
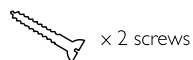

You will also need:

Drill with 5.5mm masonry drill bit
 Medium cross head screwdriver
 Tape measure
 Spirit level
 Pencil

Important information, please read carefully before you start:

- If in doubt about any of these instructions, consult a qualified trades person.
- Before starting, ensure that the wall is of a suitable strength and construction and that it is flat and even. You may need help to hold the item during marking and fixing. Ensure you will be able to remove your guide marks from the surface once the product is in position.
- The wall plugs supplied are suitable for solid stone or brick walls. For other wall types (eg plasterboard), use appropriate wall plugs.
- Before drilling, check for hidden pipes or power cables.
- Take care when using power tools, especially near water: The use of a residual current device is recommended. If in doubt refer to drill manufacturer's instructions.
- If drilling glazed tile surfaces, use a tile/ceramic drill bit for this purpose.
- **Handy tip** - using a piece of masking tape on the wall helps prevent the drill from slipping.
- Always wear suitable eye protection when drilling.
- After fixing, check the fitting at regular intervals to ensure that the screws have not become loose.
- Please retain this leaflet for future reference.

Warning:

Please take extra care when fitting that you position the product correctly before attaching it to the wall.

These products should always be fitted strictly in accordance with the fitting instructions. Robert Welch Designs Ltd cannot be held liable for damages if these instructions are not adhered to strictly.

Please contact Robert Welch Designs if you have any queries:

Lower High Street Chipping Campden Gloucestershire GL55 6DY UK.

+ 44 (0) 1386 840522

email: help@robertwelch.com

www.robertwelch.com

Care and maintenance:

- Clean the mirror only with a soft damp cloth.
- Do not use any abrasive cleaners or solvents when cleaning this product.
- Do not allow any liquids to stand on any part of the mirror.

NOTE. When handling glass mirror products:

- Do not place in a shower enclosure or above a bath.
- Do not place very hot or very cold items against or in close proximity to the glass mirror.
- Do not strike the glass mirror with hard or pointed objects.
- Do not attempt to cut the glass mirror.

Glass conforms to BS6206 Class B.

Products and trade marks of Robert Welch Designs Ltd are protected by patent, design and trade mark registrations. For full details, please visit www.robertwelch.com/iprights

Please read carefully:

- 1 Decide whether the mirror is to be hung portrait or landscape.
- 2 Measure the distance between the centre of the slots on the back of the mirror:

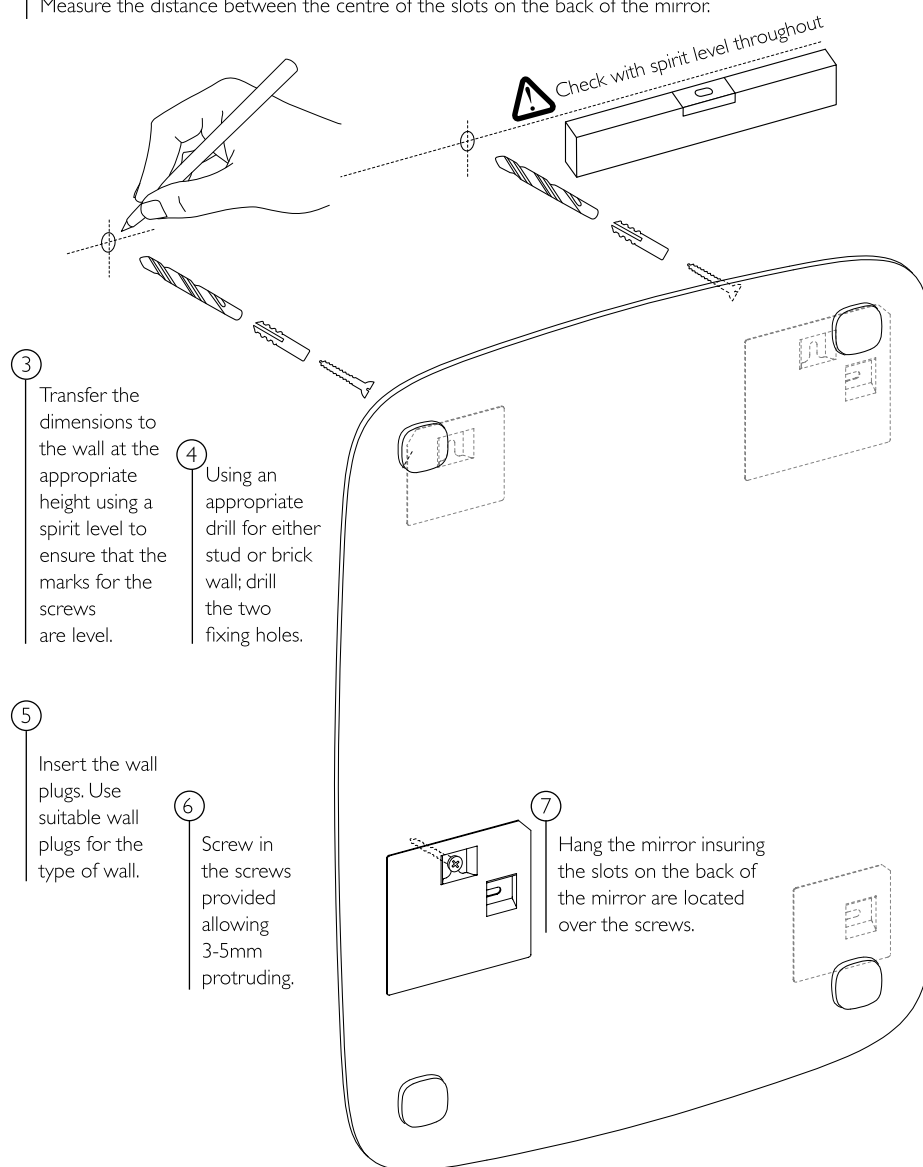

- 3 Transfer the dimensions to the wall at the appropriate height using a spirit level to ensure that the marks for the screws are level.

- 4 Using an appropriate drill for either stud or brick wall; drill the two fixing holes.

- 5 Insert the wall plugs. Use suitable wall plugs for the type of wall.

- 6 Screw in the screws provided allowing 3-5mm protruding.

- 7 Hang the mirror insuring the slots on the back of the mirror are located over the screws.