

# Rain Gutter for Rion Greenhouse U1(13) Assembly Instructions

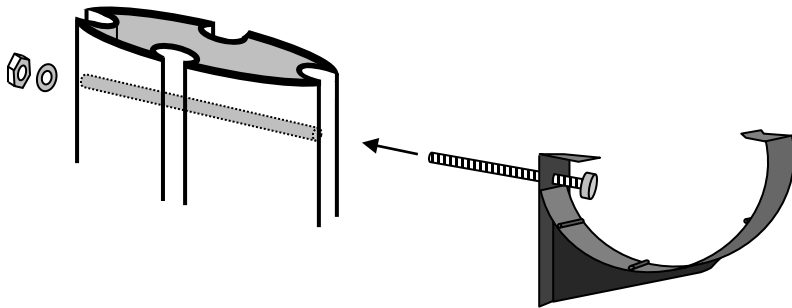

Remove both the inner and outer pins from the top holes in the E1Oval and R1 Round profiles that make up the walls of your greenhouse.

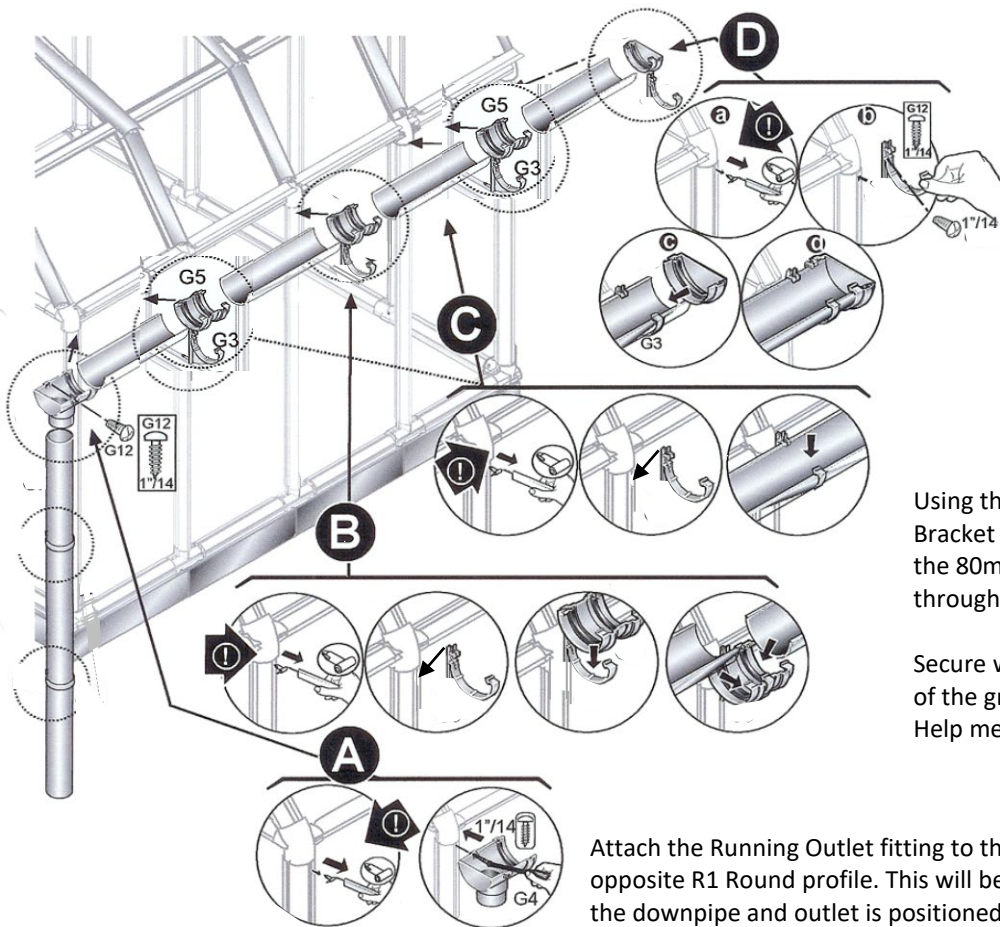

Attach a Fascia Bracket to the R1 Round profile, opposite to the end where the downpipe will be positioned, using a self tapping screw.

Using the now vacant holes, attach a Fascia Bracket to all the E1 Oval profiles by inserting the 80mm bolt into the bracket face and through the E1.

Secure with the washer and nut to the inside of the greenhouse.  
Help me be necessary at this point.

Attach the Running Outlet fitting to the opposite R1 Round profile. This will be where the downpipe and outlet is positioned.

Assemble your length of guttering using the appropriate lengths of gutter and Unions as shown in the table.

Carefully place the assembled length onto the Fascia Brackets and clip in position. Clip one end into the Running Outlet.

Attach the Stop End to the opposite end of the gutter.

The downpipe can be used as a straight outlet or can be cut to size to divert into a water butt using the bends provided.

Clip the two aluminium anchor points into the channel of the main corner frame directly under the Running Outlet. This is done by inserting the small fold into the channel and then with your thumb, pull the face of the clip fixing until it clicks and locks in position.

Wrap the downpipe clip around the down pipe and bolt in position

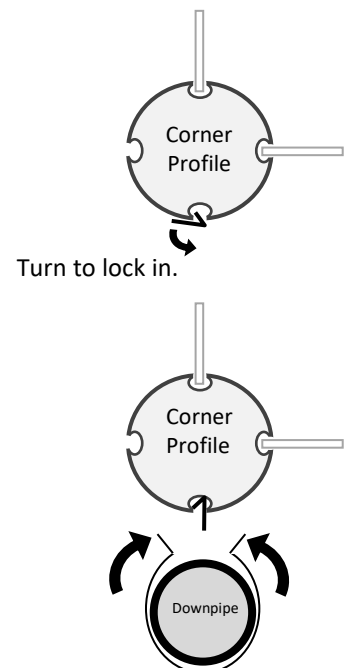

Turn to lock in.