

Vegetable Cages T15(01)
Model: 4' Wide x 4' High
Assembly Instructions

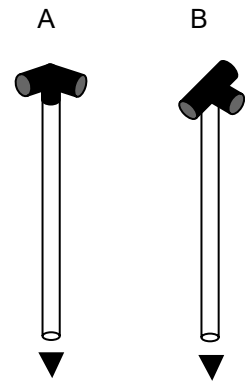

Components	Length					
	6'	12'	18'	24'	30'	36'
A Tube 54" Corner Leg	4	4	4	4	4	4
B Tube 54" Side Leg	-	2	4	6	8	10
C Tube 4' Horizontal	2	3	4	5	6	7
D Tube 6' Horizontal	2	4	6	8	10	12
3 Way Joint	4	4	4	4	4	4
4 Way Joint	-	2	4	6	8	10
Spike	4	6	8	10	12	14
Netting 1.4m Wide	8	14	20	26	32	38
Netting Ties	50	50	100	100	150	150
Ground Pegs	10	15	20	25	30	35

1. Please check the components.
2. Assemble the main framework as shown in the diagram. Use a rubber or wooden mallet to knock the tubes onto the joints until the tube is up against the shoulder of the joint.

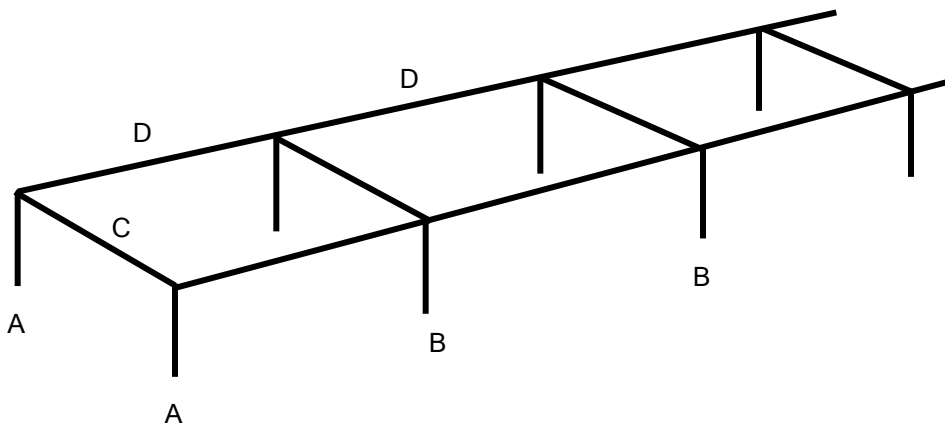

3. Push the verticals into the ground to a depth of approx' 6".
 4. Run the netting along the sides of the frame and secure using the ties which can fasten the net back onto itself or wrapped around the frame. Anchor down using the ground pegs.
 5. Lay the net along the top of the frame and secure it to the side net
- * To prevent snow damage during winter, remove the top netting or replace it with pigeon netting.**