

**GRIPPLE**  
**UNIVERSAL PLANT SUPPORT SYSTEM** P10 (14)  
*Installation and Suggested Uses*

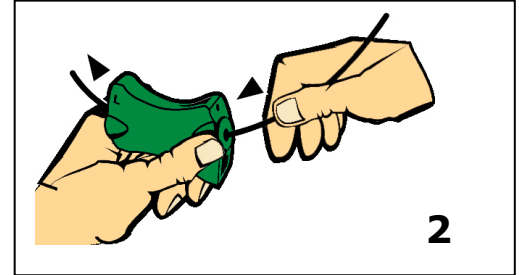

**Installation – a few simple steps**

1. Pull a short amount of wire out through the hole in the centre of the pack.
2. Thread the end of the wire through either of the central channels of the joiner.



3. Loop the wire around or through an anchor point.
4. Pass the wire back through the second channel of the Joiner. Dispense as much wire as required.

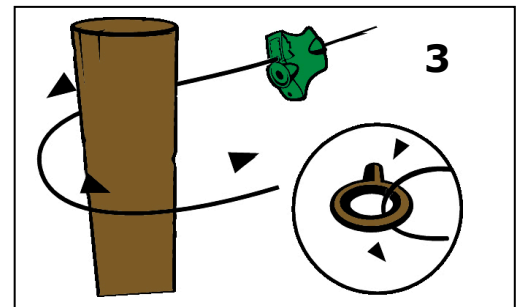

5. Cut off the required amount of wire.
6. Repeat steps 2, 3 and 4 to anchor and tension.

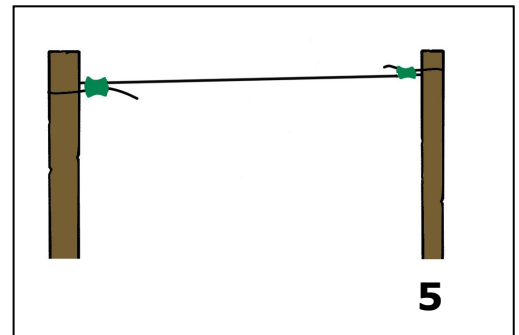

**Top Tips**

To tension further, pull more wire through the joiner.

'Zig-zag' the wire using vine eyes or similar points, and then anchor-off with the Joiner.

The plastic wire can be cut with secateurs (there is no metal core).

Always dispense the wire through the central hole of the pack.

Always leave a length of wire exposed to pull with.

DO NOT remove the plastic wire from the pack.

## Suggested Uses

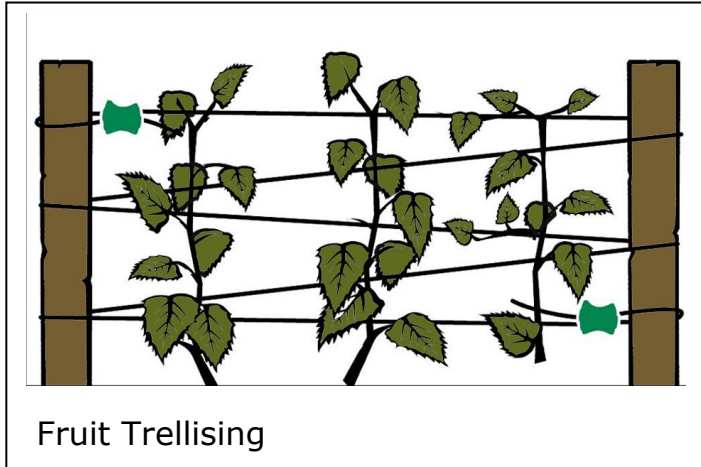

Fruit Trellising

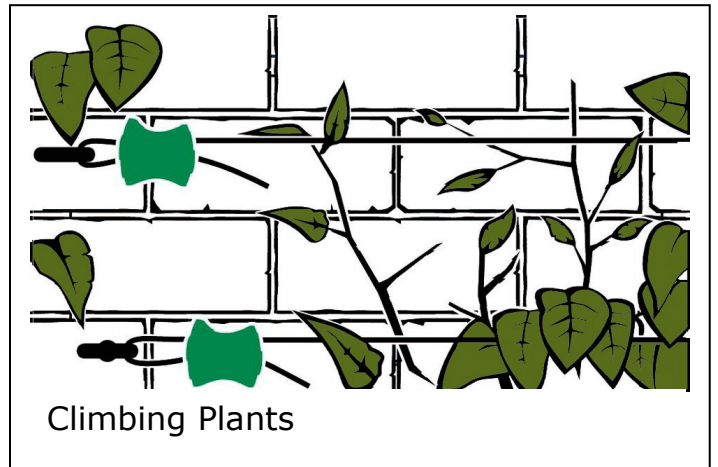

Climbing Plants

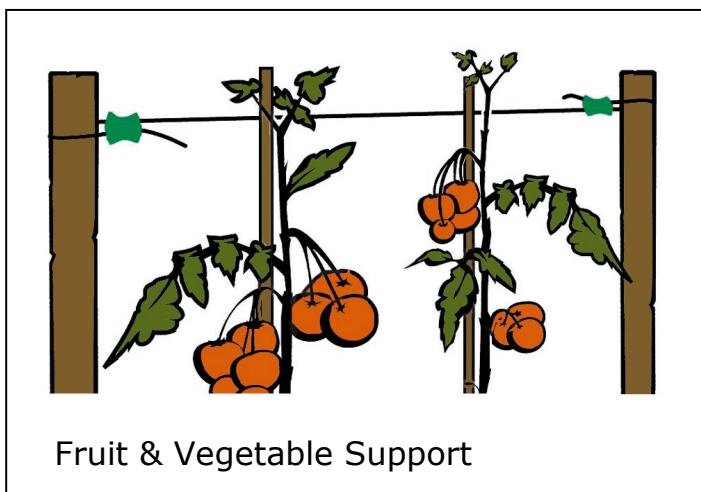

Fruit & Vegetable Support

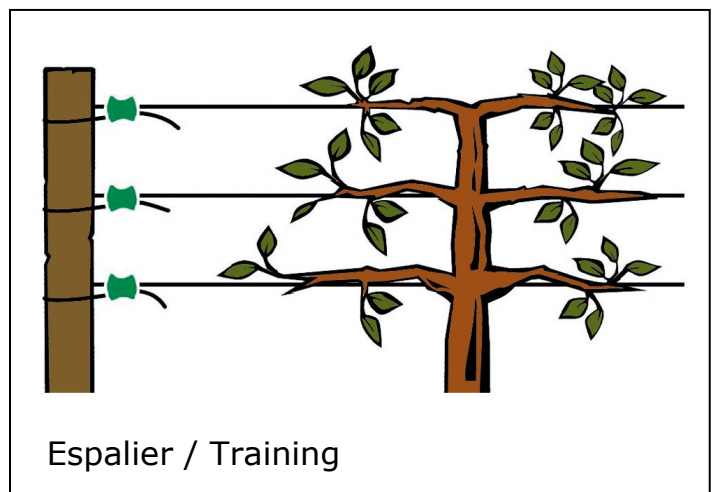

Espalier / Training

The Gripple Support System can be used on Clematis, Wisteria, Jasmine, Climbing Roses, Raspberries, Tomatoes and many, many more. It's ideal for espalier training too! And it can be used on walls, fences or posts.

When creating a trellis using the Gripple Wire it is important to have solid anchor points. On brickwork or rendered walls, we recommend the use of vine eyes.

For best results, drill and plug the hole first, then screw in the vine-eye. When creating a trellis on wooden fences or between posts vine-eyes can be screwed directly into the wood or, for an even more secure anchor point, take the wire around the post.

If you have concrete posts with wooden panels, you may be able to screw vine-eyes into the frame of the wooden panel.

Dependent on the weight of plant being supported, we recommend that the wire should be supported with a vine-eye, or something similar, every 10-12' (3-4 metres).