

HabiStat

TEMPERATURE THERMOSTAT + TIMER

FUNCTIONS & OPERATING INSTRUCTIONS

Digital On / Off Temperature Thermostat + Timer. Maximum load 600 watts. Comes with preset settings of 30°C for the day. All you need to do is set the clock to the correct time zone.

Plug your heater into socket marked I and your lights or spray system into socket II. Locate the probe in the position where temperature is to be measured. This unit can be used in HEAT mode to control a heater or COOL mode to control a fan. Press the SET button and hold for 3 seconds. This puts the unit into SET mode. "COOL" and "HEAT" will both flash and the icons will be displayed. ❄️ 🔥 Use the A V buttons to toggle between the 2, choose the mode you require and press SET to save and move onto the next setting. Full instructions overleaf. If no buttons are pressed for 15 seconds the unit will return to display mode. The unit has a battery backup to keep settings if power is switched off however the unit must be continuously left on for 48hrs when first used to charge the battery fully.

Heating / Cooling. Suitable for most heaters and fans. No minimum load is required but the maximum is 600 watts. Ensure adequate time is allowed from setting up to stabilise and maintain the set temperature. When heater / fan is being powered the HEAT 🔥 / COOL ❄️ will flash.

Time. Real time is continually displayed in top left corner of display.

Set temperature. Temperature range is between 0°C and 50°C. Please remember that the temperature can only be achieved if the heater is large enough and the temperature cannot drop any lower than the room ambient temperature regardless of what the settings on the thermostat are.

Difference Setting. This adjusts the on / off temperature cycle between 0.1°C and 5°C, this is the difference in temperature between the heater / fan being turned on and off. This setting will provide what is called hysteresis. This is needed with an on / off thermostat to stop the heater / fan perpetually switching on and off. For example if this is set at 1°C the thermostat will switch on or off 0.5°C above and 0.5°C below the set temperature. If this is set at 5°C the thermostat will switch on or off 2.5°C above and 2.5°C below the set temperature.

Over temperature alarm. This can be set to be activated between 0.1°C and 5°C over or under the set temperature. It will warn you with an audible sound and a flashing 🔥 and will display OVER TEMPERATURE ALARM.

It can be temporarily muted by pressing the set button once or can be turned permanently off by the following routine.

If A and V arrows are both held down together for more than 5 seconds, display will show AL. This is the alarm function and in ON mode will alert if the OVER TEMPERATURE ALARM is activated. If when in AL mode and A or V arrow is pressed display will show NO. If SET is pressed then this will disable the alarm function until turned back on by the above routine. This routine will stop audible alarm however the visible warning will remain.

Timer 1 . This controls the output on socket II. It can be used to turn a separate output in the form of fluorescent lighting, spray bar or separate light on and off in a 24 hour period. Most common use is to turn fluorescent lights on and off automatically.

Flashing 1 icon 💡 will indicate timer 1 period is active.

Upper and lower setting limit. Under normal circumstances the range of temperature the unit can be set at are between 0°C and 50°C. If a limit on the adjustment of the temperature range is required this can be changed as follows:

To set the upper limit that the units temperature can be set at press the A arrow for 5 seconds. Temperature setting on right hand side will flash. Use A V buttons to set maximum settable temperature and press SET.

To set the lower limit that the units temperature can be set at press the V arrow for 5 seconds. Temperature setting on right hand side will flash. Use A V buttons to set minimum settable temperature and press SET.

Remember that once set you will be unable to change the set temperature above or below these settings until the high / low limits are altered.

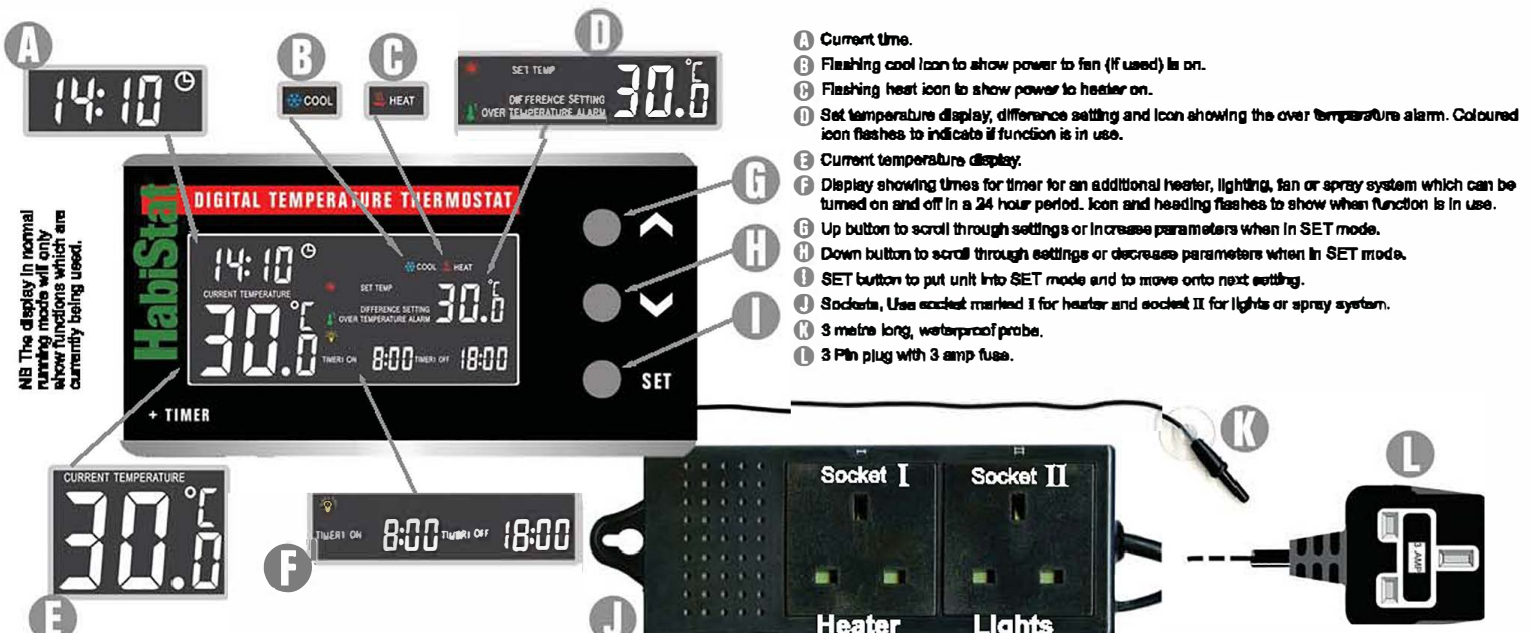

SETTINGS. Press the **SET** button and hold for 3 seconds. This puts the unit into SET mode. Use the **Λ V** buttons to change parameters (hold button down for rapid change) and then press **SET** to save and move onto the next setting. The order is shown below. Elements **highlighted** indicates flashing display.

COOL HEAT set the unit to either COOL mode to control a fan or HEAT mode to control a heater.



USE TO CHANGE
Λ V
SET

SET TEMP set the required temperature for use.



USE TO CHANGE
Λ V
SET

DIFFERENCE SETTING set the on / off cycle between 0.1 & 5°C the difference in temperature between the heater / fan being turned on or off.



USE TO CHANGE
Λ V
SET

OVER TEMPERATURE ALARM set the alarm between 0.1 & 5°C. Alarm will sound if temperature goes above or below this amount.



USE TO CHANGE
Λ V
SET

TIMER1 ON set the time when you would like No.1 timer to switch on. Set the hours then press SET and repeat to adjust minutes.



USE TO CHANGE
Λ V
SET

TIMER1 OFF set the time when you would like No.1 timer to switch off. Set the hours then press SET and repeat to adjust minutes.

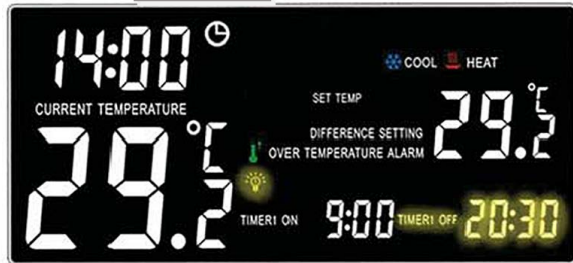

USE TO CHANGE
Λ V
SET

CLOCK Set the current time. Set the hours then press SET and repeat to adjust minutes.



USE TO CHANGE
Λ V
SET

If no buttons are pressed for 15 seconds the unit will return to display mode

Return to first setting..

Quick check of settings. Settings can be quickly checked without going into the setting routine. Simply scroll up or down with the **Λ V** arrows. Functions will scroll through and will flash indicating current settings of those functions flashing. You cannot alter these settings in this manner and the normal display will resume if untouched for 5 seconds.

Warnings. If 50°C is exceeded display will show HH.H If lower than 0°C display will show LL.L If probe becomes faulty ERR display will show. Avoid placing the control box or display in areas of high humidity or near water.

Guarantee

There are no user serviceable parts in this unit, so please do not open it. Any tampering, including cutting any wire, may render the guarantee void. This thermostat is guaranteed for one year from the date of purchase against faulty parts and workmanship. In the unlikely event of failure please contact orders@eurorep.co.uk t:020 8573 4311. A receipt or proof of purchase will be required. No liability is accepted other than for the repair or replacement of a faulty product. Statutory rights are not affected.