

OPERATING INSTRUCTIONS

Please read the operating instructions carefully before commissioning the machine and store them in a safe place for future reference.

FORSTHOFF FORPLAST-P2
Hot air welding machine

Application:

Manually guided hot air welding machine for overlapping and seam welding on tarpaulins, films, coated fabrics and sealing sheeting made of PVC-P, PE, ECB, CSPE, EPDM, PVDF, etc, as well as PE-coated woven fabrics for trucks, tents, awnings, advertising banners, boat tarpaulins, covers for swimming pools, biotopes and agriculture

Welding scene with: 20 mm, 30 mm, 40 mm or 45 mm

CAUTION

 **Danger of death** when opening the machine due to live components and connections being exposed. Remove the power plug from the socket before opening

 **Risk of fire and explosion** in the case of incorrect use of hot air devices, particularly near to flammable materials and explosive gases.

 **Risk of burns!** Do not touch heating element pipes and nozzles when hot. Allow the device to cool down. Do not point the stream of hot air at people or animals.

 Connect the device to a **socket with protective earth**. Disconnecting the protective earth within or outside of the device is dangerous!

Only use extension cables with protective earth!

CAUTION

 The nominal voltage stated on the device must match the mains voltage.

 A residual current circuit breaker is compulsory when using the device on building sites in order to protect others.

 The device must be operated under observation. Heat can make contact with flammable materials which are out of view.

 Protect the device against moisture and water

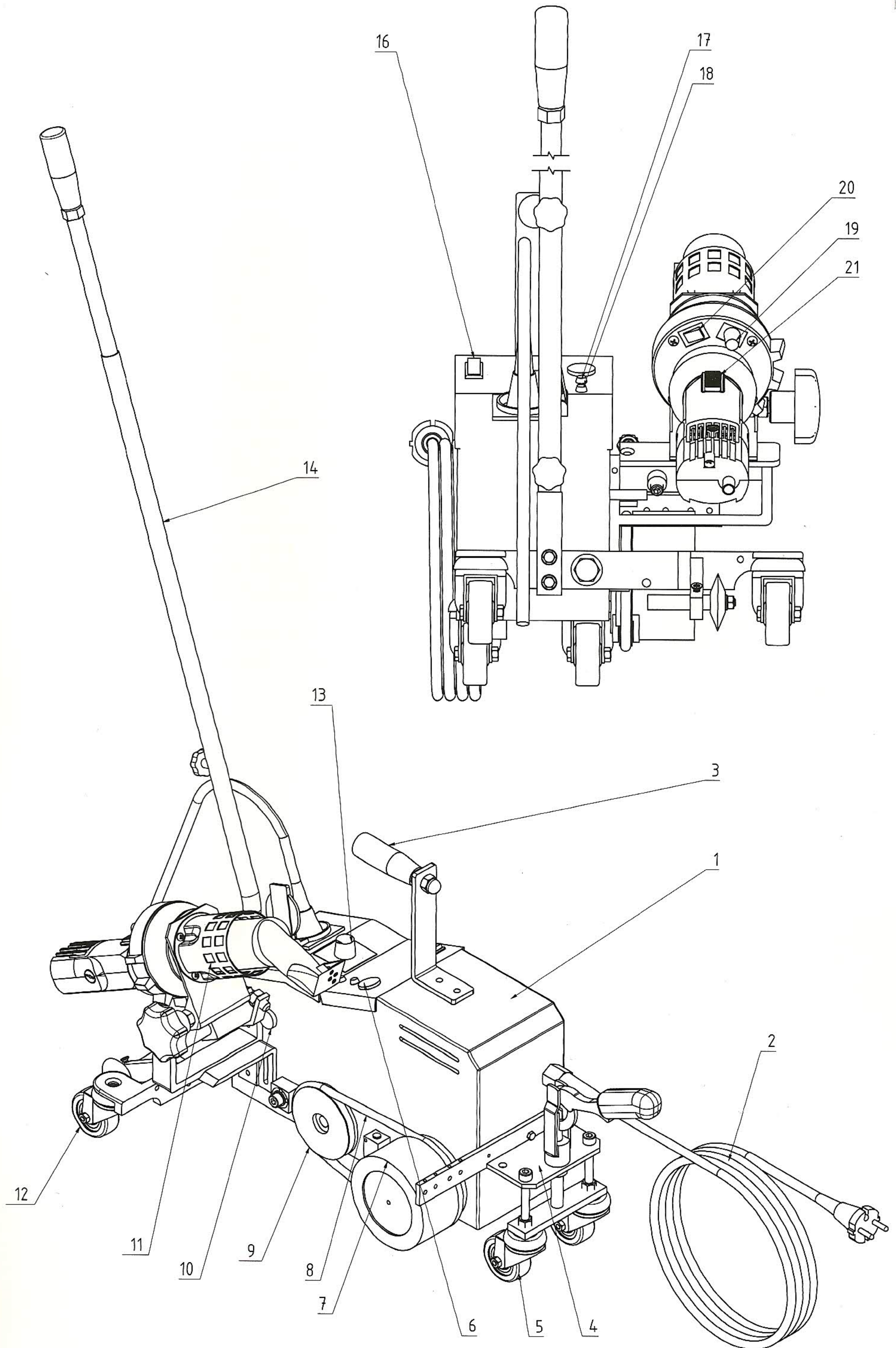

TECHNICAL DATA
MACHINE PROTECTION CLASS I

Voltage	V~	230
Frequency	Hz	50/50
Power	W	3400, 4000
Temperature °C		20-620 progressive
Drive m/min		1-18
Noise emissions level		<70dB
Weight kg		17,5 (with connection cable)
Mass mm		535 x 280 x 350 mm (without guide handle)

Device description
FORPLAST-P2

1. Housing
2. Mains connection cable
3. Carrying handle
4. Lifting facility for neutral gear
5. Guide roller of lifting facility
6. Permanent feed switch
7. Drive roll
8. Blank holders
9. Deflection roller
10. Startup switch
11. Welding nozzle
12. Guide arm with guide roller
13. Speed knob
14. Telescopic guide pole
15. Hot air fan
16. Main switch
17. Green indicator lamp (ready-to-use)
18. Red indicator lamp (error report)
19. Temperature knob
20. Heat stage switch
21. Hot air fan main switch

COMMISSIONING

FORSTHOFF FORPLAST-P2

Ready-to-use



- Before commissioning, check the mains connection cable (2) and plug for electrical and mechanical damages.
- Pull out the hot air fan (15) on the guide carriage with the star handle and tilted upwards as far as it will go
- Mount the telescopic guide pole and adjust it to the required height. The handle can be extended from 835 mm to 1085 mm.
- Connect the device to the mains. The mains voltages must match the device voltage. The indicator lamp (17) flashes green.
- Switch the device on with the main switch (16). The indicator lamp (17) flashes green to show that the device is ready for use. Also switch the hot air fan (15) on at the main switch (20).
- Set the potentiometer for the air temperature (19) to the required value.
- Set the potentiometer for the speed (13) to the required value.

Welding process

- Position the welding machine over the planned welding seam with the lifting facility (4). Using the switch for permanent feed (6), the device can be positioned with motor power in the direction of welding without pivoting the hot air fan.
- Pivot the hot air fan as far as possible into the welding seam using the star handle. The machine is automatically started using startup automation. During the welding process, the indicator lamp (17) permanently illuminates green.
- After welding, the hot air fan is withdrawn from the welding seam with the star handle and pivoted up as far as possible. The machine feed stops automatically.

- After the end of welding work, set the potentiometer for the air temperature to zero so that the hot air fan can cool down or switch the heat stage switch (20) of.
- Switch off the hot air fan on the main switch (21) to the 0 switch position.
- Switch off the welding machine on the main switch (16) to the 0 switch position and disconnect the device from the mains.

FORPLAST-P2 accessories

- Only FORSTHOFF accessories may be used
- Additional weight

Maintenance and repairs

- Clean the air outlet openings on the machine and air filter of the hot air fan with a brush if there is any soiling.
- When the minimum length of the carbon brushes is reached, the fan motor automatically switches off. The carbon service life is a minimum of 1500 hours. Only allow carbon brushes to be replaced by an authorised service point or specialist company.
- Clean welding nozzles (11) with a wire brush
- Check the mains connection cable (2) and plug for electrical and mechanical damages.
- Only allow repairs to the device to be performed by an authorised repair workshop.



Disposal

Do not dispose of the device in the household waste! Always recycle the device with separate collection of materials to protect the environment.

Assistance in case of problems

FORSTHOFF GmbH, Freiheitstr. 24,
D – 42719 Solingen GERMANY
Tel.: +49 (0) 212 336052
Fax: +49 (0) 212 336916
E-Mail: info@forsthoffwelding.com
Internet: www.forsthoffwelding.com

EC Declaration of Conformity

FORSTHOFF GmbH, Freiheitstr. 24,
D – 42719 Solingen
declares that the product
Type of device: hot air welding machine
Name: FORPLAST-P2

conforms to the regulations of the following
European directives:
EC directive 2006/95/EC - LVD
EC directive 2004/108/EC – EMC

The specified product's conformity with the
regulations of directive 2006/95/EC is proven by
compliance with the following norms:
EN 60335-1:2002 + A11:2004 + A1:2004 +
A12:2006 + Corrigendum: 2006 + A2:2006
EN 60335-2-45:2002

Last two figures of the year in which the CE
mark was applied: 10

The specified product's conformity with the
regulations of directive 2004/108/EC is proven
by compliance with the following norms:
EN 55014-1:12/2006
EN 55014-2:02/1997+A1:12/2001
EN61000-3-2:4/2006
EN61000-3-3:1/1995+A1:6/2001+A2:11/2005

This declaration certifies compliance with
the specified directives, but does not provide
assurance of the properties in the legal sense.
The safety information supplied with the product
documentation must be observed.

Solingen, 01.09.2010

Andrea Forsthoff-Neeff
General Manageress, Company Owner

Warranty

A one-year warranty is provided for this device
from the date of purchase (proof provided with
an invoice or delivery note). Any damages will
be addressed with a replacement delivery of
repair. Heating elements are excluded from this
guarantee.

Subject to the provision of legal regulations, all
other claims are excluded.

Damages caused by natural wearing tear,
overload or inappropriate use are excluded from
the warranty.

No claims can be made for devices that have
been converted or changed by the purchaser.

Technical changes are reserved.