



SUPERLIFT
SANITARY LIFTS

TILTERS

Stainless Steel Ground Level Mezzanine Column Lift

Features

- 304 Stainless steel
- Sanitary no weld platform
- Capacity up to 3,000 lbs
- Wash down motors
- No enclosed metal and no tube
- Front load and Side Loading available

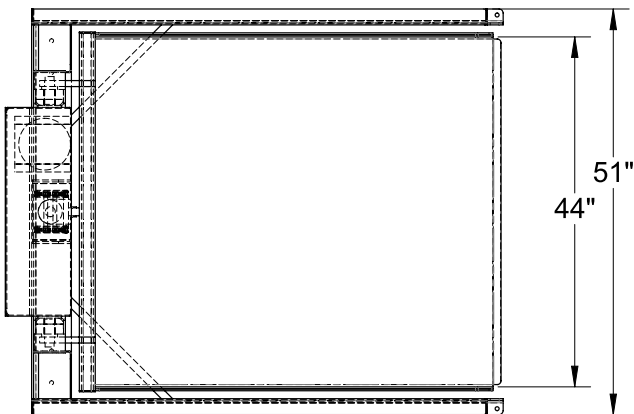

TOP VIEW

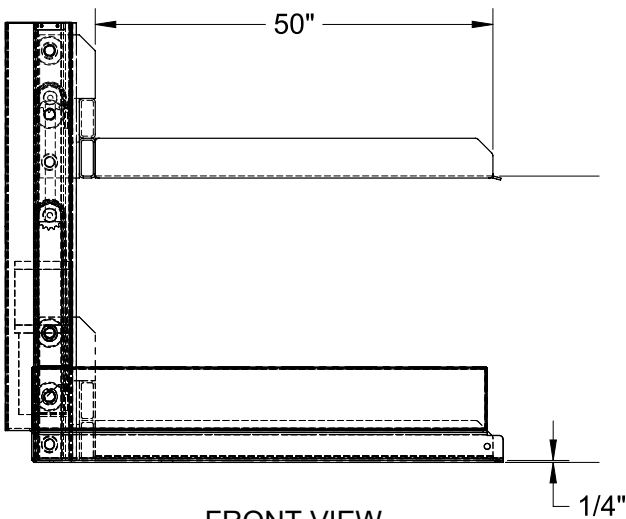

FRONT VIEW



Optional Features

- Stainless steel motor
- Electropolish
- Sloped stainless control panels
- 316L Stainless steel
- Stainless steel cylinders



* Lift height to 120"