

Step #1

Insert the treads into the slots in the left and right risers. Next, slip the aluminum trim onto the front of the treads. Secure the treads to the risers with the supplied #10 x 3/4" self tapping screws. Secure the aluminum trim to the treads with two #10 x 3/4" self tapping screws, one on each end of the underside of the aluminum trim (see Fig. 1).

Step #2

Attach 2 of the rear braces to the back of the step using the supplied 1/4 x 3/4" flat head screws, 1/4 flat washers and the 1/4 nylon locknuts (see Fig. 2). **Note: the side tabs on the rear brace go on the inside of the risers and the folded tab gets inserted in the back of the top tread.**

Step #3

Remove the 1/4 x 3/4" flat head screws, 1/4 washers and the 1/4 nylon locknuts from the rear brace on the ModStep 2. Next, attach the ModStep 4 assembly to the ModStep 2 using the (6) 1/4 x 3/4" flat head screws, (6) 1/4 washers and the (6) 1/4 nylon locknuts (see Fig. 3).

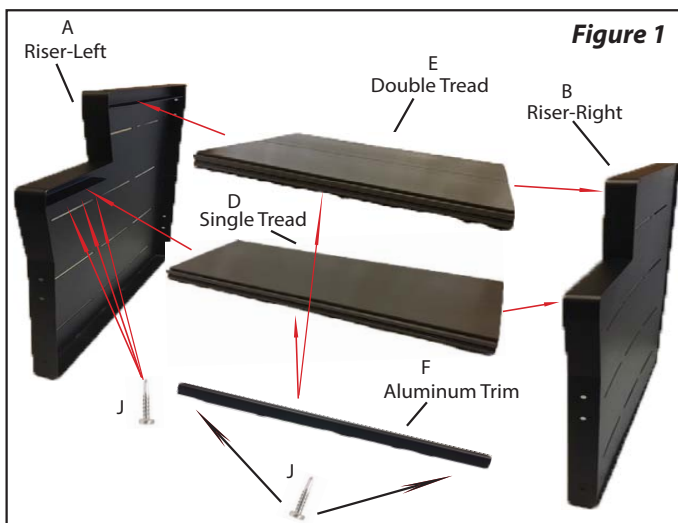

Figure 3

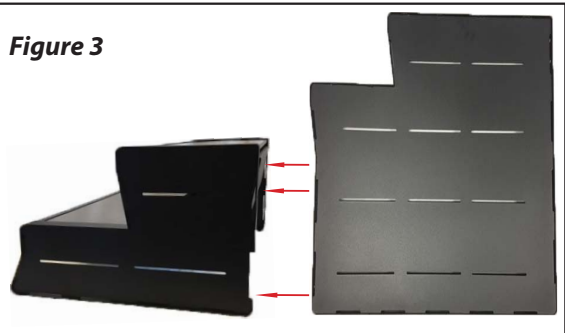
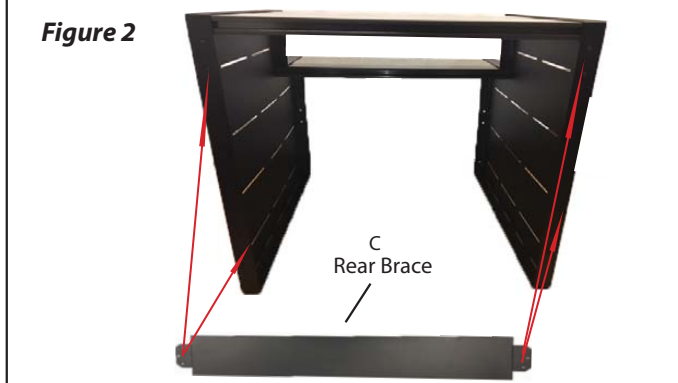

Figure 2



ITEM	PART#	DESCRIPTION	QTY
A	101476	MODSTEP 4 RISER - LEFT	1
B	101477	MODSTEP 4 RISER - RIGHT	1
C	101486	MODSTEP REAR CROSS BRACE	2
D	101492	MODSTEP TREAD	1
E	101516	MODSTEP DOUBLE TREAD	1
F	101493	MODSTEP TREAD TRIM	2
G	101495	1/4 x 1" FLAT HEAD MACHINE SCREW - STAINLESS STEEL	10
H	100608	1/4 FLAT WASHER	10
I	100607	1/4 NYLON LOCKNUT	10
J	101414	#10 X 3/4" SELF-TAPPING SCREW - STAINLESS	22

Step #1

Remove the 1/4 x 3/4" flat head machine screws, 1/4 flat washers and 1/4 nylon locknuts from the back of the ModStep 4 (see Fig. 1). Next, attach the rear rail brackets using the hardware removed and using the same holes (see Fig. 2).

Step #2

Using the supplied #10 x 5/8" self-tapping screws, finish attaching the rear rail brackets to the backside of the ModStep 4 (see Fig. 3).

Step #3

Insert the rail into the rear rail brackets and attach using the supplied 3/8 x 2-3/4" hex cap bolts, 3/8 flat washers and 3/8 nylon locknuts (see Fig. 3).

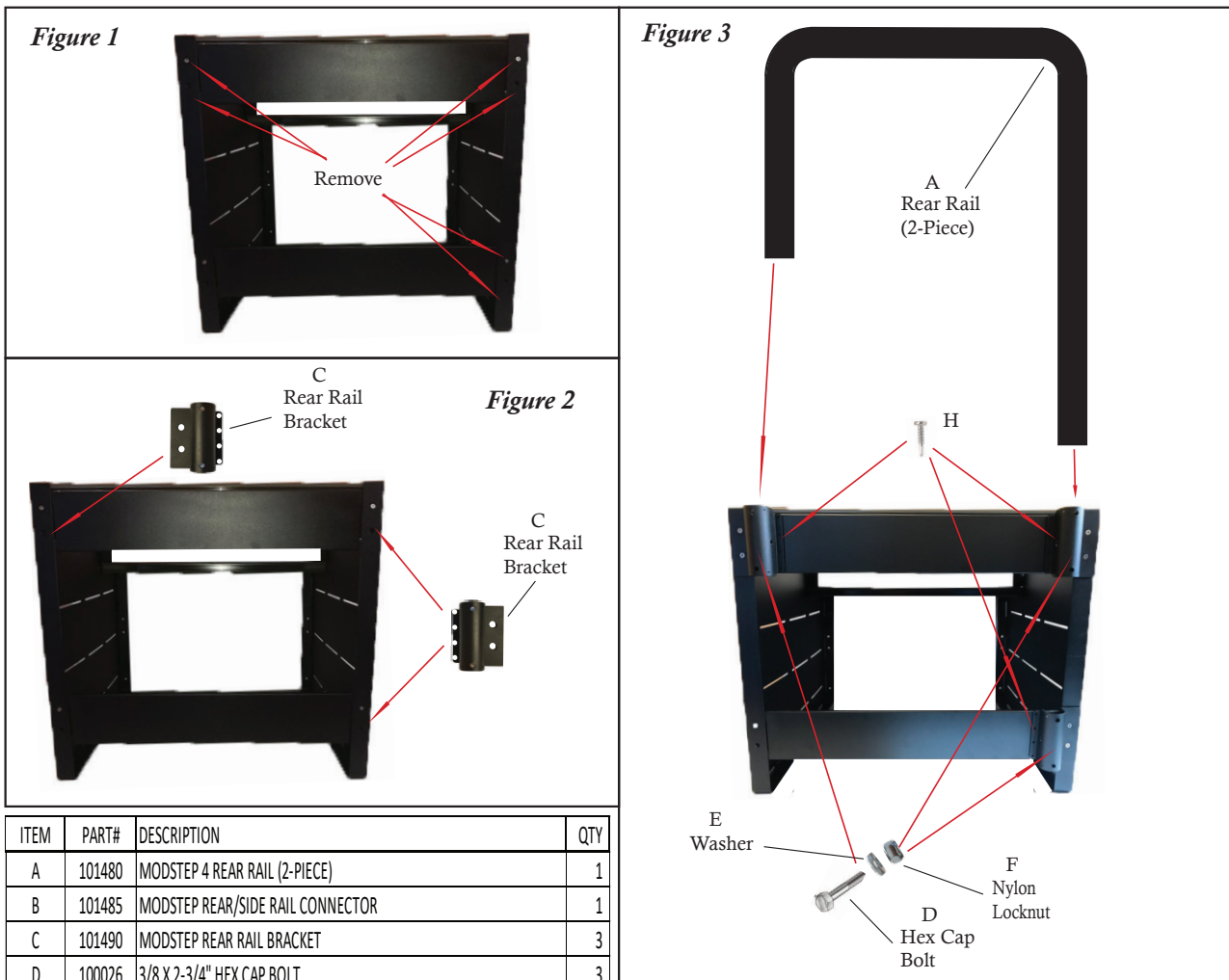

ITEM	PART#	DESCRIPTION	QTY
A	101480	MODSTEP 4 REAR RAIL (2-PIECE)	1
B	101485	MODSTEP REAR/SIDE RAIL CONNECTOR	1
C	101490	MODSTEP REAR RAIL BRACKET	3
D	100026	3/8 X 2-3/4" HEX CAP BOLT	3
E	100012	3/8 FLAT WASHER	3
F	100011	3/8 THIN NYLON LOCKNUT	3
G	100015	LARGE BLACK DOME CAP	6
H	100013	#10 X 5/8" SELF-TAPPING SCREW	24
I	100016	SMALL BLACK DOME CAPS	24

Step #1

Insert the front rail bracket into the side of the ModStep 2 riser and attach from underneath using the supplied 1/4 x 3/4" flat head machine screws, 1/4 flat washers and 1/4 nylon locknuts (see Fig. 1).

Step #2

Remove the 1/4 x 3/4" flat head machine screws, 1/4 flat washers and 1/4 nylon locknuts from one side of the back of the ModStep 4. Next, attach the side rail brackets using the hardware removed and using the same holes (see Fig. 2). Next, using the supplied #10 x 5/8" self tapping screws, finish attaching the front rail bracket and both side rail brackets to the side of the ModStep 4 (see Fig. 3).

Step #3

Insert the rail into the front rail bracket and both side rail brackets and attach using the supplied 3/8 x 2-3/4" hex cap bolts, 3/8 flat washers and 3/8 nylon locknuts (see Fig. 3).

Figure 1

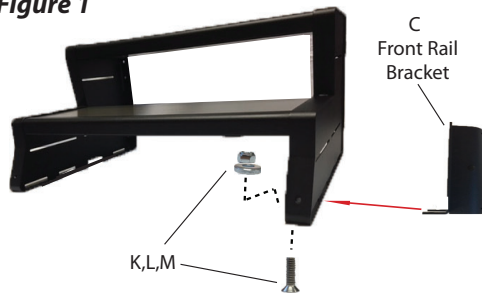

Figure 2

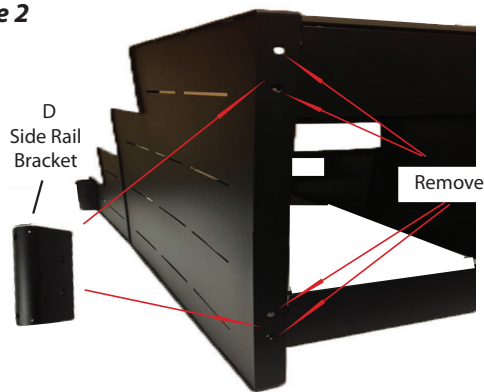
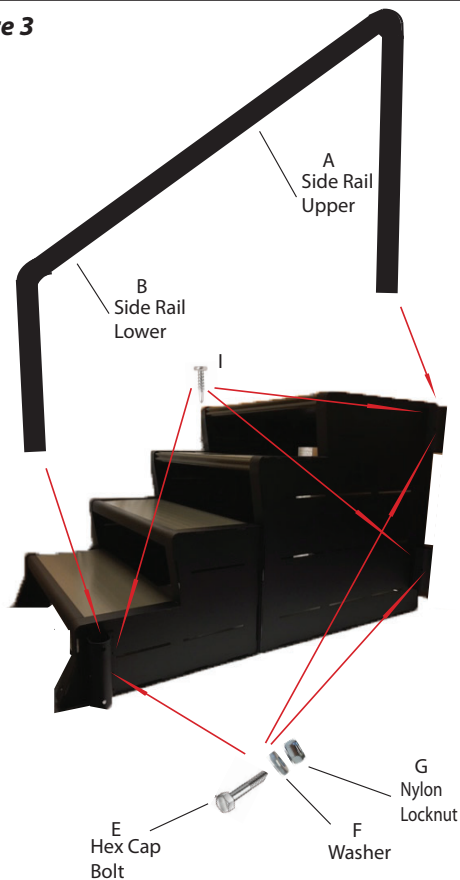

Figure 3



ITEM	PART#	DESCRIPTION	QTY
A	101483	MODSTEP 4 SIDE RAIL - UPPER	1
B	101484	MODSTEP 4 SIDE RAIL - LOWER	1
C	101489	MODSTEP FRONT RAIL BRACKET	1
D	101491	MODSTEP SIDE RAIL BRACKET	2
E	100026	3/8 X 2-3/4" HEX CAP BOLT	3
F	100012	3/8 FLAT WASHER	3
G	100011	3/8 THIN NYLON LOCKNUT	3
H	100015	LARGE BLACK DOME CAP	6
I	100013	#10 X 5/8" SELF TAPPING SCREW	28
J	100016	SMALL BLACK DOME CAPS	28
K	101396	1/4 X 3/4" FLAT HEAD MACHINE SCREW - STAINLESS	2
L	100608	1/4 FLAT WASHER	2
M	100607	1/4 NYLON LOCKNUT	2