



19" Industrial Wall mount cabinet

Assembled Wall mount cabinet

DB Wall mount series

19" SINGLE SECTION WALL MOUNT CABINET

19" Single Section Wall Mount Cabinet

Width: 19" 600mm

Heights: 4U-18U

Depth: 450mm & 600mm

With 1 fan

Feature:

Steel frame with assistant profile, unassembled structure with precise craftsmanship;

Single section, compatible with 19" standard equipments;

Tempered glass front door with over 180 turning degree;

Bolted side panel, easy to install and maintain;

Cable entry on the top cover and bottom panel with knock-out plate or cover plate.

L-shaped mounting profile, easy to adjustable on the mounting rail;

Fan cutout on the top cover, easy to install fan;

Installing back panel, easy to fix on the wall;

Flat packing, save the shipping space, easy to transport;;

Standard:

Comply with ANS/EIA RS-310-D, IEC297-2, DIN4197

PAET1, DIN41494 Part 7, GB/T3047.2-92 Standard;

Material:

SPCC quality cold rolled steel

Thickness: Mounting profile: 1.2mm; other: 1.0mm;

Loading Capacity:

Static loading: 60kg

Degree of protection:

IP20

Surface finish:

Degreasing, Pickling, Phosphating, Powder Coated

Package: fully assembled or Flat packing for choice



Main Structure

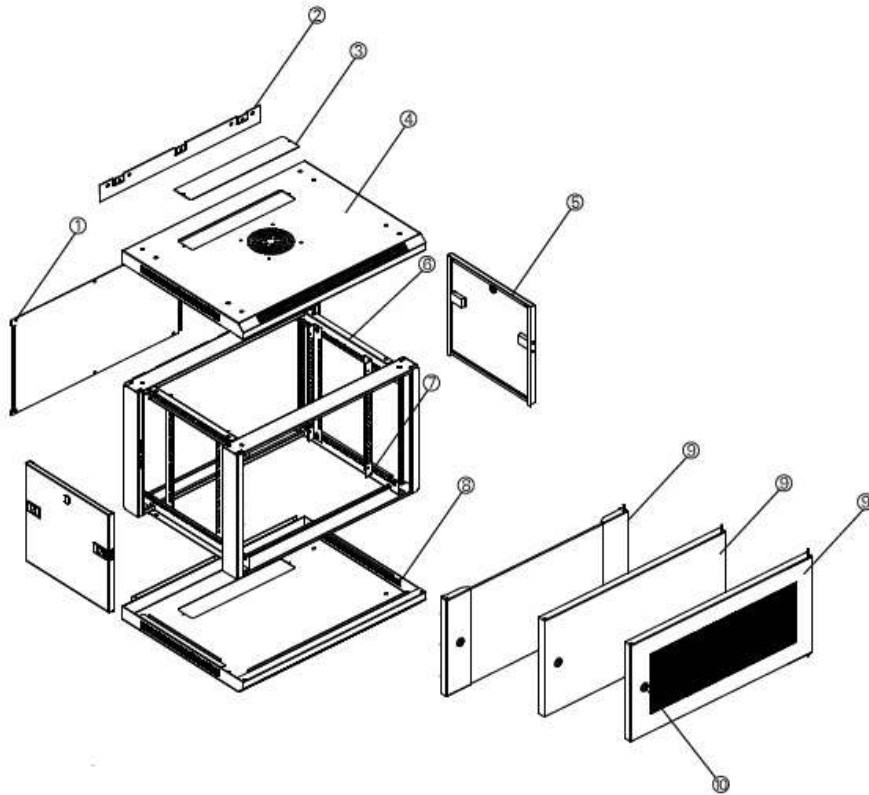

- 1.Back plate
- 2.Wall mount bracket
- 3.Cover plate
- 4.Top
- 5.Side panel
- 6.Frame
- 7.Mouting profile
- 8.Bttom
- 9.Different front clour
- 10.Lock

19" wall mount cabinet explosion drawing – 1 fan hole or 2 fan hole

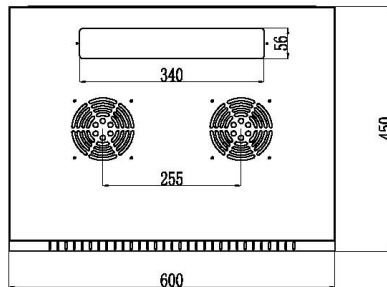
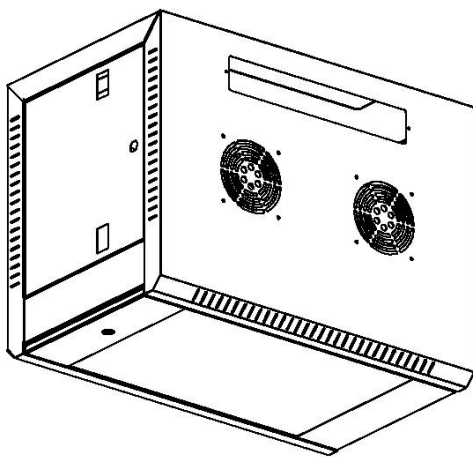

TOP

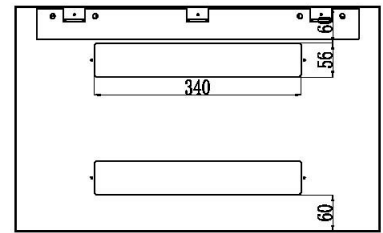

BACK

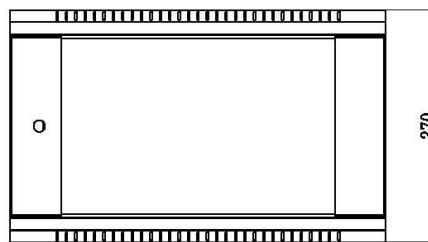
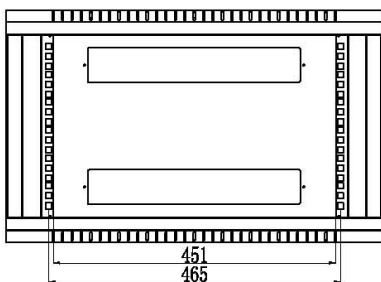

FRONT

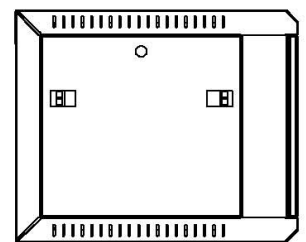

SIDE

Dimension (Unit : mm)

Item number	Capacity(U)	Width(W) (mm)	Depth(D) (mm)	Height (H) (mm)	Packing size (W*D*H)
MS-EWM6404	4	600	450	281.0	640*490*320
MS-EWM6406	6			370.0	640*490*410
MS-EWM6409	9			503.3	640*490*540
MS-EWM6412	12			636.7	640*490*670
MS-EWM0415	15			770.0	640*490*810



Dimension (Unit : mm)

Item number	Capacity(U)	Width(W) (mm)	Depth(D) (mm)	Height (H) (mm)	Packing size (W*D*H)
MS-EWM6606	6	600	600	370.0	640*640*410
MS-EWM6609	9			503.3	640*640*540
MS-EWM6612	12			636.7	640*640*670
MS-EWM6615	15			770.0	640*640*810
MS-EWM6618	18			903.4	640*640*940

Package –by flat packing (disasesmbled type)



Color of cabinet body:

Color Standard	Normal Color		
Standard	 Ral 9004	 Ral 7035	Other color

Optional Accessories:

- Fixed shelf;
- Various of front door;
- Ornament strip for the glass side;
- Brush for cable entry
- Smoked Color glass;Cantilever;
- L-rail

Fix shelf

PDU

Brush panel

L -rail

round rock for side door

