

Instructions for Assembly – ULTRA PURE

- Unpack the box
- DO NOT MIX the blades with Blades of OTHER fans.

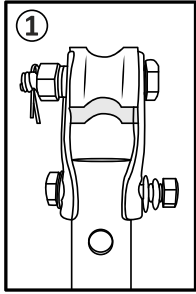

1. - Take the fan motor and insert the DOWN-ROD in the
- Ceiling clamp assembly.
 - Tighten the Bolts as shown in the picture.

Sequence

1. Washer
2. Spring washer
3. Nut
Tighten Nut Fully
4. Insert LOCK PIN.

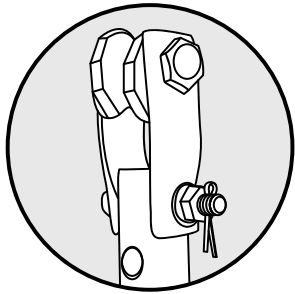

IMPORTANT : Must check LOCK PIN is inserted and SPREAD OPEN with PLIERS. This will ensure that the fan does not Fall in any case of Loosening of Fasteners.

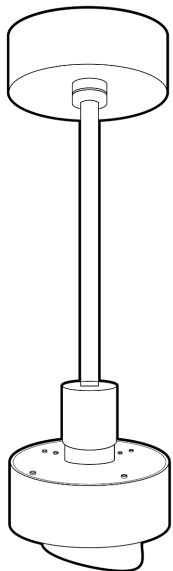

- 2 Hang the fan on the Ceiling.

TURN OFF the Fan Mains before proceeding ahead

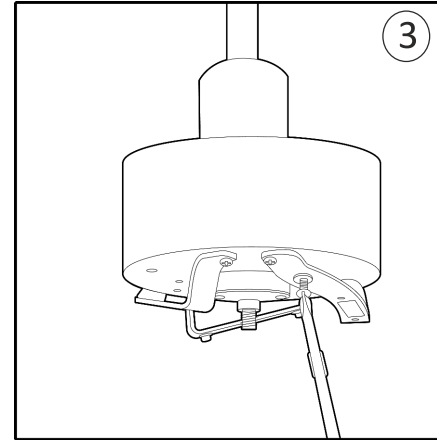

Open Screws from Blade Holders.

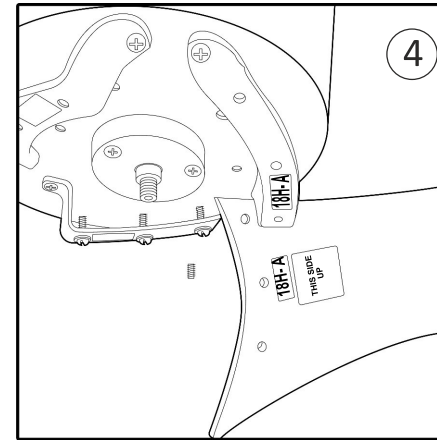

Match BLADE Code with MOTOR code. (for Wood Blades)

BLADES are Balanced in SETS.

BLADES are NUMBERED (18H-A or B or C)

18H denotes Motor Number
A or B or C denotes BLADE LOCATION

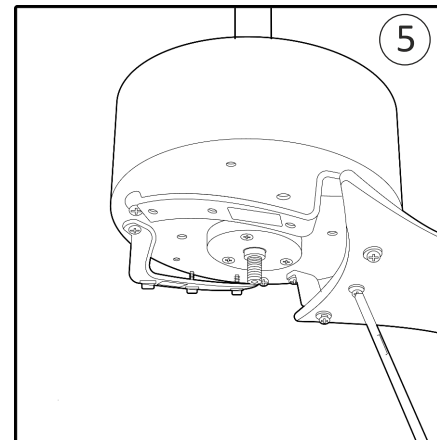

DO NOT MIX BLADES with OTHER MOTOR BLADES.

ENSURE the screws are full tight.

Keep “THIS SIDE UP” sticker facing the Ceiling

Repeat for all 3 Blades.

IMPORTANT
PLEASE FOLLOW STICKER ON BLADE

EN: Push blades in this direction and tighten screws.

FR: Poussez la lame dans cette direction et serrez la vis

IND: इस तरफ ब्लेड को धक्का दें और पेच कस दें

Instructions for Assembly – ULTRA PURE (PAGE 2)

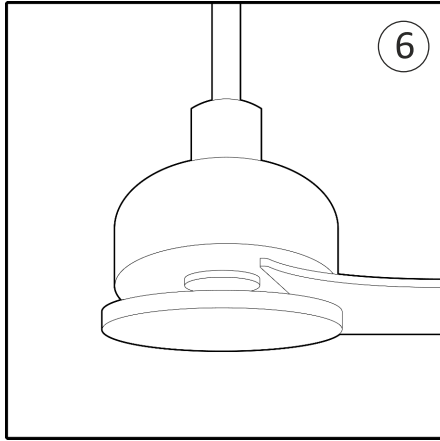

RE-CHECK all Canopy Screws and tighten them.

They may have loosened in transit.

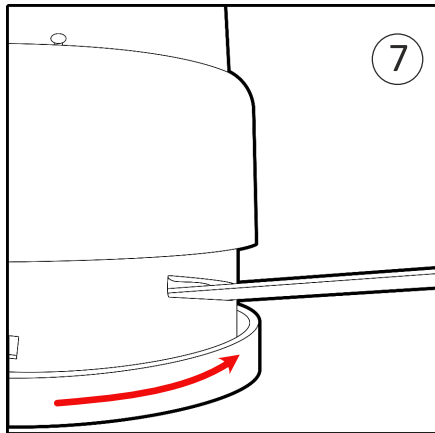

Screw the BOTTOM Plate on the fan.

Turn the plate by HAND and ENSURE the PLATE is full tight.

FOR FANS with REMOTE CONTROL

Fans Come pre-installed with Remote Receiver inside the Canopy

A. I.R Sensor (please do not cover/remove)

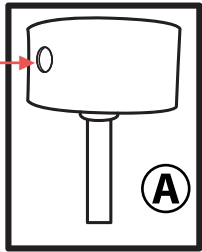

CONNECT

BROWN Main (Live) to Brown
BLUE Mains (neutral) to Blue
Earth Mains to Yellow/Green

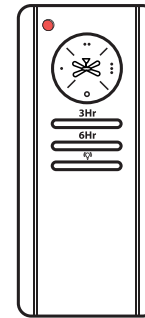
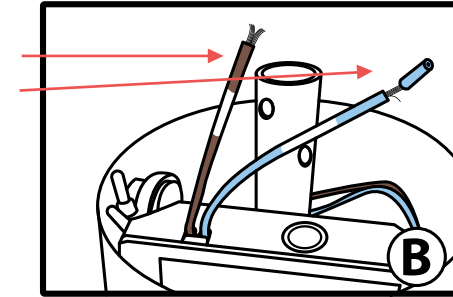

Supplied REMOTE Controller
2 x AAA Batteries required (not supplied)