

XG



START

- Turn on at wall.
- Ensure the Filter (1) is pressed down and clipped firmly in place.
- Check the Upstand (2) is in place and shut the door.
- Press the Power button which glows red. The machine will begin to fill automatically.

OPERATION

- Load rack into machine and shut door.
- Press Start button.
- The Start button will glow green until the cycle is complete.

NOTE: The machine may be started while the rinse water is being heated. It will continue to run the wash until the rinse is up to temperature.

SHUT DOWN - EVERY NIGHT

- Open the door and remove only the Upstand (2) only.
- Press Drain button. Allow to drain for approximately 1 minute or until the tank is empty.
- If you want to flush the inside of the machine, close the door for 10 seconds before reopening.
- Turn the Drain and then the Power buttons off.
- Clean the tank then remove and rinse Filter (1) before replacing back in machine with Upstand (2).
- Ensure Filter (2) is pressed firmly down and has clicked into place.

CLEANING - AT LEAST ONCE A WEEK

Remove, rinse and replace:

Filter	1
Upstand	2
Wash/Rinse Arm	3

Inspect and clear all jets in the Wash/Rinse Arm and the Top Rinse Jet using a small object such as a toothpick where necessary to remove any blockages prior to rinsing.

NOTE: The Filter (1) is to be removed up lifting directly upwards and clipped back into place by pressing down. Take care not to unscrew the Wash/Drain Sump (4) by turning this or the Filter.

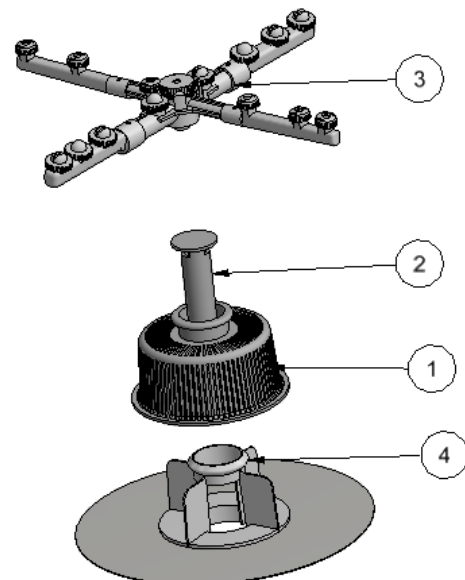

SUGGESTED BEST PRACTICE

- | | |
|--------------|--|
| Pre-rinse | Rinse residue from glasses in cool water. |
| Chemical | Use good quality non foaming commercial detergent and drying agent – do not use domestic detergent which will cause the machine to foam. |
| Wash results | If wash results are deteriorating, check that you have haven't run out of detergent and that the wash/rinse arms are clean and free of obstructions. |
| Draining | Use the Drain button to lower the water level before removing the Upstand. |



XG OPERATOR TROUBLESHOOTING



WARNING: Commercial Dishwashers use electricity, powerful chemicals, and high temperatures. Refer Operating and Service Manuals.

ISSUE	POSSIBLE CAUSE											
	POOR PRE-SCRAPING	OVERLOADING RACKS	CARRY OVER OF SOAP FROM SINK	POOR MACHINE CLEANING PROCEDURE	JETS BLOCKED OR ARMS OBSTRUCTED	ISSUE WITH THE DETERGENT TUBE*	DETERGENT DOSAGE LOW OR HIGH*	RINSE FLUID DOSAGE LOW OR HIGH*	WATER SUPPLY PRESSURE LOW	RINSE TEMPERATURE LOW <75 °C	DRAIN UPSTAND NOT PLUGGED IN	POOR WATER QUALITY**
POOR WASH RESULTS AND/OR DIRTY MACHINE	•	•		•	•	•	•		•			•
MACHINE FOAMING			•	•			•	•	•	•		
NO FIZZ, GREASY FILM ON GLASSES, HIGH RINSE FLUID CONSUMPTION				•	•		•	•		•		
DETERGENT RESIDUE ON WARES, HIGH DETERGENT CONSUMPTION				•			•		•		•	
SCALE BUILD UP AND/OR FILTERS ALREADY FITTED TO OTHER EQUIPMENT												•

* Correct use of the appropriate chemicals is critical for machine performance. For issues most likely due to incorrect chemical dosages or other chemical issues, we recommend you consult your chemical supplier and/or a local chemical expert prior to calling in a dishwasher technician as these are unlikely to be covered under the machine warranty.

** Good water quality (refer spec sheet, manual or Washtech website for requirements) is essential for good machine performance and optimal equipment life. It also reduces maintenance requirements and chemicals costs. For issues that are likely due to poor water quality (scale building up, filters being required on other kitchen equipment, etc.), we recommend you consult a local water specialist prior to calling in a dishwasher technician as water quality related issues are not covered under warranty.

IF PROBLEMS PERSIST CONTACT MOFFAT SERVICE ON 1300 264 217