

GE



START

- Turn on at wall
- Press the Power button which will glow red and the rinse water will begin to heat
- Machine will be ready to run once Rinse Ready Light glows yellow
- If required, switch cold rinse on. Switch will glow

NOTE: In cold rinse mode, cycles will end with a cooling spray

OPERATION

- Load rack into machine and shut door
- Press Start button, the Start button glows green while machine is operating
- When Start button light goes out, the cycle is complete

SHUT DOWN - EVERY NIGHT

- Turn machine and wall power switches off
- Clean the tank

CLEANING – AT LEAST ONCE A WEEK

Remove the Wash/Rinse Arm

Inspect and clear all jets in the Wash/Rinse arm and the Top Rinse Jet using a small object such as a toothpick where necessary to remove any blockages prior to rinsing

Replace the Wash/Rinse Arm

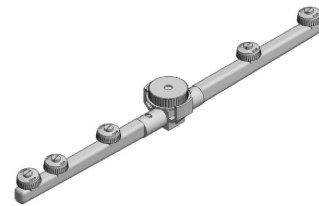

SUGGESTED BEST PRACTICE

Pre-rinse	Rinse residue from glasses in cool water
Chemical	Use good quality non foaming commercial detergent and drying agent – do not use domestic detergent which will cause the machine to foam
Wash results	If wash results are deteriorating, check that you have haven't run out of detergent and that the wash/rinse arms are clean and free of obstructions