

PW1C

Front Loading Warewasher c/w Heat Recovery Unit

W 680mm x D 780mm x H 2065mm

Washtech warewashers are built to improve the efficiency of operations washing oversized and/or heavily soiled items, from bakeries to production kitchens, supermarkets to hospitals.

The PW1C is a powerful, highly durable, simple-to-use and easy-to-maintain front load warewasher. It features Washtech Hybrid Controls which combine IP65 stainless switches, tried-and-tested switchgear, with a customisable electronic timer. Built with a large wash chamber and carefully counterbalanced split door, it is ideal for washing baking and GN trays, bins, bowls and other oversized items.

The PW1C also features a highly efficient integrated heat recovery unit which ensures minimal steam emissions and reduced energy consumption.

Since 1981 Washtech dishwashers have been constructed from heavy duty stainless steel, and are engineered specifically for the unique local conditions and regulations. Backed by the most extensive service network and spare parts inventory in the region, your Washtech PW1C will not let you down.

Special Features:

- Suitable for installation without an extraction canopy in many situations*
- Integrated heat recovery unit which preheats the cold water supply, significantly reducing steam emissions, energy consumption and water treatment cost
- Internal upper rail with optional and adjustable tines suited for hanging ladles, whisks and/or washing up to 10 baking or GN trays (up to 40mm deep) per cycle

Standard Features:

- Versatile 2.5, 4.5 and 6.5 minute wash cycles
- Large internal wash chamber with useable area of W 565mm x D 600mm x H 750mm
- Low cold water consumption of 2.6 litres per cycle
- Washtech Hybrid Controls
- Easy Installation supplied with:
 - Water supply hose
 - Detergent and rinse aid pumps with injector lines
 - No commissioning required
- High powered wash system
- Suitable for connection to low inlet water temperature and/or pressure (break tank and rinse pump fitted)
- Heavy-duty stainless steel construction and wash manifold
- Robust stainless steel wash and rinse arms with precision stainless steel jets
- Double heavy duty stainless steel filtration system including dual scrap trays and separate wash inlet filter
- Wash chamber easily accessible via insulated counter-sprung split door
- Watermark approved backflow prevention
- Comprehensive Moffat 5-2-1 warranty

Includes:

- 1 x 500mm x 600mm dish rack (600 70042)
- 1 x 500mm x 600mm cup rack (600 70043)
- 1 x cutlery basket (C660508)
- 1 x 435mm cup cover (k0452)
- 1 x Upper hanging rail with adjustable tines (824 10228)



* Full certificate and conditions from SEED available on request

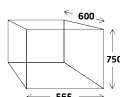

PW1C

Front Loading Warewasher c/w Heat Recovery Unit
W 680mm x D 780mm x H 2065mm

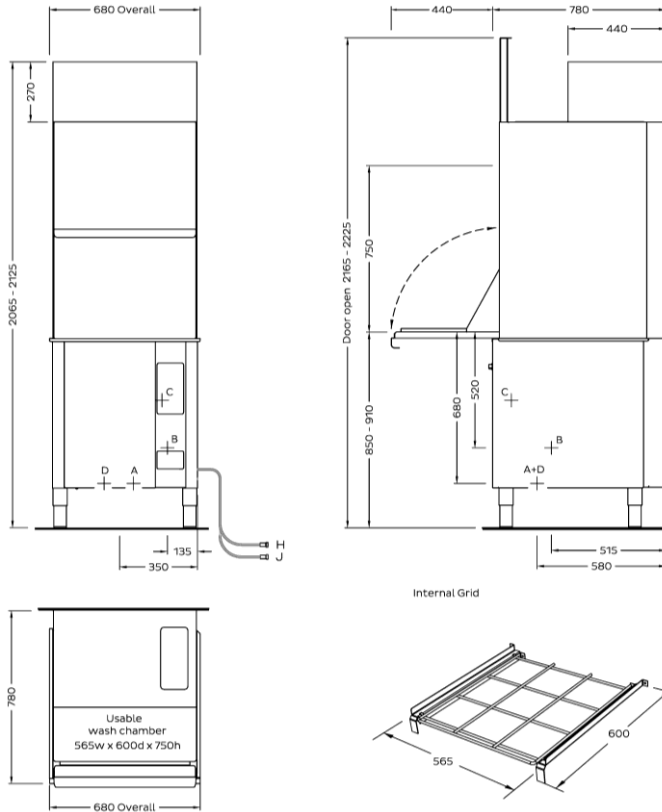

Australia
Moffat Pty Limited

Victoria/Tasmania
740 Springvale Road
Mulgrave, Victoria 3170
Telephone 03-9518 3888
Facsimile 03-9158 3833
vsales@moffat.com.au

New South Wales
Telephone 02-8833 4111
nswsales@moffat.com.au

South Australia
Telephone 03-9518 3888
vsales@moffat.com.au

Queensland
Telephone 07-3630 8600
qldsales@moffat.com.au

Western Australia
Telephone 08-9202 6820
wasales@moffat.com.au



ISO9001
All Washtech products are designed and manufactured by Washtech using the internationally recognised ISO9001 quality management system, covering design, manufacture and final inspection, ensuring consistent high quality at all times.

In line with policy to continually develop and improve its products, Washtech reserves the right to change specifications and design without notice.



© Copyright Moffat Ltd
Version: 1904

D Cold water	Temperature	<25°C			
	Connection	3/4" male; hose supplied			
	Pressure	200-350kPa			
	Flow	10 litres per min			
	Quality	Potable - refer table			
	Backflow Prevention	Atmospheric Vacuum Breaker			
	Consumption	2.6 litres per cycle			
A Hot water (fill only)	Temperature	65°C			
	Connection	3/4" male; hose supplied			
	Pressure	200-350kPa			
	Flow	20 litres per min			
	Quality	Potable - refer table			
	Backflow Prevention	Atmospheric Vacuum Breaker			
B Waste	Connection	1.5" BSP male			
	Line	2.0" / 50mm minimum			
C Electrical	V	Hz	A/phase	max Kw	
	3P + N + E	415	50	25	18.00
	Option:				
	* 3P + N + E	415	50	15	10.50

Dimensions	Machine	Packed
Width	680	770
Depth	780	870
Height	2065	2090
Weight	186	209
Cubicmetres		1.40

Water Quality	Min	Max
pH	7	8
Hardness ppm	20	100
CL-		100
SO ₄		400
Fe		0.1
Mn		0.5
Cu		0.05
CL ₂		0.1

Refer operator manual for installation instructions. Isolating switch must be within 1m of, and not directly behind the machine.
* Connection on lower power rating will reduce the wash and rinse heating, and delay the operation of the machine.

an Ali Group Company



The Spirit of Excellence