



**DUAL HEAD  
WEED BURNER**

**INSTRUCTION MANUAL**

---



# #YSN1000K

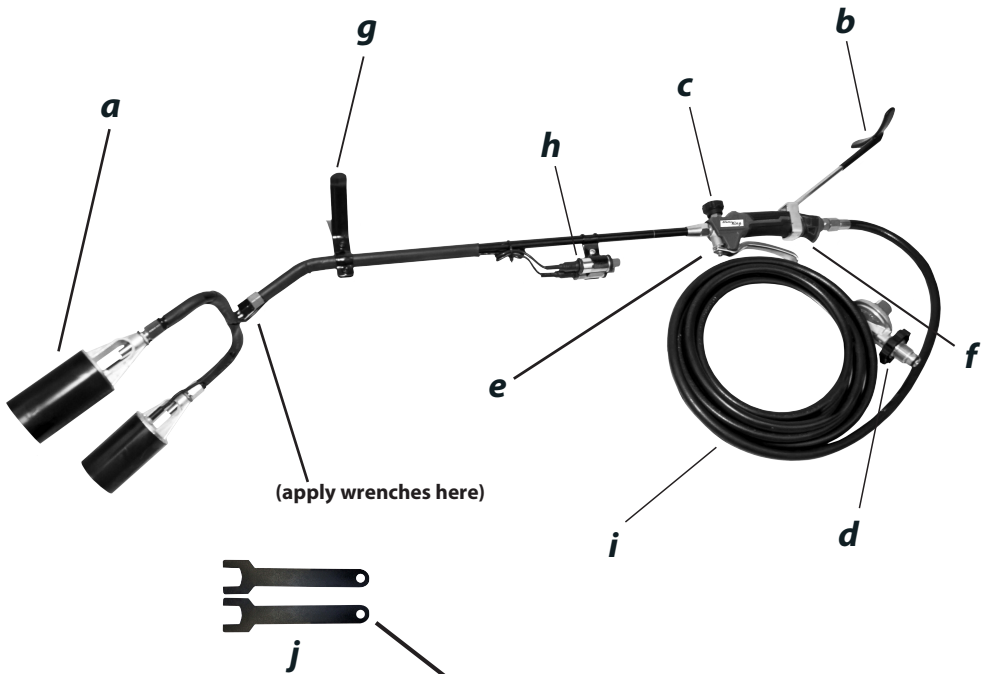

## TORCH COMPONENTS

- a. Dual Large, wide nozzles
- b. Arm support
- c. Flame control knob
- d. Handwheel tightener
- e. Idle/boost control lever
- f. Grip handle
- g. Nozzle cooling stand
- h. Dual Switch Piezo-powered ignitors
- i. 16-ft hose
- j. Assembly wrenches (included)

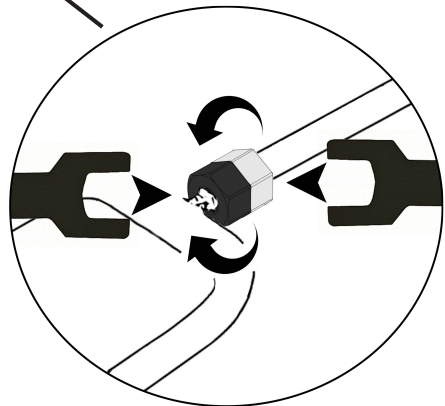

1. Remove torch from the box
2. Straighten out the dual head neck
3. Apply both wrenches as shown in the graph to tighten and lock in place

## GAS ROOFING BURNER FOR LIQUID GAS #YSN1000K

### OPERATIONAL SAFETY

The torch has no temperature indicator. Careless handling of the tool may cause fire. Protect yourself and the environment and observe applicable safety measures.



#### CAUTION!

1. Do not put the torch burner close to face and hands. There is risk of burns.
2. The burner heats up very much during torch operation. High temperature remains for some time after the torch is switched off.
3. Do not put hot torch burner close to flammable materials.
4. Before storing ensure that gas valve wheel is turned off, hot torch must cool down.
5. Do not store the gas container in temperature above 40°C (104°F) or in direct sunlight.
6. Keep the torch beyond reach of children.
7. With this torch use propane, butane or propane and butane mixed.
8. Protect the torch and rubber hose against oil, acids and other chemical agents.
9. When operating the torch always use personal protection measures: protective glasses and gloves.
10. Do not operate damaged torch or a torch with damaged rubber hose.
11. Do not repair the torch by yourself, do not dismantle parts of the torch.
12. Use the torch accordingly to the manual.



#### WARNING!

- Do not use brazed joints for elements that may be subject to temperature above 130°C.
- Do not join parts used for lifting weights with brazed joints.



#### CAUTION!

Ensure that flexible, rubber hose between torch and gas container is in good technical condition, connection is air-tight, and gas pressure does not exceed the value on the rubber hose.



#### CAUTION!

Rubber hoses are equipped with left hand thread connectors.



#### CAUTION!

All checks and repairs should be carried out by the supplier's service department or by service site certified by the supplier. All checks and repairs must be carried out only when rubber hose is disconnected from the gas cylinder. **Cut off gas supply before disconnecting the hose!**



#### CAUTION!

Do not pull the rubber hose to move or lift gas container.

Check condition of rubber hose each time before starting work. In case any damage is found (accidental surface cut, signs of burns, bulge or change of diameter) immediately replace the hose with a new one. Rubber hose also must be replaced not later than 5 years from its production date specified on the hose.

## TECHNICAL PARAMETERS

Flame temperature [°C]	1850
Gas consumption [g/h]	7800
Burner power [kW]	110
Number of burners	2
Burner diameter (mm)	W = 50
Type of burner	roofing
Hose length	5m
Additional equipment	50 cm gas supply stiff connection



## MAINTENANCE

Sometimes using contaminated gas that may appear when the gas tank is almost empty causes partial clogging of the nozzle. To clean the nozzle turn the gas container valve off, disconnect rubber hose from the gas container, disassemble the torch, clean the nozzle thoroughly with petrol or similar liquid. You can also use very thin wire to clear the nozzle. **UNDER NO CIRCUMSTANCES ALLOW THE NOZZLE OPENING TO ENLARGE.**



## OPERATION AND USE

### Starting the torch

- Release gas valve lever
- Turn gas valve of the torch towards (-) to turn it off.
- Connect gas hose to the torch and gas container.
- Open gas container valve to supply rubber hose with gas.
- Direct the torch nozzle forward.
- Press the gas valve lever against the handle
- Turn the torch gas valve by 2/3 of a turn in (+) direction (you should hear specific hissing of the gas coming out).
- Light up gas coming out of the burner.

### Adjusting flame size and temperature

Gas valve wheel allows setting the flame size and temperature.

Turn the wheel in (-) direction to reduce the flame size and temperature. Turn the wheel in (+) direction to increase the flame size and temperature.

### Extinguishing the flame

- Release gas valve lever
- Turn the gas valve in (-) direction to extreme position.
- Cut off gas supply from the gas container when the flame is extinguished.

