

- One (1) Supermicro Motherboard
- Six (6) SATA Cables (X9DRL-EF)
- Eight (8) SATA Cables (X9DRL-7F)
- One (1) Quick Reference Guide
- One (1) I/O Shield

Motherboard Layout and Features

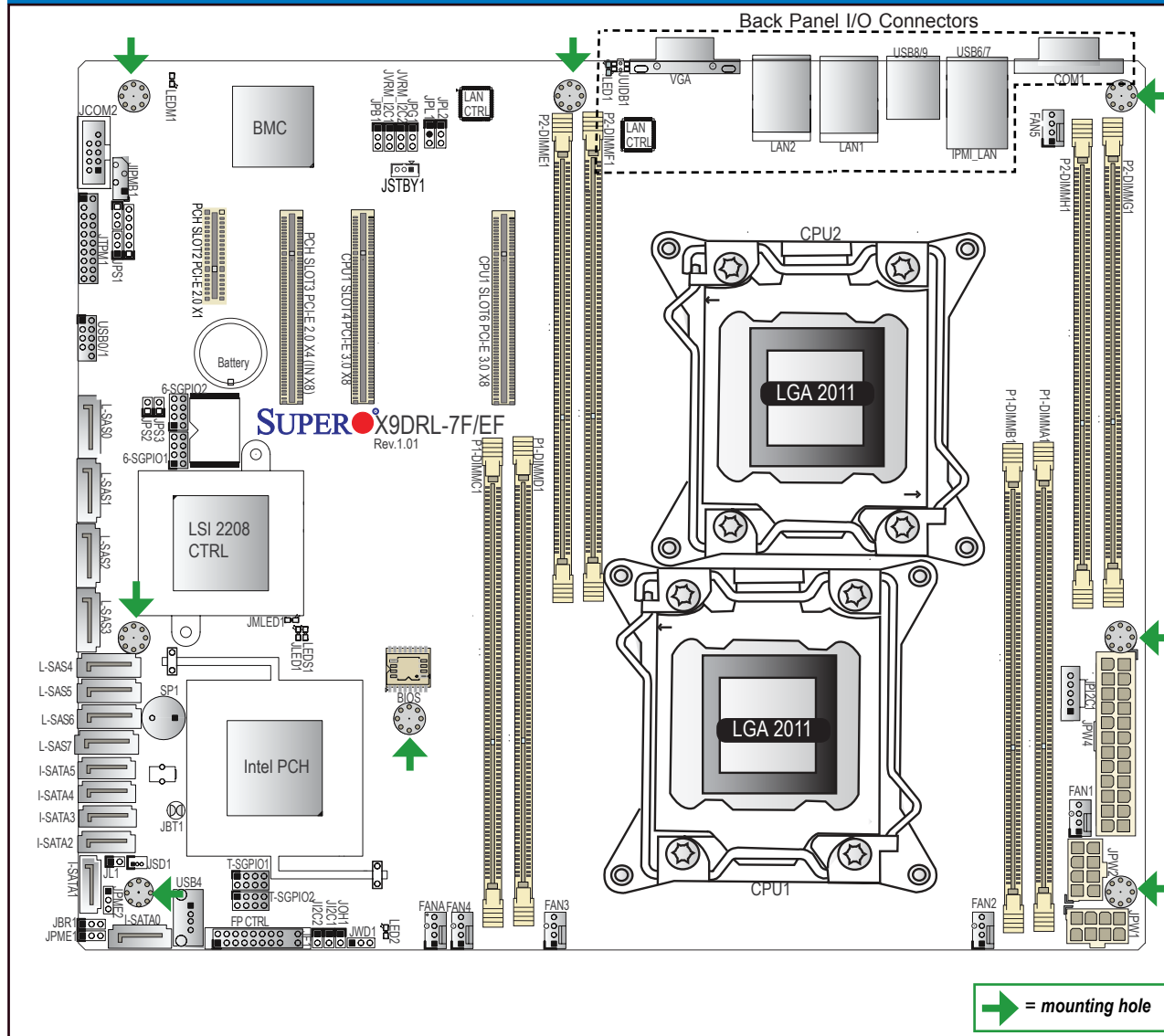

Jumpers, Connectors and LED Indicators

Jumpers		
JBT1	Clear CMOS	See Chapter 3
JIP2C1/JIP2C2	SMB to PCI-E Slots	Off (Disabled)
JPB1	BMC Enable	Pins 1-2 (Enabled)
JPG1	VGA Enable	Pins 1-2 (Enabled)
JPL1/JPL2	GLAN1/GLAN2 Enable	Pins 1-2 (Enabled)
JPS1	L-SAS Enable (X9DRL-7F Only)	Pins 1-2 (Enabled)
JWD1	Watch Dog Timer Enable	Pins 1-2 (Reset)

Connectors	
Battery	Onboard Battery (See Chpt. 3 for Used Battery Disposal)
COM1/COM2	Backplane COM Port1/Front Accessible COM2 Header
Fan1-5, FanA	CPU/System Fan Headers
JF1	Front Panel Control Header
JIPMB1	4-pin External BMC I ² C Header (for an IPMI Card)
JL1	Chassis Intrusion
JOH1	Overheat LED Indicator
JIP2C1	Power Supply SMBbus I ² C Header
JPW1/2	12V 8-Pin Power Connectors (See Warning on Pg. 1-6.)
JPW4	24-Pin ATX Main Power Connector (See Warning on Pg. 1-6.)
JSD1	SATA DOM (Device on Module) Power Connector
JSTBY1	5V Standby Power
JTPM1	TPM (Trusted Platform Module)/Port 80
JUIDB	UID (Unit Identification) Switch
LAN1/LAN2	G-bit Ethernet Ports 1/2
(IPMI) LAN	IPMI_Dedicated LAN
(L-)SATA 0-5	Intel PCH SATA Connectors (0-5)
(L-)SAS 0-7	L-SAS Connectors 0-7 (via LSI 2208 controller for X9DRL-7F)
(PCH) Slot2	PCI-Express 2.0 x1 Slot from Intel PCH
(PCH) Slot3	PCI-Express 2.0 x4 in x8 Slot from Intel PCH
(CPU1) Slot4	PCI-Express 3.0 x8 Slot from CPU1
(CPU1)Slot6	PCI-Express 3.0 x8 Slot from CPU1
(6-) SGPIO 1/2	Serial Link General Purpose I/O Headers 1/2 for L-SAS ports (for X9DRL-7F only)
(T-)SGPIO1/2	Serial Link General Purpose I/O Headers 1/2 (for SATA ports)
SP1	Internal Speaker/Buzzer
(FP) USB 4	Front Panel Type A USB Connector 4
(FP) USB 0/1	FP-Accessible USB Connectors 0/1
(BP) USB 6/7, 8/9	Backpanel USB Ports 6/7, 8/9
VGA	Backpanel VGA Port

LED Indicators			
JLED1	I-SATA Activity LED	Green: Blinking	I-SATA Active
JMLED1	L-SAS Activity LED	Green: Blinking	L-SAS Active
LED1	Rear UID LED	Blue: On	Unit Identified
LED2	Onboard PWR LED	Green: On	System Power On
LEDM1	BMC Heartbeat LED	Green: Blinking	BMC Normal
LEDS1	L-SAS Heartbeat LED	Green	L-SAS Normal

Memory Support

The X9DRL Motherboard series supports up to 256GB of Registered (RDIMM)/ Load Reduced (LRDIMM) ECC or up to 64GB of Unbuffered (UDIMM) ECC/ Non-ECC DDR3 memory with speeds of 1600/1333/1066/800 MHz in eight DIMM slots. For the latest memory updates, please refer to our website at <http://www.supermicro.com/products/motherboard>.

Note: For memory optimization, use only DIMM modules that have been validated by Supermicro. For the latest memory updates, please refer to our website at <http://www.supermicro.com/products/motherboard>.

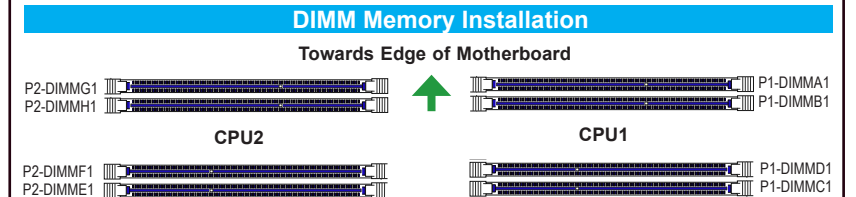

Processors and their Corresponding Memory Modules				
CPU#	Corresponding DIMM Modules			
CPU1	P1-DIMMA1	P1-DIMMB1	P1-DIMMC1	P1-DIMMD1
CPU2	P2-DIMME1	P2-DIMMF1	P2-DIMMG1	P2-DIMMH1

Processor and Memory Module Population	
Number of CPUs+DIMMs	CPU and Memory Population Configuration Table (*For memory to work proper, please install DIMMs in pairs)
1 CPU & 2 DIMMs	CPU1 P1-DIMMA1/P1-DIMMB1
1 CPU & 4 DIMMs	CPU1 P1-DIMMA1/P1-DIMMB1, P1-DIMMC1/P1-DIMMD1
2 CPUs & 2 DIMMs	CPU1 + CPU2 P1-DIMMA1, P2-DIMME1
2 CPUs & 4 DIMMs	CPU1 + CPU2 P1-DIMMA1/P1-DIMMB1, P2-DIMME1/P2-DIMMF1
2 CPUs & 6 DIMMs	CPU1 + CPU2 P1-DIMMA1/P1-DIMMB1/P1-DIMMC1, P2-DIMME1/P2-DIMMF1/P2-DIMMG1
2 CPUs & 8 DIMMs	CPU1 + CPU2 P1-DIMMA1/P1-DIMMB1/P1-DIMMC1/P1-DIMMD1, P2-DIMME1/P2-DIMMF1/P2-DIMMG1/P2-DIMMH1

Note: Up to 256GB of memory are supported. See chapter 2 of the User Manual for complete memory population information.

Back Panel I/O Connectors

A. COM 1	B. IPMI Dedicated LAN
C. USB Port 7	D. USB Port 6
E. USB Port 9	F. USB Port 8
G. Gigabit LAN 1	H. Gigabit LAN 2
I. VGA Port	J. UID Switch & LED

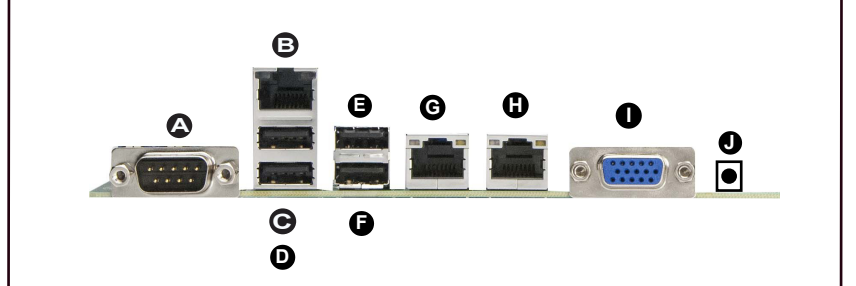

CPU Installation

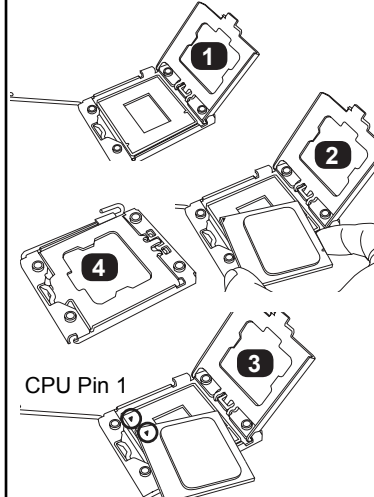

Heatsink Installation

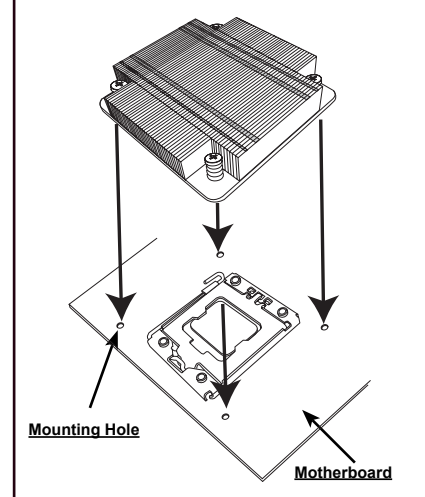

Front Panel Control (JF1)

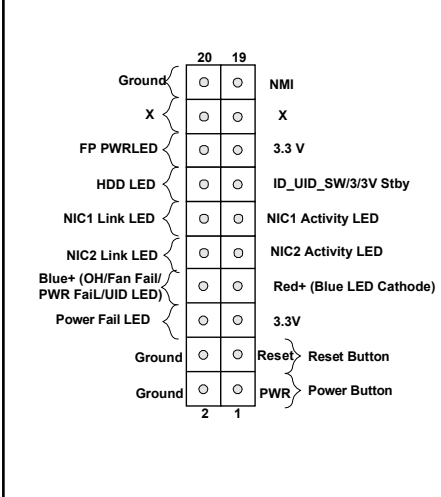

Note: Graphics shown in this quick reference guide are for illustration only. Your components may or may not look exactly the same as drawings shown in this guide.

Note: Refer to Chapter 2 of the User Manual for detailed information on jumpers, connectors, and LED indicators.

Note: Refer to Chapter 2 of the User Manual for detailed information on memory support and CPU/motherboard installation instructions.