

**CONTACT INFORMATION**

- Website: [www.supermicro.com](http://www.supermicro.com)
- General Information: [marketing@supermicro.com](mailto:marketing@supermicro.com)
- Tech Support: [support@supermicro.com](mailto:support@supermicro.com)
- Phone: +1 (408) 503-8000, Fax: +1 (408) 503-8008

FOR YOUR SYSTEM TO WORK PROPERLY, PLEASE DOWNLOAD APPROPRIATE

DRIVERS/IMAGES/USER'S MANUAL FROM THE LINKS BELOW:

- Manuals: <http://www.supermicro.com/support/manuals/>
- Drivers & Utilities: <http://www.supermicro.com/wftp>
- Safety: [http://www.supermicro.com/about/policies/safety\\_information.cfm](http://www.supermicro.com/about/policies/safety_information.cfm)

**PACKAGE CONTENTS**

- One (1) Supermicro Motherboard
- Six (6) SATA Cables
- One (1) I/O Shield
- One (1) Quick Reference Guide



**Motherboard Layout and Features**

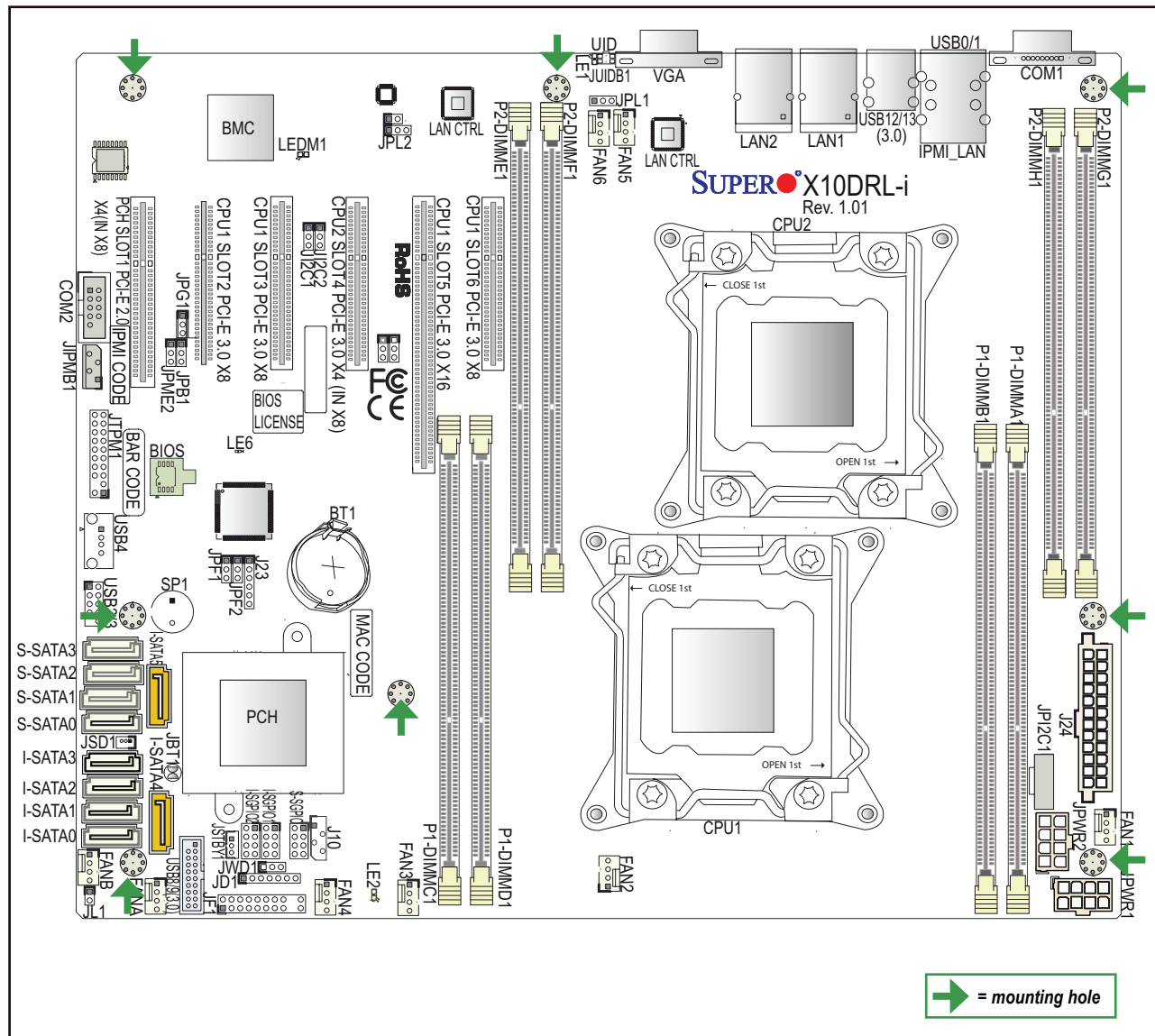

**Jumpers, Connectors, and LED Indicators**

| Jumpers    |                              |                     |
|------------|------------------------------|---------------------|
| Jumper     | Description                  | Default Setting     |
| JBT1       | Clear Onboard CMOS Battery   | See Chapter 2       |
| JIP1/ JIP2 | SMB to PCI-E Slots           | Pins 2-3 (Disabled) |
| JPB1       | BMC Enable                   | Pins 1-2 (Enabled)  |
| JPG1       | VGA Enable                   | Pins 1-2 (Enabled)  |
| JPL1/JPL2  | GLAN1/GLAN2 Enable           | Pins 1-2 (Enabled)  |
| JPME2      | ME Manufacturing Mode Select | Pins 1-2 (Normal)   |
| JWD1       | Watch Dog Timer Enable       | Pins 1-2 (Reset)    |

| Connectors           |   |
|----------------------|---|
| Connectors           | Description   |
| BT1                  | Onboard Battery (See Chpt. 3 for Used Battery Disposal)                                     |
| COM1/COM2            | Back_panel COM Port1/Front Accessible COM2 Header   |
| Fan1-6, FanA/B       | CPU/System Fan Headers  |
| J24                  | 24-pin ATX Main Power Connector (See Warning on Pg. 1-6.)                                   |
| JD1                  | Speaker/Power LED   |
| JF1                  | Front Control Panel Header  |
| JIPMB1               | 4-pin External BMC I <sup>2</sup> C Header (for an IPMI Card)                               |
| JL1                  | Chassis Intrusion   |
| JPIPC1               | Power Supply SMBus I <sup>2</sup> C Header  |
| JPWR1/JPWR2          | 12V 8-Pin Power Connectors (See Warning on Pg. 1-6.)  |
| JSD1                 | SATA DOM (Device on Module) Power Connector   |
| JSTBY1               | Standby Power Connector   |
| JTPM1                | TPM (Trusted Platform Module)/Port 80 Header  |
| JUIDB1               | UID (Unit Identification) Button  |
| LAN1/LAN2            | G-bit Ethernet (GLAN) Ports 1/2   |
| IPMI_LAN             | IPMI_Dedicated LAN support by the Aspeed Controller   |
| I-SATA 0-5           | SATA 3.0 Connectors supported by Intel PCH (I-SATA 0-5)                                     |
| S-SATA 0-3           | SATA 3.0 Connectors supported by Intel SCU (S-SATA 0-3)                                     |
| (PCH) Slot1          | PCI-Express 2.0 x4 in x8 Slot from Intel PCH  |
| (CPU1) Slot2         | PCI-Express 3.0 x8 Slot from CPU1   |
| (CPU1) Slot3         | PCI-Express 3.0 x8 Slot from CPU1   |
| (CPU2) Slot4         | PCI-Express 3.0 x4 in x8 Slot from CPU2   |
| (CPU1) Slot5         | PCI-Express 3.0 x16 Slot from CPU1  |
| (CPU1) Slot6         | PCI-Express 3.0 x8 Slot from CPU1   |
| I-SGPI01/2           | Seria_Link General Purpose I/O Headers 1/2 (I-SGPI01 for I-SATA0-3, I-SGPI02 for I-SATA4/5) |
| S-SGPI0              | Seria_Link General Purpose I/O Header (for S-SATA0-3)                                       |
| SP1                  | Internal Speaker/Buzzer   |
| (BP) USB 0/1         | Backpanel USB 2.0 Ports 0/1   |
| (BP) USB 12/13 (3.0) | Backpanel USB 3.0 Ports 12/13   |
| (FP) USB 2/3         | Front-Accessible USB 2.0 Connection Header 2/3  |
| (FP) USB 4           | Front-Accessible Type A Connector USB 2.0 Port 4  |
| (FP) USB 8/9 (3.0)   | Front-Accessible USB 3.0 Connection Header 8/9  |
| VGA                  | Backpanel VGA Port  |

| LED Indicators |                   |                 |                 |
|----------------|-------------------|-----------------|-----------------|
| LED            | Description       | State           | Status          |
| LE1            | Rear UID LED      | Blue: On        | Unit Identified |
| LE2            | Onboard PWR LED   | On              | System Power On |
| LEDM1          | BMC Heartbeat LED | Green: Blinking | BMC Normal      |

**CPU Support**

Dual Intel® E5-2600v3/v4 Series processors (Socket R3-LGA 2011); each processor supports dual full-width Intel QuickPath Interconnect (QPI) links (of up to 9.6 GT/s one direction per QPI)

**Memory Support**

The X10DRL-i Motherboard supports up to 512 GB of DDR4 Registered (RDIMM)/ Load Reduced (LRDIMM) ECC 2400/2133/1866/1600 MHz memory modules in eight DIMM slots. Memory speed support is dependent on the CPUs used in the motherboard. For the latest memory updates, please refer to our website at <http://www.supermicro.com/products/motherboard>.

Populating RDIMM/LRDIMM DDR4 Memory Modules for the E5-2600v3-based Motherboard

| Type   | Ranks Per DIMM and Data Width | DIMM Capacity (GB) |       | Speed (MT/s); Voltage (V); Slot Per Channel (SPC) and DIMM Per Channel (DPC) |
|--------|-------------------------------|--------------------|-------|--|
|        |                               | 4Gb                | 8Gb   |  |
| RDIMM  | SRx4                          | 8GB                | 16GB  | 2133   |
|        |                               | 4GB                | 8GB   | 2133   |
| RDIMM  | DRx8                          | 8GB                | 16GB  | 2133   |
|        |                               | 16GB               | 32GB  | 2133   |
| LRDIMM | QRx4                          | 32GB               | 64GB  | 2133   |
|        |                               | 64GB               | 128GB | 2133   |

Populating RDIMM/LRDIMM DDR4 Memory Modules for the E5-2600v4-based Motherboard

| Type   | Ranks Per DIMM and Data Width | DIMM Capacity (GB) |       | Speed (MT/s); Voltage (V); Slot Per Channel (SPC) and DIMM Per Channel (DPC) |
|--------|-------------------------------|--------------------|-------|--|
|        |                               | 4Gb                | 8Gb   |  |
| RDIMM  | SRx4                          | 8GB                | 16GB  | 2400   |
|        |                               | 4GB                | 8GB   | 2400   |
| RDIMM  | DRx8                          | 8GB                | 16GB  | 2400   |
|        |                               | 16GB               | 32GB  | 2400   |
| LRDIMM | QRx4                          | 32GB               | 64GB  | 2400   |
|        |                               | 64GB               | 128GB | 2400   |

**DIMM Memory Installation**

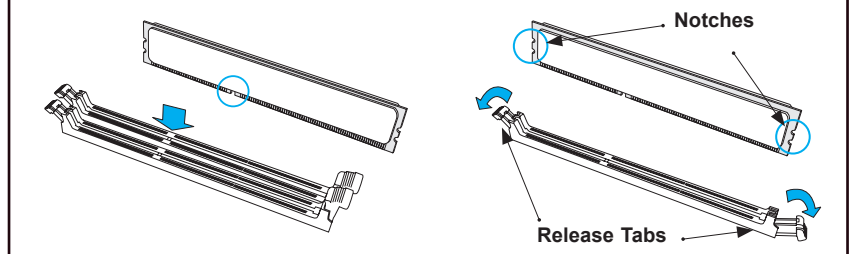

**Back Panel I/O Connectors**

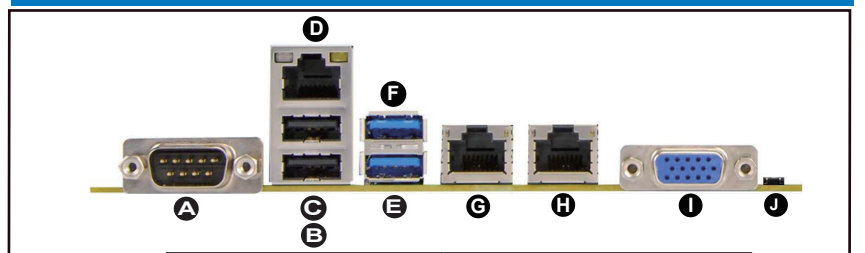

| Backplane I/O Panel          |  |
|------------------------------|--|
| A. COM1                      | F. Backpanel USB 3.0 Port 13                     |
| B. Backpanel USB 2.0 Port 0  | G. Gigabit LAN1                                  |
| C. Backpanel USB 2.0 Port 1  | H. Gigabit LAN2                                  |
| D. IPMI_LAN                  | I. VGA   |
| E. Backpanel USB 3.0 Port 12 | J. UID Button/UID LED (LE1) (on the motherboard) |

**CPU Installation**

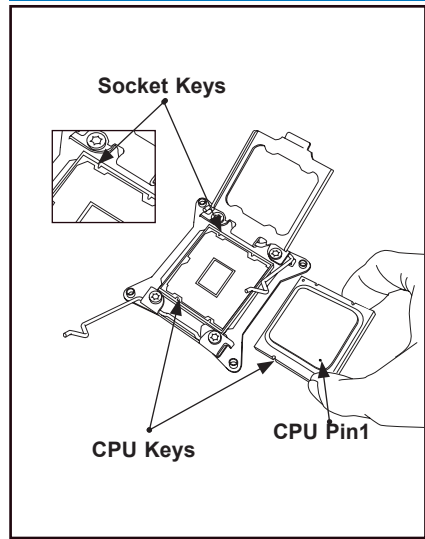

**Heatsink Installation**

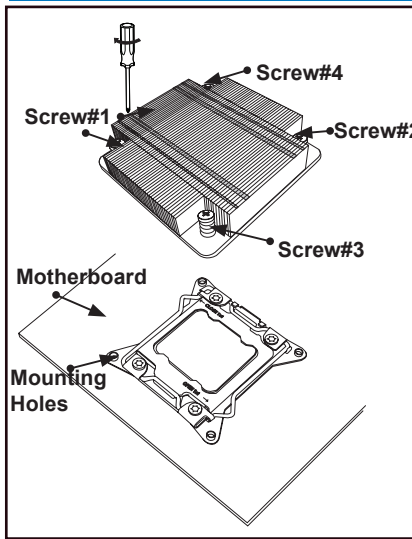

**Front Control Panel (JF1)**

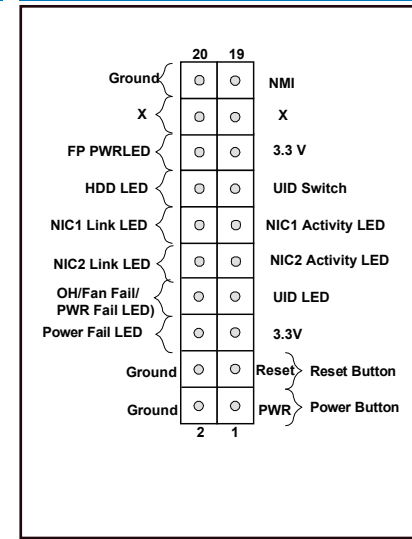

Note: Graphics shown in this quick reference guide are for illustration only. Your components may or may not look exactly the same as the drawings shown in this guide.

Note: Refer to Chapter 1 of the user manual for detailed information on jumpers, connectors, and LED indicators.