

Parts needed for assembly using method #607

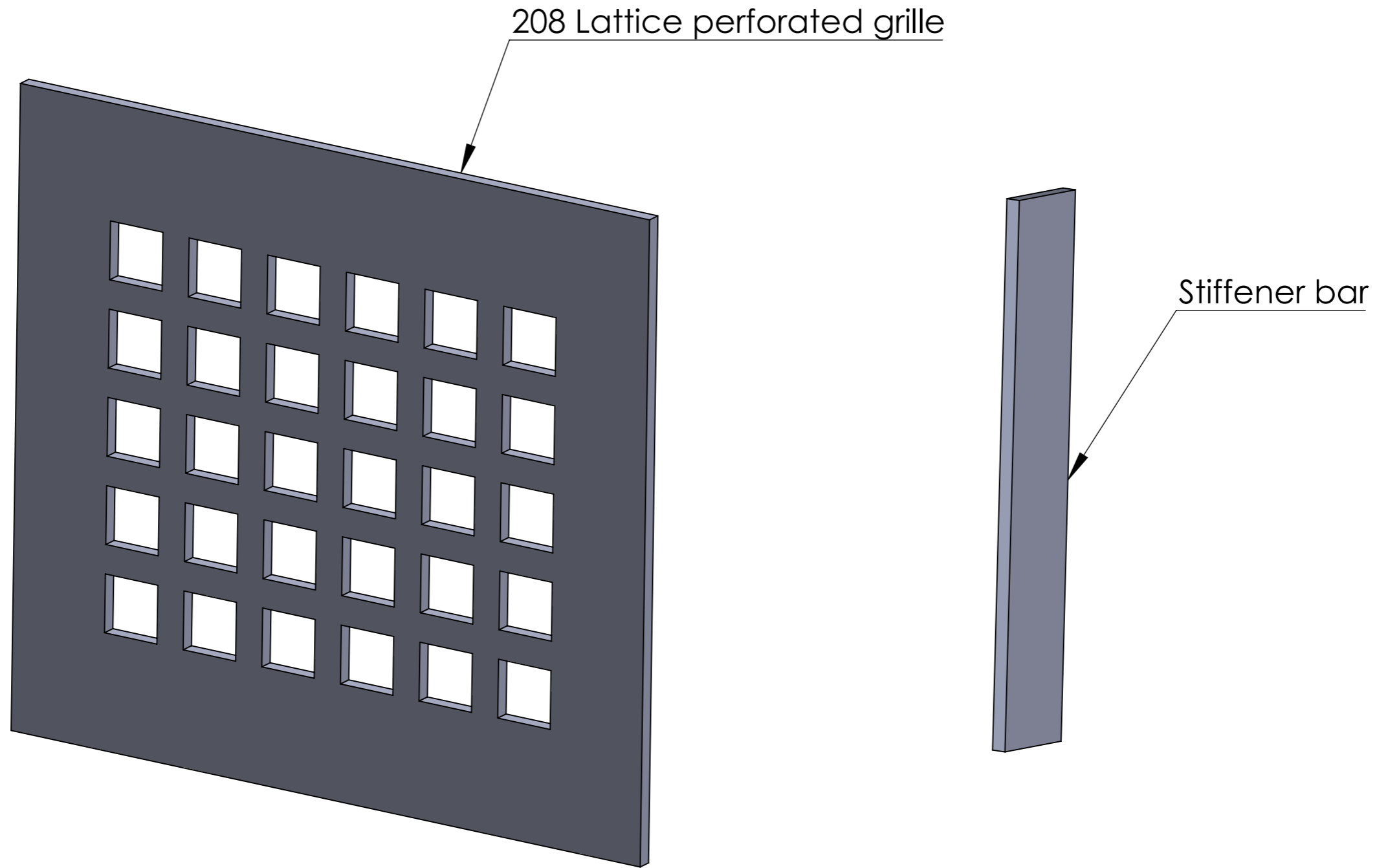

Disclaimer:
This step by step layout is one of the many ways someone can install their custom grille using method #607

	ARCHITECTURAL GRILLE				
	42 SECOND AVENUE BROOKLYN, NY 11215 WWW.ARCHGRILLE.COM				
CUSTOMER			Drawn by Heg	SIZE A3	REV -
DESCRIPTION #607 Method of fastening			SCALE 1"=1"	SHEET DMS.607.1	

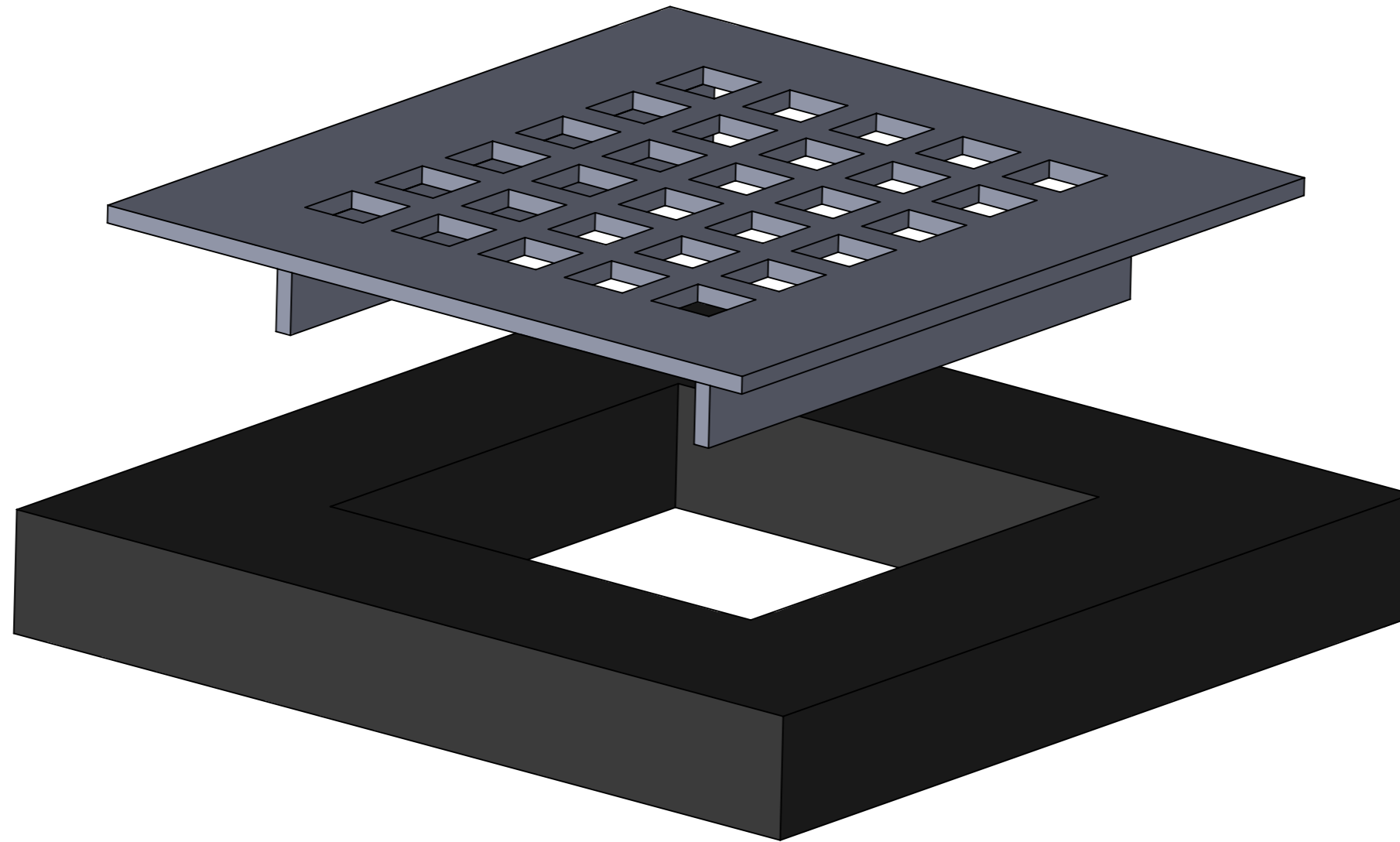

STEP 1:
Place the welded 208 lattice perforated grille and the stiffener bars into the floor opening.

	ARCHITECTURAL GRILLE				
	42 SECOND AVENUE BROOKLYN, NY 11215 WWW.ARCHGRILLE.COM				
CUSTOMER			Drawn by Heg	SIZE A3	REV -
DESCRIPTION	#607 Method of fastening		SCALE 1"=1"	SHEET DMS.607.2	

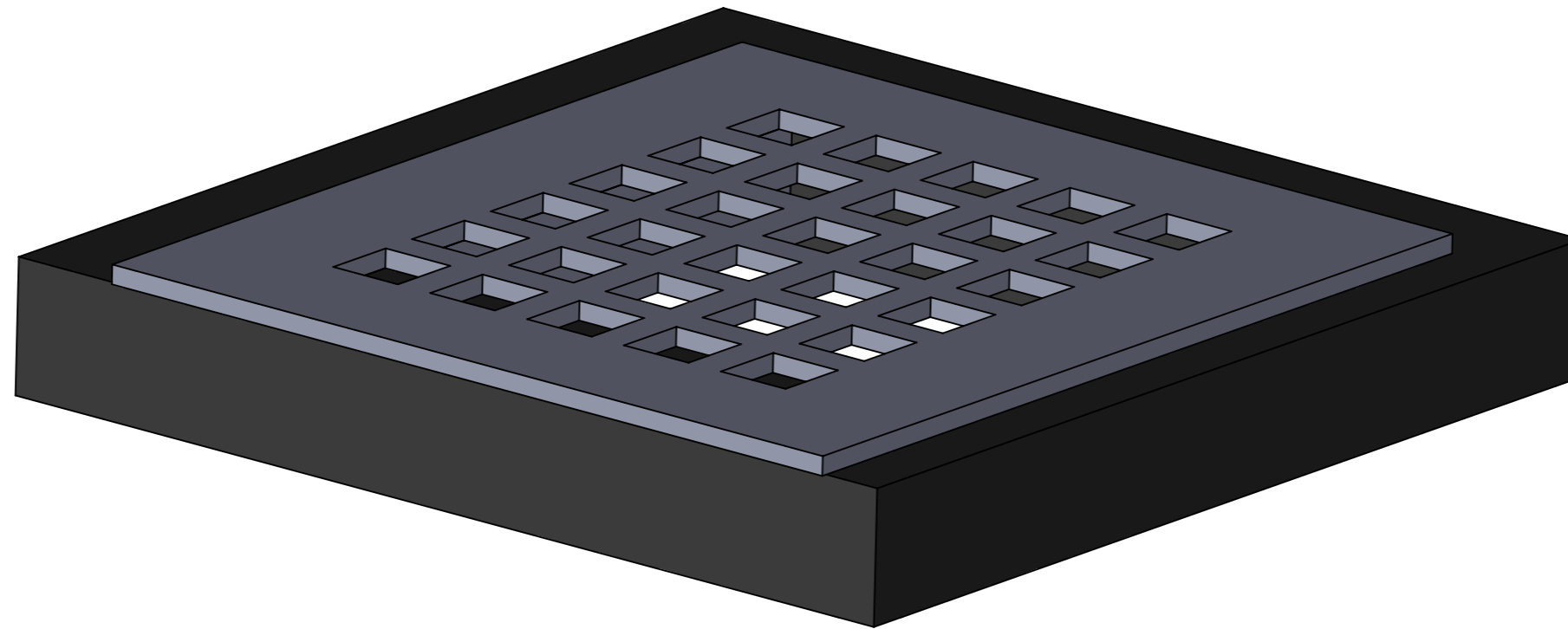

STEP 2:
 The welded 208 lattice perforated grille and
 the stiffener bars placed into the floor opening.
 Installation complete.

	ARCHITECTURAL GRILLE				
	42 SECOND AVENUE BROOKLYN, NY 11215 WWW.ARCHGRILLE.COM				
CUSTOMER			Drawn by Heg	SIZE A3	REV -
DESCRIPTION #607 Method of fastening			SCALE 1"=1"	SHEET DMS.607.3	