

# eTrim<sup>®</sup>

Family Nail Trimmer



## User Manual



## Component Description:

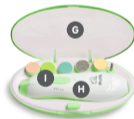

### Switch settings:

- (R1) right/fast
- (R2) right/slow
- (0) power on/off
- (L1) left/slow
- (L2) left/fast

- (A) Super fine grinding
- (B) Fine grinding
- (C) Regular grinding
- (D) Stainless Steel grinding
- (E) Soft polishing
- (F) Cylindrical grinding
- (G) Storage box
- (H) Trimmer
- (I) Switch

2

## Installing or replacing the battery:

1. Open the battery cover of the main unit by pressing the cover.
2. Insert two 'AA' size batteries as shown below. (batteries not provided)
3. Ensure the batteries are correctly inserted in their +/- position in the battery compartment.
4. Close the battery compartment cover.

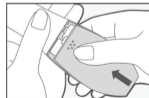
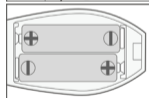

3

## Selection of Grinding Head

1. According to the age of the user, select the corresponding grinding head.
2. Connect the grinding head in to the trimmer unit.
3. Gently hold the baby's hand; choose the appropriate head as below.
4. Grinding Heads - For Baby Use:
  - A. (Super-fine) for 0-3 months old baby.
  - B. (Fine) for 4-11 months old baby.
  - C. (Regular) for over 12 months old baby or toddlers.
5. Grinding Heads - For Adult Use:
  - D. (Stainless grinding head): Use to trim the nails, remove dry and dead skin.
  - E. (Soft) White one: Used for polishing the toenails or fingernails.
  - F. Cylinder grinding head: to polish the edges of the nail.

4

## Operating Instructions:

1. Prepare warm water, wet towel, hand or foot cream.
2. Before use make sure the batteries are working correctly and insert the appropriate fitting into the head of the unit as required.
3. Open the main switch; the LED will light up to start work.
4. This product is designed to operate at two speed and in two circular directions, depending on the individual needs. Select the appropriate speed and rotation direction as required to achieve the best effect on the nails.
5. After use, wash the hands or feet with warm water and dry with a towel; apply hand or feet cream as appropriate to nourish the skin and protect nails.
6. After use store the unit in a safe and dry space.

5

## Tips:

1. For better results please do not wet your hands or feet before using the product.
2. LED light is most effective for use in a darkened room or at night.

## Precautions:

1. Keep the product away from children and in a safe place.
2. Remove batteries if the product will not be used for a long time.
3. Do not disassemble or repair the product yourself.
4. This product is not waterproof. Putting it in water may cause damage and will void the warranty.

6

## Warranty

The warranty period for device is one year from date of delivery. In case of a warranty claim, the date of delivery has to be proven by means of the sales receipt or invoice.

Repairs under warranty do not extend after the warranty period.

The following cases are excluded under the warranty:

- All damage due to improper treatment, e.g. failure to follow the user guide.
- All damage due to repair or tampering by the customer or unauthorized third parties.
- Damage incurred during transport from the manufacturer to the consumer or during transport to the service center.
- Accessories (including but not limited to heads) that are subject to wear and tear.
- Battery replacement is not covered under the warranty.

Liability for direct or indirect consequential losses caused by the unit is excluded even if the damage to the unit is accepted as a warranty claim.

**Contact your point of sales representative and include your product purchase receipt as evidence for service support during the warranty period.**

7



Factory Location: Dongsheng Town, Zhongshan City, Guangdong Province, China.

Product Type: KDE-003  
Voltage: 3 V  
Manufactured for Elepho Inc.



Elepho Inc., 466 Central Ave (2nd floor), Cedarhurst, New York, 11516. USA

Product/model name: eTrim

E-mail support: [customercare@elepho.com](mailto:customercare@elepho.com)

Elepho Consumer Relations (USA):  
1-833-435-3746 (1-833-4-ELEPHO)

General information regarding Elepho's full product line: [www.elepho.com](http://www.elepho.com)



8