

CARBIT Easy Connected verified mobile phone list

Table with 7 columns: Date, 2015/2/28, Version, V2.0, Date, 2015/2/28, Version, V2.0. It lists various mobile phone models and their compatibility with the system.

Map installation and parameter

Installing method :

- 1. insert SD card with map into the GPS slot on the panel of device
2. enter into setup interface,click GPS icon and then turn to settings of navigation path,the system will automatically find out all the "exe" files in the map card,and then select correct navigation path,(as shown below)press GPS on the panel or back to main UI and click GPS icon will start navigating.

Parameter : Operation System : WIN CE 6.0 Core Chinese/English version
Chipset : MSR2112
Resolution : 800X480
GPS BAUD(Baud rate) : 9600bps
GPS COM : 2



SWC settings

- Click "SWC" icon on the main UI to enter into the setup interface
1. Click the steering wheel to set the steering wheel
2. Click the "SWC" icon to set clear
3. Press the button on the steering wheel,and meanwhile press the function which need to be set on the display,when the icon is in selected state,that's means ok
4. Repeat the steps for other buttons
5. Press "OK" to confirm once finished
6. Any mistake or resetting,just repeat 2-5

Note:make sure "button wire" on the steering wheel connected well with "SWC" on the unit, as shown below: 2 CSW wire connected with anode of steering wheel button wire, GND conneted with cathode

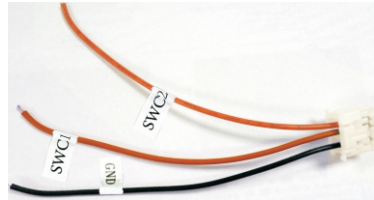

Bluetooth use method CODE : 0000

- 1.Enter into bluetooth interface,click "Bluetooth" icon to search nearby phones, ensure bluetooth of your mobile phone is under searchable states when searching. Available bluetooth device will be displayed in the middle list;if too long,just click "Pair".
2.Pair:find your phone in the list and click phone name to pair,also your mobile phone will ask matching password,just input "0000"and then click "sure" will be ok. It will appear "LINK OK". If you want to cancel pairing,just find your phone in the list and press your phone name for 3seconds,then your phone name will disappear from the list. If you just cancel pairing on the phone but not on the car DVD player, it will send a pairing request for every 30seconds to you mobile phone and cause troubles to you.
3.Synchronous phonebook: "Phonebook" icon,a small window appears, just click "Phonebook" and then pop up a phonebook synchronization request on your phone,click"OK" to complete synchronization. Phonebook synchronization finished,input first letter of contact on the keypad of screen to search(Chinese search is the first letter of Pinyin).
4.Dial phone:click "Phone" enter into dialing interface,input phone number on the numeric keypad to call or hang up.
5.Bluetooth music:click "Music" enter into bluetooth music interface.Pls note that open the player on the phone first when playing music,because the car DVD player cannt start phone player.Some mobile phones may installed more than one player,just start any one will be ok.

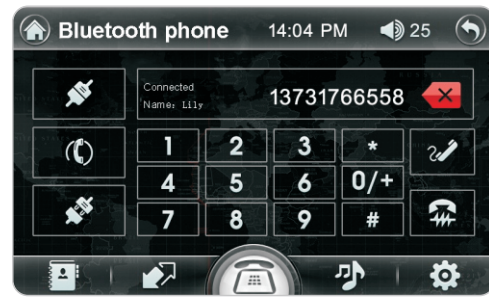

Common Troubleshooting Guide

Table with 3 columns: Fault, Reason, Solution. It lists various issues like 'No boot up', 'After ignition starting up and power off...', 'No remote control action/function', etc., and their corresponding solutions.

Car Multimedia System DK Series User Manual

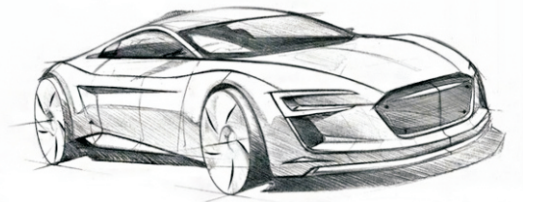

REV1.0

Professional vehicle entertainment multimedia

Thank patronage!

Thank you very much for purchasing and using our digital car audio-video series products! To ensure you can use this product correctly,please read this user manual carefully before use it and keep it well for your future reference.

Safety Warning

- Laws of some countries prohibit users from watching TV or other programs and performing related operations when driving.For your personal safety,please do not watch videos,TV and other related operations while driving.
• The system is only for assistant function when reversing(backing),we accept no any responsibility for any accidents caused during reversing(backing).

Warning

- 1.Do not expose the unit in the damp environment to prevent from fire or electric shock accident.
2.Any change or modification to this unit without the clear prior consent of the authorization party may bring inconvenience to the users.
3.This unit is made up of high-precision accessories,do not dismantle the device or adjust any accessories inside this device if without authorization.
4.Do not touch the display screen with hard objects, so as to avoid scratching the screen.
5.Please don't install this device in these places which is in the way of driver's view or effect driving.
6.To avoid any traffic accidents as driver's distraction,please don't operate this device when driving, if needing to operate, please park the car in a safety place first.
7.This device is fit for such cars with 12V power supply battery system of cathode ground wire,please do not install this device to 24V battery's trucks or buses.

Functions and features

System Features

- MSTAR2531 chipset solution , ARM Cortex-A7 core , 800MHz main frequency.
• RAM 256MB,DDR3 @ 1600MHz
• Flash support SLC/MLC , 128MB SLC NAND FLASH

Supported media formats for DISC

- Compatible with DVD-R, DVD-RW, DVD + R, DVD + RW, CD-R, CD-RW CD-DA, MP3, WMA, SVCD, VCD and MPEG1, MPEG2, MPEG4, JPEG format discs .

Supported media formats for USB/SD

- Compatible with MP3, WMA, WAV,AST,AVI,MP4,MPEG1,MPEG2,MPEG4,JPEG, FLAC,RMVB format .
• Supports SD port and USB(2.0) port.

Radio functions

- 30 storage radio stations (FM x 18pcs, AM12 x pcs) .
• Automatic , semi-automatic and manual search , preset memory radio stations.

TV functions(optional)

- Analog TV(ATV) • Digital TV(DTV)

Aux input,output,amplifier and other functions

- AUX input \* 1 •rear-view camera input \* 1
•two-channes' amplifier output,which can be directly speaker.
• 2 +1 channel audio output.
• 4 channels amplifier output.

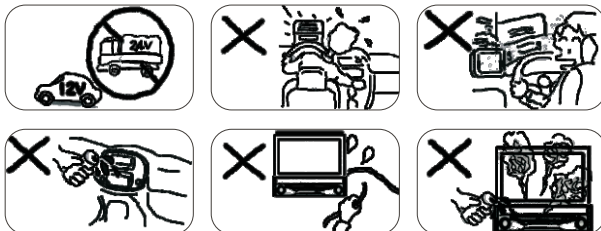

Class 1 Laser Products

We have the rights not to inform in advance if the product descriptions in this manual have any changing.

The notes about the full unit's connection diagram

- The product is used for such cars with 12V battery and negative grounding , before installing this product on these cars with 24V batteries,such as truck,bus, big coach etc.cars), please install the reduction voltage equipment first.
• To avoid short circuit of the electrical system , please firstly switch off the negative electrode terminal's wire of the batter before installing it.
• Please arrange the wiring in some place where can be fixed, thus, keep it no way to touch any moving parts , such as the handbrake ,gear lever, etc ; Do not arrange the wiring in the heat source area , such as near the heater discharge outlet , otherwise,the heat source will cause the wiring insulation layer was melted or worn,thus,it will cause short-circuit between the wiring and the car body .
• When replacing the blown fuse ,you must use (10A) fuse as ruled. If use high - capacity rated fuses to replace ruled fuses, or no use fuses to direct connect , very easy to cause a fire or damage the device.
• Do not let the yellow power cord go through the engine mounting hole and introduced with warehouse positions to connect the battery , otherwise, it may damage the power line,then, it will cause short circuit between power line and car body .
• Do not connect this product's power line with other devices' power lines , otherwise, it will cause overloading to change overheating.
• Please use insulation paste to wrap the leading wire of unused speaker, so as to avoid(prevent) short circuit,please ensure that the leading wire of unused speaker gets insulation, otherwise it will cause a short circuit.
• Please ensure that keep any exposed wires to get insulation,meanwhile,bundling all electric wires very well , avoiding any connection terminals to touch the metal parts of this device's body,thus, it can prevent short circuits.
• If your car's ignition does not have ACC position , please use ignition switch key to connect ignition wire/lead onto this on/off power source.
• When turning on the power source , external power amplifier control signal leads AMP. CONT output of this device(unit) connected an external amplifier , please do not connect AMP. CONT leading wire to the end of power amplifier, otherwise, it will cause electric leakage and fault.
• For this product, forbidden its loudspeaker output terminals to connect ground wire,otherwise it will burn out the amplifier. Do not use such loudspeaker system with the common ground wire and three kinds of wires styles,no permitting to connect the loudspeaker to car body.
• The loudspeaker which connects this device(unit) must be high-power type, the minimum rated value is 50W, impedance values(resistance value) is 4Ω, please don't directly connected a several of speaker leads or impedance values (resistance value) outside of this range, otherwise,it will cause short circuit and damage the loudspeakers.

MCU Software upgrade Instructions

Copy MCU software(total 2 files) as below into empty SD card;insert SD card into GPS slot while off state of the device,and then it will upgrade automatically when detect the software after power on.SD card can only be removed after upgrade completely finished.Note:power off is prohibited while upgrading



ARM Software upgrade Instructions

Copy ARM software(total 8 files) as below into empty SD card;insert SD card into GPS slot while off state of the device,and then it will upgrade automatically when detect the software after power on.SD card can only be removed after upgrade completely finished.Note:power off is prohibited while upgrading



DVD software upgrade instructions

Copy DVD software(total 2 files) as below into empty SD card;insert SD card into GPS slot while off state of the device,and then it will upgrade automatically when detect the software after power on.SD card can only be removed after upgrade completely finished.Note:power off is prohibited while upgrading

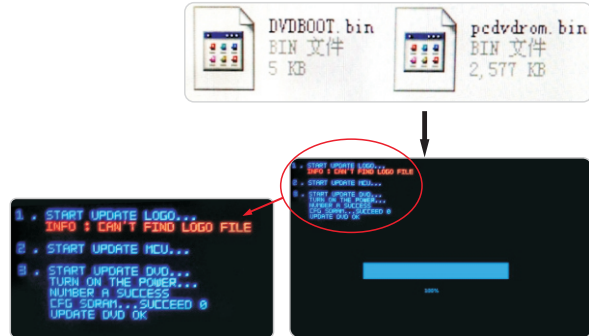

Mirror Link Instruction

After mobile phone bluetooth linked successfully with unit,connect this unit with mobile phone with a 2.0 USB cable,it will prompt download mirror link "phonelink" APP for the first time,and then prompt installation after finished(some mobile phones may will not prompt download and install APP).APP installation finished,find the developer option on the mobile phone,and then open "USB debug", the mobile phone will connect with the unit automatically(some cellphones can only access connection by clicking USB2 icon manually), you will be able to operate any applications of the mobile phone on this unit after connected successfully;please repeat above steps for failure.Checking whether the mobile phone has installed APP,you can see whether there is "phonelink" icon on the phone UI

