

Consumers should notice that this manual might differ slightly from the actual product as more improvements are made to our products. We reserves the right to make changes at any time without any notice and without incurring any obligation.



Recycle unwanted materials instead of disposing of them as waste, all tools and packaging should be sorted, taken to the local recycling centre and disposed of in an environmentally safe way.

KNK[®] **POWER**

BACKPACK MULTI-FUNCTION SYSTEM 4 IN 1 USER MANUAL

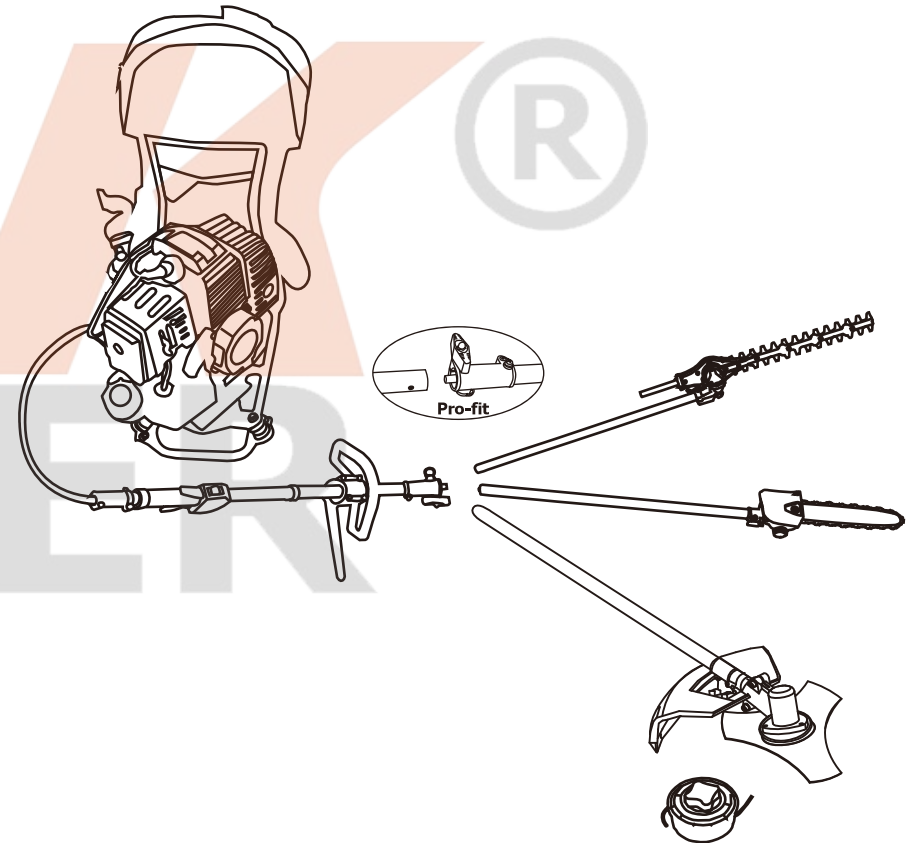

Model: KM0408529

Table of content

1	CAUTION · PLEASE READ	2
1.1	Safety instructions for hand-operated petrol power scythe	2
1.2	Preliminary measures	2
1.3	Handling	2
1.4	Meaning of safety symbols used	3
1.5	What not to do	3
2	PROPER OPERATION	3
3	LAYOUT	4
3.1	Overview	4
3.2	Safety devices	4
4	ASSEMBLING THE COMPONENTS	4
4.1	Assembly of the „D“ handle	4
4.2	Assembly of the "Bike" handle	5
4.3	Assembly of the guard hood	5
4.4	Assembly of the cutting head	5
4.5	Assembly of the cutting blade	5
4.6	Setting the cutting height	5
5	STARTING UP	6
5.1	Fuel and oil	6
5.2	Starting the engine	6
5.2.1	Starting the engine from a cold state	6
5.2.2	Starting the engine from a warm state	6
5.3	To stop engine	7
6	TRIMMING INSTRUCTIONS	7
6.1	Additional safety precautions	7
6.2	Stringhead line release	7
6.3	Trimming procedures	7
6.4	Cutting with blades	7
7	MAINTENANCE	8
7.1	Air filter	8
7.2	Carburettor adjustment	8
7.3	Spark plug	8
7.4	Debris shield knife sharpening	8
8	STORING A UNIT	8
9	REMOVING A UNIT FROM STORAGE	8
10	TECHNICAL SPECIFICATIONS	9
11	TROUBLE SHOOTING THE ENGINE	9

1 CAUTION · PLEASE READ

For safety reasons, it is imperative that you read these operating instructions before using the appliance. Serious injuries could result if these instructions are not followed. You must therefore dedicate a few minutes to studying your new power tool and its instructions before each use.

1.1 Safety instructions for hand-operated petrol power scythe

Read the directions with due care. Familiarize yourself with the settings and proper operation of the machine.

Never allow children or other persons who are not familiar with the operating instructions to use the petrol power scythe. Contact your local governmental agency for information regarding minimum age requirements for operating the petrol power scythe.

Never mow in the direct vicinity of persons -especially children - or animals.



Maintain a safety distance of 15m. If approached, switch off the appliance immediately. Always keep in mind that the machine operator or user is responsible for accidents involving other persons and/or their property.

1.2 Preliminary measures

- Always wear sturdy, non-slip footwear and long trousers when mowing. Never mow barefoot or in sandals.
- Check the grounds on which the machine will be used and remove all objects that could be caught up and violently flung out.











Warning: Petrol is highly flammable!

- Only store petrol in containers designed to hold petroleum-based liquids
- Only refuel out in the open and do not smoke during the refueling process.
- Always refuel before starting the engine. Do not open fuel tank cap and do not refuel when the engine is running or when the scythe is hot.
- If petrol has overflowed, do not under any circumstances attempt to start the engine. Instead, remove the machine from the affected area. Avoid starting the engine until the petrol fumes have completely evaporated.
- For safety reasons, the petrol tank and other tank closures must be replaced if they are damaged.
- Replace defective mufflers.
- Before using the scythe, visually inspect it to ensure that the blade, mounting bolts and the entire cutting apparatus are in good working order (i.e. not worn out or damaged). To prevent any imbalance, replace worn out or damaged blades and mounting bolts as a set only (if applicable).

1.3 Handling

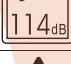
1. **Wear close fitting, tough work clothing** that will provide protection, such as long slacks or trousers, safety work shoes, heavy duty work gloves, hard hat, a safety face shield, or safety glasses for eye protection and a good grade of ear plugs or other sound barriers for hearing protection.
2. **Store in a safe place.** Open fuel cap slowly to release any pressure which may have formed in fuel tank. To prevent a fire hazard, move at least 10 feet (3 meters) from fueling area before starting.
3. **Turn unit off** before setting it down.
4. **Always hold unit firmly with both hands**, the thumb and fingers encircling the handles.
5. **Keep all screws and fasteners tight.** Never operate your equipment when it is improperly adjusted or not completely and securely assembled.
6. **Keep handles dry**, clean and free of fuel mixture.
7. **Keep stringhead as close to ground as practical.** Avoid hitting small objects with stringhead. When cutting on a slope, stand below stringhead. NEVER cut or trim on a hill or slope, etc. if there is the slightest chance of slipping, sliding or losing firm footing.
8. **Check area you will be trimming for debris** that may be struck or thrown during operation.
9. **Keep all parts of your body and clothing away from stringhead** when starting or running engine. Before starting engine, make sure stringhead will not come in contact with any obstacle.
10. **Stop engine** before examining cutting line.
11. **Store equipment away from possible flammable materials**, such as gas-powered water heaters, clothes dryers, or oil-fired furnaces, portable heaters, etc.
12. **Always keep** the debris shield, stringhead, and engine free of debris build-up.
13. **Operation of equipment** should always be restricted to mature and properly instructed individuals

1.4 Meaning of safety symbols used

	Read the operating instructions before you operate the machine.
	Wear helmet, ear muffs and goggles!
	Keep other people out of the danger area!
	Important! Hazard!
	Important! Hot surface!
	Noise emission complies with EC Directive 2004/14/EC!
	Hazard due to objects being thrown out!
	Wear gloves in order to protect hands.
	Wear rubber boots to protect against electric shock.

1.5 What not to do

- DO NOT USE ANY OTHER FUEL** than that recommended in your manual. Always follow instructions in the Fuel and Lubrication section of this manual. Never use gasoline unless it is properly mixed with 2-cycle engine lubricant. Permanent damage to engine will result, voiding manufacturer's warranty.
- DO NOT SMOKE** while refuelling or operating equipment.
- DO NOT OPERATE UNIT WITHOUT A MUFFLER** and properly installed muffler shield
- DO NOT TOUCH** or let your hands or body come in contact with the muffler. Hold unit with thumbs and fingers encircling the handles.

- DO NOT OPERATE UNIT IN AWKWARD POSITIONS**, off balance, outstretched arms, or one-handed. Always use two hands when operating unit with thumbs and fingers encircling the handles.
- DO NOT RAISE STRINGHEAD** above ground level while unit is operating. Injury to operator could result.
- DO NOT USE UNIT FOR ANY PURPOSES OTHER** than trimming lawn or garden areas.
- DO NOT OPERATE UNIT FOR PROLONGED PERIODS**. Rest periodically.
- DO NOT OPERATE UNIT WHILE UNDER THE INFLUENCE OF ALCOHOL OR DRUGS**.
- DO NOT OPERATE UNIT UNLESS DEBRIS SHIELD AND/OR GUARD IS INSTALLED AND IN GOOD CONDITION**.
- DO NOT ADD, REMOVE OR ALTER ANY COMPONENTS OF THIS PRODUCT**. Doing so could cause personal injury and/or damage the unit voiding the manufacturer's warranty.
- DO NOT** operate your unit near or around flammable liquids or gases whether in or out of doors. An explosion and/or fire may result.
- DO NOT USE ANY OTHER CUTTING TOOLS**. For your own safety only use the accessories and additional equipment specified in the operating manual or recommended or specified by the manufacturer. The use of tools or accessories other than those recommended in the operating manual or catalogue may place you in danger of personal injury.

2 PROPER OPERATION

The petrol power scythe is intended for private use, i.e. for use in home and gardening environments. The operating instructions as supplied by the manufacturer must be kept and referred to in order to ensure that the petrol power scythe is properly used and maintained. The instructions contain valuable information on operating, maintenance and servicing conditions..



Due to the high risk of bodily injury to the user, the petrol power scythe must not be used to carry out the following work: to clean (suck up) dirt and debris off walkways, or to chop up tree or hedge clippings. Moreover, the petrol power scythe may not be used to level out high areas such as molehills.

For safety reasons, the petrol power scythe may not be used as a drive unit for other work tools or toolkits of any kind.

3 LAYOUT

3.1 Overview

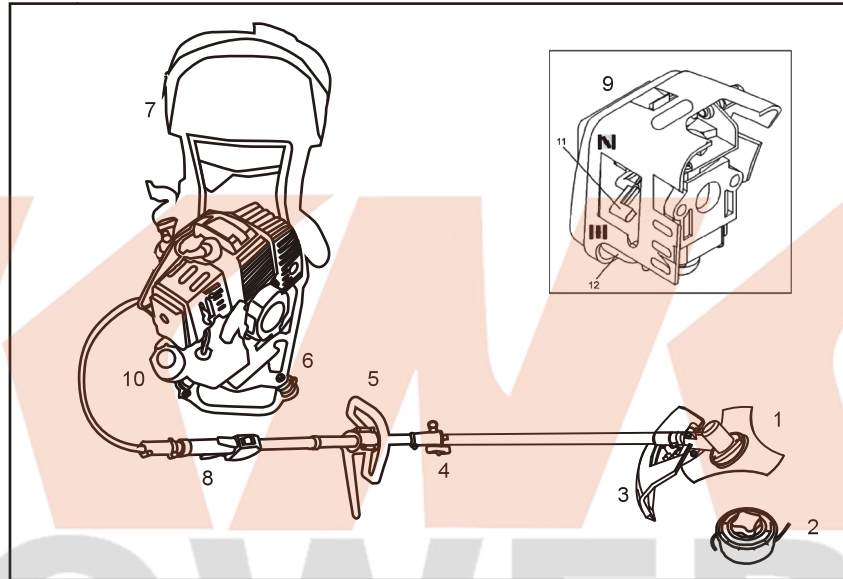

1. Cutting blade
2. Trimmer head
3. Safety shield
4. Pro-fit connector
5. Q handle
6. Metal stand
7. Back pack
8. Carrying strap
9. Air filter cover
10. Petrol tank
11. Levers for "choke" and "run"
12. Petrol accumulation button

3.2 Safety devices

It is important that the GUARD HOOD is assembled in order to prevent injuries to the operator due to objects catapulted by the machine.

4 ASSEMBLING THE COMPONENTS

Some parts of the power scythe come disassembled. For quick and easy assembly, read and follow the instructions below.

4.1 Assembly of the „D“ handle

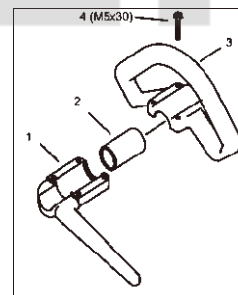

Place the rubber block (2) over the shaft and tighten the upper part (3) and the lower part (1) of the handle with the screws (4).

4.2 Assyblly of the "Q"handle

1. Place the rubber block (3) over the shaft.
2. Tighten the lower part (2) and the middle part (4) by using the four screws (1).
3. Insert the bike-bar (5) and tighten the upper part (6) with the four screws (7).

4.3 Assembly of the guard hood

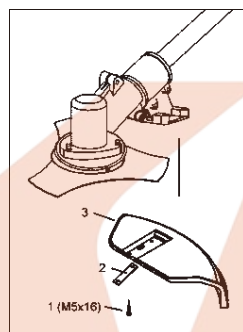

Place the two plates (2) under the safety guard and tighten the guard hood (3) with the four screws (1) to the shaft.

The integrated blade in the guard hood automatically cuts the cutting line to the optimum length.

4.4 Assembly of the cutting head

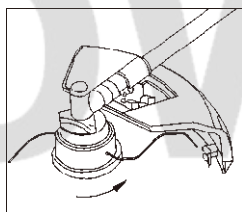

Now put the retainer pin into the cut-out hole and screw the cutting head onto the locating pin of the drive shaft by turning it in counter-clockwise direction (**Important: Left-hand screw-thread!**).

Tighten the cutting head by hand, holding the drive shaft in place with the retainer pin

4.5 Assembly of the cutting blade

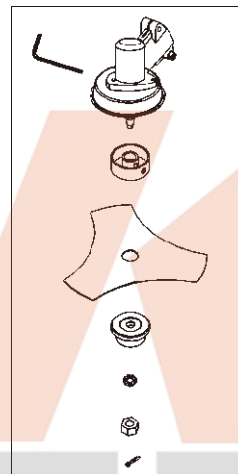

Place the cutting blade on the carrier plate in such a way that the centre of the cutting blade is situated precisely on the guide circle on the carrier plate. Place the pressure plate on the cutting blade ensuring that the flat side points to the cutting blade. Tightly screw the fastening nuts on the locating pin by turning them in counter-clockwise direction (**Important: Left-hand screw-thread!**) Place the retainer pin, as described in the assembly of the cutting head, in the appropriate cut-out hole and use the key. Use safety split pin.

4.6 Setting the cutting height

Shoulder strap:

1. Slip the shoulder strap over the left shoulder.
2. Hook the locking hook into eye.
3. Set the length of the shoulder strap in such a way that the cutting head or the cutting blade runs parallel to the ground. In order to establish the optimum length of the shoulder strap, you should then make a few swinging movements without starting the engine.



Always use the shoulder strap when using the appliance. Attach the strap as soon as you have started the engine and the engine is running in idle mode

Important: Remove the shoulder strap from the appliance before you start the engine.

5 STARTING UP

5.1 Fuel and oil:

1. The engine of the power scythe is a 2-stroke engine. For operation, it requires a mixture of normal unleaded petrol and 2-stroke oil in a ratio of 25:1 (see fuel mixture table).
2. It is advisable to mix a maximum of 5 litres of petrol/oil mixture, since this quantity will give you approx. 12-15 operational hours and an older petrol/oil mixture does not guarantee the optimum level of lubrication.



Never use pure petrol for your appliance. Otherwise there is a danger of causing permanent damage to the engine and as a result the manufacturer's guarantee would not apply. Do not use any petrol/oil mixture which has been kept for longer than 90 days.

Only use a petrol/oil mixture in a mixing ratio of 25:1. Do not change the mixing ratio of your own accord even if some types of 2-stroke oil recommend a different mixing ratio. If insufficient

Fuel mixture table:

Fuel	2-stroke oil
1.2L (1200 cm ³)	0,048L (48 cm ³)
3.6L (3600 cm ³)	0.144L (144 cm ³)
6L (6000 cm ³)	0.24L (240 cm ³)

5.2 Starting the engine:

Important: You must first read the instructions for starting the engine from a cold and a warm state, and then carry out the appropriate start procedure. Place the appliance on a hard, level surface, hold it by the handle with one hand and pull the starting handle on the tension cable with the other hand.

Important: In order to keep the load on the engine as small as possible during start-up and warm-up, cut the excess cutting line back to 13cm.

5.2.1 Starting the engine from a cold state

1. Set the ignition switch (1) to the "Start" position.

2. Secure the throttle lever: Press the "Lock off" switch (2) downward. Then, at the same time, press the throttle lever (3) and slide the locking switch (4). The throttle lever locks into place on full throttle.

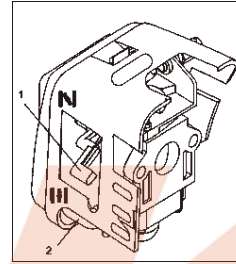

3. The appliance has a choke, which can be set in 2 positions: "CHOKE" (II) and "RUN" (III). Set the choke lever to "CHOKE" (II).
4. For starting purposes, spray fuel into the carburetor. Press the pad ten times.
5. Pull the starting cable out by a short amount, until you feel resistance (approx. 10cm). For a strong ignition spark, a smooth, sharp pull is required. Pull the starting cable four times quickly and forcefully.
6. Set the choke lever to "RUN" (III).
7. If the engine does not start up, repeat steps 1 to 6.

PLEASE NOTE: If the engine does not start up even after several attempts, read the section "Engine Troubleshooting".

PLEASE NOTE: Always pull the starting cable out in a straight line. If it is pulled out at an angle, then friction will occur on the eye. As a result of this friction, the cable will become frayed and will wear away faster. Always hold the starter handle when the cables retract. Never allow the cable to snap back when it has been pulled out. This would fray or wear the cable and also damage the starter unit.

5.2.2 Starting the engine from a warm state

1. Set the ignition switch to the "Start" position.
2. Set the choke lever to the "RUN" (III) position.
3. Lock the throttle lever as described under Point 2 of "Starting the engine from a cold state".
4. Pull the starter cable quickly, until the engine starts up. However, do not pull the cable more than 6 times. Hold down the throttle lever FULLY, until the engine is running quietly. If the engine does not want to start, set the choke to "RUN" (III) and pull 5 more times on the starter cable. However, should the engine not start, then it is probably fully-pumped with petrol. Wait 5 minutes and then try it again with the choke set to "RUN" (III) and with a fully depressed throttle lever.

5.3 To stop engine

Release throttle trigger. Let engine return to idle. Push and hold ignition stop switch until engine stops.

6 TRIMMING INSTRUCTIONS

6.1 Additional safety precautions

Before operating your unit, review ALL SAFETY PRECAUTIONS in this manual.



Warning / Caution

1. **IF UNFAMILIAR WITH TRIMMING** techniques, practice the procedures with ENGINE in "OFF" position.
2. **ALWAYS CLEAR WORK** area of debris such as cans, bottles, rocks, etc. Striking objects can cause serious injury to operator or bystanders and also damage equipment. If an object is accidentally hit, immediately **TURN ENGINE OFF** and examine equipment. Never operate unit with damaged or defective equipment.
3. **ALWAYS TRIM OR CUT AT HIGH ENGINE SPEEDS.** Do not run engine slowly at start or during trimming operations.
4. **DO NOT** use equipment for purposes other than trimming or mowing weeds.
5. **NEVER** raise stringhead above knee height during operation.
6. **DO NOT** operate unit with other people or animals in the immediate vicinity. Allow a minimum of 50 feet (15 meters) between operator and other people and animals when trimming or mowing. Allow a distance of 100 feet (30 meters) between operator and other people and animals when **SCALPING** with stringhead cutter.
7. **IF OPERATING UNIT ON A SLOPE**, stand below the cutting attachment. **DO NOT OPERATE** on a slope or hilly incline if there is the slightest chance of slipping or losing your footing.

6.2 Stringhead line release



DO NOT use steel wire or plastic-coated steel wire of any kind with your stringhead. Serious operator injury can result.

To release fresh line, run engine at full throttle and "bump" stringhead against lawn. Line will automatically release. The knife in debris shield will trim excess line.



Periodically remove weed wrap to prevent overheating the drive shaft. Weed wrap occurs when strands of weed become entangled around the shaft beneath the debris shield. This condition prevents the shaft from being properly cooled. Remove weed wrap with screwdriver or similar.

6.3 Trimming procedures

When properly equipped with a debris shield and stringhead, your unit will trim unsightly weeds and tall grass in those hard-to-reach areas - along fences, walls, foundations and around trees. It can also be used for scalping to remove vegetation down to the ground for easier preparation of a garden or to clean out a particular area.

NOTE: Even with care, trimming around foundations, brick or stone walls, curves, etc., will result in above normal string wear.

TRIMMING / MOWING

Swing trimmer with a sickle-like motion from side to side. Do not tilt the stringhead during the procedure. Test area to be trimmed for proper cutting height. Keep stringhead at same level for even depth of cut.

CLOSER TRIMMING

Position trimmer straight ahead with a slight tilt so bottom of stringhead is above ground level and string contact occurs at proper cutting point. Always cut away from operator. Do not pull trimmer in toward operator

FENCE / FOUNDATION TRIMMING

Approach trimming around chain link fences, picket fences, rock walls and foundations slowly to cut close without whipping string against the barrier. If the string comes in contact with rock, brick walls, or foundations, it will break or fray. If string snags fencing, it will snap off.

TRIMMING AROUND TREES

Trim around tree trunks with a slow approach so string does not contact bark. Walk around the tree trimming from left to right. Approach grass or weeds with the tip of the string and tilt stringhead slightly forward..



Use extreme caution when SCALPING. Keep a distance of 100 feet (30 meters) between operator, other people and animals during these operations

SCALPING

Scalping refers to removal of all vegetation down to the ground. To do this, tilt the stringhead to about a 30 degree angle to the left. By adjusting the handle you will have better control during this operation. Do not attempt this procedure if there is any chance flying debris could injure operator, other people or cause damage to property

6.4 Cutting with blades

Whenever you are cutting with a blade you must wear eye protection and protective clothing. Always use the shoulder strap when working with the blade.



Before you use this machine with a blade, check that it has been fitted correctly. Follow all the instructions according "Safety instructions for undergrowth/grass cutting blades".

WORKING WITH WEED-CUTTING BLADES MOWING WEEDS

Mowing means moving the blade in a horizontal curve from one side to the other. This is very effective for grass-like weeds and small undergrowth. It is not suitable for cutting large, tough weeds or woody vegetation.



Do not use weed-cutting blades for cutting scrub or young trees!

JAMMING

Very thick vegetation, such as young trees or thick scrub may jam the blade and bring it to a standstill. Prevent the blade from jamming by anticipating the direction in which the scrub leans and cut it from the opposite side.

If the blade jams while cutting, switch off the engine immediately. Hold the machine level so that the blade does not jump or break while you push the young tree away from the cut to free the blade.

TO PREVENT RECOIL

When using metal cutting tools (grass blades, thicket knives) there is a risk that the machine will recoil if the tool strikes a solid object (tree trunk, branch, tree stump, stone or the like). In this case the machine will jump backwards in the opposite direction to which the tool is rotating. This may lead to a loss of control of the tool and risk of injury to the user and onlookers.

Do not use metal cutting tools near fences, metal posts, boundary stones or foundations.

The safety blade is designed to reduce recoil if the blade strikes a hard, solid object.

7 MAINTENANCE

7.1 Air filter



Never work without an air filter. Make sure it is always clean. If it is damaged then it must be replaced with a new filter. Empty the petrol tank and pour the fuel into a suitable jerry can. Open the petrol tank slowly so that any potential pressure can be released

Cleaning the air filter:

1. Unscrew the screw with which the air filter cover is secured; remove the cover and lift the filter out of the air inlet.
2. Wash the filter in soapy water. **DO NOT USE ANY PETROL!**
3. Air-dry the filter.
4. Re-insert the filter.

PLEASE NOTE: Replace the filter if it is worn away, torn or damaged, or if it can no longer be cleaned.

7.2 Carburettor adjustment

The carburettor was pre-set at the factory for optimum performance. If further adjustments are necessary, please take your unit to the nearest Authorized Service Centre.

7.3 Spark plug

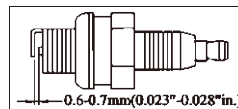

1. Spark plug gap = .025" (.635mm).
2. Torque to 105 to 130 inch pounds (12 to 15 Nm). Connect spark plug boot.

7.4 Debris shield knife sharpening

1. Remove cutter knife from debris shield.
2. Place knife in a bench vise. Sharpen knife using a flat file, being careful to maintain the angle of cutting edge. File in one direction only

8 STORING A UNIT



Failure to follow these steps may cause varnish to form in the carburettor and difficult starting or permanent damage following storage

1. Perform all the general maintenance recommended in the Maintenance Section of your User Manual.
2. Clean exterior of engine, drive shaft assembly, debris shield and stringhead.
3. Drain fuel from the fuel tank.
4. After fuel is drained, start engine.
5. Run engine at idle until unit stops. This will purge the carburettor of fuel.
6. Allow engine to cool (approx. 5 minutes).
7. Using a spark plug wrench, remove the spark plug.
8. Pour 1 teaspoon of clean 2-cycle oil into the combustion chamber. Pull starter rope slowly several times to coat internal components. Replace spark plug.
9. Store unit in a cool, dry place away from any source of ignition such as an oil burner, water heater, etc.
10. Do not transport and store the trimmer with the blade fitted unless the supplied transport guard is also fitted

9 REMOVING A UNIT FROM STORAGE

1. Remove spark plug.
2. Pull starter rope briskly to clear excess oil from combustion chamber.
3. Clean and gap spark plug or install a new spark plug with proper gap.
4. Prepare unit for operation.
5. Fill fuel tank with proper fuel / oil mixture. See Fuel and Lubrication Section

10 TECHNICAL SPECIFICATIONS

Engine Type	2 stroke,air cooled
Mating Engine	1E44F
Displacement	51.7CC
Max Speed	8400r.p.m.(brush cutter)/7600r.p.m.(grass trimmer)
Idling Speed	3000±400 r.p.m
Max output power	1.4Kw
Fuel tank capacity	1.2L
Fuel consumption	615g/kWh
Vibration level for idling	5.0m/s ²
Vibration level for racing	8.0m/s ²
Sound Power Level	114dB(A)

11 TROUBLE SHOOTING THE ENGINE

PROBLEM	PROBABLE CAUSE	CORRECTIVE ACTION
Unit won't start or starts but will not run.	Incorrect starting procedures.	Follow instructions in the User Manual.
	Incorrect carburettor mixture adjustment setting.	Have carburettor adjusted by an Authorized Service Centre.
	Fouled spark plug	Clean / gap or replace plug.
	Fuel filter plugged.	Replace fuel filter.
Unit starts, but engine has low power.	Incorrect lever position on choke.	Move to RUN position.
	Dirty air filter.	Remove, clean and reinstall filter.
	Incorrect carburettor mixture adjustment setting.	Have carburettor adjusted by an Authorized Service Centre.
Engine hesitates.	Incorrect carburettor mixture adjustment setting.	Have carburettor adjusted by an Authorized Service Centre.
No power under load. Runs erratically.	Incorrectly gapped spark plug.	Clean / gap or replace plug.
Smokes excessively. (after approx. 1 min. in full throttle position)	Incorrect carburettor mixture adjustment setting.	Have carburettor adjusted by an Authorized Service Centre.
	Incorrect fuel mixture.	Use properly mixed fuel (25:1 mixture).

INSTRUCTION MANUAL
POLE PRUNER SAW ATTACHMENT
MODEL:KM0408MF005

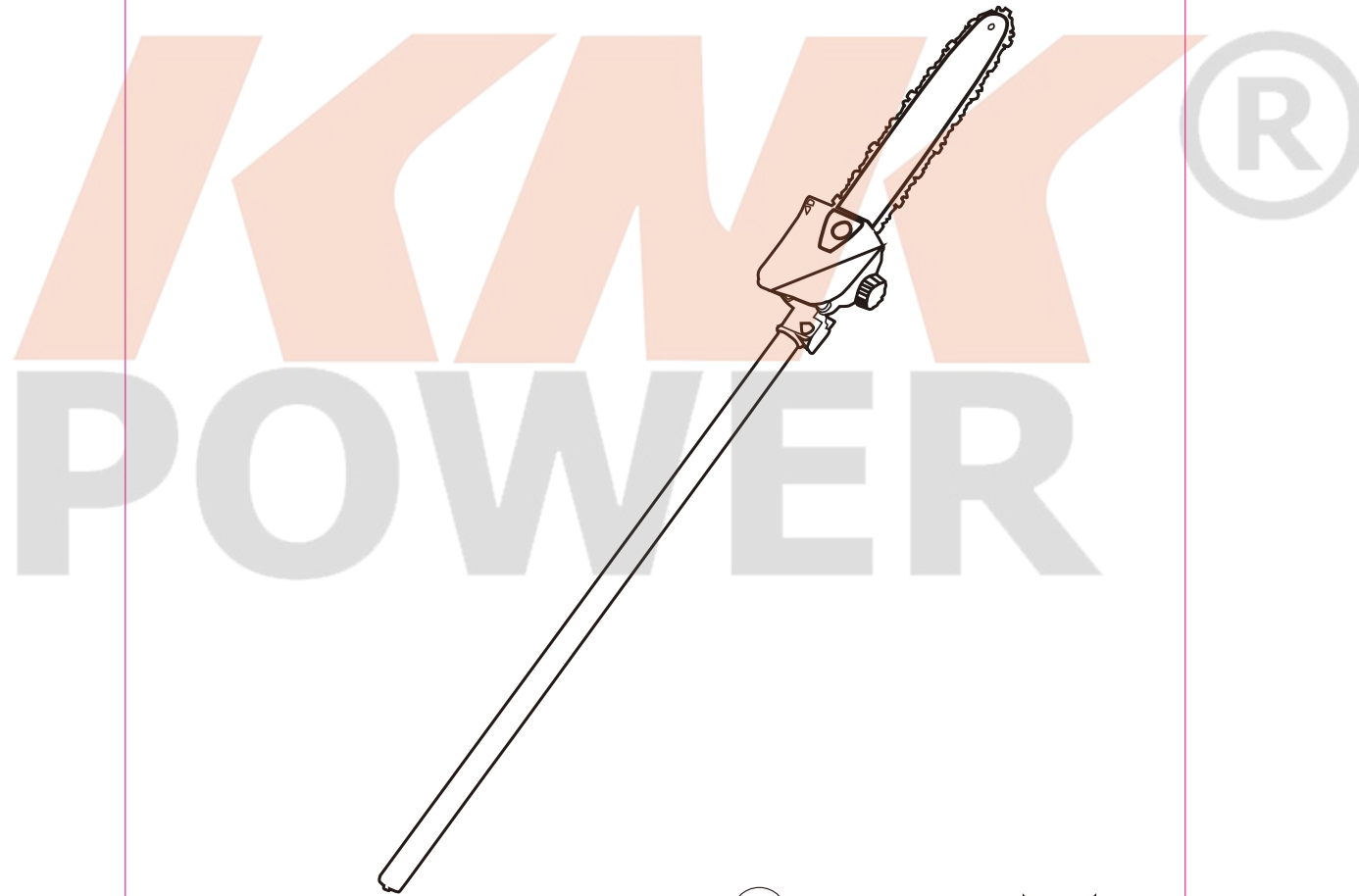

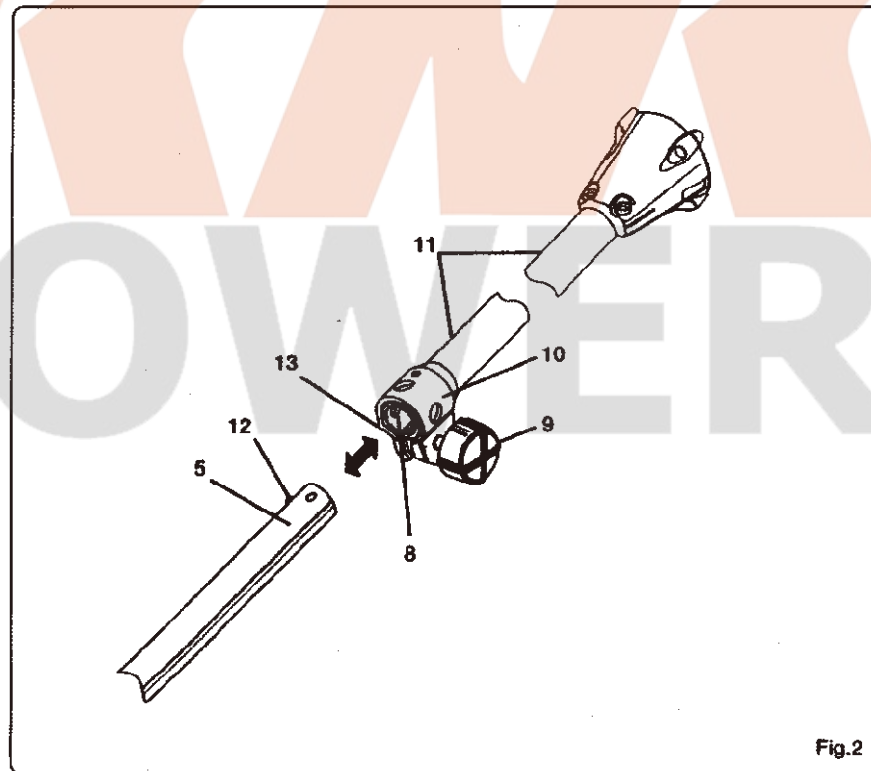
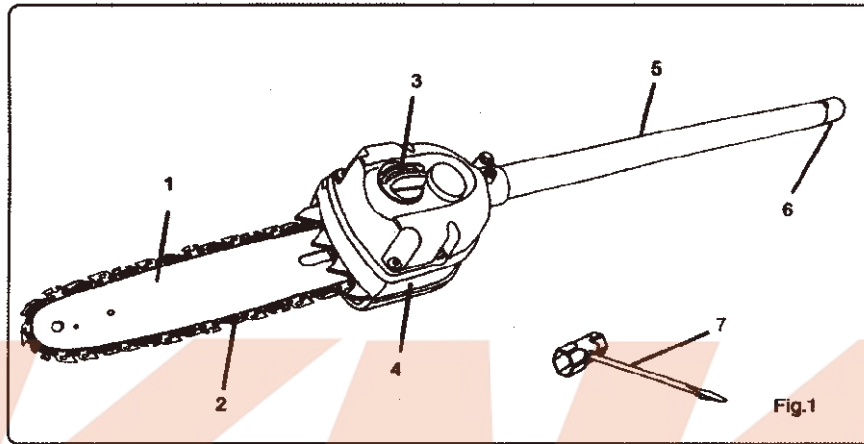

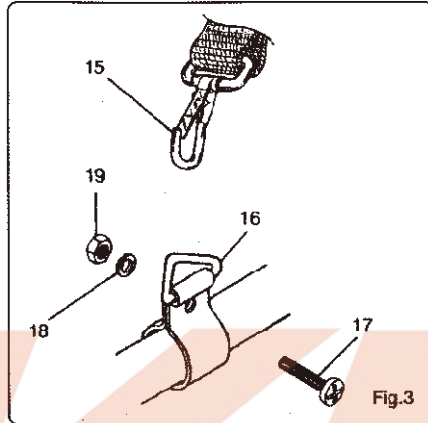

Fig.3

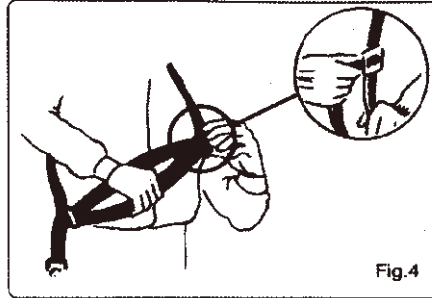

Fig.4

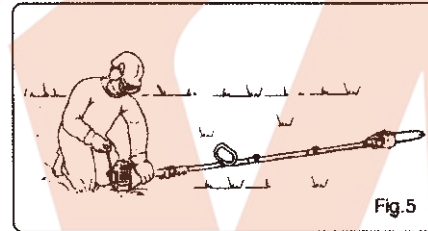

Fig.5

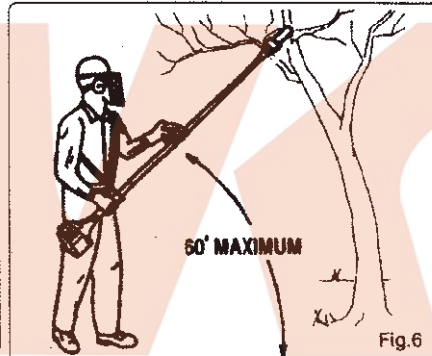

Fig.6

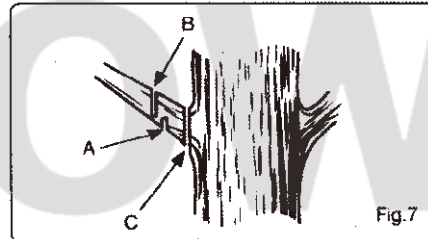

Fig.7

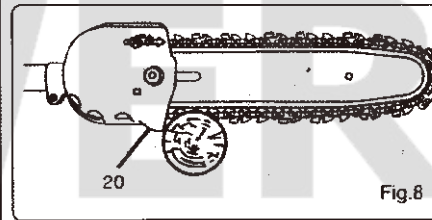

Fig.8

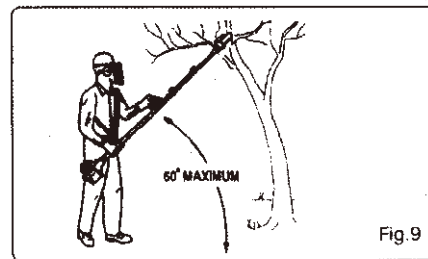

Fig.9

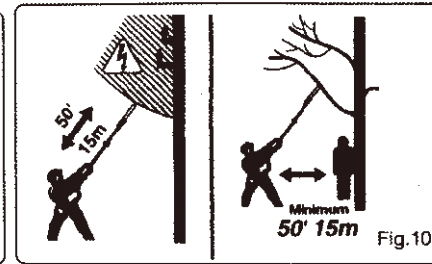
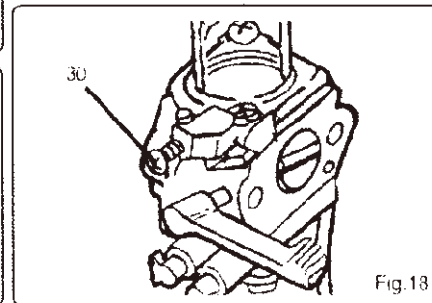
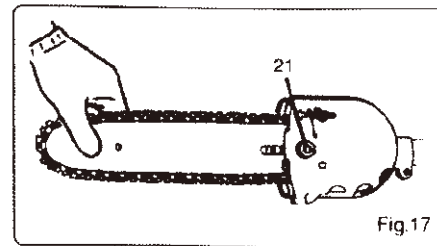
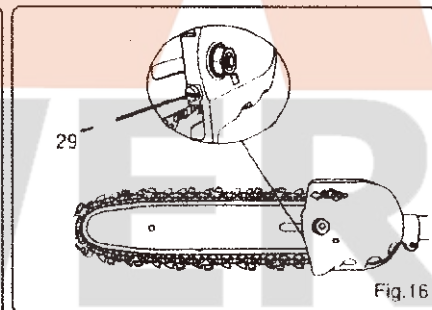
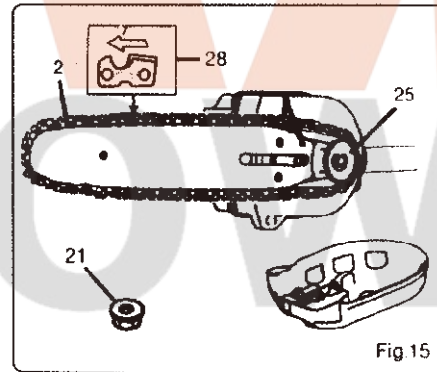
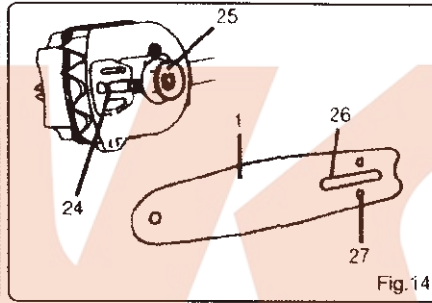
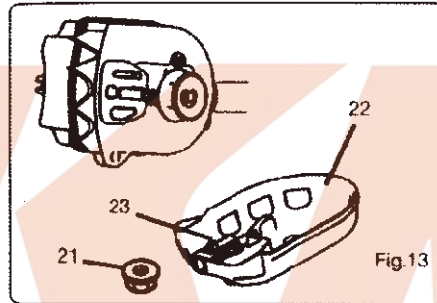
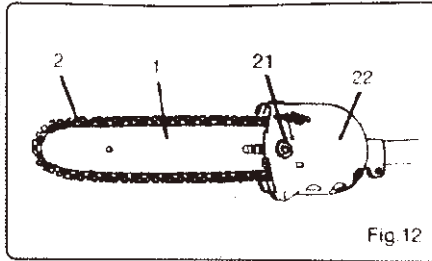
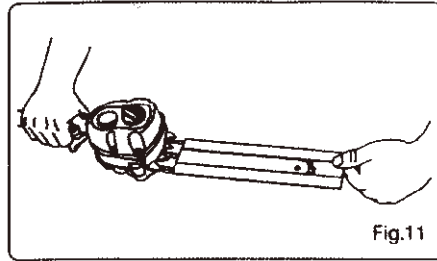

Fig.10



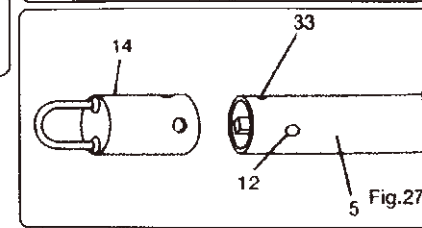
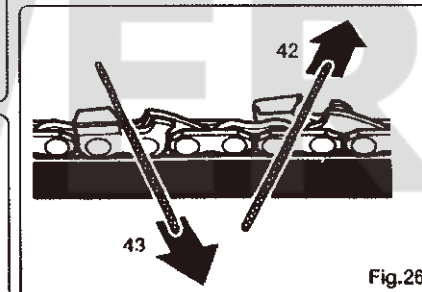
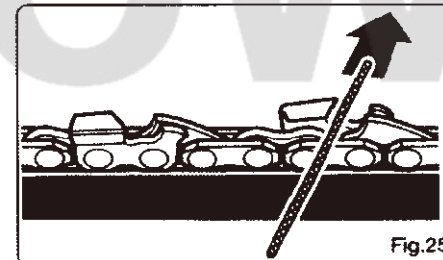
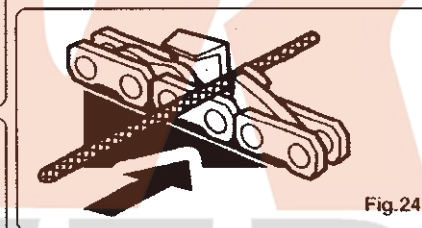
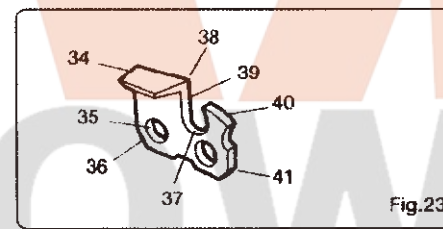
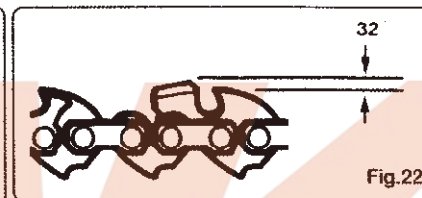
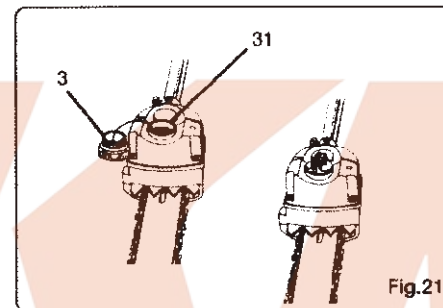
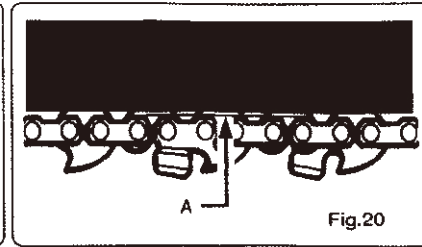
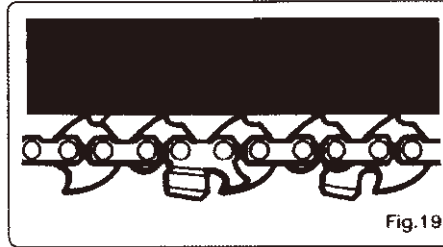
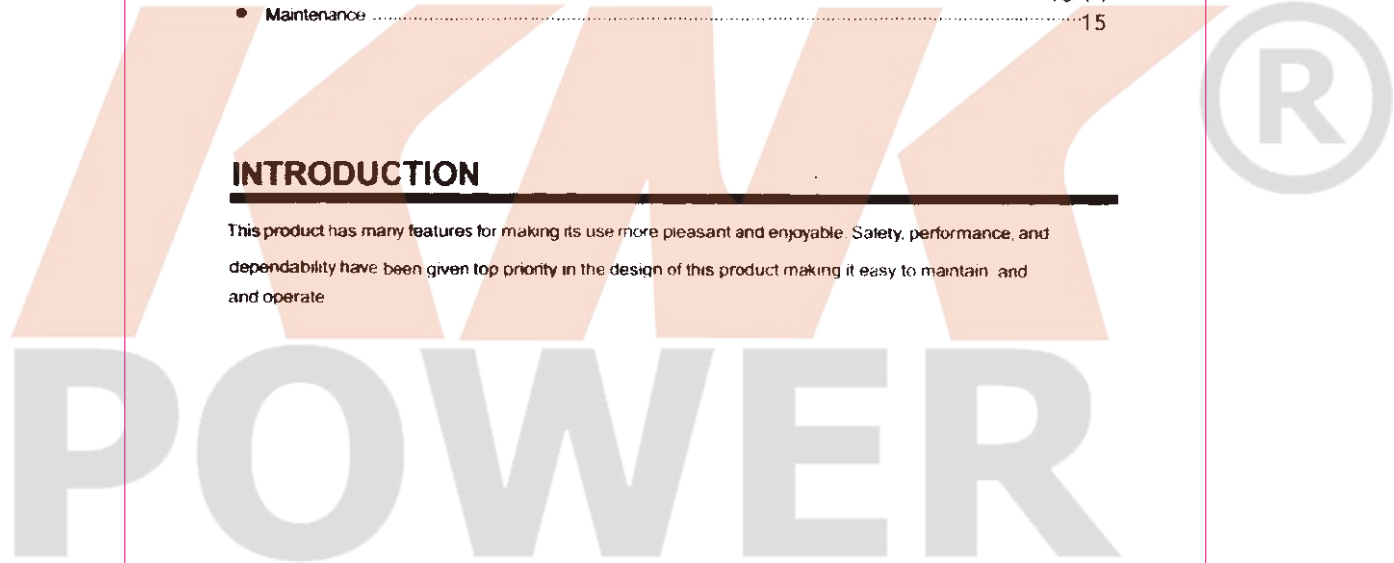

TABLE OF CONTENTS

● Introduction	6
● Safety Rules	7-8
● Symbols	9-10
● Unpacking	11
● Features	11
● Description	11
● Assembly	12
● Operation	13-14
● Maintenance	15

INTRODUCTION

This product has many features for making its use more pleasant and enjoyable. Safety, performance, and dependability have been given top priority in the design of this product making it easy to maintain and operate.



SAFETY RULES

⚠ WARNING:

READ AND UNDERSTAND ALL INSTRUCTIONS. Failure to follow all instructions listed below, may result in electric shock, fire and/or serious personal injury.

SAVE THESE INSTRUCTIONS

GENERAL SAFETY RULES

- For safe operation, read and understand all instructions before using the pruner attachment. Follow all safety instructions. Failure to follow all safety instructions listed below, can result in serious personal injury.
- Do not allow children or untrained individuals to use this unit.
- Wear safety glasses or goggles as well as hearing and head protection when operating this unit.
- Wear heavy long pants, boots, and gloves. Do not wear loose fitting clothing, short pants, jewelry of any kind, or go barefoot.
- Secure long hair so it is above shoulder level to prevent entanglement in any moving parts.
- Keep all bystanders, children, and pets at least 50 ft (15 m) away.
- Do not operate this unit when you are tired, ill, or under the influence of alcohol, drugs, or medication.
- Do not operate in poor lighting.
- Keep firm footing and balance. Do not overreach. Overreaching can result in loss of balance or exposure to hot surfaces.
- Keep all parts of your body away from any moving part.
- Do not touch areas around the muffler or cylinder of the power head, these parts get hot from operation. Failure to do so could result in possible serious personal injury.
- Always stop the engine and remove the spark plug wire or disconnect from power supply before making any adjustments or repairs except for carburetor adjustments.
- Check for damaged parts. Before further use of the appliance, any part that is damaged should be carefully checked to determine that it will operate properly and perform its intended function. Check for alignment of moving parts, binding of moving parts, breakage of parts, mounting, and any other conditions that may affect its operation. A guard or other part that is damaged should be properly repaired or replaced by an authorized service dealer. Following this rule will reduce the risk of shock, fire, or serious injury.

- Use only original manufacturer's replacement parts. Failure to do so, may cause poor performance, possible injury, and will void your warranty.
- Do not, under any circumstance, use any attachment or accessory on this product, which was not provided with the product, or identified as appropriate for use with this product in the Operator's Manual.
- Avoid dangerous environment. Do not use the attachment in damp or wet locations.
- Do not use in rain.
- Use the right attachment, do not use attachment for any job except that for which it is intended.

SPECIFIC SAFETY RULES FOR PRUNER USE

- Kickback is a dangerous reaction that can lead to serious injury. Kickback may occur when the moving chain contacts an object at the upper portion of the tip of the guide bar or when the wood closes in and pinches the saw chain in the cut. Contact at the upper portion of the tip of the guide bar can cause the chain to dig into the object and stop the chain for an instant. The result is a lightning fast, reverse reaction which kicks the guide bar up and back toward the operator. If the saw chain is pinched along the top of the guide bar, the guide bar can be driven rapidly back toward the operator. Either of these reactions can cause loss of saw control which can result in serious injury. Do not rely exclusively upon the safety devices built into your saw. As a chain saw user, you should take several steps to keep your cutting jobs free from accident or injury.
- With a basic understanding of kickback, you can reduce or eliminate the element of surprise. Sudden surprise contributes to accidents.
- Make sure that the area in which you are cutting is free from obstructions. Do not let the nose of the guide bar contact a log, branch, fence, or any other obstruction while you are operating the unit.
- Always cut with the engine running at full speed. Fully squeeze the throttle trigger and maintain a steady cutting speed.
- Follow the sharpening and maintenance instructions for the saw chain.
- Use only the replacement guide bars and low kickback chains specified for your unit.
- Do not force tool. Use the correct tool for your application. The correct tool will do the job better and safer at the rate for which it is designed.
- Do not use on a ladder or unstable support.
- Never let anyone use your machine who has not received adequate instructions in the machine's proper use. This applies to rentals as well as private owned units and also to the power head it is attached to.

SAFETY RULES

- To protect yourself from electrocution, do not operate within 50 feet (15 m) of overhead electrical lines.
- To protect yourself from falling branches, do not stand directly under the branch or limb being cut. This unit should not be held at an angle over 60° from ground level.
- Keep the handles dry, clean, and free of oil or fuel mixture.
- Before you start the engine, make sure the chain is not contacting any object.
- Shut off the engine and make sure the cutting attachment has stopped before setting the unit down.

⚠ WARNING:

This attachment is suitable for use with petrol power heads **ONLY**.

This attachment is **NOT** suitable for use with petrol power heads facilitated by biker handles
Regulations require that any petrol power head used must have a clutch installed.

⚠ WARNING:

Regulations require that any petrol power head used with pole pruners must have a clutch installed.











⚠ WARNING:

Whichever power head you use, ensure the distance between the throttle trigger and the nearest unguarded point of the cutting attachment is at least 1250mm, for your personal safety.

NOTE: National regulations may restrict the use of pole pruners. You should check with your local authorities before using this product.



SYMBOLS

Important: Some of the following symbols may be used on your unit. Please study them and learn their meaning. Proper interpretation of these symbols will allow you to operate the tool better and safer.

SYMBOL	NAME	EXPLANATION
	Safety Alert Symbol	Indicates danger, warning or caution. It means attention!!! Your safety is involved.
	Read Your Operator's Manual	Your manual contains special messages to bring attention to potential safety concerns, machine damage as well as helpful operating and servicing information. Please read all the information carefully to avoid injury and machine damage.
	Wear eye, hearing, and head protection.	Wear eye protection as well as hearing and head protection when operating this equipment.
	Safety footwear.	Wear non-slip safety footwear when using this equipment.
	Wear gloves.	Wear non-slip, heavy-duty protective gloves when handling the pole pruner attachment and the saw chain.
	Moving parts.	Keep hands away from moving parts.
	Keep bystanders away.	Keep all bystanders at least 50 ft. (15 m) away.
	Kickback.	DANGER! Beware of kickback.
	Hot surfaces	Indicates HOT SURFACES. Keep all body parts away from all hot surfaces.
	Risk of Electrocuton	DANGER! Risk of electrocution!

SYMBOLS

The following signal words and meanings are intended to explain the levels of risk associated with this product

SYMBOL	SIGNAL	MEANING
	DANGER:	Indicates an imminently hazardous situation which, if not avoided, will result in death or serious injury.
	WARNING:	Indicates a potentially hazardous situation which, if not avoided, could result in death or serious injury.
	CAUTION:	Indicates a potentially hazardous situation which, if not avoided, may result in minor or moderate injury.
	CAUTION:	(Without Safety Alert Symbol) Indicates a situation that may result in property damage.

SERVICE

Service requires extreme care and knowledge and should be performed only by a qualified service technician. For service we suggest you return the product to your nearest **AUTHORIZED SERVICE DEALER** for repair. When servicing, use only identical replacement parts.

WARNING:

To avoid serious personal injury, do not attempt to operate this product until you read thoroughly and understand completely the operator's manual. Save this operator's manual and review frequently for continuing safe operation and instructing others who may use this product.

SAVE THESE INSTRUCTIONS

POWER

UNPACKING

INSTRUCTIONS

We have shipped the Pruner Attachment completely assembled.

- Carefully remove the tool from the box. Make sure that all items listed in the packing list are included.
- Inspect the tool carefully to be sure no breakage or damage occurred during shipping.
- Do not discard the packing material until you have carefully inspected and satisfactorily operated the tool.

WARNING:
If any parts are missing, replace them before operating the tool. Failure to do so could result in serious personal injury.

FEATURES

Before attempting to use this product, familiarize yourself with all operating features and safety rules (See Fig.1)

WARNING: Do not allow familiarity with your tool to make you careless. Remember that a careless fraction of a second is sufficient to inflict severe injury

WARNING: Do not attempt to modify this tool or create accessories not recommended for use with this tool. Any such alteration or modification is misuse and could result in a hazardous condition leading to possible serious personal injury.

DESCRIPTION

- | | |
|---|-------------------------------|
| 1. Bar (254mm) | 23. Chain tensioning pin |
| 2. Chain (10", 3/8" pitch, 0.05" gauge) | 24. Bar stud |
| 3. Chain oiler tank cap | 25. Sprocket |
| 4. Gear case | 26. Bar stud slot |
| 5. Pruner attachment shaft | 27. Chain tensioning pin hole |
| 6. End cap | 28. Chain rotation |
| 7. Combination wrench | 29. Chain tensioning screw |
| 8. Positioning hole | 30. Idle speed screw |
| 9. Knob | 31. Chain oiler tank |
| 10. Coupler | 32. Depth gauge setting |
| 11. Power head shaft | 33. Hanger hole |
| 12. Button | 34. Top plate |
| 13. Guide recess | 35. Rivet hole |
| 14. Hanger cap | 36. Heel |
| 15. Shoulder strap clip | 37. Gullet |
| 16. Strap hanger | 38. Cutting corner |
| 17. Bolt | 39. Side plate |
| 18. Lock washer | 40. Depth gauge |
| 19. Nut | 41. Toe |
| 20. Cutting guide | 42. Left hand cutters |
| 21. Bar nut | 43. Right hand cutters |
| 22. Drive case cover | |

ASSEMBLY

JOINING THE POWER HEAD TO THE PRUNER ATTACHMENT *(See Figure 2.)*

WARNING:
Never attach or adjust any attachment while power head is running. Failure to stop the engine may cause serious personal injury.

The pruner attachment (5) connects to the powerhead, by means of a coupler device.

1. Loosen the knob (9) on the coupler (10) of the power head shaft (11) and remove the end cap (6) from the attachment shaft (5).
2. Push in the button (12) located on the attachment shaft. Align the button with the guide recess (13) on the power head coupler and slide the two shafts together. Rotate attachment shaft until button locks into the positioning hole (8).
3. Tighten the knob (9) securely.

NOTE: If the buttons do not release completely in the positioning holes, the shafts are not locked into place. Slightly rotate from side to side until the button is locked into place.

NOTE: The pole pruner attachment should only be operated with the blade in a vertical position. Use only the specified positioning hole for this pole pruner attachment.

WARNING:
Be certain the knob is fully tightened before operating equipment; check it periodically for tightness during use to avoid serious injury.

OPERATION

POSITION FOR STARTING

(See Fig 5.)

Lay the pole pruner on the ground and ensure that no objects or obstructions are in the immediate vicinity. Make sure nothing can come in contact with the bar and chain.

WARNING:
To avoid kickback, binding of the saw bar, and possible injury, never cut limbs that the pole pruner does not reach when supported by the shoulder strap.

PREPARATION FOR CUTTING

PROPER GRIP ON HANDLES

CHAIN OILER

Add bar and chain oil in the chain oiler tank (3) before starting the engine of the power head.

REMOVING THE ATTACHMENT FROM THE POWER HEAD

For removing or changing the attachment:

1. Loosen the knob.
2. Push in the button and twist the shafts to remove and separate ends.

INSTALLING THE SHOULDER STRAP AND HANGER

(See Figures 3 and 4.)

When operating this unit, you must wear the shoulder strap supplied to support the unit.

1. Pull strap hanger (16) apart and place over power head end of shaft, position near the upper knob.
2. Install bolt (17), lock washer (18), and nut (19). Tighten nut securely.

NOTE: Check for tightness before each use to avoid serious injury or product damage.

3. Place shoulder strap over your left shoulder and attach clip (15) to strap hanger.
4. Shoulder strap can be adjusted by sliding the clip up or down.
5. When properly adjusted, the power head should be supported by the shoulder strap about hip level.

NOTE: The shoulder strap supplied is fitted with a quick release mechanism, so that the shoulder strap and the pruner can be removed quickly in the event of an emergency.

Refer to the "Important Safety Instructions" earlier in this manual, for appropriate safety equipment.

- Wear non-slip gloves for maximum grip and protection.
- Maintain a proper grip on the unit whenever the engine is running. Use your right hand to firmly grip the rear handle while your left hand has a firm grip on the front handle.
- Hold the unit firmly with both hands. Always keep your left hand on the front handle and your right hand on the rear handle, so that your body is to the left of the chain line.
- Never use a left-handed (cross-handed) grip, or any stance which would place your body or arm across the chain line. *(See Fig 6.)*

OPERATION

- Never stand directly under the limb you are cutting. (See Fig 6.)
- Always wear shoulder strap for increased safety and to support the pole pruner.

BASIC CUTTING PROCEDURE

- Accelerate the engine to full throttle just before entering the cut by squeezing the throttle trigger.
- **DO NOT** use a back and forth sawing type motion for cutting.
- The following steps should be followed to prevent damage to tree or shrub bark. (See Fig 7.)
 1. The first cut should be a shallow cut (1/4 of the limb diameter) on underside of limb close to main limb or trunk (A).
 2. The second cut should be made from the top side of the limb outboard from first cut (B).
 3. Make the final cut close to trunk (C).

WARNING:

To prevent possible serious injury to yourself or to others, READ, understand, and follow all instructions in this Operator's Manual.

- Keep the engine at full throttle the entire time you are cutting.
- For second and final cuts (from top of limb or branch), hold the front cutting guide (20) against the limb being cut. See Fig 8. This will help steady the limb and make it easier to cut.
- Allow the chain to cut for you; exert only light downward pressure. If you force the cut, damage to the bar, chain, or engine can result.
- Release the trigger as soon as the cut is completed, allowing the engine to idle. If you run the pole pruner at full throttle without a cutting load, unnecessary wear or damage can occur to the chain, bar, and engine.

WORK AREA PRECAUTIONS

- Cut only wood or materials made from wood; no sheet metal, no plastics, no masonry, no non-wood building materials.
- Never allow children to operate your pole pruner. Allow no person to use this pole pruner who has not read this Operator's Manual and received adequate instructions for the safe and proper use of this pole pruner.
- Keep everyone - helpers, bystanders, children, and animals a safe distance, of at least 50 ft. (15 m), from the cutting area.
- Always cut with both feet on solid ground to prevent being pulled off balance.
- Cut only when visibility and light are adequate for you to see clearly.

LIMBING AND PRUNING

This unit is designed for limbing small branches and limbs up to 6 in. (15 cm) in diameter.

- Plan the cut carefully. Be aware of the direction in which the branch will fall.
- Branches may fall in unexpected directions. Do not stand directly under the branch being cut.
- The most typical cutting application is to position the unit at an angle of 60° or less, depending on the specific situation. (See Figure 9.)
- As the angle of the pole pruner shaft to ground increases, the difficulty of making the first cut (from the underside of limb) increases. Failure to follow procedure shown in Figure 7 will result in the bar and chain binding and becoming pinched or trapped in the limb. If this should happen:
 1. Stop the engine of the power head.
 2. With engine stopped, loosen the knob on coupler.
 3. Depress the button on the shaft, twist and pull the shafts to separate the pruner from the engine.
 4. If the limb can be reached from the ground, lift the limb while holding the attachment. This should release the "pinch" and free the pruner.
 5. If pruner is still trapped, call a professional for assistance.
- The long reach of the unit allows the operator to prune branches or limbs that are normally out of reach.
- Long branches should be removed in several stages.
- Cutting lower branches first will allow the top branches more room to fall.
- Work slowly, keeping both hands on the saw with a firm grip.
- Maintain secure footing and balance.
- Keep the tree between you and the chain while limbing. Cut from the side of the tree opposite the branch you are cutting.
- Do not cut from a ladder, this is extremely dangerous.
- Leave this operation for professionals.
- **DO NOT** use for felling or bucking.
 - When pruning trees it is important not to make the flush cut next to the main limb or trunk until you have cut off the limb further out to reduce the weight. This prevents stripping the bark from the main member. Under cut the the branch 1/4 way through for your first cut, your second cut should an over cut to drop the branch off. Now make your final cut smoothly and neatly against the main member so the bark will grow back to seal the wound. (See Fig 7.)
- Keep all bystanders at least 50 ft. (15 m) away. To prevent electrocution, do not operate within 50 feet (15 m) of overhead electrical lines. See Figure 11.

Under-Cut

Begin on the under side of the limb with the top of the pruner against the limb; exert light pressure upward. During underbucking, the pruner will tend to push back at you. Be prepared for this reaction and hold the pruner firmly to maintain control.

Over-Cut

Begin on the top side of the limb with the bottom of the

OPERATION

pruner against the limb, exert light pressure downward. Note that the pruner will tend to pull away from you.

WARNING:
prevent electrocution, do not operate within 50 (15 m) of overhead electrical lines. (See Fig 11.)

WARNING:
Keep all bystanders at least 50 ft. (15 m) away. (See Figure 11.)

WARNING:
Never climb into a tree to limb or prune. Do not stand on ladders, platforms, a log or in any position which can cause you to lose your balance or control of the unit.

MAINTENANCE

- Never operate a unit that is damaged, improperly adjusted, or is not completely and securely assembled. Be sure that the saw chain stops moving when the trigger is released. If the chain moves at idle speed, the carburetor may need adjusting, refer to "Maintenance-Trimmer Engine - Idle Speed Adjustment" later in this manual. If the chain still moves at idle speed after adjustment has been made, contact a service dealer for adjustment and discontinue use until the repair is made.
- Always stop the engine and remove the spark plug wire or disconnect from power supply before making any adjustments or repairs except for carburetor adjustments.
- Inspect unit before each use for loose fasteners, fuel leaks and damaged parts. Replace any parts that are cracked, chipped, or damaged in any way. Failure to do so can cause serious injury.
- Make sure all handles are properly and securely attached.
- Never modify the unit in any way. Do not use for any purpose except that for which it is intended.
- Keep all safety devices in place when using this machine. Failure to do so can cause serious injury.

WARNING:
Use only the manufacturer's replacement parts. Failure to do so may cause poor performance, possible injury and may void your warranty.

- Before storing the unit, allow the engine to cool. Always place the sheath on the saw bar when transporting or storing your pole pruner. The sheath is a snug fit and must be attached very carefully due to the sharp teeth on the saw chain. This is best done by grasping the sheath at one end, in the center portion of the sheath, and carefully sliding it over the chain. Use caution to avoid the sharp teeth of the chain. (See Fig 11.)

WARNING:
To avoid possible serious injury, stop engine before replacing the bar, chain, or performing any maintenance operation.

(See Figures 12 and 13.)

1. Remove the bar nut and drivecase cover, using the combination wrench provided.
2. The bar contains a bar stud slot that fits over the bar stud. The bar also contains a chain tensioning pin hole which fits over the chain tensioning pin.

(See Figures 14 and 15.)

3. Place the bar onto the bar stud so that the chain tensioning pin fits into the chain tensioning pin hole.
 4. Fit the chain over the sprocket and into the bar groove. The cutters on the top of the bar should face toward the bar tip, in the direction of the chain rotation.
 5. Replace the side case cover and install the bar nut. Tighten the bar nut finger tight only, the bar must be free to move for tension adjustment.
 6. Remove all slack from chain by turning the chain tensioning screw (29) clockwise, assuring that the chain seats into the bar groove during tensioning. See (Figure 16.)
 7. Lift the tip of the bar up to check for sag. Release the tip of the bar, and turn the chain tensioning screw 1/2 turn clockwise. Repeat this process until sag does not exist.
 8. Hold the tip of the bar up and tighten the bar nut securely. See (Figure 17.)
 9. Chain is correctly tensioned when there is no slack on the underside of the bar, the chain is snug, but it can be turned by hand without binding.
- NOTE:** If chain is too tight, it will not rotate. Loosen the bar nut slightly and turn adjusting screw 1/4 turn counterclockwise. Lift the tip of the bar up and retighten bar nut.

MAINTENANCE

WARNING:
 Check the chain tension frequently when operating the unit. Never touch or adjust the chain while the engine is running. The chain is very sharp, always wear protective gloves when performing maintenance to the chain.

TRIMMER ENGINE - IDLE SPEED ADJUSTMENT (See Fig. 18.)

If the chain turns at idle, the idle speed screw needs adjusting on your trimmer engine. Turn the idle speed screw counterclockwise to reduce the idle RPM and stop the chain movement. If the saw chain still moves at idle speed, contact a service dealer for adjustment and discontinue use until the repair is made.

WARNING:
 The saw chain should never turn at idle. Turn the idle speed screw "T" counterclockwise to reduce the idle RPM and stop the chain, or contact a service dealer for adjustment and discontinue use until the repair is made. Serious personal injury may result from the saw chain turning at idle.

CHAIN TENSION

WARNING:
 To avoid possible serious injury, never touch or adjust the chain while the motor is running. The saw chain is very sharp, always wear protective gloves when performing maintenance to the chain.

1. Stop the engine before setting the chain tension. Make sure the guide bar nut is loose to finger tight, turn the chain tensioning screw clockwise to tension the chain. Refer to "Replacing the Bar and Chain" for additional information. A cold chain is correctly tensioned when there is no slack on the underside of the guide bar, the chain is snug, but it can be turned by hand without binding.
2. Chain must be re-tensioned whenever the flats on the drive links hang out of the bar groove. (See Fig. 19.)
3. During normal operation, the temperature of the chain will increase. The drive links of a correctly tensioned warm chain will hang approximately .050 in. (1.25 mm) out of the bar groove. (See Fig. 20.)

NOTE: New chain tends to stretch; check chain tension frequently and tension as required.

CAUTION:
 Chain tensioned while warm, may be too tight upon cooling. Check the "cold tension" before next use.

CHAIN OILER

1. Use Premium Bar and Chain Oil. It is designed for chains and chain oilers and is formulated to perform

over a wide temperature range with no dilution required.

2. Remove the cap and carefully pour approximately 8 oz. (237 cc) of the bar and chain oil into the chain oiler tank (31). (See Fig. 21.)
3. Replace the cap and tighten securely.
4. Check and refill the chain oiler tank every time the engine is fueled.

NOTE: Do not use dirty, used or otherwise contaminated oils. Damage may occur to the oil pump, bar, or chain.

CHAIN MAINTENANCE

Use only the replacement low kickback chain specified for your unit.

For smooth and fast cutting, the chain needs to be maintained properly. The chain requires sharpening when the wood chips are small and powdery, the chain must be forced through the wood during cutting, or the chain cuts to one side. During maintenance of your chain, consider the following.

- Improper filing angle of the side plate can increase the risk of a severe kickback.
- Depth gauge (or raker clearance) setting (32) determines the height the cutter enters the wood and the size of the wood chip that is removed. Too much clearance increases the potential for kickback. Too little clearance decreases the size of the wood chip thus decreasing the chain's cutting ability. (See Figure 22.)
- If cutter teeth have hit hard objects such as nails and stones, or have been abraded by mud or sand on the wood, have service dealer sharpen chain.

How to Sharpen the Cutters (See Figure 23.)

Be careful to file all cutters to the specified angles and to the same length, as fast cutting can be obtained only when all cutters are uniform.

1. Tighten the chain tension enough that the chain does not wobble. Do all of your filing at the mid-point of the bar. Wear gloves for protection.
2. Use a 5/32 in. (4.5mm) diameter round file and holder.
3. Keep the file level with the top plate of the tooth. Do not let the file dip or rock. See (Figure 24.)
4. Using light but firm pressure, stroke towards the front corner of the tooth. Lift file away from the steel on each return stroke. (See Figure 25.)
5. Put a few firm strokes on every tooth. File all left hand cutters (42) in one direction. Then move to the other side and file the right hand cutters (43) in the opposite direction. Occasionally remove filings from the file with a wire brush. (See Figure 26.)

CAUTION:
 Dull or improperly sharpened chain can cause excessive engine speed during cutting which may result in severe engine damage.

INSTRUCTION MANUAL
HEDGE TRIMMER ATTACHMENT
MODEL:KM0408MF004

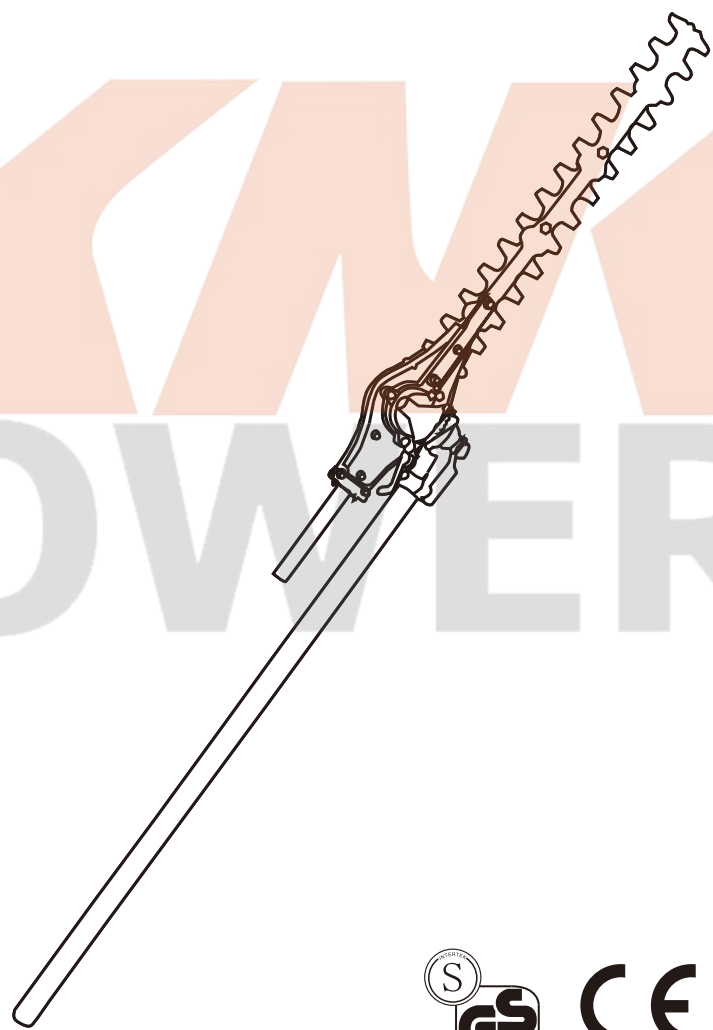
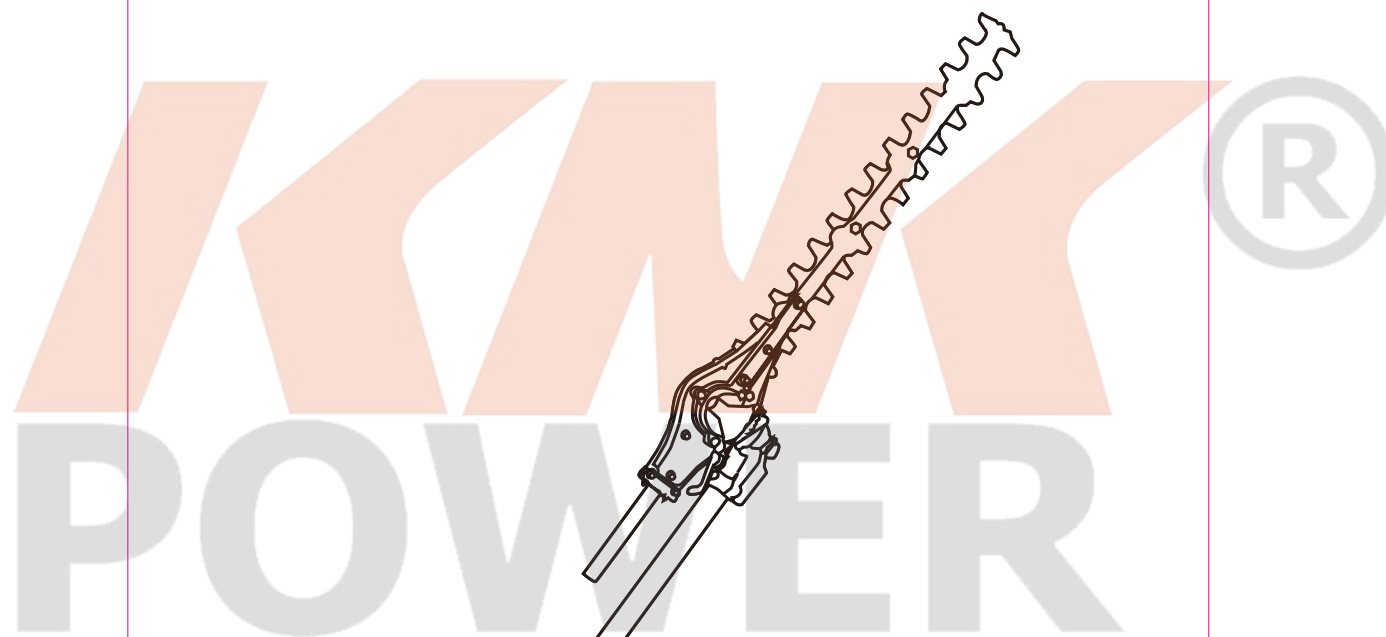

SAFE RULES

▲ WARNING:

Do not operate this product indoors or in inadequately ventilated areas. Engine exhaust contains poisonous emissions and can cause serious injury or death

Provide Safety and Operating Instructions To All Operators

1. Provide all users of this equipment with the Operator's Manual and Safety Manual for instructions on Safe Operation
2. Review area to be trimmed. Look for hazards that could contribute to unsafe conditions. DO NOT operate unit if any wires (power, telephone, cable, etc) are closer than 15m (50ft) to any part of the operator or unit.
3. Before starting the unit, equip yourself and any other person working within the 15m(50ft) Safety Zone with the required protective equipment and clothing.



Keep a Solid Stance

Maintain footing and balance at all times. Do not stand on slippery, uneven or unstable surfaces. Do not work in odd positions or on ladders. Do not over reach

Keep a Firm Grip

Hold the front and rear handles with both hands, with thumbs and fingers tightly encircling the handles



Only Make Cutting Angle adjustments With Unit Off And On Flat Ground

Only adjust cutting blade angle with unit flat on the ground. With the engine stop switch in the "STOP" position. Never Adjust cutting angle with unit standing upright.

gear box assembly when using unit or

Avoid Contact With Gear Box Assembly During Use

Gear box assembly becomes hot during use. Avoid contact with gearbox assembly when using unit or making cutting angle adjustments.

DESCRIPTION

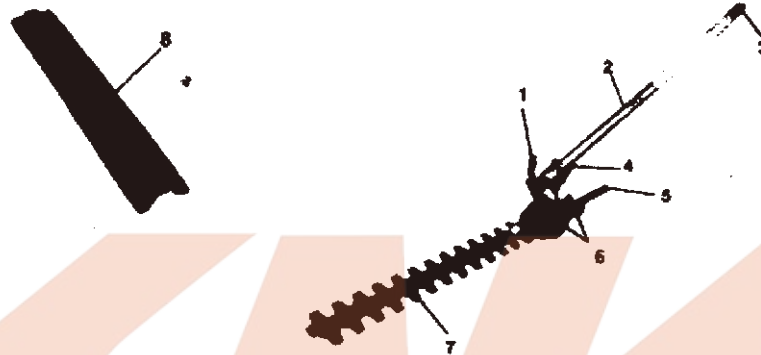

The product you have purchased has been factory pre-assembled for your convenience

1. **GEAR ADJUSTMENT LEVER** - This lever does not secure gear box angle setting. Lever must be aligned with drive Shaft (tight position) to remove internal gear play before operating Hedge Clipper Attachment.
2. **LOWER DRIVE SHAFT ASSEMBLY** - Includes the Gear Housing assembly, Flexible Drive Cable, Blade and Safety Decals.
3. **FLEXIBLE DRIVE CABLE** - Cable end fits into upper drive shaft coupler. Lubricate drive cable every 25 hours with Grease.
4. **INDEXING LEVER** - Spring loaded lever that engages with a notch every 15 degrees, from the straight (in line with shaft tube) position to right angle with the shaft tube.
5. **ATTACHMENT HANDLE** - For convenience and safety of operator when changing the blade angle.
6. **GREASE FITTINGS** - Grease gear case every 15-20 hours of operation or on a weekly schedule.
7. **CUTTING BLADES** - Double reciprocating blades mounted to a blade support bar. Double sided blades, are capable of cutting on either side of the blade.
8. **BLADE COVER** - Used to cover blades during transport and storage. Remove blade cover before operating unit.

SPECIFICATIONS

ASSEMBLY

POWER HEAD SHAFT/LOWER SHAFT ASSEMBLY

1. Set Power Head/Shaft Assembly on a level surface.
2. Pull locator pin (A) out, and turn counter-clockwise 1/4 turn to lock-out position.
3. Carefully fit attachment drive shaft assembly into Coupler (B) to decal assembly line (C), making sure that the inner lower drive shaft engages into the square upper drive shaft socket.

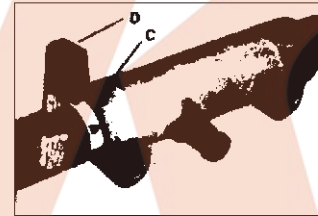
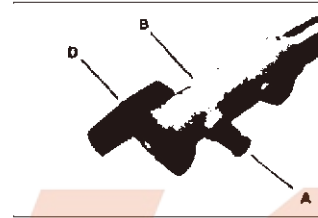

▲ NOTE:

Earlier model Power Heads may have shorter couplings. Short couplings fit flush to decal point (E). New couplings are 4-3/4 in. long, and fit flush to line (C). Lower bearing housing and head assembly must be in line with the engine.

4. Rotate locator pin (A) 1/4 turn clockwise to engage lower shaft hole. Insure locator pin is fully engaged by twisting lower drive shaft. Locator pin should snap flush in coupler. Full engagement will prevent further shaft rotation.
5. Secure lower shaft assembly to coupler by tightening clamping Knob (D).

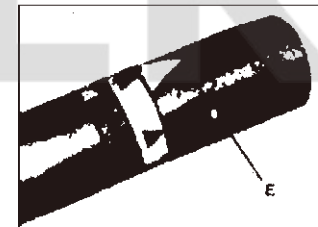

OPERATION

▲ NOTE:

All over head electrical conductors and communications wires can have electricity flow with high voltages. Never touch wires directly or indirectly when pruning, otherwise serious injury or death may result.

ADJUSTING CUTTING ANGLE

1. Place unit on a flat, clear area. Make sure stop switch is in the "STOP" position.
2. Move gear tension release lever (A) to "up" position.
3. Grip hedge clipper shaft at gear box.
4. Grip rear handle of cutter assembly, and hold securely.
5. Depress blade indexing lever (B) to release cutter assembly.
6. Adjust cutter assembly angle to desired position, and release indexing lever into notch.
7. Move gear tension release lever (A) to full "down" position.

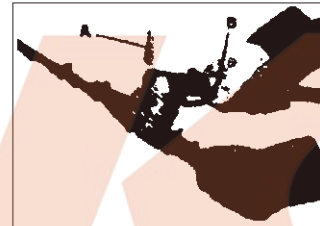

▲ IMPORTANT:

DO NOT tighten gear tension release lever nut (C) to secure angle setting of gear box. Damage to gear will result. Adjust nut ONLY if gear tension release lever is too loose, or too tight. Tighten nut for snug 90° movement.



▲ WARNING :

Gear Case Assembly becomes HOT during use. Always grip assembly at back rear handle when making cutting angle adjustments, otherwise serious injury may result.

▲ WARNING :

DO NOT stand hedge clipper on end when adjusting cutting angle, other wise serious injury may result.

MAINTENANCE

MAINTENANCE INTERVALS

<u>Component/System</u>	<u>maintenance Procedure</u>	<u>frequency</u>
Cutting Blades	Oil/Clean	Before each use
Drive Shaft	Grease	Every 25 hours of use
Gear Housing	Grease	Every 15-25 hours of use
Screws/Nuts/Bolts	Inspect/Tighten/Replace	Before each use

▲ WARNING :

Hedge Clipper Blades are very sharp. Wear gloves to protect hands, otherwise serious personal injury may result.

LUBRICATION

Blades

1. Brush loose debris from blade and coat both sides of blade with the 50-50 cleaning mixture.
2. Allow cleaning mixture to soften the remaining gummy residue then wipe it from the blade.
3. Apply clean oil to the entire length of the blade. Be certain the blade bolts are lubricated.
4. Wipe excess oil from the blade before putting the unit back in service.
5. Check blade tightness. Tighten blade bolts (A) until snug with 10mm wrench. Loosen bolts 1/2 turn. Hold bolts (A) from turning and tighten locknuts (B) with other 10 mm wrench.

▲ WARNING:

Always disconnect spar plug wire before servicing cutting Attachment. Blades are very sharp. Wear gloves to protect hands, otherwise serious personal injury may result.

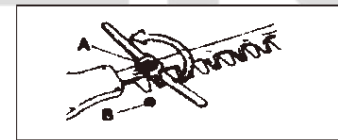
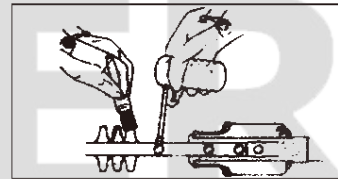

Gear Housing

1. Clean dirt from grease fittings (A).
2. Carefully pump grease in each fitting. **DO NOT** force grease. Too much pressure will force grease past seals and cause damage. Apply 1-2 pumps of grease every 15-25 hours of operation.



Drive Shaft (Lower)

1. Carefully remove locating screw and washers (A) to avoid loss of blade indexing lever spring (B), and loosen clamping screw (C). Remove the flex drive shaft assembly from the gear housing.
2. Pull the drive shaft (D) from the drive shaft assembly, and wipe clean. Re-coat with a thin coating [1/2 oz.(15ml)] of grease.
3. Slide the flex shaft back into the drive shaft assembly, being careful not to get dirt on the flex shaft.

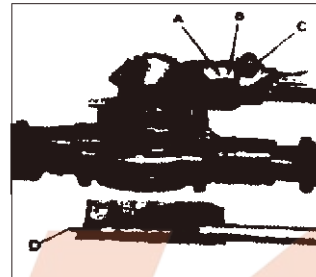

NOTE: Install drive shaft in gear case to provide desired blade adjustment Direction.

4. Align the locating screw hole in gear case with the locating hole in drive shaft assembly, and install and tighten locating screw with washers (A), and tighten clamping screw (C).

SHARPENING BLADES

NOTE: Blades are very sharp. Wear gloves to protect hand.

1. Use screwdriver to separate upper and lower cutters equal distance apart.
2. File each edge carefully. Follow the original shape of the blade.
3. Lubricate cutting blades, see "Blade lubrication Instruction", Page 7 this section

**WARNING:**

If a power grinder is used **DO NOT** allow blade to over head.

STORAGE

1. Clean and lubricate cutting blades and gear case.
2. Sharpen cutting blades as required.
3. Install blade cover onto hedge clipper cutting blades.
4. Store hedge clipper attachment in a dry, dust free place in a Horizontal position, out of the reach of children.

**IMPORTANT:**

Always store and transport hedge clippers in a stable, horizontal position. Support gear case and cutting blade to prevent excessive flexing which may cause damage to the cutting attachment. Always install blade cover when transporting or storing unit.