

# EXHAUST CUT-OUT KITS

3

This Product is **ILLEGAL** for Street or Off Highway use and is only intended for Closed Course Competition use, Except for 1965 and older US Manufactured, California Certified vehicles; 1967 and older US Manufactured, Federal Certified vehicles, or 1967 and older Foreign Manufactured vehicles, which may have this product installed as long as the vehicle still meets emissions standards for the year of the vehicle and retains any original or retrofit emissions control devices, including EGR, A.I.R and any NOx device required for the year of the vehicle.

## Installation Instructions

EXHAUST CUT-OUTS are relatively easy to install. Some fabrication is required but no welding is necessary.

Raise and support your vehicle and compare your exhaust system with Figure 1. This is a typical installation, but because exhaust systems differ greatly, it is up to you to determine the best position for the Cut-Outs to be installed.

### **Ground Clearance**

Mount the Cut-Outs with adequate ground clearance. They should not drag over speed bumps or while loading and unloading a trailer.

Figure 1

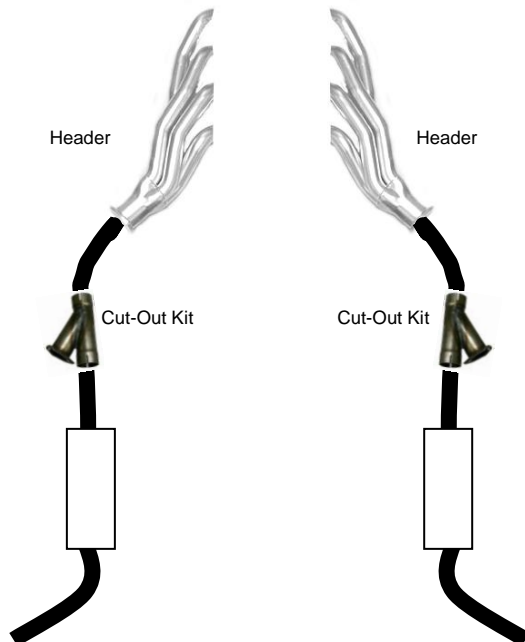

Figure 2



### **Cut-Out Kits:**

H1128	Pair	2 1/4"
H1129	Single	2 1/4"
H1130	Pair	2-1/2"
H1131	Single	2-1/2"
H1132	Pair	3"
H1133	Single	3"
H1134	Pair	3-1/2"
H1135	Single	3-1/2"

### **⚠ WARNING:**

This product can expose you to chemicals including Lead, Nickel, Cadmium and Chromium which are known to the State of California to cause cancer and birth defects or other reproductive harm. For more information go to [www.P65Warnings.ca.gov](http://www.P65Warnings.ca.gov)