

Using the **NATURE'S HEAD**[®] Self-Contained Composting Toilet



Open the lid.
Please be seated for all usage.

URINATION

Make sure trap door is **CLOSED**
(lever on the left side)

Go

Spritz the bowl with water

Close the lid

DEFECATION

Make sure trap door is **OPEN**
(lever on left side)

Go

Spritz any residue with water

Close the lid

Turn the agitator handle **SLOWLY**
for 3 or 4 revolutions

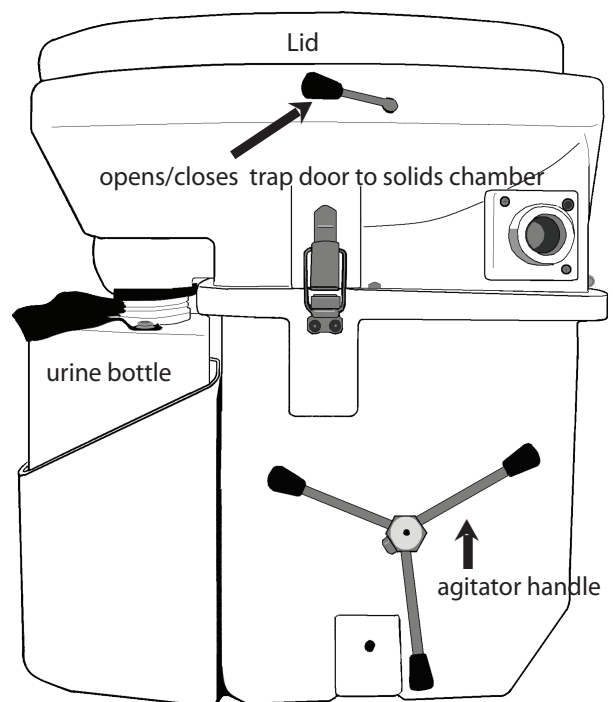

Check with hosts to get instructions on toilet paper disposal.
Do not place sanitary items or wipes in the solids bin.



SAVING OUR WATER FOR TOMORROW[®]

© 2018 Nature's Head, Inc