

NOTES: **BILL OF MATERIAL (CURRENT LEVEL)**

ITEM	PT/ASSY	DESCRIPTION	TYPE	QTY.
1	02528	CABLE CLAMP KIT	BULK ITEM	1
2	09022	LOGO PLATE W STUDS	ASSEMBLY	1
3	09520	T2 GEARBOX ASSEMBLY	ASSEMBLY	2
4	09538	LED LIGHT	ASSEMBLY	2
5	09551	T2 TRACK SPARE PARTS KIT	PART	1
6	09590	T2V2 LAZY SUSAN	ASSEMBLY	1
7	09724	T2 LIGHT KIT	ASSEMBLY	1
8	09829	T2 ALL-IN-ONE PC BOARD	ASSEMBLY	1
9	09857	(PAIR) T2 LEVER ADJ RAIL ASM	ASSEMBLY	1
10	09888	T2V2 BATTERY COVER ASM	ASSEMBLY	2
11	09923	T2 AUTO ADJ TRACK	ASSEMBLY	2
12	09929	T2V2 WELDED SHROUD	ASSEMBLY	1
13	09965	T2V2/T1.5 V2 RADIO W LIGHTS 2017	ASSEMBLY	1
14	09969	T2 DUAL LIFTER LATCH ASSMEBLY	ASSEMBLY	1
15	22422	TUG SHAFT RETAINER	PART	2
16	22596	T2 SERVO CAM	PART	1
17	22604	T2 TRACK STANDOFF	PART	24
18	22958	6" TRACK PIN	PART	2
19	23145	COVER MOUNT BAR	PART	3
20	23465	T2 AUTO MAIN PLATE	PART	1
21	23466	T2 MOTOR PLATE	PART	2
22	23559	7 TOOTH T2 DRIVE SPROCKET	PART	4
23	23642	T2 V2 MOTOR SPACER	PART	2
24	23712	MP GLIDE SHAFT 1/4" OD X 1" L	PART	6
25	23713	ACETAL WASHER 1/4" ID X .050" THICK	PART	12
26	23757	T1.5V2 PCB SUPPORT	PART	2
27	92039	PUSH MOUNT CABLE TIE	PART	8
28	92266	10-24 X 7/8" L SS CAP SCREW	PART	2
29	92361	4-40X5/16"L FLAT HD SCW, PHIL	PART	2
30	92524	8-32 UNC X 1/8 SET SCREW	PART	2
31	92542	1/4-20 X .500"L SET SCREW SS	PART	24
32	93547	RACHET TOOL, 3/8" DRIVE	BULK ITEM	1
33	93548	DEEP SOCKET, SIZE 7/16" DRIVE 3/8"	BULK ITEM	1
34	93549	T1.7 MOTOR COVER	PART	2
35	93554	M3 X 0.5MM, 8MM L FLAT HEAD SCREW	PART	12
36	93555	M3 X 0.5MM, HEX NUT	PART	8
37	93557	T2V2 SHROUD END LEFT	PART	1
38	93558	T2V2 SHROUD END RIGHT	PART	1
39	93560	#4, 1/4" L SELF-TAPPING SCREW	PART	8

40	94050	BEARING 5/8" OD FOR 1/4" SHAFT	PART	6
41	95003	1/4"-20 X 3/4" FLAT HEAD	PART	6
42	95016	1/4"-20 X 5/8" SOCKET CAP	PART	6
43	95017	1/4"-20 X 1/2" SOCKET CAP	PART	26
44	95026	1/8" SQ. X .400"L KEY STOCK	PART	4
45	95073	10-32 X 1/4"L FLAT HEAD SCREW	PART	8
46	95092	10-32 X 3/8" FLAT HEAD	PART	2
47	95158	1/4" X .125" NYLON SPACER	PART	8
48	95175	1/4"-20 X 3/8"L PAN HEAD	PART	6
49	95234	1/4"-20 X 5/8" LOW HD CAP SCW	PART	16
50	95294	ROTOCLIP DTX-4	PART	4
51	95308	BALL BEARING 1-3/8" OD 5/8" SHAFT	ASSEMBLY	4
52	95340	3/8"-16 X 1-1/4" CAP SCREW	PART	16
53	95350	8.25 EXTENSION	BULK ITEM	1
54	95366	WIRE EXTENSION CLIP	BULK ITEM	1
55	95368	1/8" SQ. X .250"L KEY STOCK	PART	4
56	95385	T2 INSIDE COVER (AUTO ADJ)	PART	2
57	95386	T2 OUTSIDE COVER	PART	2
58	95391	T2 AUTO ADJ TUG OWNERS MANUAL	PART	1
59	95394	29.2V POWER SUPPLY 7A	PART	1
60	95396	T2 RAIL END COVER	PART	4
61	95415	1/4"-20 X 1/2" L PAN HEAD	PART	4
62	95463	SS THIN NYLON-INSERT LOCK NUT	PART	2
63	95503	24V 20AH BATTERY	PART	2
64	95553	SPEED CONTROL 2020	PART	4
65	95554	#4-24 THRD-FORM SCREW FOR PLASTIC	PART	16
66	95624	10-32 X 3/8" PHILLIPS SCREW, THREAD LOCK PART	PART	24
67	97021	6-32X3/8"L PHILIPS SCREW	PART	4
68	93553A	SS MAGNETIC LATCH	PART	4
69	93553B	93553 SS MAGNET STRIKE PLATE	PART	4

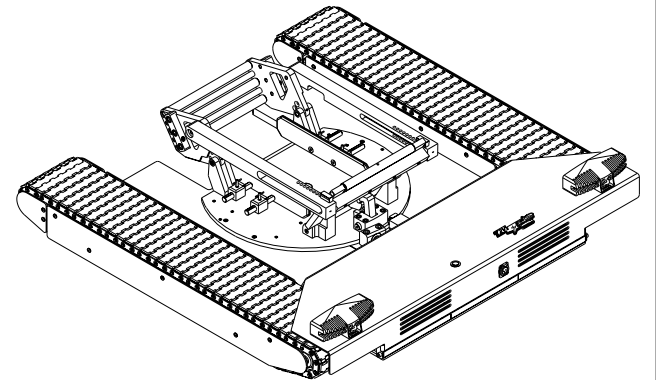

**ACAIR Technology**

13832 MAGNOLIA AVE.  
CHINO, CA 91710-7027  
855-884-7222

T2 V2 TUG W LIGHTS

ASSY. NO **09922**

U

SCALE 0.060

REF. -

SHEET 1 OF 11

NOTES:

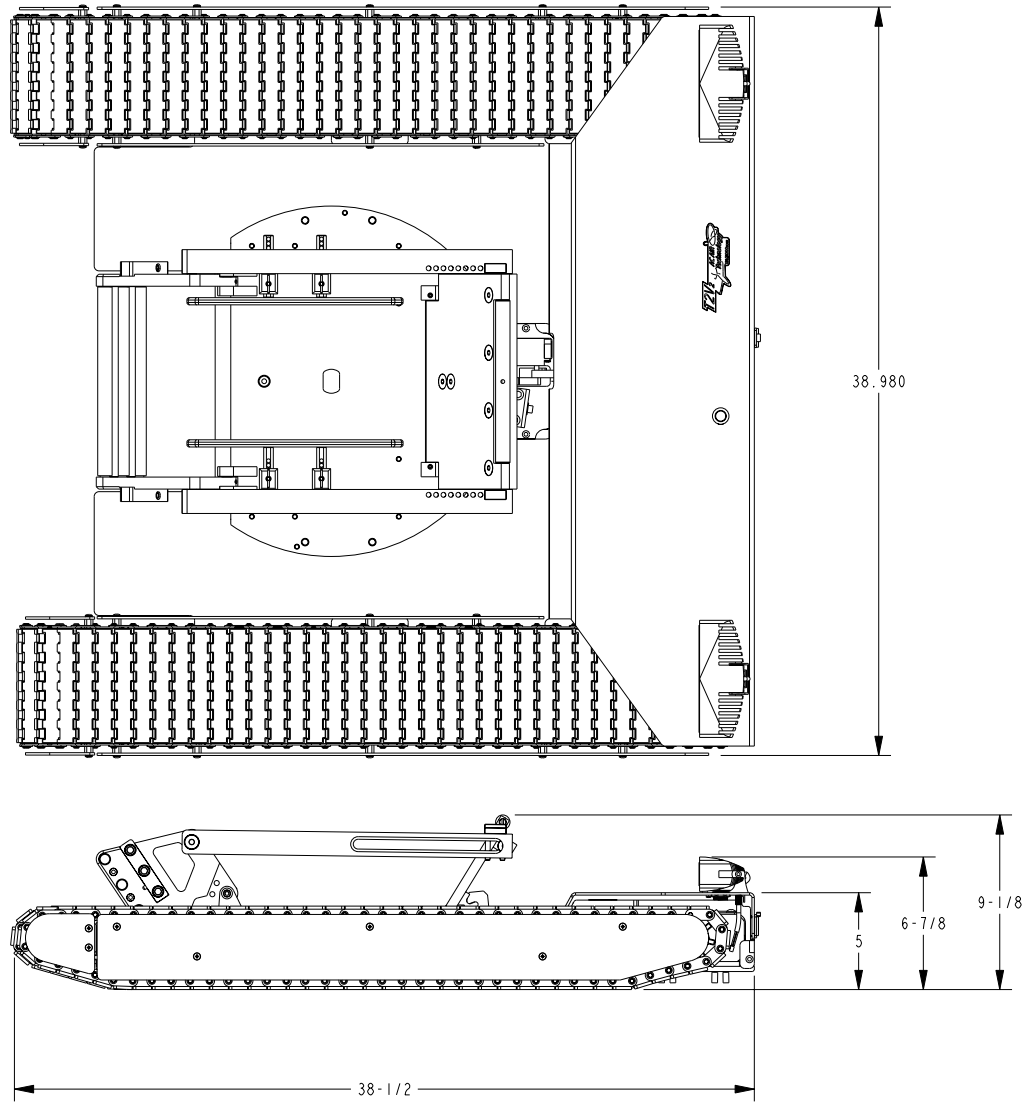

**ACAIR  
Technology**

13832 MAGNOLIA AVE.  
CHINO, CA 91710-7027  
855-884-7222

T2 V2 TUG W LIGHTS

ASSY. NO. 09922

U

SCALE 0.100

REF. -

SHEET 2 OF 11

NOTES:

 BLUE REMOVABLE LOCTITE

**BILL OF MATERIAL (CURRENT LEVEL)**

ITEM	PT/ASSY	DESCRIPTION	TYPE	QTY.
1	09520	T2 GEARBOX ASSEMBLY	ASSEMBLY	2
2	09969	T2 DUAL LIFTER LATCH ASSMEBLY	ASSEMBLY	1
3	22596	T2 SERVO CAM	PART	1
4	23145	COVER MOUNT BAR	PART	3
5	23465	T2 AUTO MAIN PLATE	PART	1
6	23466	T2 MOTOR PLATE	PART	2
7	23712	MP GLIDE SHAFT 1/4" OD X 1" L	PART	6
8	23713	ACETAL WASHER 1/4" ID X .050"	THICK	12
9	93560	#4, 1/4" L SELF-TAPPING SCREW	PART	8
10	94050	BEARING 5/8" OD FOR 1/4" SHAFT	PART	6
11	95016	1/4"-20 X 5/8" SOCKET CAP	PART	6
12	95017	1/4"-20 X 1/2" SOCKET CAP	PART	24
13	95234	1/4"-20 X 5/8" LOW HD CAP SCW	PART	16
14	93553B	93553 SS MAGNET STRIKE PLATE	PART	4

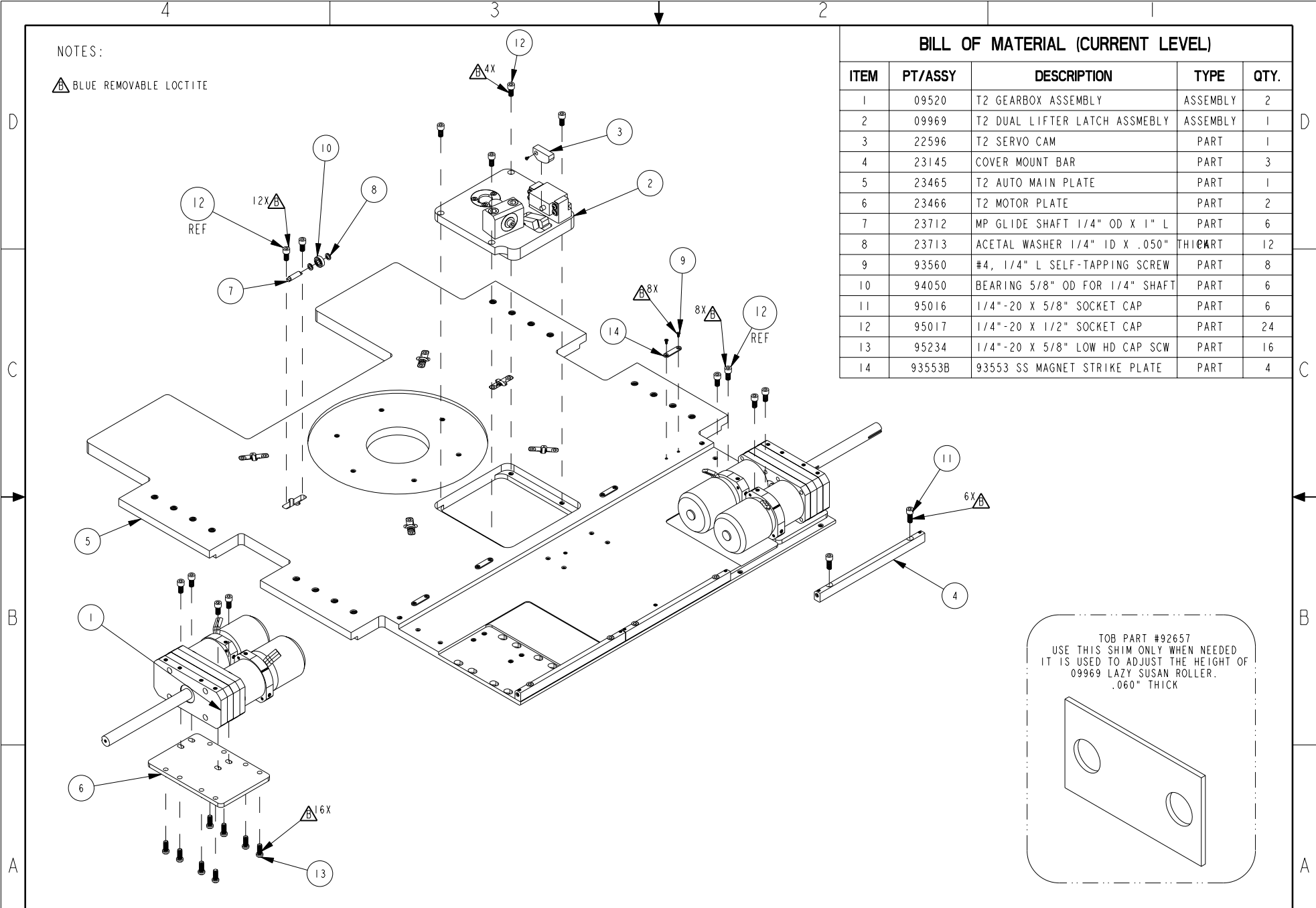

**ACAIR  
Technology**

13832 MAGNOLIA AVE.  
CHINO, CA 91710-7027  
855-884-7222

T2 V2 TUG W LIGHTS

ASSY. NO. 09922

U

SCALE 0.140

REF. -

SHEET 3 OF 11

NOTES: **BILL OF MATERIAL (CURRENT LEVEL)**

ITEM	PT/ASSY	DESCRIPTION	TYPE	QTY.
1	09829	T2 ALL-IN-ONE PC BOARD	ASSEMBLY	1
2	23757	T1.5V2 PCB SUPPORT	PART	2
3	92039	PUSH MOUNT CABLE TIE	PART	8
4	92266	10-24 X 7/8" L SS CAP SCREW	PART	2
5	93549	T1.7 MOTOR COVER	PART	2
6	95158	1/4" X .125" NYLON SPACER	PART	8
7	95415	1/4"-20 X 1/2" L PAN HEAD	PART	4
8	95553	SPEED CONTROL 2020	PART	4
9	95554	#4-24 THRD-FORM SCREW FOR PLASTICPART	PART	16
10	97021	6-32X3/8"L PHILIPS SCREW	PART	4

 BLUE REMOVABLE LOCTITE

ADD HOT GLUE TO 95553 SPEED CONTROL HOLES BEFORE TIGHTENING 95554 SCREWS

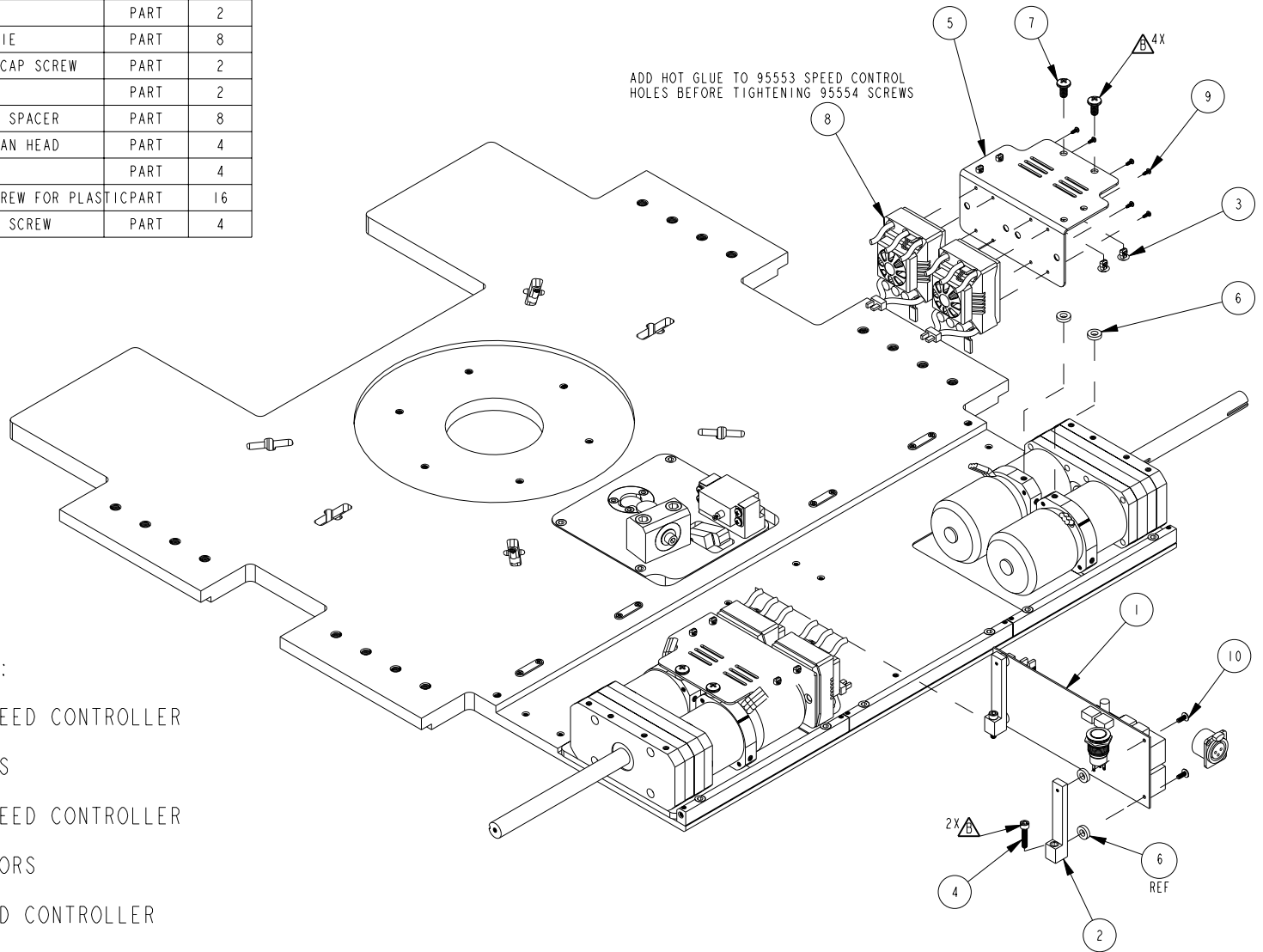

T2V2 WIRE CONNECTION:

ORANGE WIRES FROM SPEED CONTROLLER  
CONNECT TO  
RED WIRES FROM MOTORS

YELLOW WIRES FROM SPEED CONTROLLER  
CONNECT TO  
BLACK WIRES FROM MOTORS

BLUE WIRES FROM SPEED CONTROLLER  
CONNECT TO  
YELLOW WIRES FROM MOTORS

**ACAIR  
Technology**

13832 MAGNOLIA AVE.  
CHINO, CA 91710-7027  
855-884-7222

T2 V2 TUG W LIGHTS

ASSY. NO. 09922

U

SCALE 0.170

REF. -

SHEET 4 OF 11

NOTES:

▲ BLUE REMOVABLE LOCTITE

▲ LOCTITE JOINT (GREEN)

BILL OF MATERIAL (CURRENT LEVEL)

ITEM	PT/ASSY	DESCRIPTION	TYPE	QTY.
1	09857	(PAIR) T2 LEVER ADJ RAIL ASM	ASSEMBLY	1
2	22422	TUG SHAFT RETAINER	PART	2
3	23559	7 TOOTH T2 DRIVE SPROCKET	PART	4
4	23642	T2 V2 MOTOR SPACER	PART	2
5	95026	1/8" SQ. X .400"L KEY STOCK	PART	4
6	95092	10-32 X 3/8" FLAT HEAD	PART	2
7	95308	BALL BEARING 1-3/8" OD 5/8" SHAFT	ASSEMBLY	4
8	95340	3/8"-16 X 1-1/4" CAP SCREW	PART	16
9	95368	1/8" SQ. X .250"L KEY STOCK	PART	4

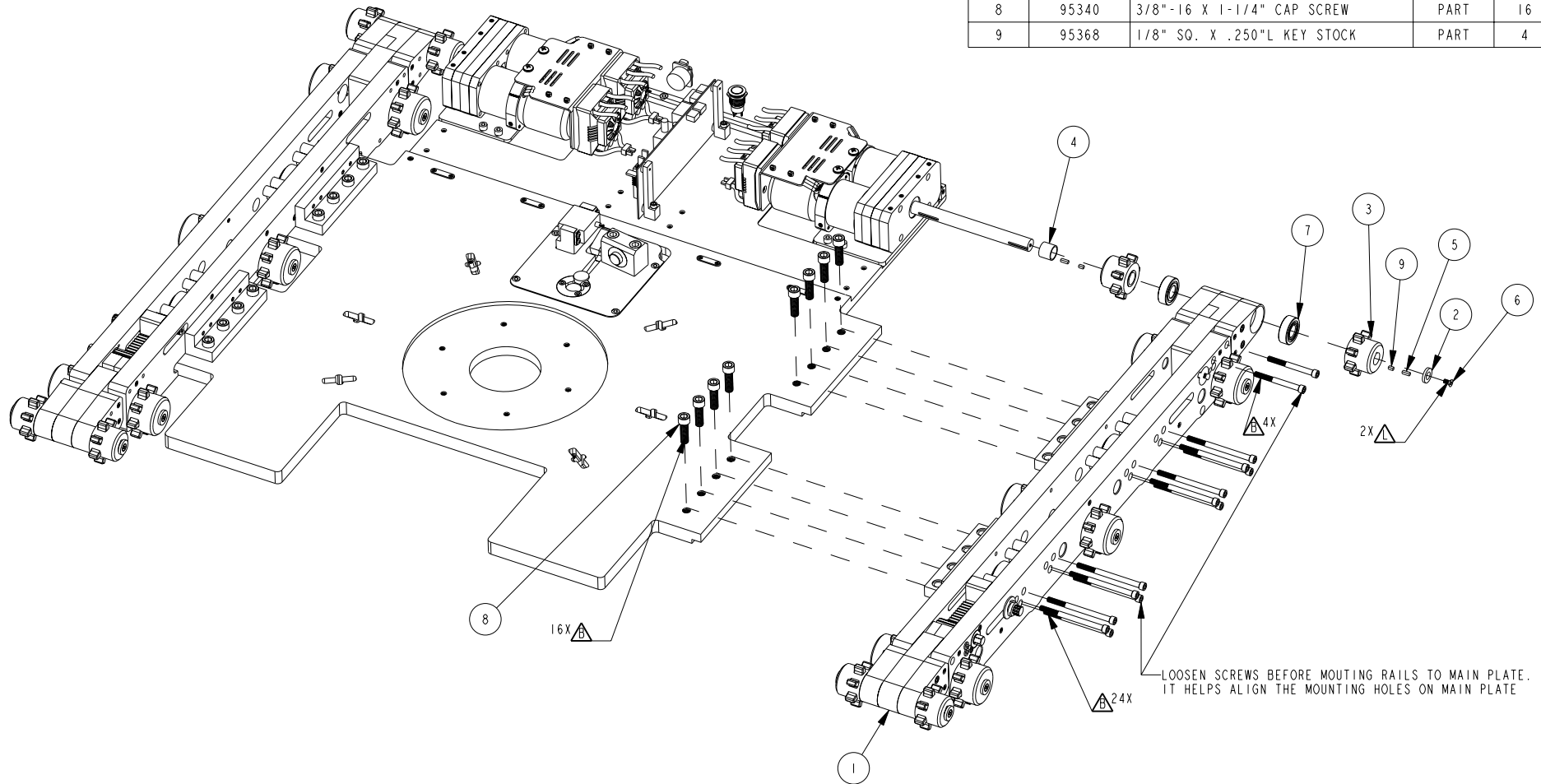

**ACAIR**  
Technology

13832 MAGNOLIA AVE.  
CHINO, CA 91710-7027  
855-884-7222

T2 V2 TUG W LIGHTS

ASSY. NO. 09922

U

SCALE 0.130

REF. -

SHEET 5 OF 11

NOTES:

 BLUE REMOVABLE LOCTITE

D

C

B

A

**BILL OF MATERIAL (CURRENT LEVEL)**

ITEM	PT/ASSY	DESCRIPTION	TYPE	QTY.
1	02528	CABLE CLAMP KIT	BULK ITEM	1
2	09888	T2V2 BATTERY COVER ASM	ASSEMBLY	2
3	09923	T2 AUTO ADJ TRACK	ASSEMBLY	2
4	22958	6" TRACK PIN	PART	2
5	93557	T2V2 SHROUD END LEFT	PART	1
6	93558	T2V2 SHROUD END RIGHT	PART	1
7	95073	10-32 X 1/4"L FLAT HEAD SCREW	PART	8
8	95175	1/4"-20 X 3/8"L PAN HEAD	PART	6
9	95294	ROTOCLIP DTX-4	PART	4

D

C

B

A

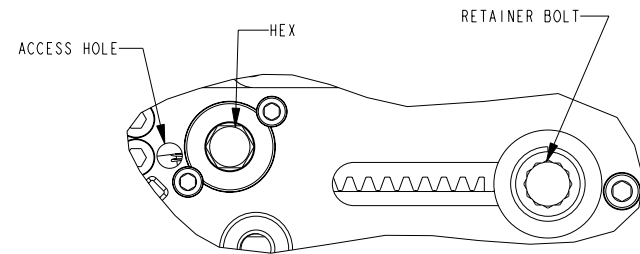
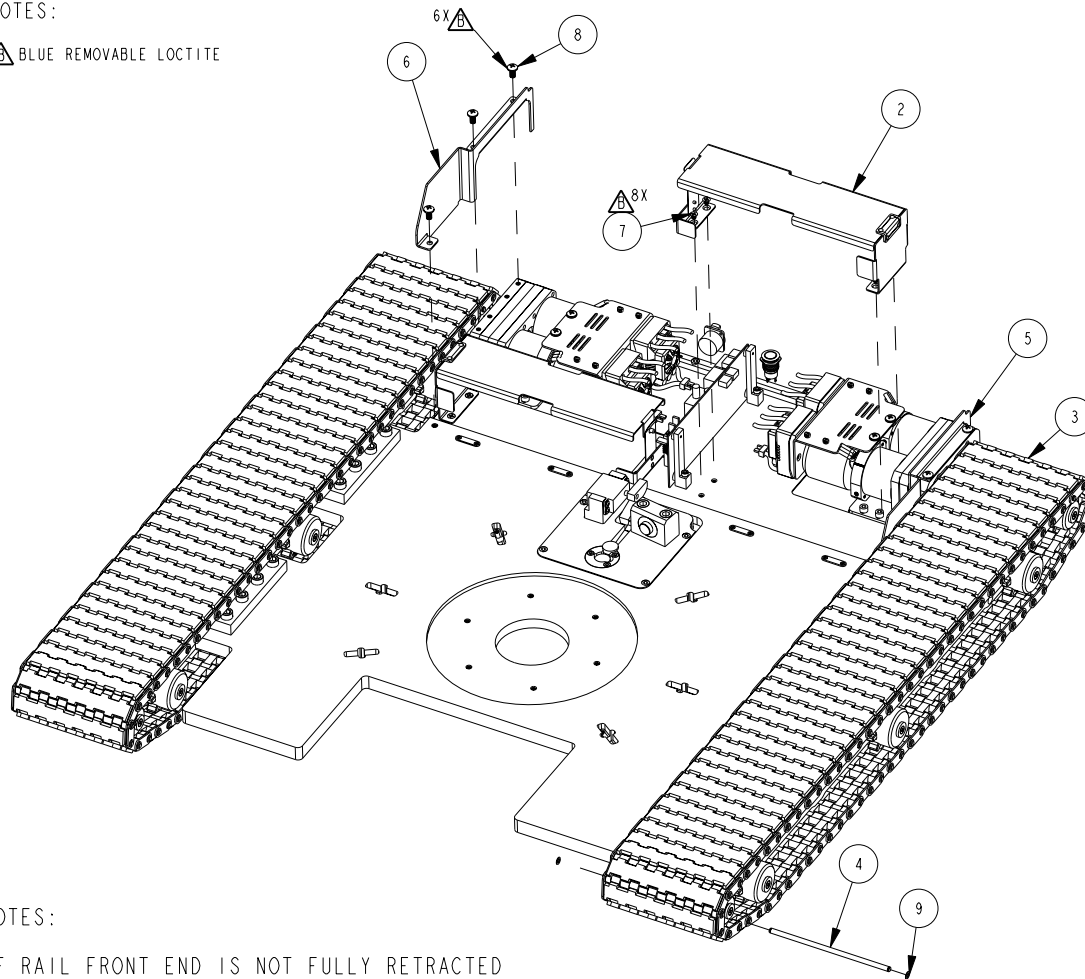

NOTES:

IF RAIL FRONT END IS NOT FULLY RETRACTED

1. LOOSEN THE RETAINER BOLT WITH A 7/16" SOCKET
2. SLIGHTLY ROTATE THE HEX WITH 7/16" SOCKET TO RELEASE TENSION FROM THE PINION
3. WITH HEX SLIGHTLY ROTATED INSERT A 1/4" DIAMETER SCREW DRIVE INTO THE ACCESS HOLE TO RELEASE THE INTERNAL MECHANISM
4. ROTATE HEX WITH 7/16" SOCKET TO RETRACT FRONT END
5. REMOVE THE SCREW DRIVE TO RELEASE THE INTERNAL MECHANISM
6. ROTATE HEX WITH 7/16" SOCKET TO ADJUST TENSION. (SHOULD ONLY ROTATE IN ONE DIRECTION)

ELSE  
SEE STEP 6

**ACAIR Technology**  
13832 MAGNOLIA AVE.  
CHINO, CA 91710-7027  
855-884-7222

T2 V2 TUG W LIGHTS

ASSY. NO. 09922

U

SCALE 0.110

REF. -

SHEET 6 OF 11

4

3

2

NOTES:

 BLUE REMOVABLE LOCTITE

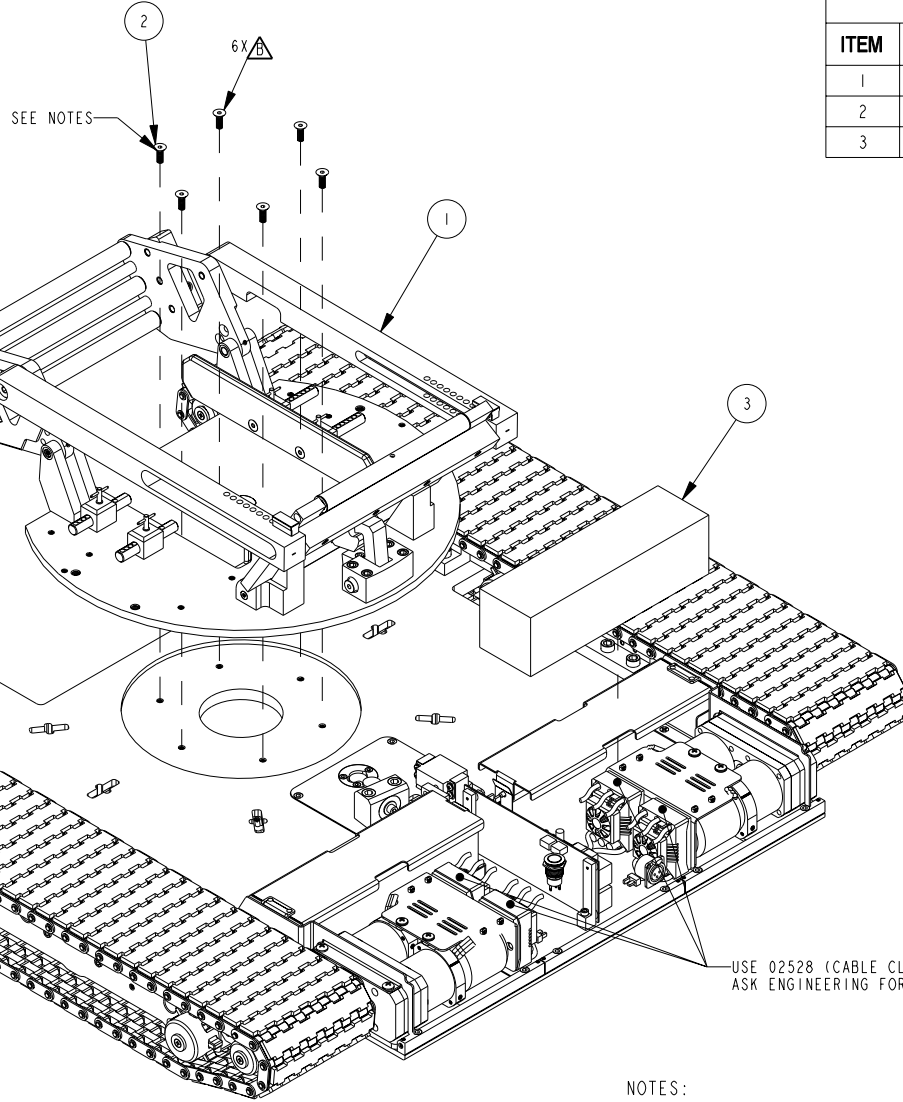

**BILL OF MATERIAL (CURRENT LEVEL)**

ITEM	PT/ASSY	DESCRIPTION	TYPE	QTY.
1	09590	T2V2 LAZY SUSAN	ASSEMBLY	1
2	95003	1/4"-20 X 3/4" FLAT HEAD	PART	6
3	95503	24V 20AH BATTERY	PART	2

TOB PART # 95583  
 USE THIS SHIM ONLY WHEN NEEDED  
 IT IS USED TO ADJUST THE HEIGHT OF  
 09969 LAZY SUSAN LATCH.  
 .030" THICK

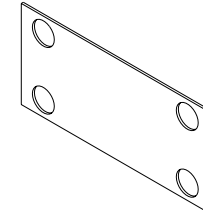

USE O2528 (CABLE CLAMP KIT) TO SECURE 4X 95563 (SPEED CONTROLS)  
 ASK ENGINEERING FOR INSTALL. INSTRUCTIONS.

NOTES:

1. ASSEMBLE (6X) 95003 THROUGH HOLE ON LAZY SUSAN WHEEL PLATE.
2. REINSTALL THE LAZY SUSAN ROLLER AND SCREWS. ADD BLUE LOCTITE TO SCREWS.

**ACAIR  
Technology**

13832 MAGNOLIA AVE.  
 CHINO, CA 91710-7027  
 855-884-7222

T2 V2 TUG W LIGHTS

ASSY. NO. **09922**

U

SCALE 0.125

REF. -

SHEET 7 OF 11

NOTES:

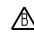
 BLUE REMOVABLE LOCTITE

**BILL OF MATERIAL (CURRENT LEVEL)**

ITEM	PT/ASSY	DESCRIPTION	TYPE	QTY.
1	09022	LOGO PLATE W STUDS	ASSEMBLY	1
2	09538	LED LIGHT	ASSEMBLY	2
3	09724	T2 LIGHT KIT	ASSEMBLY	1
4	09929	T2V2 WELDED SHROUD	ASSEMBLY	1
5	93554	M3 X 0.5MM, 8MM L FLAT HEAD SCREW	PART	8
6	93555	M3 X 0.5MM, HEX NUT	PART	8
7	95463	SS THIN NYLON-INSERT LOCK NUT	PART	2
8	93553A	SS MAGNETIC LATCH	PART	4

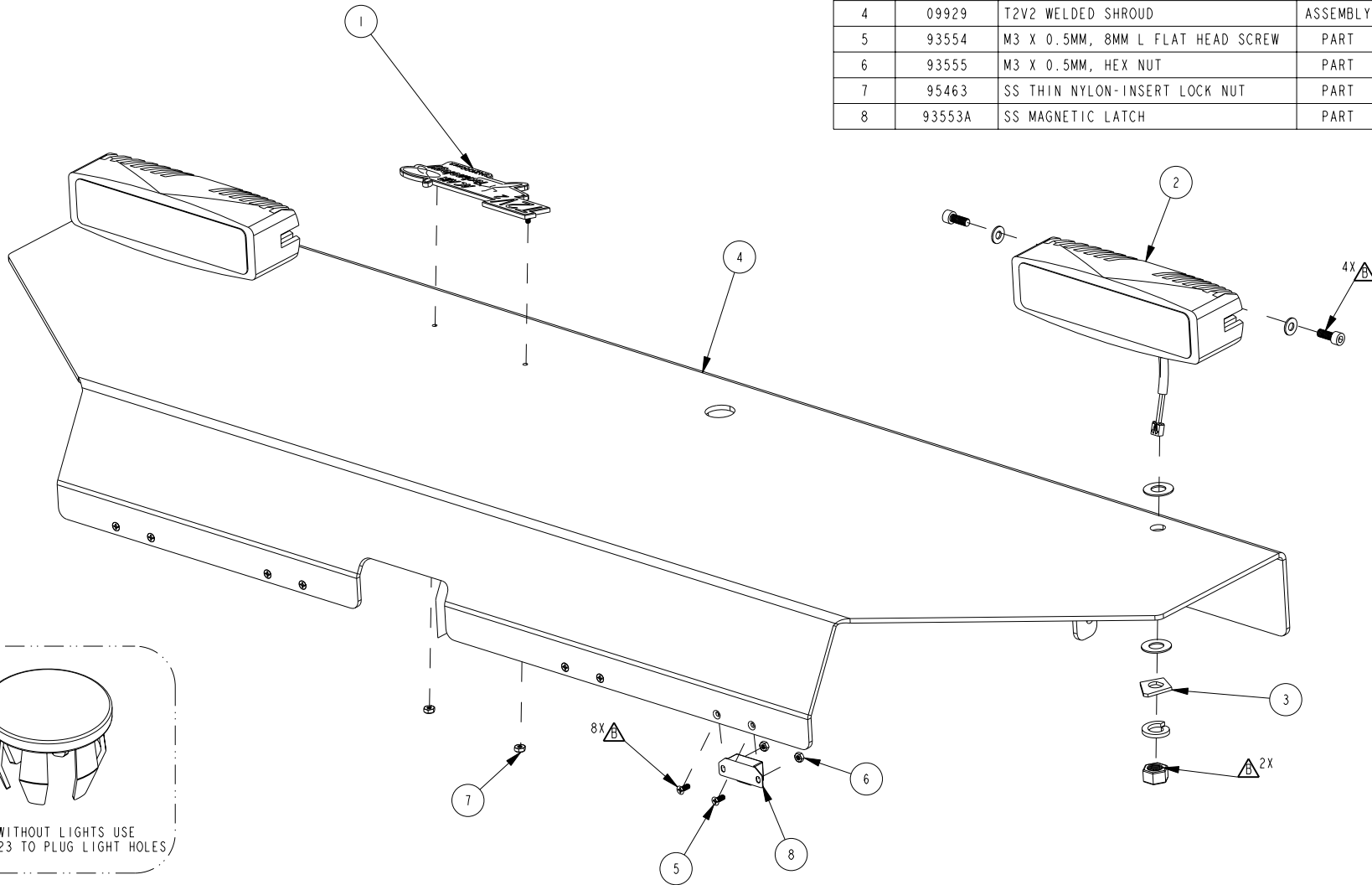

**ACAIR  
Technology**

13832 MAGNOLIA AVE.  
CHINO, CA 91710-7027  
855-884-7222

T2 V2 TUG W LIGHTS

ASSY. NO. 09922

U

SCALE 0.250

REF. -

SHEET 8 OF 11

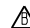

NOTES:

 BLUE REMOVABLE LOCTITE

**BILL OF MATERIAL (CURRENT LEVEL)**

ITEM	PT/ASSY	DESCRIPTION	TYPE	QTY.
1	92361	4-40X5/16"L FLAT HD SCW, PHIL	PART	2
2	92524	8-32 UNC X 1/8 SET SCREW	PART	2
3	95017	1/4"-20 X 1/2" SOCKET CAP	PART	2

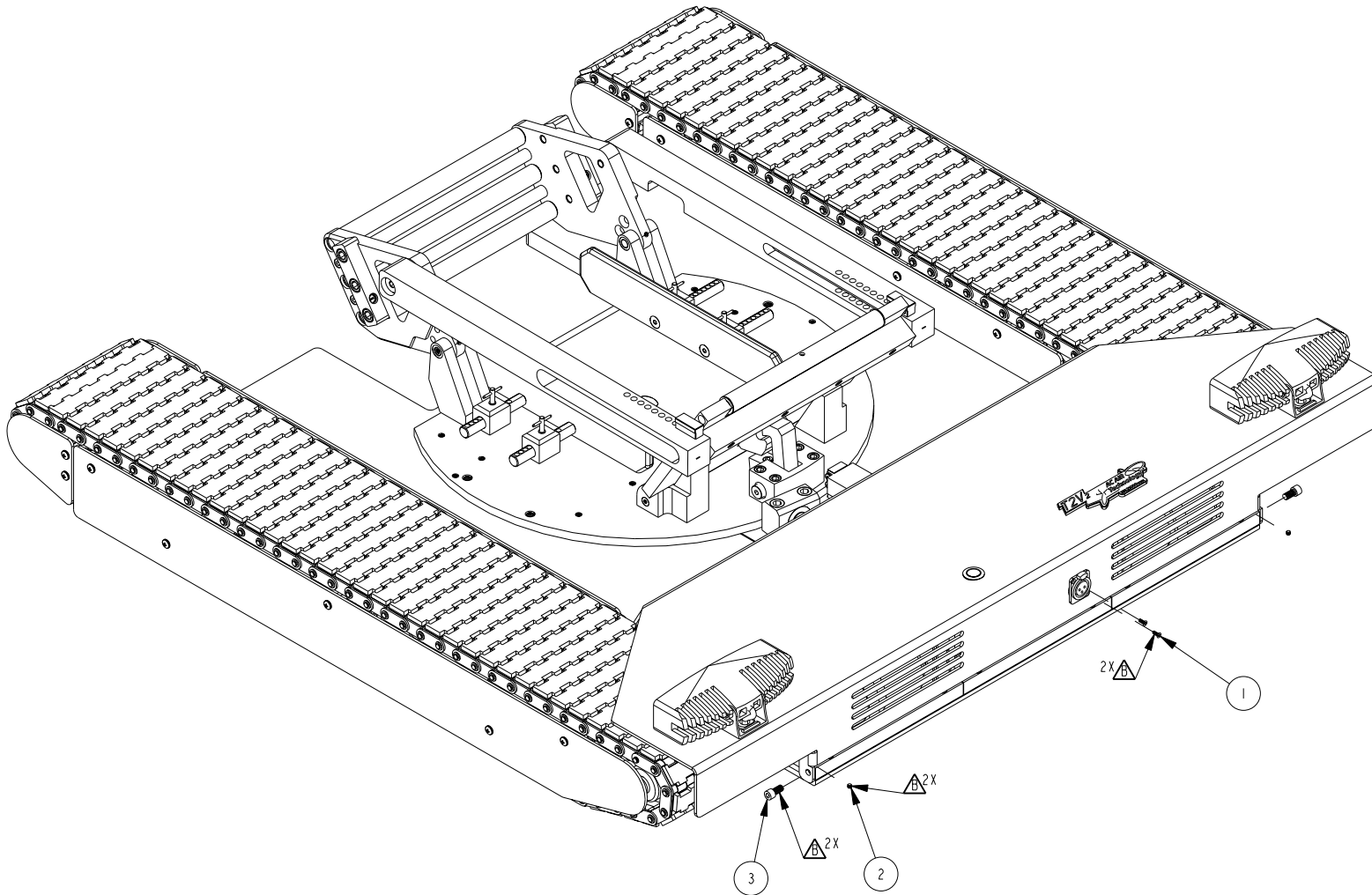

**ACAIR  
Technology**

13832 MAGNOLIA AVE.  
CHINO, CA 91710-7027  
855-884-7222

T2 V2 TUG W LIGHTS

ASSY. NO. 09922

U

SCALE 0.150

REF. -

SHEET 9 OF 11

NOTES:

▲ BLUE REMOVABLE LOCTITE

▲ LOCTITE JOINT (GREEN)

BILL OF MATERIAL (CURRENT LEVEL)

ITEM	PT/ASSY	DESCRIPTION	TYPE	QTY.
1	22604	T2 TRACK STANDOFF	PART	24
2	92542	1/4-20 X .500"L SET SCREW SS	PART	24
3	95385	T2 INSIDE COVER (AUTO ADJ)	PART	2
4	95386	T2 OUTSIDE COVER	PART	2
5	95396	T2 RAIL END COVER	PART	4
6	95624	10-32 X 3/8" PHILLIPS SCREW, THREAD LOCK	PART	24

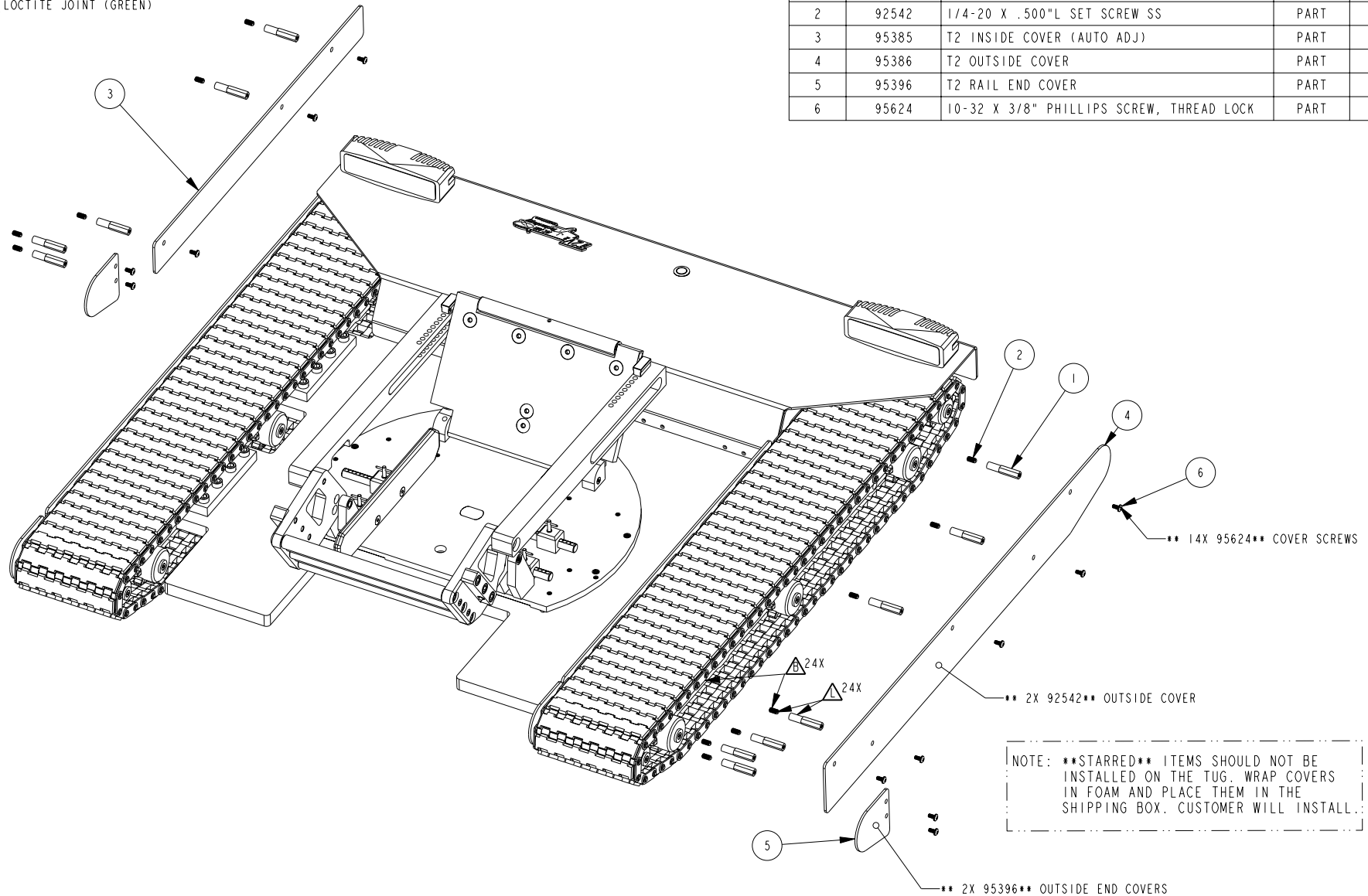

**ACAIR  
Technology**

13832 MAGNOLIA AVE.  
CHINO, CA 91710-7027  
855-884-7222

T2 V2 TUG W LIGHTS

ASSY. NO. 09922

U

SCALE 0.125

REF. -

SHEET 10 OF 11

NOTES:

**BILL OF MATERIAL (CURRENT LEVEL)**

ITEM	PT/ASSY	DESCRIPTION	TYPE	QTY.
1	09551	T2 TRACK SPARE PARTS KIT	PART	1
2	09965	T2V2/T1.5 V2 RADIO W LIGHTS 2017	ASSEMBLY	1
3	95391	T2 AUTO ADJ TUG OWNERS MANUAL	PART	1
4	95394	29.2V POWER SUPPLY 7A	PART	1

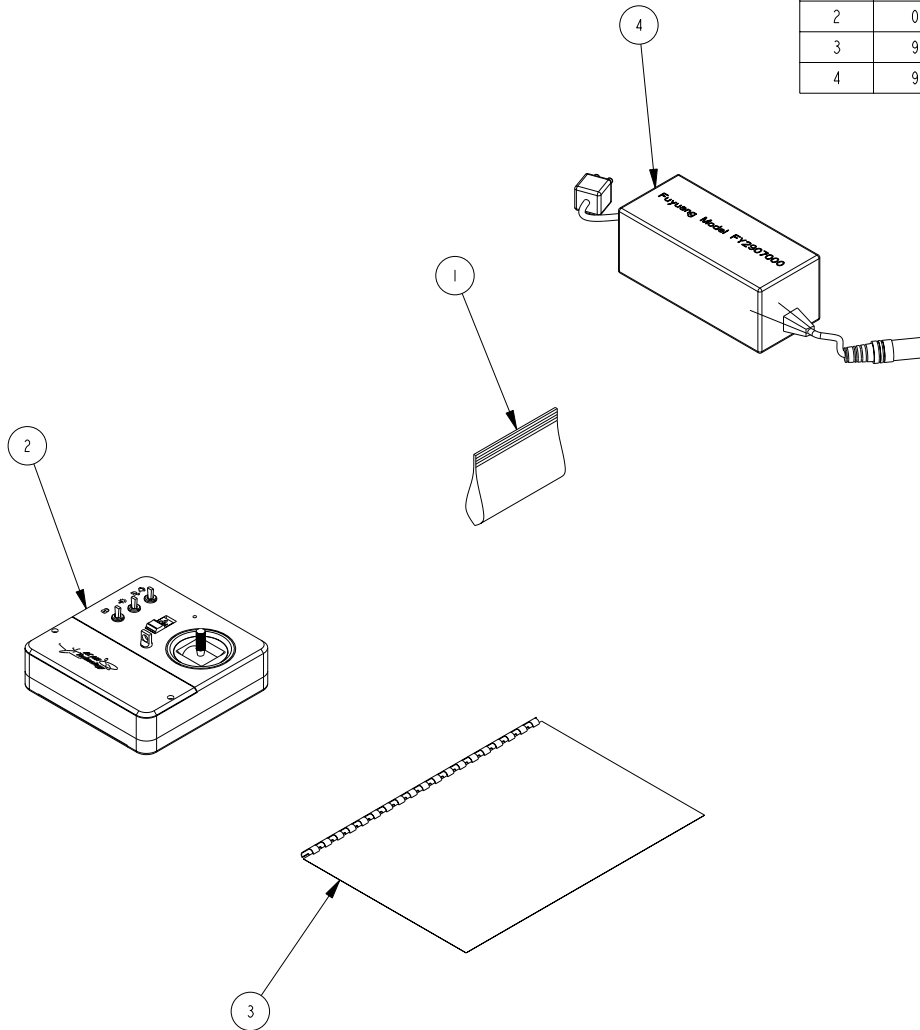

**ACAIR  
Technology**

13832 MAGNOLIA AVE.  
CHINO, CA 91710-7027  
855-884-7222

T2 V2 TUG W LIGHTS

ASSY. NO. 09922

U

SCALE 0.150

REF. -

SHEET 11 OF 11