

NOTES:

**BILL OF MATERIAL (CURRENT LEVEL)**

ITEM	PT/ASSY	DESCRIPTION	TYPE	QTY.
1	01244	LONG SIDE COVER STANDOFF	ASSEMBLY	26
2	02623	T2V3 RAIL ASSEMBLY	ASSEMBLY	1
3	02624	T2V3 GEARBOX-MOTOR ASSEMBLY	ASSEMBLY	2
4	02626	T2V3 LOGO PLATE W STUDS	ASSEMBLY	1
5	09538	LED LIGHT	ASSEMBLY	2
6	09551	T2 TRACK SPARE PARTS KIT	PART	1
7	09724	T2 LIGHT KIT	ASSEMBLY	1
8	09829	T2 ALL-IN-ONE PC BOARD	ASSEMBLY	1
9	09888	T2V2 BATTERY COVER ASM	ASSEMBLY	2
10	09923	T2 AUTO ADJ TRACK	ASSEMBLY	2
11	09929	T2V2 WELDED SHROUD	ASSEMBLY	1
12	09965	T2V2/T1.5 V2 RADIO W LIGHTS 2017	ASSEMBLY	1
13	09969	T2 DUAL LIFTER LATCH ASSMEBLY	ASSEMBLY	1
14	09992	T2W2 CRADLE XL	ASSEMBLY	1
15	09999	ON-BOARD PARTS BOX	ASSEMBLY	1
16	20401	T2V3 MAINPLATE	PART	1
17	22596	T2 SERVO CAM	PART	1
18	23145	COVER MOUNT BAR	PART	3
19	23466	T2 MOTOR PLATE	PART	2
20	23712	MP GLIDE SHAFT 1/4" OD X 1" L	PART	6
21	23713	ACETAL WASHER 1/4" ID X .050" THICK	PART	12
22	23757	T1.5V2 PCB SUPPORT	PART	2
23	92039	PUSH MOUNT CABLE TIE	PART	8
24	92266	10-24 X 7/8" L SS CAP SCREW	PART	2
25	92361	4-40X5/16"L FLAT HD SCW, PHIL	PART	2
26	92524	8-32 UNC X 1/8 SET SCREW	PART	2
27	92708	T2V3 RAIL INSIDE COVER	PART	4
28	93547	RACHET TOOL, 3/8" DRIVE	BULK ITEM	1
29	93548	DEEP SOCKET, SIZE 7/16" DRIVE 3/8"	BULK ITEM	1
30	93549	T1.7 MOTOR COVER	PART	2
31	93554	M3 X 0.5MM, 8MM L FLAT HEAD SCREW	PART	8
32	93555	M3 X 0.5MM, HEX NUT	PART	8
33	93557	T2V2 SHROUD END LEFT	PART	1
34	93558	T2V2 SHROUD END RIGHT	PART	1
35	93560	#4, 1/4" L SELF-TAPPING SCREW	PART	8

36	94050	BEARING 5/8" OD FOR 1/4" SHAFT	PART	6
37	95003	1/4"-20 X 3/4" FLAT HEAD	PART	6
38	95016	1/4"-20 X 5/8" SOCKET CAP	PART	22
39	95017	1/4"-20 X 1/2" SOCKET CAP	PART	26
40	95073	10-32 X 1/4"L FLAT HEAD SCREW	PART	8
41	95158	1/4" X .125" NYLON SPACER	PART	8
42	95175	1/4"-20 X 3/8"L PAN HEAD	PART	6
43	95350	8.25 EXTENSION	BULK ITEM	1
44	95366	WIRE EXTENSION CLIP	BULK ITEM	1
45	95386	T2 OUTSIDE COVER	PART	2
46	95394	29.2V POWER SUPPLY 7A	PART	1
47	95396	T2 RAIL END COVER	PART	4
48	95415	1/4"-20 X 1/2" L PAN HEAD	PART	4
49	95463	SS THIN NYLON-INSERT LOCK NUT	PART	2
50	95503	24V 20AH BATTERY	PART	2
51	95553	SPEED CONTROL 2020	PART	4
52	95554	#4-24 THRD-FORM SCREW FOR PLASTIC	PART	16
53	95624	10-32 X 3/8" PHILLIPS SCREW, THREAD LOCK	PART	26
54	95666	T2V3 TUG OWNERS MANUAL	PART	1
55	96198	1/2"-20 X 1-1/4" L CAP SCREW	PART	8
56	96346	TUG SHIPPING BOX	BULK ITEM	1
57	96350	TUG FOAM PACKAGING	BULK ITEM	1
58	97021	6-32X3/8"L PHILIPS SCREW	PART	4
59	98017	10-32 X 1/2"L W LOCK WASHER	PART	2
60	93553A	SS MAGNETIC LATCH	PART	4
61	93553B	93553 SS MAGNET STRIKE PLATE	PART	4



13832 MAGNOLIA AVE.  
CHINO, CA 91710-7027  
855-884-7222

T2W3 TUG ASSEMBLY

ASSY. NO 09917

A

SCALE 0.023

REF. -

SHEET 1 OF 11

NOTES:

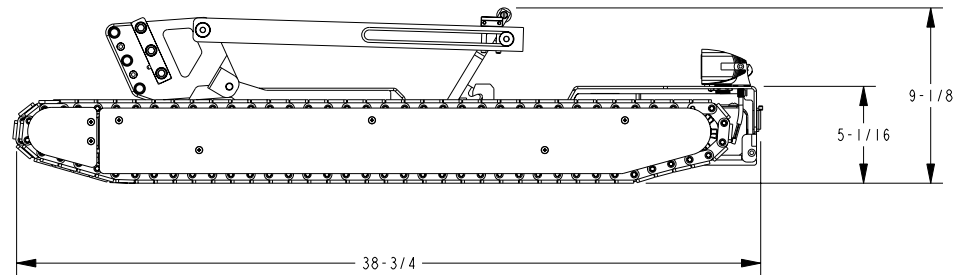
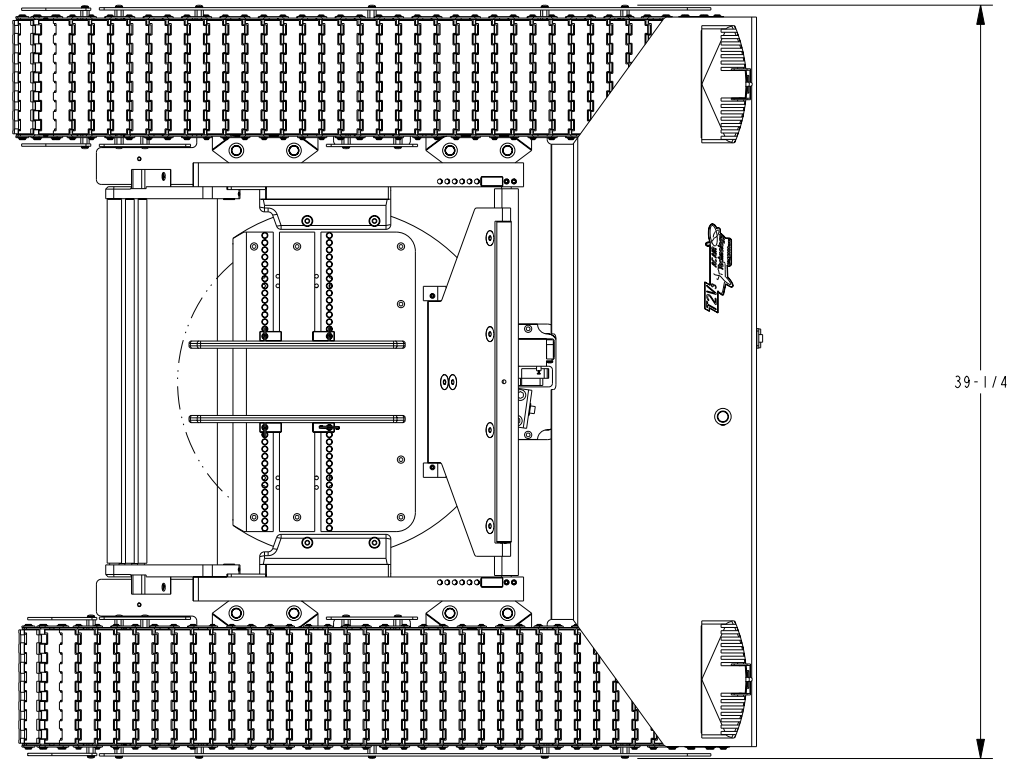

**ACAIR  
Technology**

13832 MAGNOLIA AVE.  
CHINO, CA 91710-7027  
855-884-7222

T2W3 TUG ASSEMBLY

ASSY. NO. 09917

A

SCALE 0.100

REF. -

SHEET 2 OF 11

NOTES:  BLUE REMOVABLE LOCTITE

**BILL OF MATERIAL (CURRENT LEVEL)**

ITEM	PT/ASSY	DESCRIPTION	TYPE	QTY.
1	02624	T2V3 GEARBOX-MOTOR ASSEMBLY	ASSEMBLY	2
2	09969	T2 DUAL LIFTER LATCH ASSEMBLY	ASSEMBLY	1
3	20401	T2V3 MAINPLATE	PART	1
4	22596	T2 SERVO CAM	PART	1
5	23145	COVER MOUNT BAR	PART	3
6	23466	T2 MOTOR PLATE	PART	2
7	23712	MP GLIDE SHAFT 1/4" OD X 1" L	PART	6
8	23713	ACETAL WASHER 1/4" ID X .050" THICK	THICK	12
9	93560	#4, 1/4" L SELF-TAPPING SCREW	PART	8
10	94050	BEARING 5/8" OD FOR 1/4" SHAFT	PART	6
11	95016	1/4"-20 X 5/8" SOCKET CAP	PART	22
12	95017	1/4"-20 X 1/2" SOCKET CAP	PART	24
13	93553B	93553 SS MAGNET STRIKE PLATE	PART	4

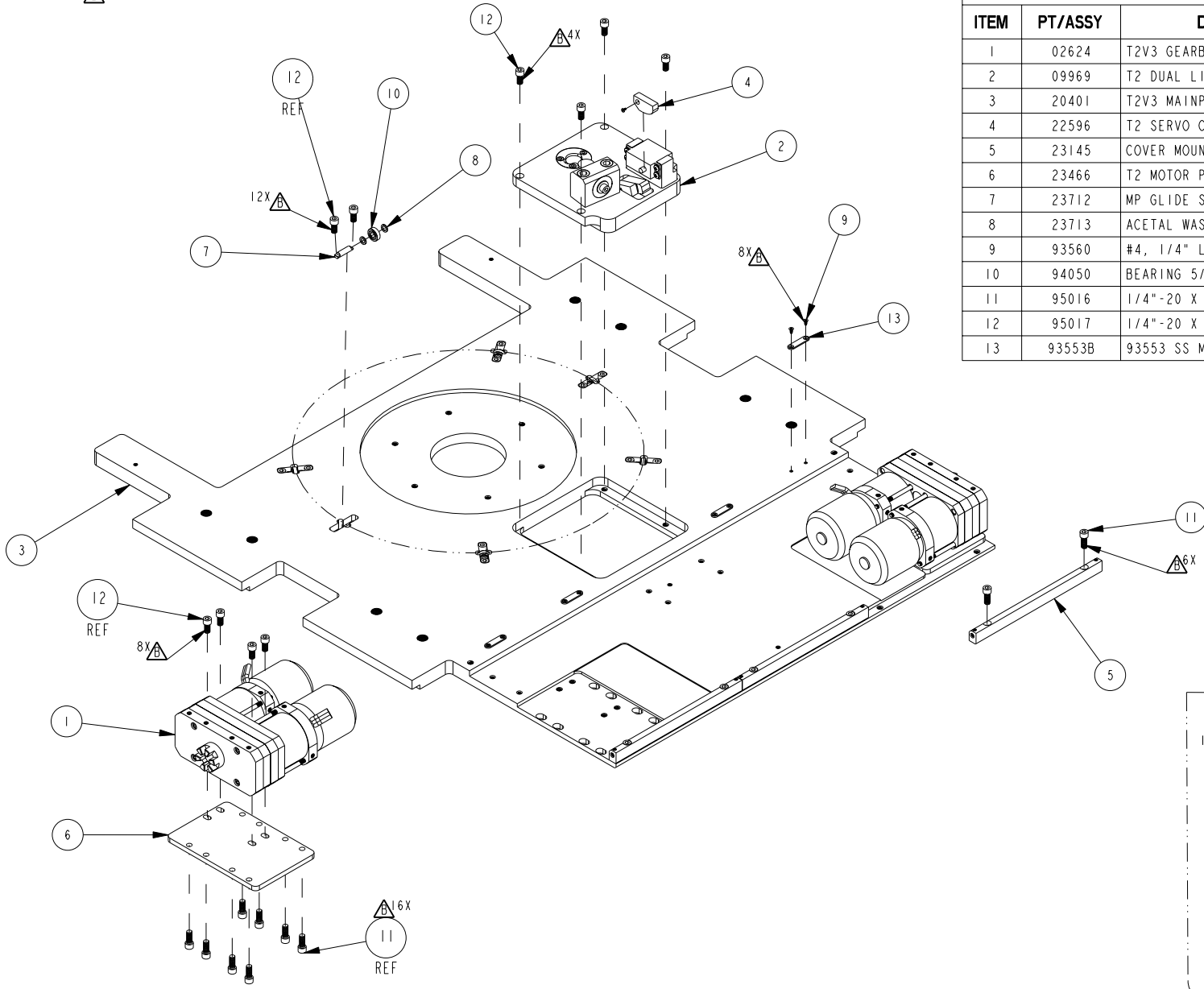

ACA PN: 92657  
 USE THIS SHIM ONLY WHEN NEEDED.  
 IT IS USED TO ADJUST THE HEIGHT OF  
 09969 LAZY SUSAN ROLLER.  
 .060" THICK

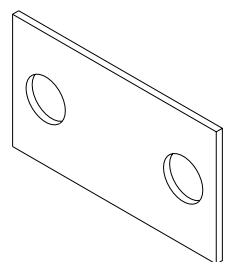

**ACAIR  
Technology**

13832 MAGNOLIA AVE.  
 CHINO, CA 91710-7027  
 855-884-7222

T2V3 TUG ASSEMBLY

ASSY. NO. 09917

A

SCALE 0.140

REF. -

SHEET 3 OF 11

NOTES: **BILL OF MATERIAL (CURRENT LEVEL)**

ITEM	PT/ASSY	DESCRIPTION	TYPE	QTY.
1	09829	T2 ALL-IN-ONE PC BOARD	ASSEMBLY	1
2	23757	T1.5V2 PCB SUPPORT	PART	2
3	92039	PUSH MOUNT CABLE TIE	PART	8
4	92266	10-24 X 7/8" L SS CAP SCREW	PART	2
5	93549	T1.7 MOTOR COVER	PART	2
6	95158	1/4" X .125" NYLON SPACER	PART	4
7	95415	1/4"-20 X 1/2" L PAN HEAD	PART	4
8	95553	SPEED CONTROL 2020	PART	4
9	95554	#4-24 THRD-FORM SCREW FOR PLASTICPART	PART	16
10	97021	6-32X3/8"L PHILIPS SCREW	PART	4

 BLUE REMOVABLE LOCTITE

ADD HOT GLUE TO 95553 SPEED CONTROL HOLES BEFORE TIGHTENING 95554 SCREWS

**T2V2 WIRE CONNECTION:**

ORANGE WIRES FROM SPEED CONTROLLER  
CONNECTS TO  
RED WIRES FROM MOTOR

YELLOW WIRES FROM SPEED CONTROLLER  
CONNECTS TO  
BLACK WIRES FROM MOTOR

BLUE WIRES FROM SPEED CONTROLLER  
CONNECT TO  
YELLOW WIRES FROM MOTORS

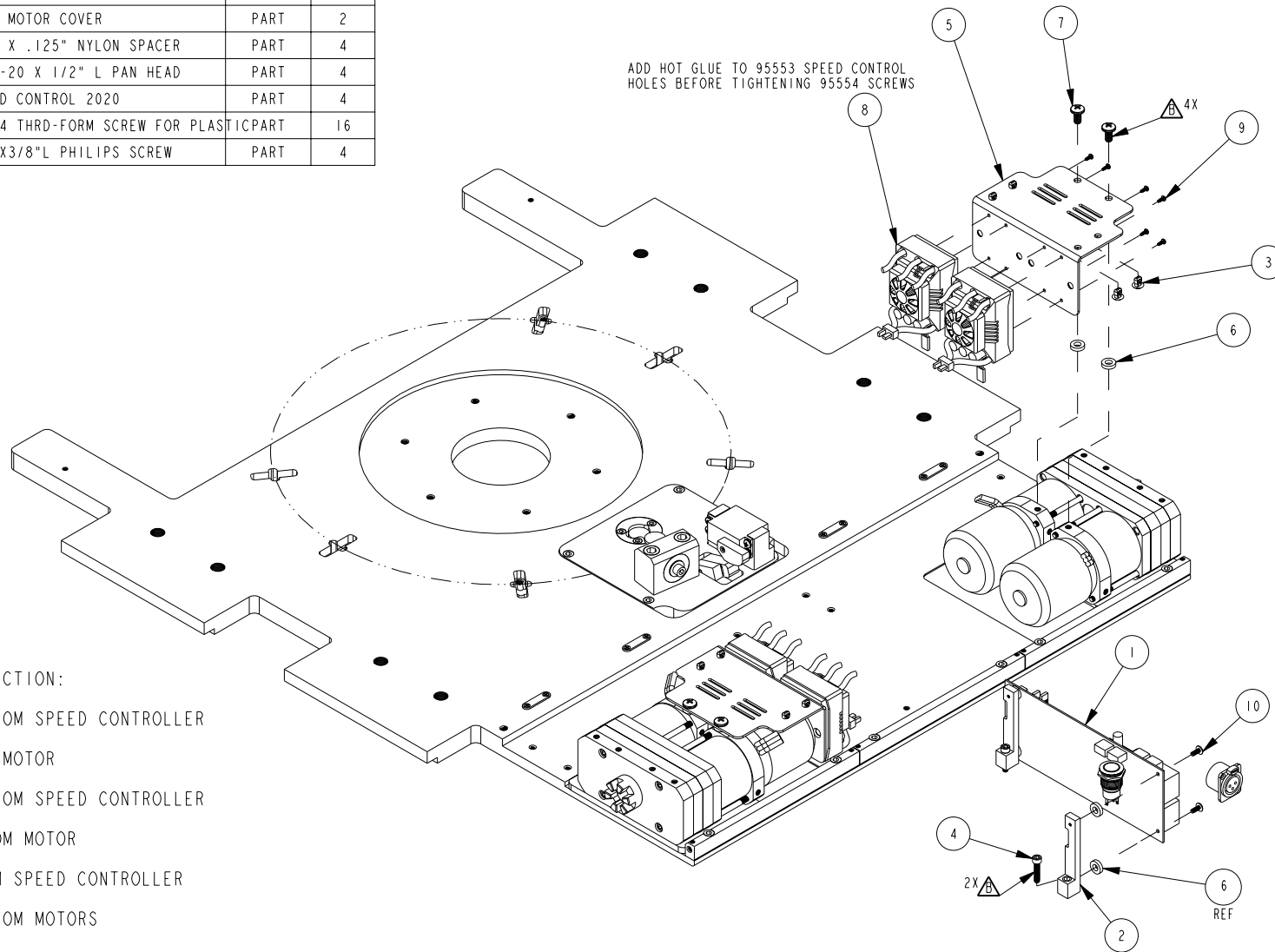

**ACAIR  
Technology**

13832 MAGNOLIA AVE.  
CHINO, CA 91710-7027  
855-884-7222

**T2W3 TUG ASSEMBLY**

ASSY. NO. **09917**

A

SCALE 0.170

REF. -

SHEET 4 OF 11

NOTES:  BLUE REMOVABLE LOCTITE

**BILL OF MATERIAL (CURRENT LEVEL)**

ITEM	PT/ASSY	DESCRIPTION	TYPE	QTY.
1	02623	T2V3 RAIL ASSEMBLY	ASSEMBLY	1
2	96198	1/2"-20 X 1-1/4" L CAP SCREW	PART	8

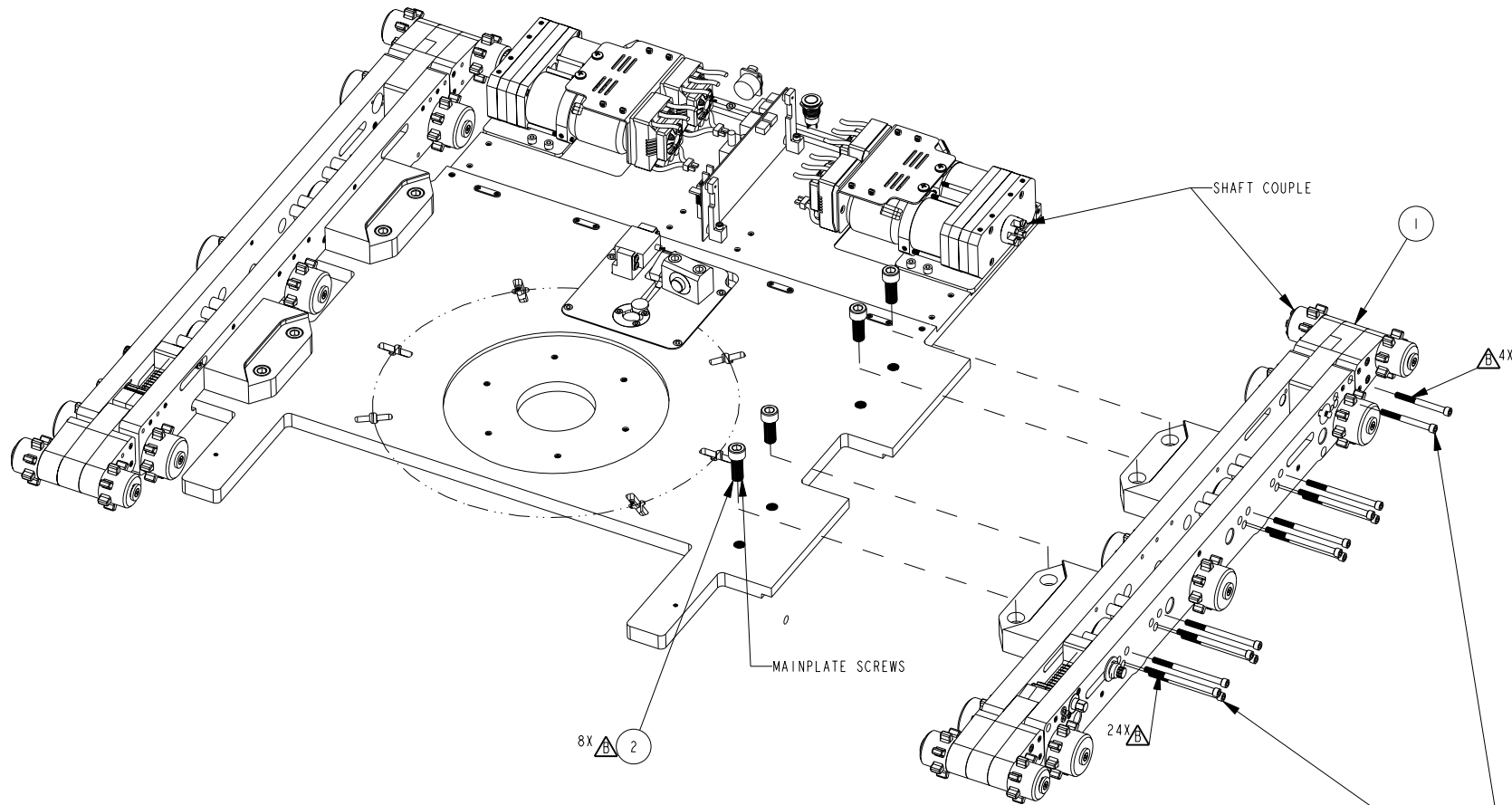

LOOSEN SCREWS BEFORE MOUNTING RAILS TO MAINPLATE  
ALIGN SHAFT COUPLE THEN ALIGN THE RAILS TO THE MAINPLATE.  
ADD GLUE AND TIGHTEN RAIL SCREWS AND MAINPLATE SCREWS.

**ACAIR  
Technology**

13832 MAGNOLIA AVE.  
CHINO, CA 91710-7027  
855-884-7222

**T2W3 TUG ASSEMBLY**

ASSY. NO. **09917**

A

SCALE 0.130

REF. -

SHEET 5 OF 11

NOTES:  BLUE REMOVABLE LOCTITE

**BILL OF MATERIAL (CURRENT LEVEL)**

ITEM	PT/ASSY	DESCRIPTION	TYPE	QTY.
1	09888	T2V2 BATTERY COVER ASM	ASSEMBLY	2
2	09923	T2 AUTO ADJ TRACK	ASSEMBLY	2
3	09999	ON-BOARD PARTS BOX	ASSEMBLY	1
4	93557	T2V2 SHROUD END LEFT	PART	1
5	93558	T2V2 SHROUD END RIGHT	PART	1
6	95073	10-32 X 1/4"L FLAT HEAD SCREW	PART	8
7	95175	1/4"-20 X 3/8"L PAN HEAD	PART	6

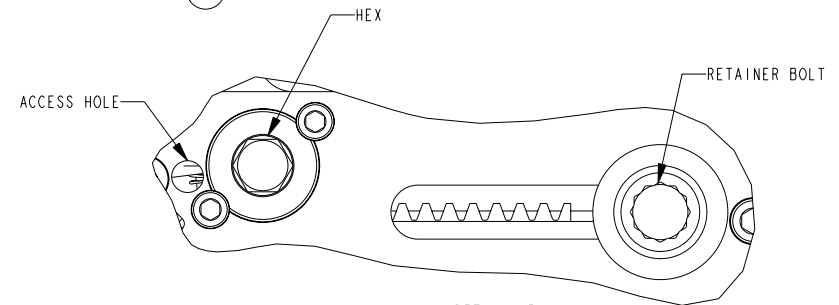
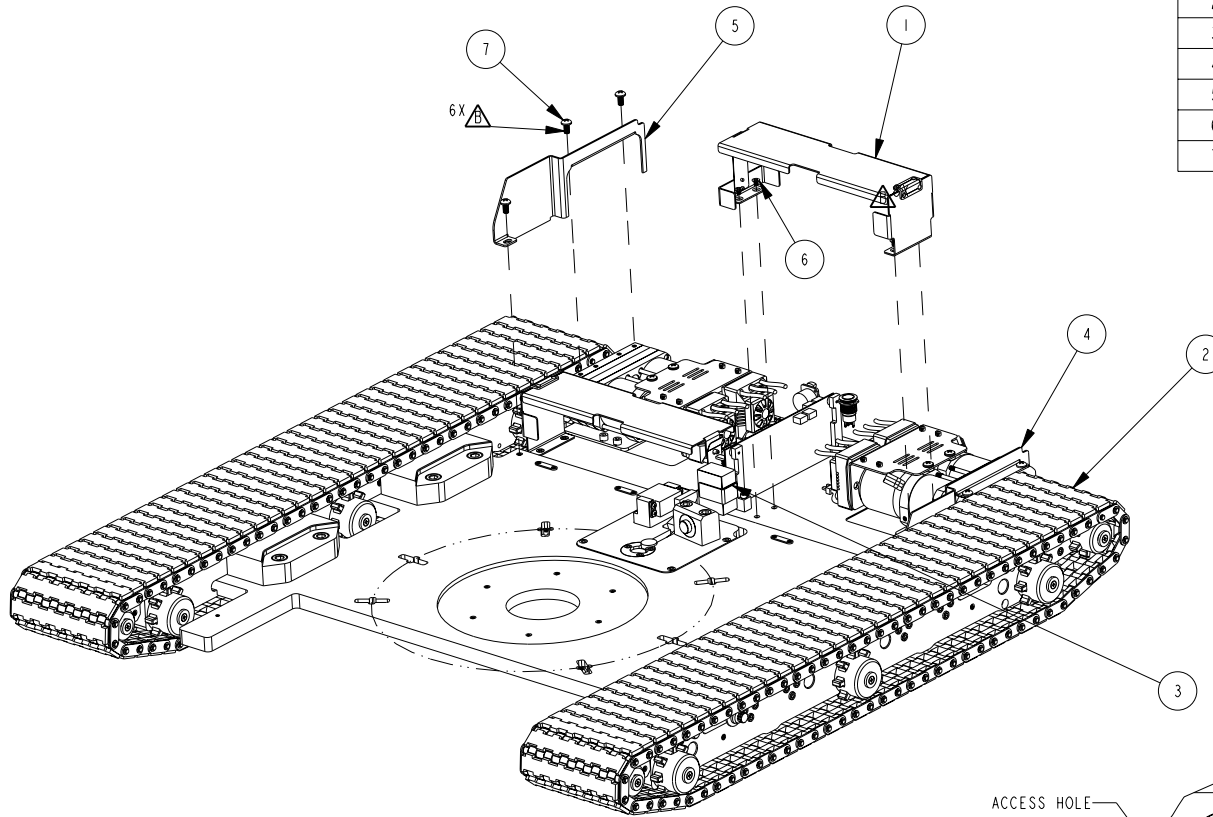

NOTES:

IF RAIL FRONT END IS NOT FULLY RETRACTED

1. LOOSEN THE RETAINER BOLT WITH A 7/16" SOCKET
2. SLIGHTLY ROTATE THE HEX WITH A 7/16" SOCKET TO RELEASE THE TENSION FROM THE INTERNAL PINION
3. WITH THE HEX SLIGHTLY ROTATED INSERT A 1/4" DIAMETER SCREW DRIVE INTO THE ACCESS HOLE TO RELEASE THE INTERNAL MECHANISM.
4. ROTATE HEX WITH 7/16" SOCKET TO RETRACT FRONT END.
5. REMOVE THE SCREW DRIVE FROM THE ACCESS HOLE TO RELEASE THE INTERNAL MECHANISM.
6. ROTATE HEX WITH 7/16" SOCKET TO ADJUST TENSION. IT SHOULD ONLY ROTATE IN ONE DIRECTION.

ELSE

SEE STEP 6

**ACAIR  
Technology**

13832 MAGNOLIA AVE.  
CHINO, CA 91710-7027  
855-884-7222

**T2W3 TUG ASSEMBLY**

ASSY. NO. **09917**

A

SCALE 0.110

REF. -

SHEET 6 OF 11

NOTES:

1. ASSEMBLE (6X) 95003 THROUGH HOLE ON LAZY SUSAN WHEEL PLATE.

BILL OF MATERIAL (CURRENT LEVEL)

ITEM	PT/ASSY	DESCRIPTION	TYPE	QTY.
1	09992	T2W2 CRADLE XL	ASSEMBLY	1
2	95003	1/4"-20 X 3/4" FLAT HEAD	PART	6
3	95503	24V 20AH BATTERY	PART	2

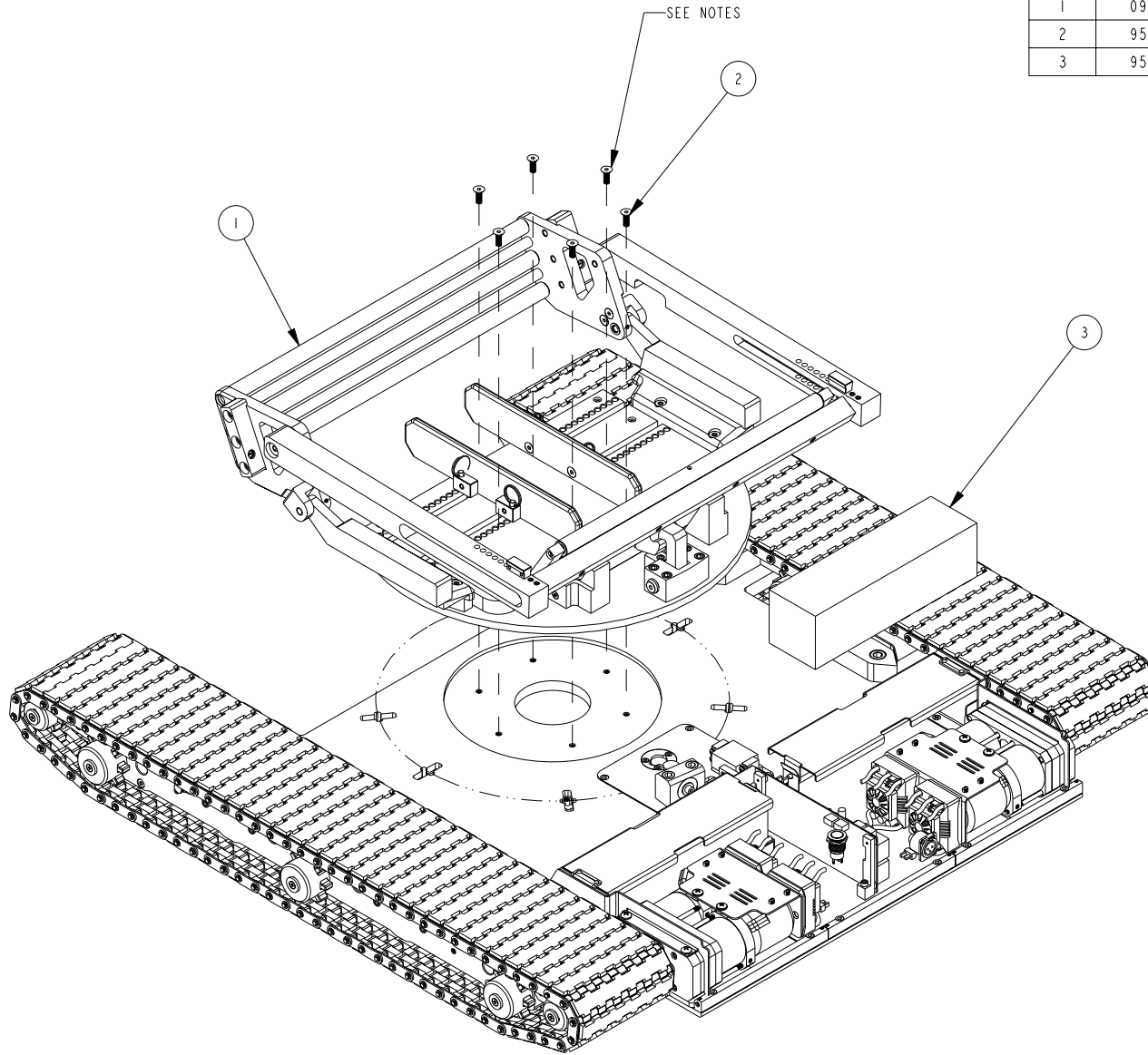

ACA PART # 95583  
 USE THIS SHIM ONLY WHEN NEEDED.  
 IT IS USED TO ADJUST THE HEIGHT OF  
 09969 LAZY SUSAN LATCH.  
 .030" THICK

**ACAIR  
 Technology**

13832 MAGNOLIA AVE.  
 CHINO, CA 91710-7027  
 855-884-7222

T2W3 TUG ASSEMBLY

ASSY. NO. **09917**

A

SCALE 0.125

REF. -

SHEET 7 OF 11

NOTES:  BLUE REMOVABLE LOCTITE

**BILL OF MATERIAL (CURRENT LEVEL)**

ITEM	PT/ASSY	DESCRIPTION	TYPE	QTY.
1	02626	T2V3 LOGO PLATE W STUDS	ASSEMBLY	1
2	09538	LED LIGHT	ASSEMBLY	2
3	09724	T2 LIGHT KIT	ASSEMBLY	1
4	09929	T2V2 WELDED SHROUD	ASSEMBLY	1
5	93554	M3 X 0.5MM, 8MM L FLAT HEAD SCREWPART	PART	8
6	93555	M3 X 0.5MM, HEX NUT	PART	8
7	95463	SS THIN NYLON-INSERT LOCK NUT	PART	2
8	93553A	SS MAGNETIC LATCH	PART	4

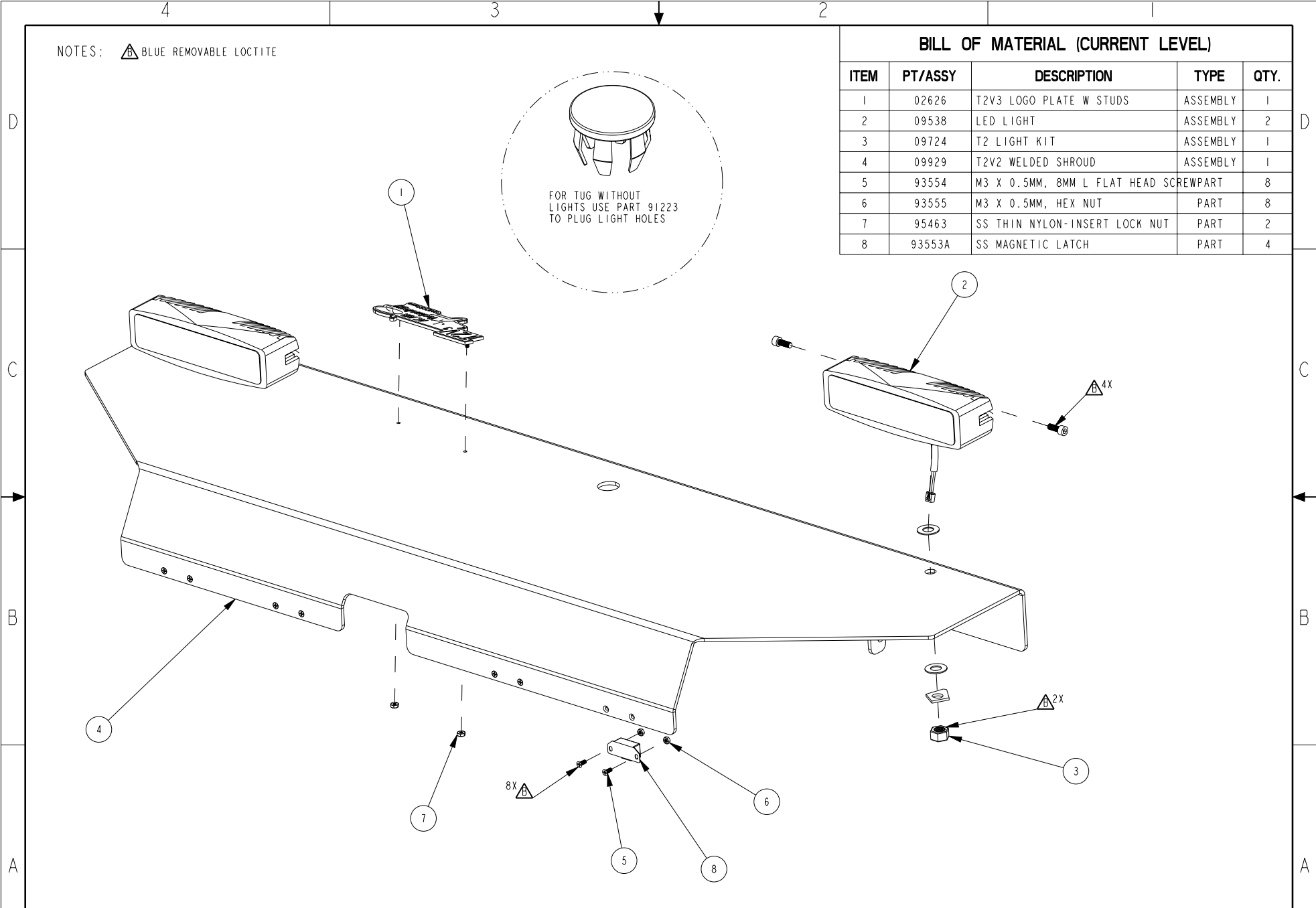
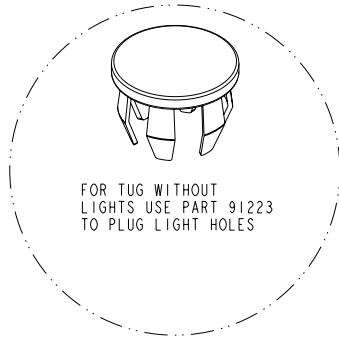

**ACAIR  
Technology**

13832 MAGNOLIA AVE.  
CHINO, CA 91710-7027  
855-884-7222

T2V3 TUG ASSEMBLY

ASSY. NO. 09917

A

SCALE 0.230

REF. -

SHEET 8 OF 11



NOTES:  BLUE REMOVABLE LOCTITE

**BILL OF MATERIAL (CURRENT LEVEL)**

ITEM	PT/ASSY	DESCRIPTION	TYPE	QTY.
1	92361	4-40X5/16"L FLAT HD SCW, PHIL	PART	2
2	92524	8-32 UNC X 1/8 SET SCREW	PART	2
3	95017	1/4"-20 X 1/2" SOCKET CAP	PART	2

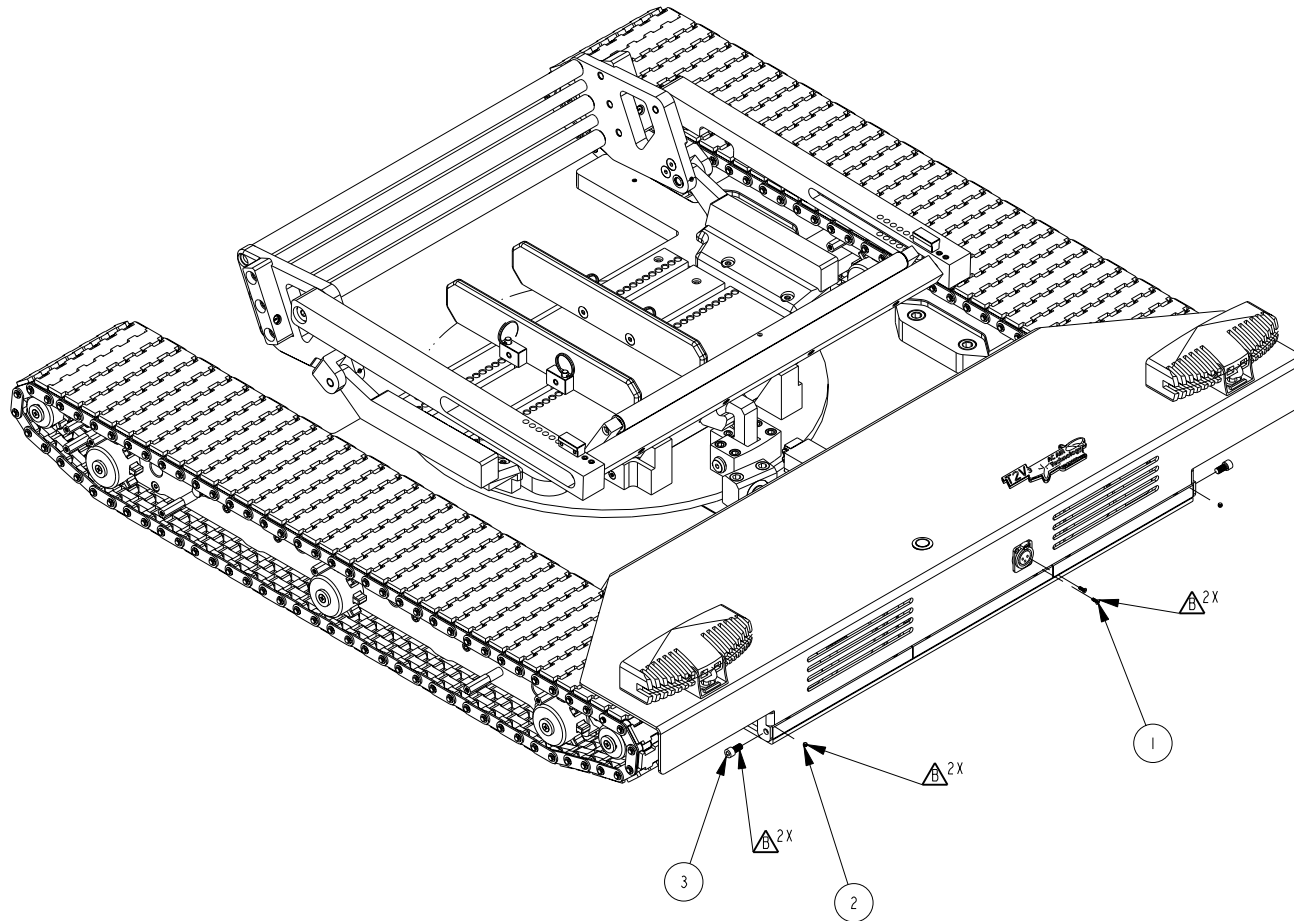

**ACAIR  
Technology**

13832 MAGNOLIA AVE.  
CHINO, CA 91710-7027  
855-884-7222

**T2W3 TUG ASSEMBLY**



ASSY. NO. **09917**

A

SCALE 0.125

REF. -

SHEET 9 OF 11

NOTES:  BLUE REMOVABLE LOCTITE  
 LOCTITE JOINT (GREEN)

**BILL OF MATERIAL (CURRENT LEVEL)**

ITEM	PT/ASSY	DESCRIPTION	TYPE	QTY.
1	01244	LONG SIDE COVER STANDOFF	ASSEMBLY	26
2	92708	T2V3 RAIL INSIDE COVER	PART	4
3	95396	T2 RAIL END COVER	PART	2
4	95624	10-32 X 3/8" PHILLIPS SCREW, THREAD LOCK	PART	12

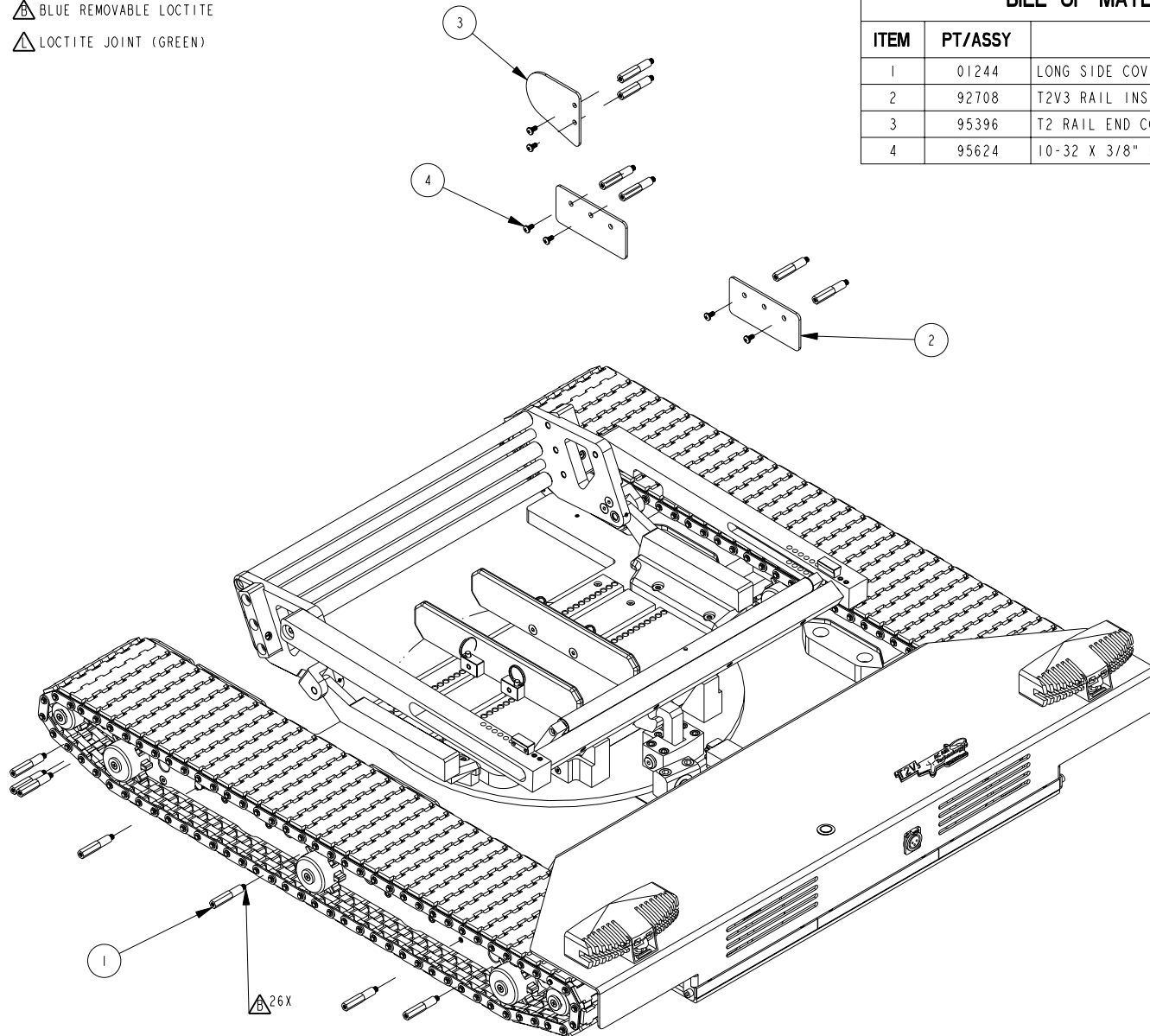

**ACAIR  
Technology**

13832 MAGNOLIA AVE.  
CHINO, CA 91710-7027  
855-884-7222

T2V3 TUG ASSEMBLY

ASSY. NO. 09917

A

SCALE 0.125

REF. -

SHEET 10 OF 11

NOTES:

TUG COVERS (2X 95386 AND 2X 95396) AND SCREWS (14X 95624) ARE NOT INSTALLED ON THE TUG. WRAP COVERS IN FOAM AND PLACE THEM WITH THE SCREWS, INSIDE THE SHIPPING BOX. CUSTOMER WILL INSTALL.

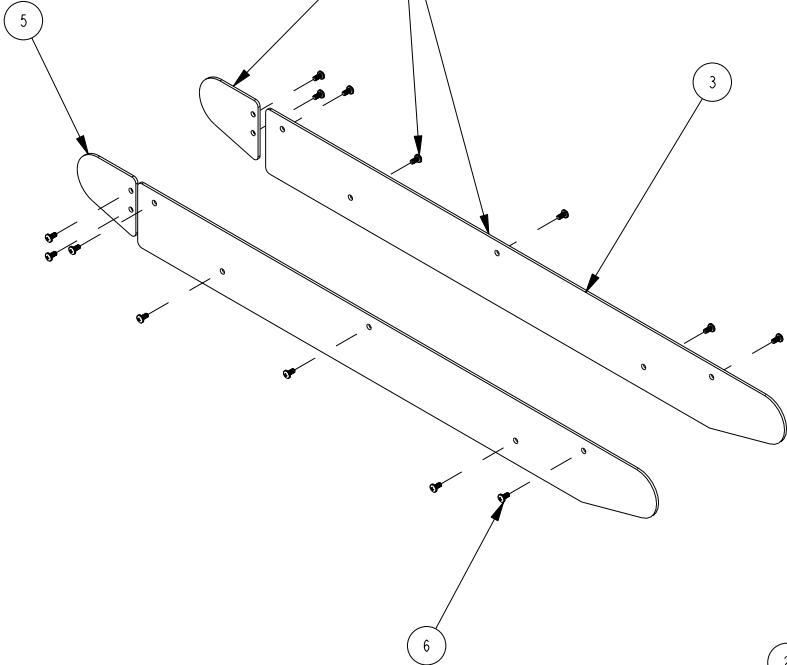

**BILL OF MATERIAL (CURRENT LEVEL)**

ITEM	PT/ASSY	DESCRIPTION	TYPE	QTY.
1	09551	T2 TRACK SPARE PARTS KIT	PART	1
2	09965	T2V2/TI.5 V2 RADIO W LIGHTS 2017	ASSEMBLY	1
3	95386	T2 OUTSIDE COVER	PART	2
4	95394	29.2V POWER SUPPLY 7A	PART	1
5	95396	T2 RAIL END COVER	PART	2
6	95624	10-32 X 3/8" PHILLIPS SCREW, THREAD LOCK	PART	14
7	95666	T2V3 TUG OWNERS MANUAL	PART	1
8	96346	TUG SHIPPING BOX	BULK ITEM	1
9	96350	TUG FOAM PACKAGING	BULK ITEM	1
10	98017	10-32 X 1/2" L W LOCK WASHER	PART	2

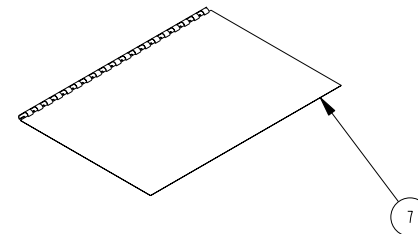
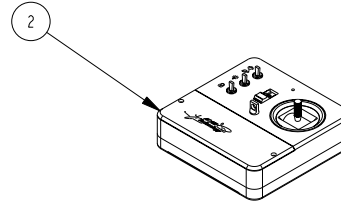
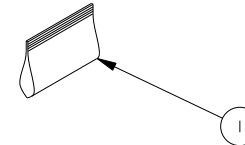
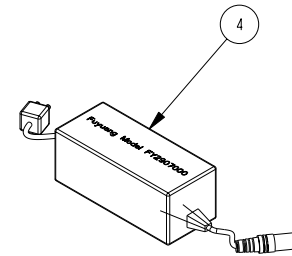

PLACE THESE 2 SCREWS INSIDE THE PLASTIC PARTS BOX

**ACAIR Technology**

13832 MAGNOLIA AVE.  
CHINO, CA 91710-7027  
855-884-7222

T2W3 TUG ASSEMBLY

ASSY. NO. 09917

A

SCALE 0.120

REF. -

SHEET 11 OF 11