

**BILL OF MATERIAL (CURRENT LEVEL)**

ITEM	PT/ASSY	DESCRIPTION	TYPE	QTY.
1	02528	CABLE CLAMP KIT	BULK ITEM	1
2	09020	T2W2 LOGO PLATE W STUDS	ASSEMBLY	1
3	09520	T2 GEARBOX ASSEMBLY	ASSEMBLY	2
4	09538	LED LIGHT	ASSEMBLY	2
5	09551	T2 TRACK SPARE PARTS KIT	PART	1
6	09724	T2 LIGHT KIT	ASSEMBLY	1
7	09829	T2 ALL-IN-ONE PC BOARD	ASSEMBLY	1
8	09857	(PAIR) T2 LEVER ADJ RAIL ASM	ASSEMBLY	1
9	09888	T2V2 BATTERY COVER ASM	ASSEMBLY	2
10	09923	T2 AUTO ADJ TRACK	ASSEMBLY	2
11	09929	T2V2 SHROUD-BRACK (V.081519)	ASSEMBLY	1
12	09965	T2V2/T1.5 V2 RADIO W LIGHTS 2017	ASSEMBLY	1
13	09969	T2 DUAL LIFTER LATCH ASSMEBLY	ASSEMBLY	1
14	09992	T2W2 CRADLE XL	ASSEMBLY	1
15	22422	TUG SHAFT RETAINER	PART	2
16	22596	T2 SERVO CAM	PART	1
17	22604	T2 TRACK STANDOFF	PART	24
18	22958	6" TRACK PIN	PART	2
19	23145	COVER MOUNT BAR	PART	3
20	23466	T2 MOTOR PLATE	PART	2
21	23559	7 TOOTH T2 DRIVE SPROCKET	PART	4
22	23642	T2 V2 MOTOR SPACER	PART	2
23	23712	MP GLIDE SHAFT 1/4" OD X 1" L	PART	6
24	23713	ACETAL WASHER 1/4" ID X .050" THICK	PART	12
25	23757	T1.5V2 PCB SUPPORT	PART	2
26	24255	SPLASH GUARD GUIDE PLATE	PART	2
27	24284	T2W2 MAIN PLATE XL	PART	1
28	92039	PUSH MOUNT CABLE TIE	PART	8
29	92266	10-24 X 7/8" L SS CAP SCREW	PART	2
30	92361	4-40X5/16"L FLAT HD SCW, PHIL	PART	2
31	92524	8-32 UNC X 1/8 SET SCREW	PART	2
32	92542	1/4-20 X .500"L SET SCREW SS	PART	24
33	93547	RACHET TOOL, 3/8" DRIVE	BULK ITEM	1
34	93548	DEEP SOCKET, SIZE 7/16" DRIVE 3/8"	BULK ITEM	1
35	93549	T1.7 MOTOR COVER	PART	2
36	93554	M3 X 0.5MM, 8MM L FLAT HEAD SCREW	PART	12
37	93555	M3 X 0.5MM, HEX NUT	PART	8
38	93557	T2V2 SHROUD END LEFT	PART	1
39	93558	T2V2 SHROUD END RIGHT	PART	1

40	93560	#4, 1/4" L SELF-TAPPING SCREW	PART	8
41	94050	BEARING 5/8" OD FOR 1/4" SHAFT	PART	6
42	95003	1/4"-20 X 3/4" FLAT HEAD	PART	6
43	95016	1/4"-20 X 5/8" SOCKET CAP	PART	6
44	95017	1/4"-20 X 1/2" SOCKET CAP	PART	26
45	95026	1/8" SQ. X .500"L KEY STOCK	PART	4
46	95073	10-32 X 1/4"L FLAT HEAD SCREW	PART	8
47	95092	10-32 X 3/8" FLAT HEAD	PART	2
48	95158	1/4" X .125" NYLON SPACER	PART	8
49	95175	1/4"-20 X 3/8"L PAN HEAD	PART	6
50	95234	1/4"-20 X 5/8" LOW HD CAP SCW	PART	16
51	95294	ROTOCLIP DTX-4	PART	4
52	95308	BALL BEARING 1-3/8" OD 5/8" SHAFT	ASSEMBLY	4
53	95340	3/8"-16 X 1-1/4" CAP SCREW	PART	16
54	95350	8.25 EXTENSION	BULK ITEM	1
55	95366	WIRE EXTENSION CLIP	BULK ITEM	1
56	95368	1/8" SQ. X .250"L KEY STOCK	PART	4
57	95385	T2 INSIDE COVER (AUTO ADJ)	PART	2
58	95386	T2 OUTSIDE COVER	PART	2
59	95391	T2 AUTO ADJ TUG OWNERS MANUAL	PART	1
60	95394	29.2V POWER SUPPLY 7A	PART	1
61	95396	T2 RAIL END COVER	PART	4
62	95415	1/4"-20 X 1/2" L PAN HEAD	PART	4
63	95463	SS THIN NYLON-INSERT LOCK NUT	PART	2
64	95503	24V 20AH BATTERY	PART	2
65	95553	SPEED CONTROL 2020	PART	4
66	95554	#4-24 THRD-FORM SCREW FOR PLASTIC	PART	16
67	95615	3/8"-16 X 1-1/2"L LOW SOCKE. HD SCREW	PART	2
68	95624	10-32 X 3/8" PHILLIPS SCREW, THREAD LOCK	PART	24
69	97021	6-32X3/8"L PHILIPS SCREW	PART	4
70	93553A	SS MAGNETIC LATCH	PART	4
71	93553B	93553 SS MAGNET STRIKE PLATE	PART	4

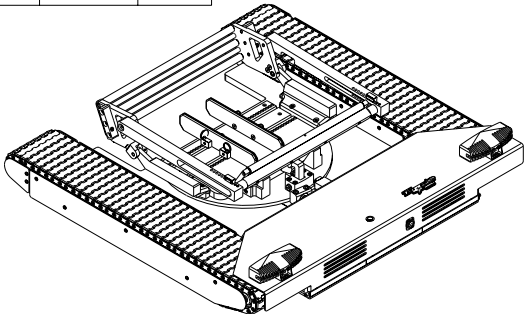

*A Touch of Brass*  
A TOUCH OF BRASS INC  
13832 MAGNOLIA AVE.  
CHINO, CA 91710-7027  
909-464-1000

**T2W2 TUG ASSEMBLY**

DWG. NO. **09878**

REV  
K

UNLESS OTHERWISE SPECIFIED, DIMENSIONS ARE IN INCHES.

SCALE 0.060

APPR.

SHEET 1 OF 11

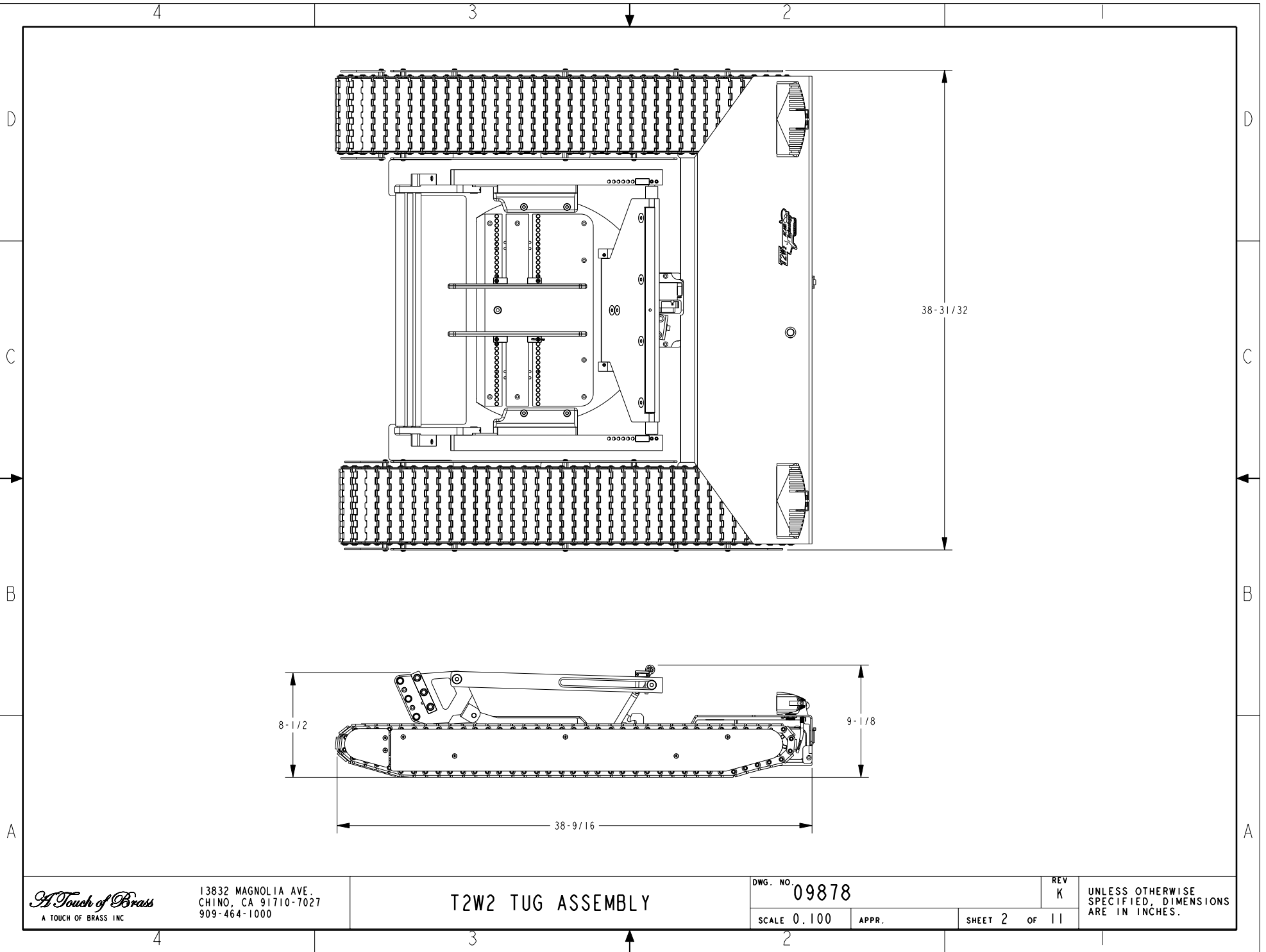

*A Touch of Brass*  
A TOUCH OF BRASS INC

13832 MAGNOLIA AVE.  
CHINO, CA 91710-7027  
909-464-1000

T2W2 TUG ASSEMBLY

DWG. NO. 09878

REV K

SCALE 0.100

APPR.

SHEET 2 OF 11

UNLESS OTHERWISE SPECIFIED, DIMENSIONS ARE IN INCHES.

BLUE REMOVABLE LOCTITE

REPLACE ASSEMBLY SCREW WITH 95615  
NO GLUE UNTIL LAZY SUSAN IS INSTALLED

### BILL OF MATERIAL (CURRENT LEVEL)

ITEM	PT/ASSY	DESCRIPTION	TYPE	QTY.
1	09520	T2 GEARBOX ASSEMBLY	ASSEMBLY	2
2	09969	T2 DUAL LIFTER LATCH ASSMBLY	ASSEMBLY	1
3	22596	T2 SERVO CAM	PART	1
4	23145	COVER MOUNT BAR	PART	3
5	23466	T2 MOTOR PLATE	PART	2
6	23712	MP GLIDE SHAFT 1/4" OD X 1" L	PART	6
7	23713	ACETAL WASHER 1/4" ID X .050"	THICK	12
8	24284	T2W2 MAIN PLATE XL	PART	1
9	93560	#4, 1/4" L SELF-TAPPING SCREW	PART	8
10	94050	BEARING 5/8" OD FOR 1/4" SHAFT	PART	6
11	95016	1/4"-20 X 5/8" SOCKET CAP	PART	6
12	95017	1/4"-20 X 1/2" SOCKET CAP	PART	24
13	95234	1/4"-20 X 5/8" LOW HD CAP SCW	PART	16
14	95615	3/8"-16 X 1-1/2" L LOW SOCKE. HD SCRBW	PART	2
15	93553B	93553 SS MAGNET STRIKE PLATE	PART	4

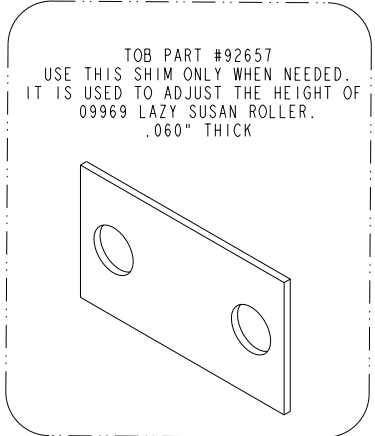
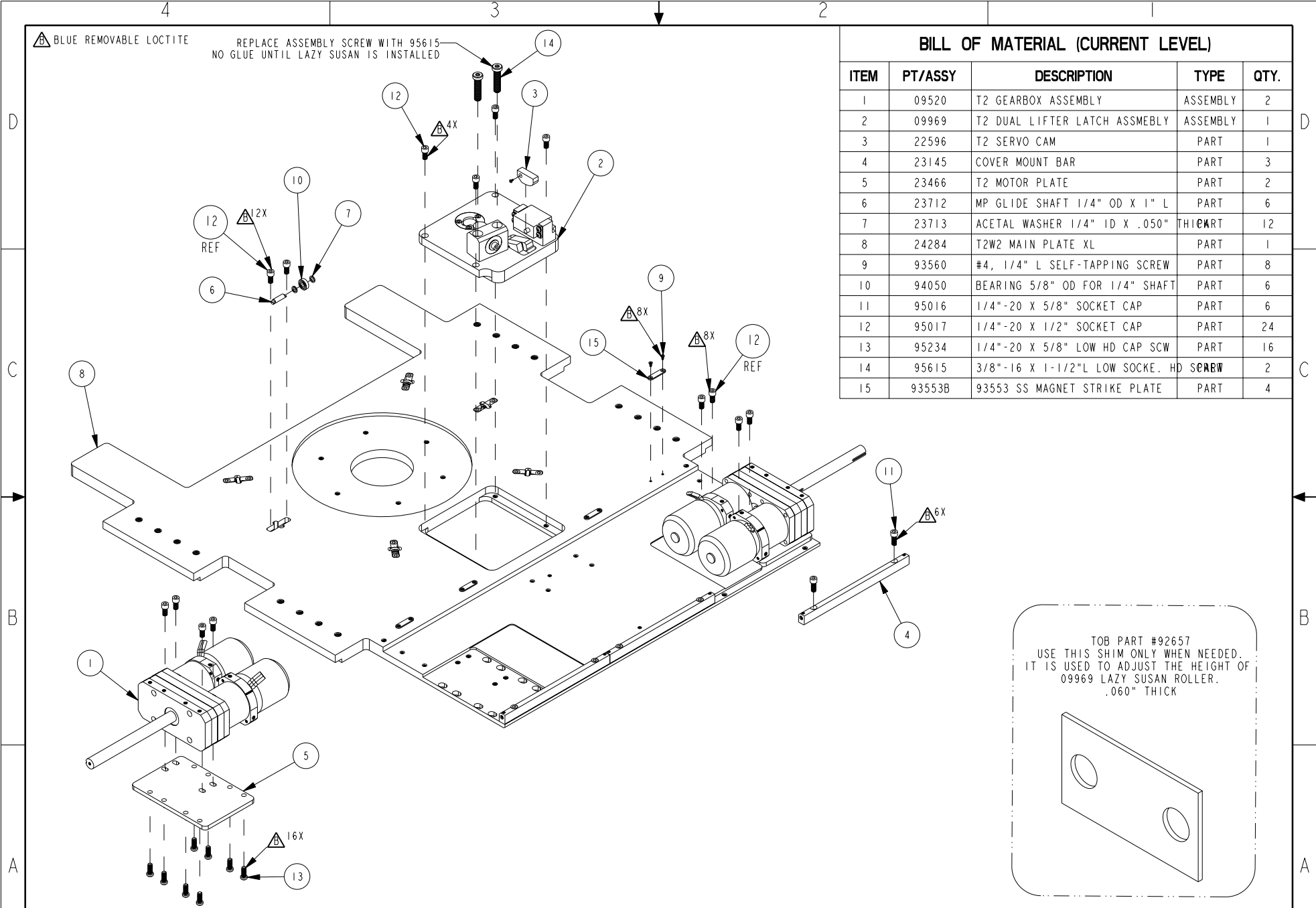

*A Touch of Brass*  
A TOUCH OF BRASS INC  
13832 MAGNOLIA AVE.  
CHINO, CA 91710-7027  
909-464-1000

## T2W2 TUG ASSEMBLY

DWG. NO. 09878	REV K	UNLESS OTHERWISE SPECIFIED, DIMENSIONS ARE IN INCHES.
SCALE 0.140	APPR.	

**BILL OF MATERIAL (CURRENT LEVEL)**

ITEM	PT/ASSY	DESCRIPTION	TYPE	QTY.
1	09829	T2 ALL-IN-ONE PC BOARD	ASSEMBLY	1
2	23757	T1.5V2 PCB SUPPORT	PART	2
3	92039	PUSH MOUNT CABLE TIE	PART	8
4	92266	10-24 X 7/8" L SS CAP SCREW	PART	2
5	93549	T1.7 MOTOR COVER	PART	2
6	95158	1/4" X .125" NYLON SPACER	PART	8
7	95415	1/4"-20 X 1/2" L PAN HEAD	PART	4
8	95553	SPEED CONTROL 2020	PART	4
9	95554	#4-24 THRD-FORM SCREW FOR PLASTIC	PART	16
10	97021	6-32X3/8"L PHILIPS SCREW	PART	4

▲ BLUE REMOVABLE LOCTITE

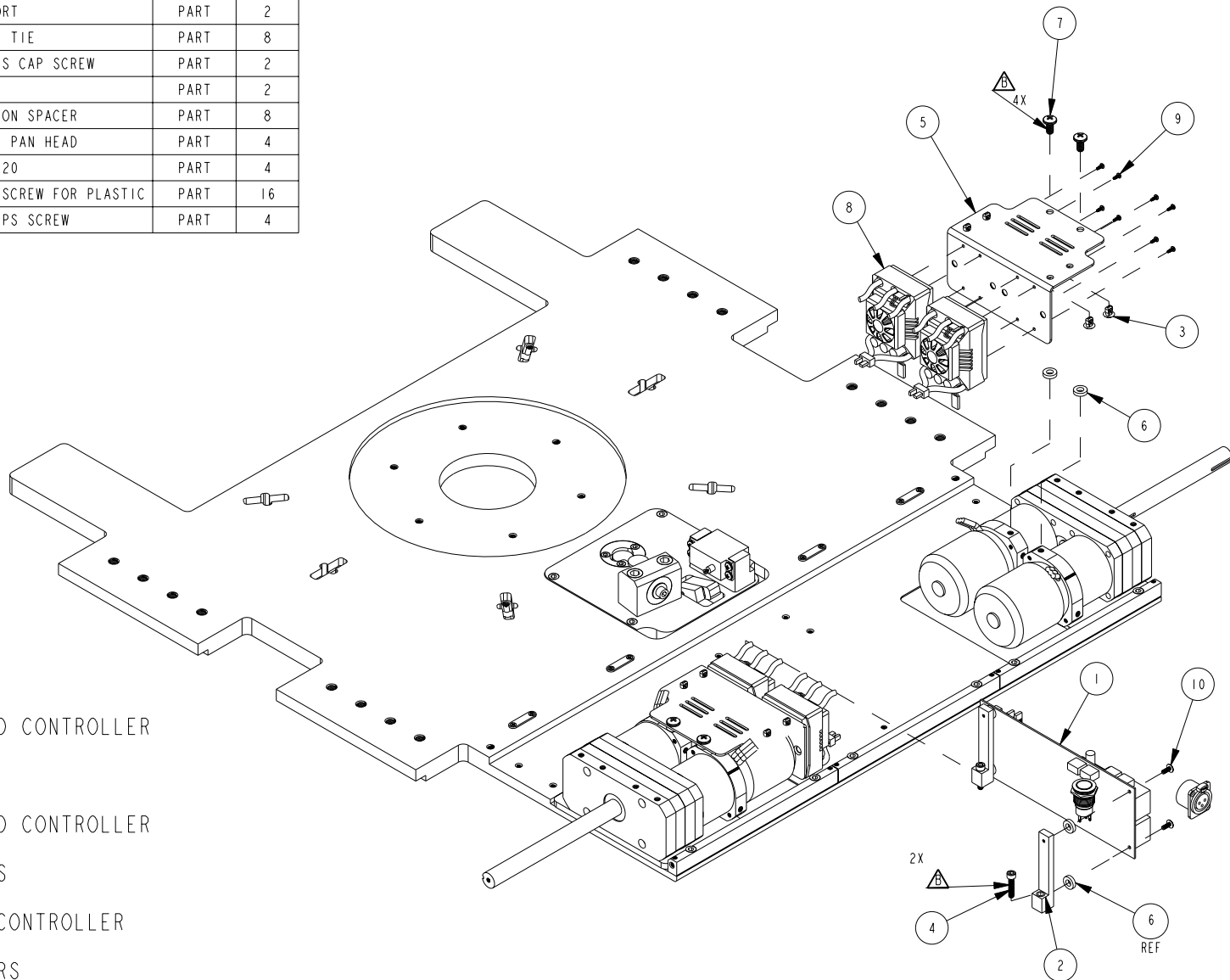

**T2W2 WIRE CONNECTION:**

ORANGE WIRES FROM SPEED CONTROLLER  
CONNECT TO  
RED WIRES FROM MOTORS

YELLOW WIRES FROM SPEED CONTROLLER  
CONNECT TO  
BLACK WIRES FROM MOTORS

BLUE WIRES FROM SPEED CONTROLLER  
CONNECT TO  
YELLOW WIRES FROM MOTORS

*A Touch of Brass*  
A TOUCH OF BRASS INC

13832 MAGNOLIA AVE.  
CHINO, CA 91710-7027  
909-464-1000

**T2W2 TUG ASSEMBLY**

DWG. NO. **09878**

REV **K**

UNLESS OTHERWISE SPECIFIED, DIMENSIONS ARE IN INCHES.

SCALE 0.170

APPR.

SHEET 4 OF 11

NOTES:

BLUE REMOVABLE LOCTITE

LOCTITE JOINT (GREEN)

**BILL OF MATERIAL (CURRENT LEVEL)**

ITEM	PT/ASSY	DESCRIPTION	TYPE	QTY.
1	09857	(PAIR) T2 LEVER ADJ RAIL ASM	ASSEMBLY	1
2	22422	TUG SHAFT RETAINER	PART	2
3	23559	7 TOOTH T2 DRIVE SPROCKET	PART	4
4	23642	T2 V2 MOTOR SPACER	PART	2
5	95026	1/8" SQ. X .500"L KEY STOCK	PART	4
6	95092	10-32 X 3/8" FLAT HEAD	PART	2
7	95308	BALL BEARING 1-3/8" OD 5/8" SHA	ASSEMBLY	4
8	95340	3/8"-16 X 1-1/4" CAP SCREW	PART	16
9	95368	1/8" SQ. X .250"L KEY STOCK	PART	4

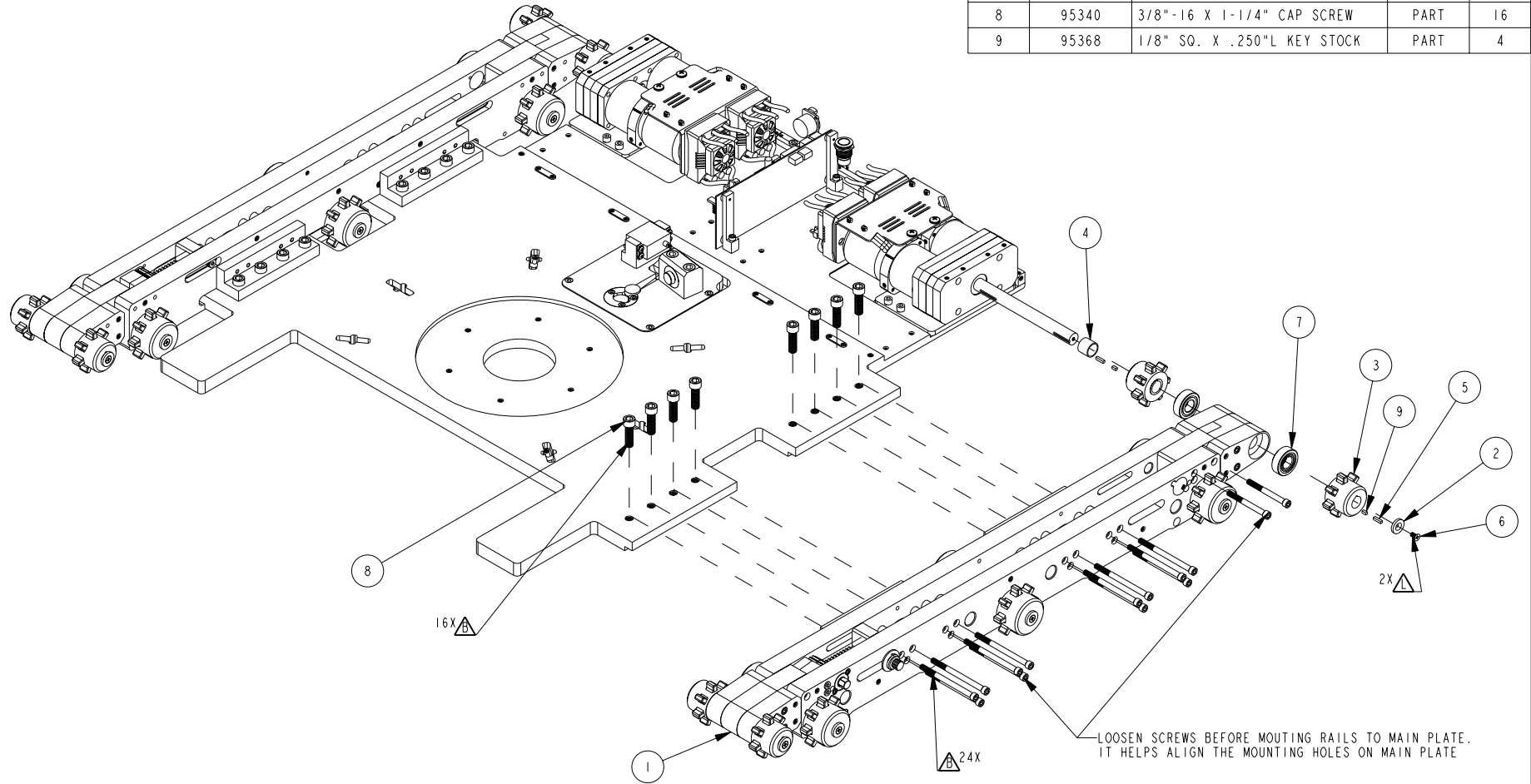

*A Touch of Brass*  
A TOUCH OF BRASS INC

13832 MAGNOLIA AVE.  
CHINO, CA 91710-7027  
909-464-1000

**T2W2 TUG ASSEMBLY**

DWG. NO. **09878**

REV  
K

UNLESS OTHERWISE  
SPECIFIED, DIMENSIONS  
ARE IN INCHES.

SCALE 0.130

APPR.

SHEET 5 OF 11

▲ BLUE REMOVABLE LOCTITE

**BILL OF MATERIAL (CURRENT LEVEL)**

ITEM	PT/ASSY	DESCRIPTION	TYPE	QTY.
1	09888	T2V2 BATTERY COVER ASM	ASSEMBLY	2
2	09923	T2 AUTO ADJ TRACK	ASSEMBLY	2
3	22958	6" TRACK PIN	PART	2
4	93557	T2V2 SHROUD END LEFT	PART	1
5	93558	T2V2 SHROUD END RIGHT	PART	1
6	95073	10-32 X 1/4"L FLAT HEAD SCREW	PART	8
7	95175	1/4"-20 X 3/8"L PAN HEAD	PART	6
8	95294	ROTOCLIP DTX-4	PART	4

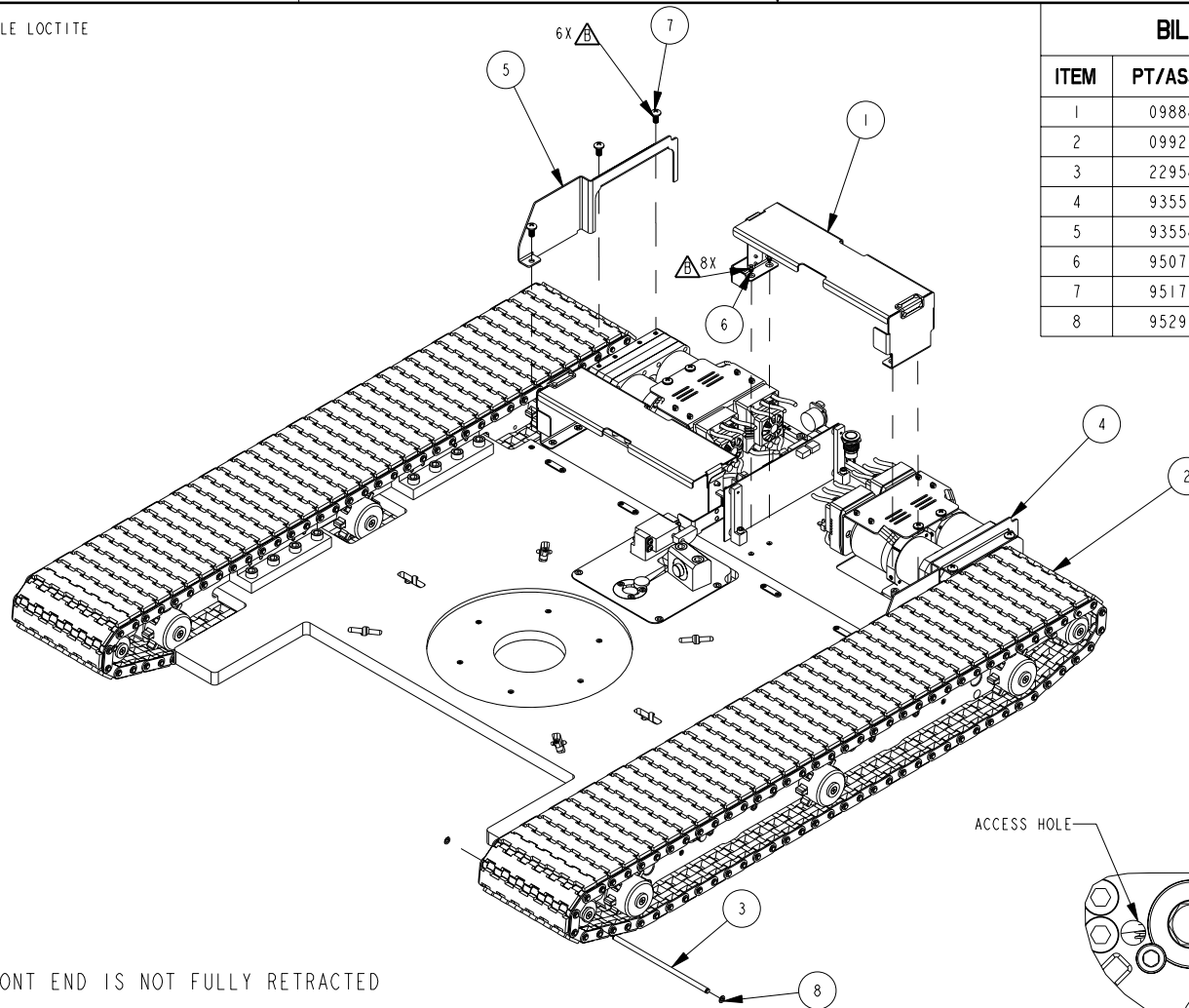

NOTES:

IF RAIL FRONT END IS NOT FULLY RETRACTED

1. LOOSEN THE RETAINER BOLT WITH A 7/16" SOCKET
2. SLIGHTLY ROTATE THE HEX WITH 7/16" SOCKET TO RELEASE TENSION FROM THE PINION
3. WITH HEX SLIGHTLY ROTATED INSERT A 1/4" DIAMETER SCREW DRIVE INTO THE ACCESS HOLE TO RELEASE THE INTERNAL MECHANISM
4. ROTATE HEX WITH 7/16" SOCKET TO RETRACT FRONT END
5. REMOVE THE SCREW DRIVE TO RELEASE THE INTERNAL MECHANISM
6. ROTATE HEX WITH 7/16" SOCKET TO ADJUST TENSION. (SHOULD ONLY ROTATE IN ONE DIRECTION)

ELSE

SEE STEP 6

DWG. NO. **09878**

REV  
K

UNLESS OTHERWISE SPECIFIED, DIMENSIONS ARE IN INCHES.

SCALE 0.110

APPR.

SHEET 6 OF 11

*A Touch of Brass*  
A TOUCH OF BRASS INC

13832 MAGNOLIA AVE.  
CHINO, CA 91710-7027  
909-464-1000

**T2V2 TUG ASSEMBLY**

▲ BLUE REMOVABLE LOCTITE

**BILL OF MATERIAL (CURRENT LEVEL)**

ITEM	PT/ASSY	DESCRIPTION	TYPE	QTY.
1	09992	T2W2 CRADLE XL	ASSEMBLY	1
2	95003	1/4"-20 X 3/4" FLAT HEAD	PART	6
3	95503	24V 20AH BATTERY	PART	2

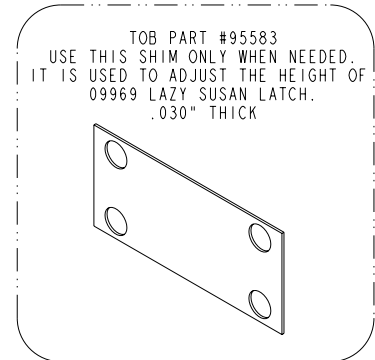
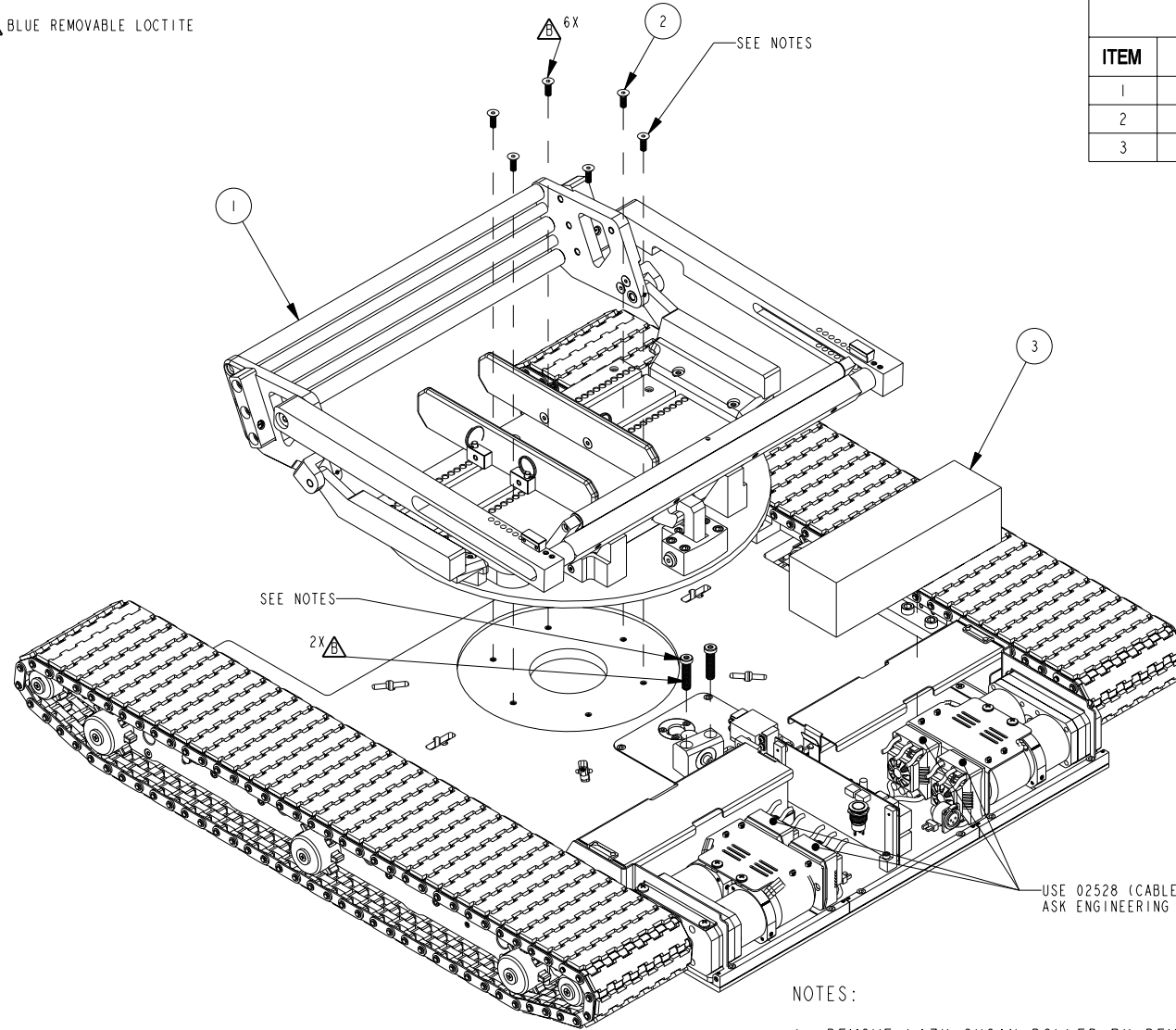

USE 02528 (CABLE CLAMP KIT) TO SECURE 4X 95563 (SPEED CONTROLS)  
ASK ENGINEERING FOR INSTALL. INSTRUCTIONS

**NOTES:**

1. REMOVE LAZY SUSAN ROLLER BY REMOVING 2 SCREWS, LAZY SUSAN NEEDS TO ROTATE 90° TO INSTALL THE LAZY SUSAN ONTO THE MAIN PLATE. BE AWARE OF THE TURNING LIMITATION OF THE LAZY SUSAN, \*\*WITHOUT THE ROLLER THE LAZY SUSAN WILL HIT THE TRACKS AND ELECTRONICS COVER.\*\*
2. ASSEMBLE (6X) 95003 THROUGH HOLE ON LAZY SUSAN WHEEL PLATE
3. REINSTALL THE LAZY SUSAN ROLLER AND SCREWS. ADD BLUE LOCTITE TO SCREWS.

*A Touch of Brass*  
A TOUCH OF BRASS INC

13832 MAGNOLIA AVE.  
CHINO, CA 91710-7027  
909-464-1000

**T2W2 TUG ASSEMBLY**

DWG. NO. **09878**

REV  
K

UNLESS OTHERWISE SPECIFIED, DIMENSIONS ARE IN INCHES.

SCALE 0.125

APPR.

SHEET 7 OF 11

 BLUE REMOVABLE LOCTITE

BILL OF MATERIAL (CURRENT LEVEL)				
ITEM	PT/ASSY	DESCRIPTION	TYPE	QTY.
1	09020	T2W2 LOGO PLATE W STUDS	ASSEMBLY	1
2	09538	LED LIGHT	ASSEMBLY	2
3	09724	T2 LIGHT KIT	ASSEMBLY	1
4	09929	T2V2 SHROUD-BRACK (V.081519)	ASSEMBLY	1
5	93554	M3 X 0.5MM, 8MM L FLAT HEAD SCREWPART	PART	8
6	93555	M3 X 0.5MM, HEX NUT	PART	8
7	95463	SS THIN NYLON-INSERT LOCK NUT	PART	2
8	93553A	SS MAGNETIC LATCH	PART	4

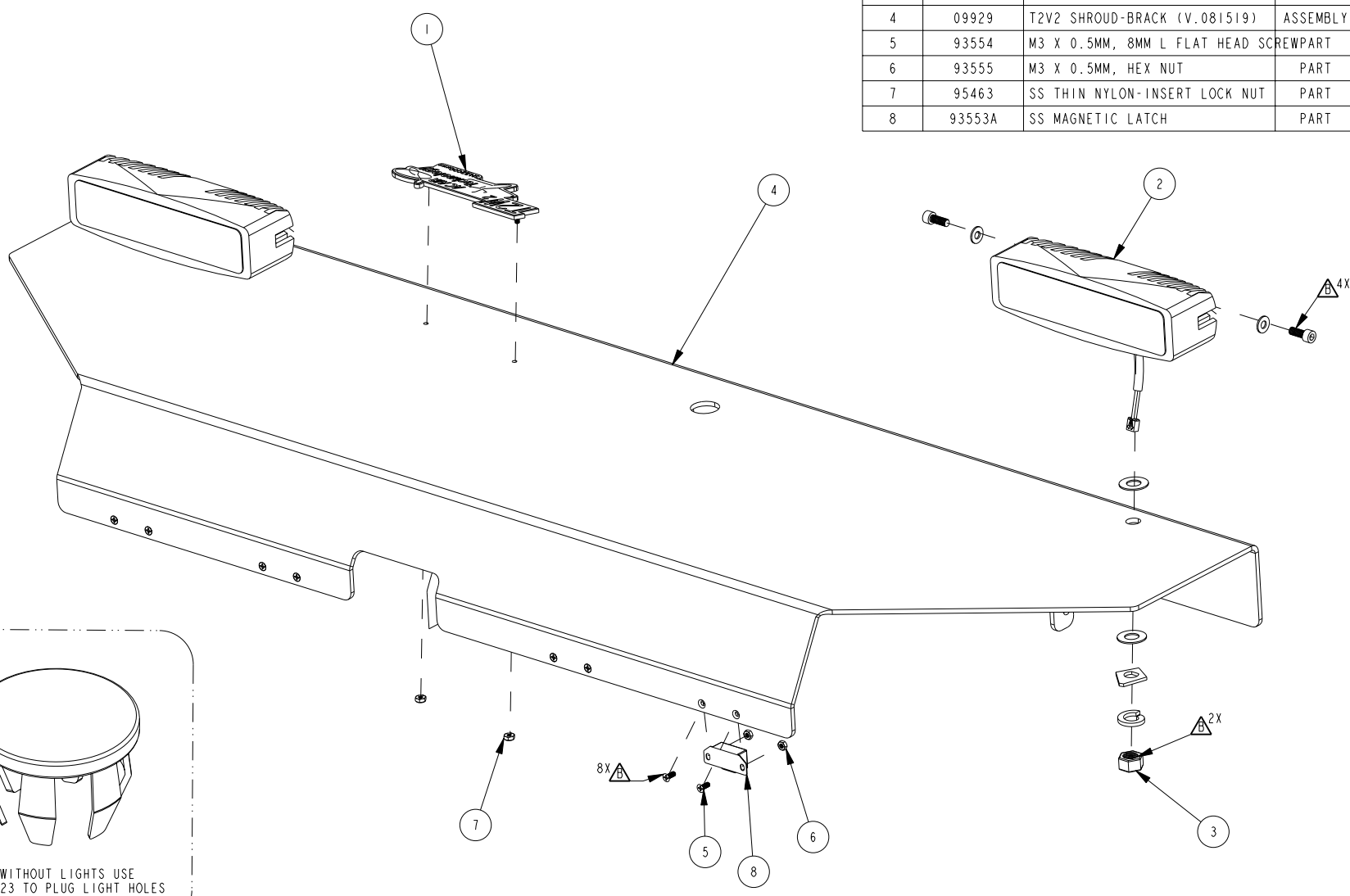

*A Touch of Brass*  
A TOUCH OF BRASS INC  
13832 MAGNOLIA AVE.  
CHINO, CA 91710-7027  
909-464-1000

T2W2 TUG ASSEMBLY

DWG. NO. 09878	REV K	UNLESS OTHERWISE SPECIFIED, DIMENSIONS ARE IN INCHES.
SCALE 0.250	APPR.	
SHEET 8 OF 11		



▲ BLUE REMOVABLE LOCTITE

**BILL OF MATERIAL (CURRENT LEVEL)**

ITEM	PT/ASSY	DESCRIPTION	TYPE	QTY.
1	92361	4-40X5/16"L FLAT HD SCW, PHIL	PART	2
2	92524	8-32 UNC X 1/8 SET SCREW	PART	2
3	95017	1/4"-20 X 1/2" SOCKET CAP	PART	2

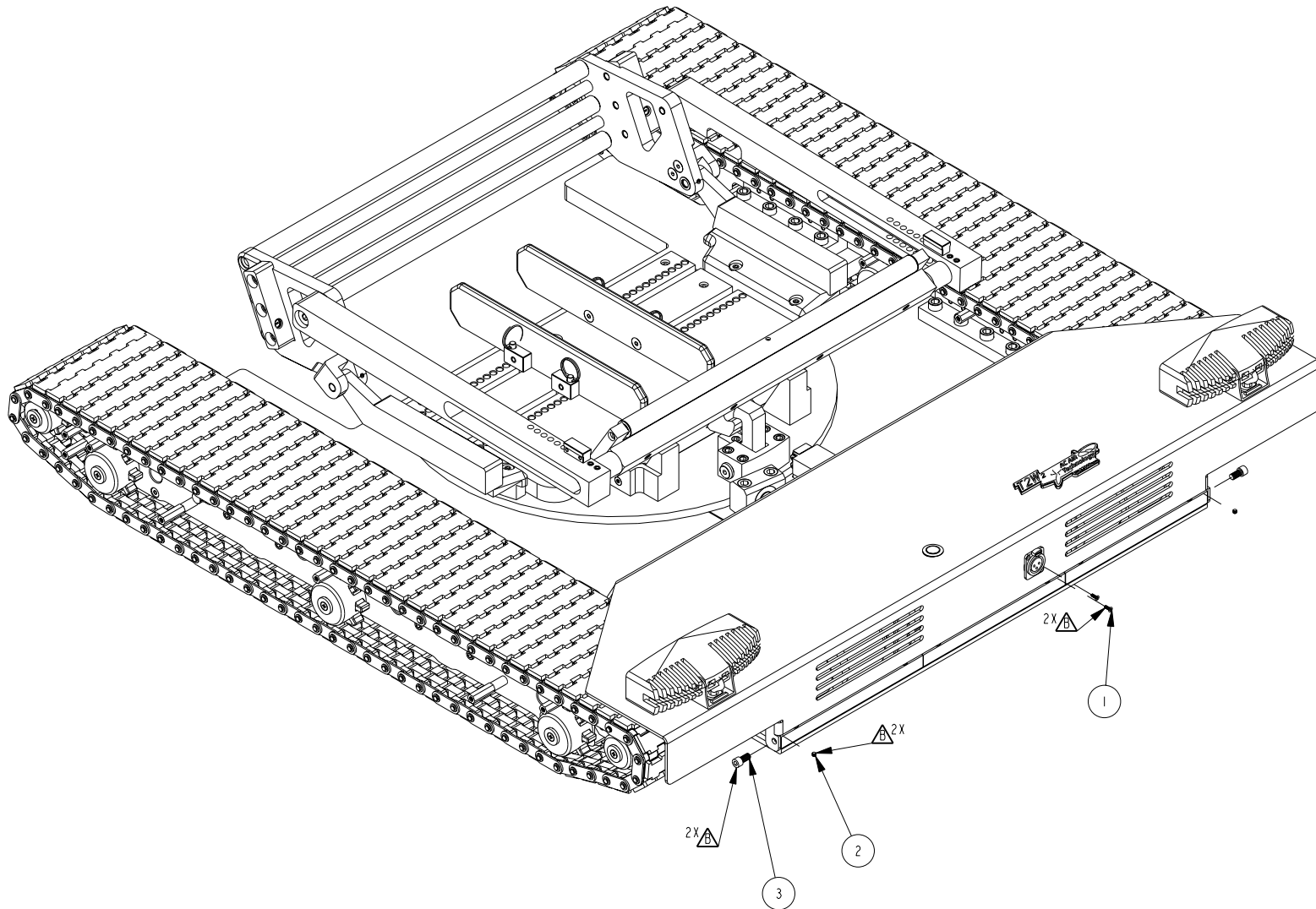

*A Touch of Brass*  
A TOUCH OF BRASS INC

13832 MAGNOLIA AVE.  
CHINO, CA 91710-7027  
909-464-1000

**T2W2 TUG ASSEMBLY**

DWG. NO. **09878**

REV  
A

UNLESS OTHERWISE SPECIFIED, DIMENSIONS ARE IN INCHES.

SCALE 2.000

APPR.

SHEET 9 OF 11

▲ BLUE REMOVABLE LOCTITE

▲ LOCTITE JOINT (GREEN)

**BILL OF MATERIAL (CURRENT LEVEL)**

ITEM	PT/ASSY	DESCRIPTION	TYPE	QTY.
1	22604	T2 TRACK STANDOFF	PART	24
2	92542	1/4-20 X .500"L SET SCREW SS	PART	24
3	95385	T2 INSIDE COVER (AUTO ADJ)	PART	2
4	95386	T2 OUTSIDE COVER	PART	2
5	95396	T2 RAIL END COVER	PART	4
6	95624	10-32 X 3/8" PHILLIPS SCREW, THREAD LOCK	PART	24

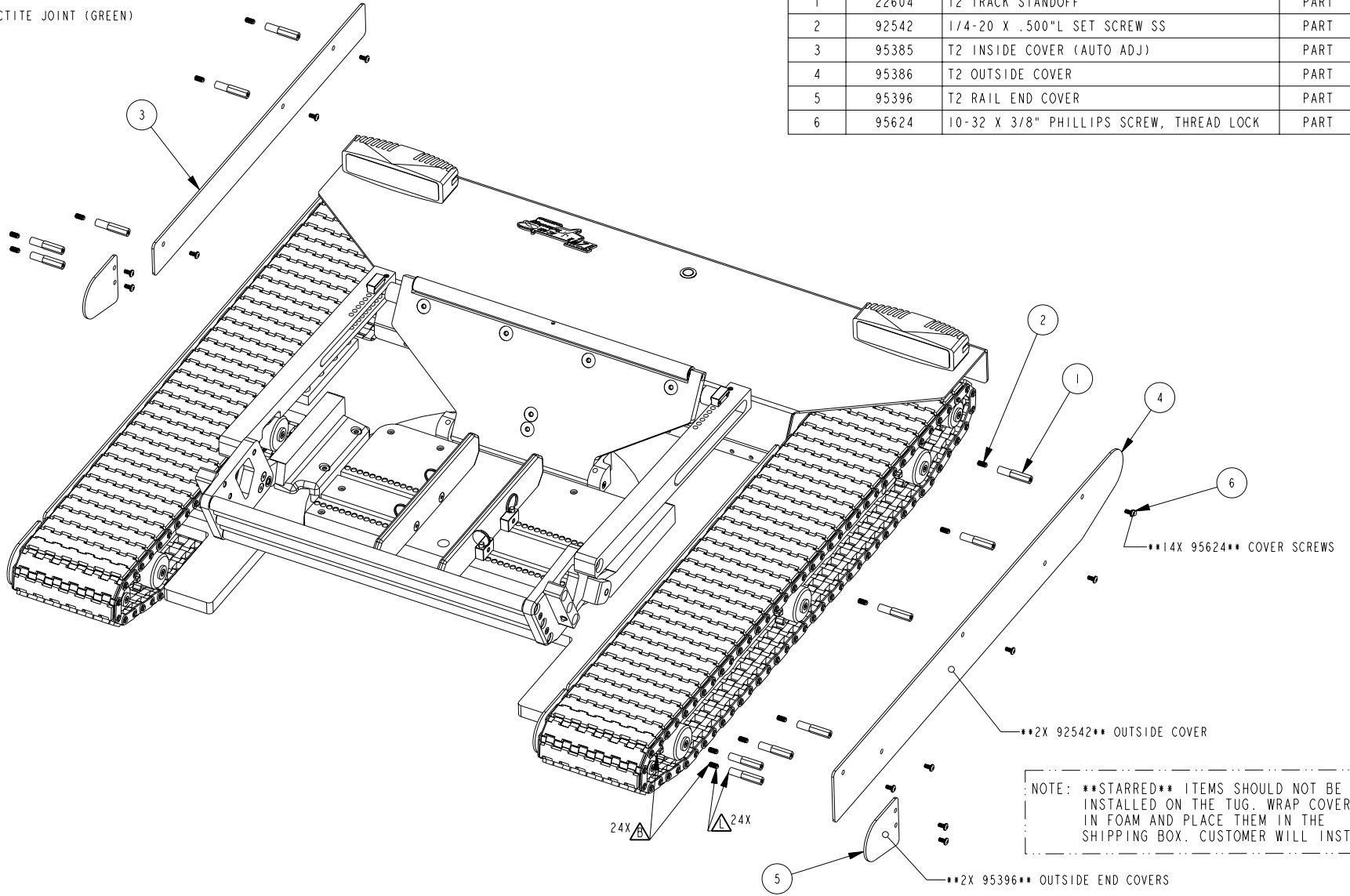

*A Touch of Brass*  
A TOUCH OF BRASS INC  
13832 MAGNOLIA AVE.  
CHINO, CA 91710-7027  
909-464-1000

**T2W2 TUG ASSEMBLY**

DWG. NO. <b>09878</b>	REV <b>K</b>	UNLESS OTHERWISE SPECIFIED, DIMENSIONS ARE IN INCHES.
SCALE <b>0.125</b>	SHEET <b>10</b> OF <b>11</b>	

BILL OF MATERIAL (CURRENT LEVEL)				
ITEM	PT/ASSY	DESCRIPTION	TYPE	QTY.
1	09551	T2 TRACK SPARE PARTS KIT	PART	1
2	09965	T2V2/T1.5 V2 RADIO W LIGHTS 201	ASSEMBLY	1
3	24255	SPLASH GUARD GUIDE PLATE	PART	2
4	95391	T2 AUTO ADJ TUG OWNERS MANUAL	PART	1
5	95394	29.2V POWER SUPPLY 7A	PART	1

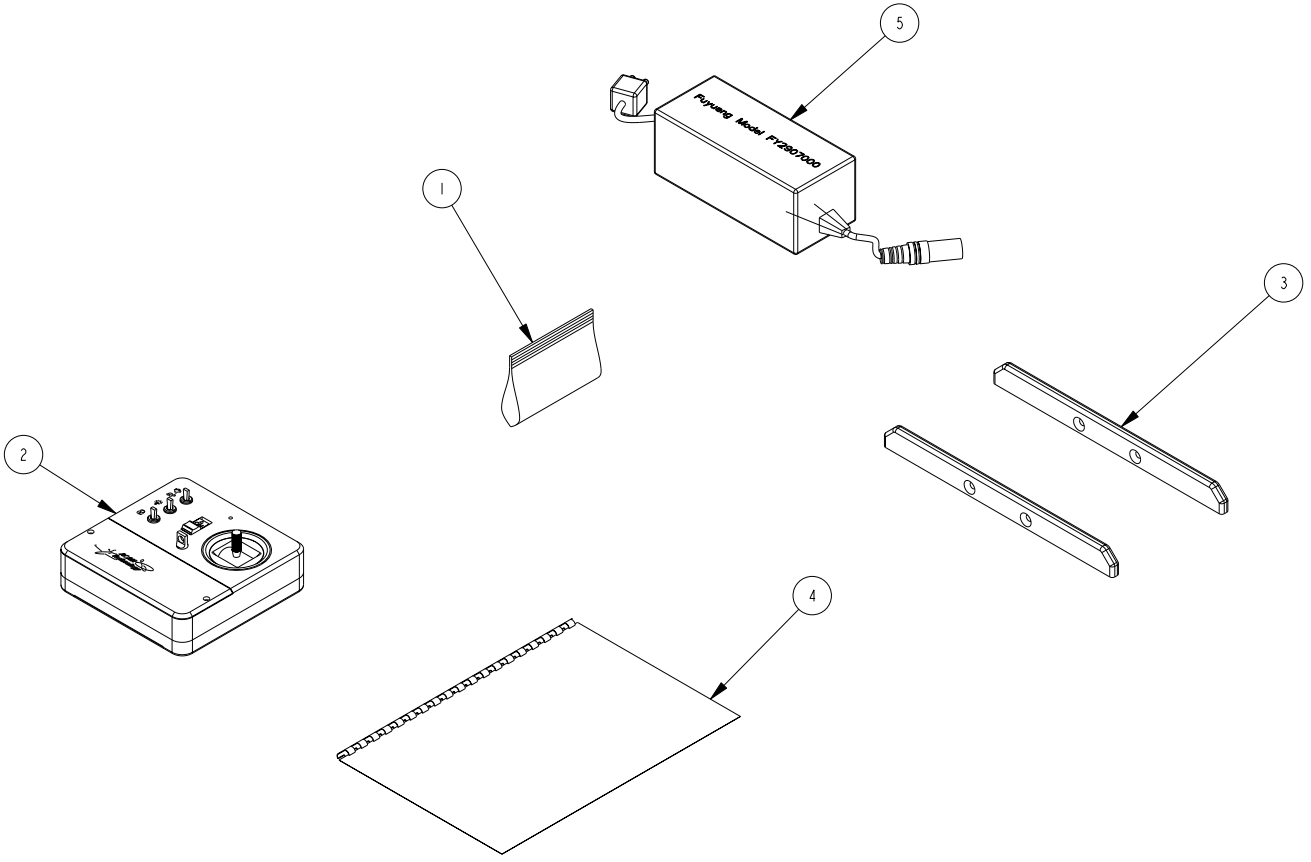

*A Touch of Brass*  
A TOUCH OF BRASS INC  
13832 MAGNOLIA AVE.  
CHINO, CA 91710-7027  
909-464-1000

T2W2 TUG ASSEMBLY

DWG. NO. 09878	REV K	UNLESS OTHERWISE SPECIFIED, DIMENSIONS ARE IN INCHES.
SCALE 0.150	APPR.	
SHEET 11 OF 11		