



-  LOCTITE JOINT (GREEN)
-  BLUE REMOVABLE LOCTITE
-  APPLY GREASE



BILL OF MATERIAL (CURRENT LEVEL)

ITEM	PT/ASSY	DESCRIPTION	TYPE	QTY.
1	22224	TUG ROLLER	PART	2
2	22225	TUG ROLLER AXLE	PART	4
3	22322	TUG LINK BAR	PART	2
4	22372	ADJUSTER PIN	PART	2
5	22423	TUG ROLLER SPACER	PART	4
6	23325	TIX RAMP PLATE	PART	1
7	23326	TIX RAMP SLIDER	PART	2
8	23327	TUG REAR ROLLER	PART	1
9	23328	TUG LATCH CATCH	PART	1
10	23329	TIX ROLLER PIN	PART	2
11	23330	TIX RAMP LOCK PLATE	PART	2
12	23334	TIX RAMP BRACE	PART	1
13	23335	TIX BACK LINK	PART	2
14	23336	TIX FRONT LINK	PART	2
15	23373	PLASTIC BUSHING	PART	2
16	23546	PIN HANDLE	PART	2
17	23839	TIX2 CRADLE FRONT JOINT	PART	2
18	23840	TIX RAMP PIVOT RIGHT	PART	1
19	23841	TIX2 CRADLE FRONT ARM R	PART	1
20	24383	CRADLE SHIM	PART	2
21	91428	8-32 X 3/8" L SS FLAT HEAD SCR	PART	2
22	92353	#10-24 3/8" Hex Nut 1/8" H	PART	1
23	92412	1/4"-20 NYLON INSERT NUT	PART	2
24	95006	1/4"-20 X 1" FLAT HEAD	PART	2
25	95024	3/8" NEEDLE ROLLER BEARING	PART	4
26	95041	SPRING PLUNGER	PART	2
27	95070	1/4"-20 SHOULDER SCREW, .375"L	PART	2
28	95095	10-24 X 1/4" L SET SCREW	PART	2
29	95117	1/4"-20 X 3/4" SOCKET CAP	PART	2
30	95347	1/4" DIA X 1-1/4" L SHOULDER SS	PART	1
31	95351	1/4" SHOULDER BOLT	PART	2
32	95460	5/16" DIA X 3/16" L SHOULDER X 1/4" PORT	PART	2
33	95470	1/4"-20 X 1-1/4" FLAT HEAD	PART	6
34	95571	1/4" C"SNK EXT. TTH. LOCK WASHER	PART	2

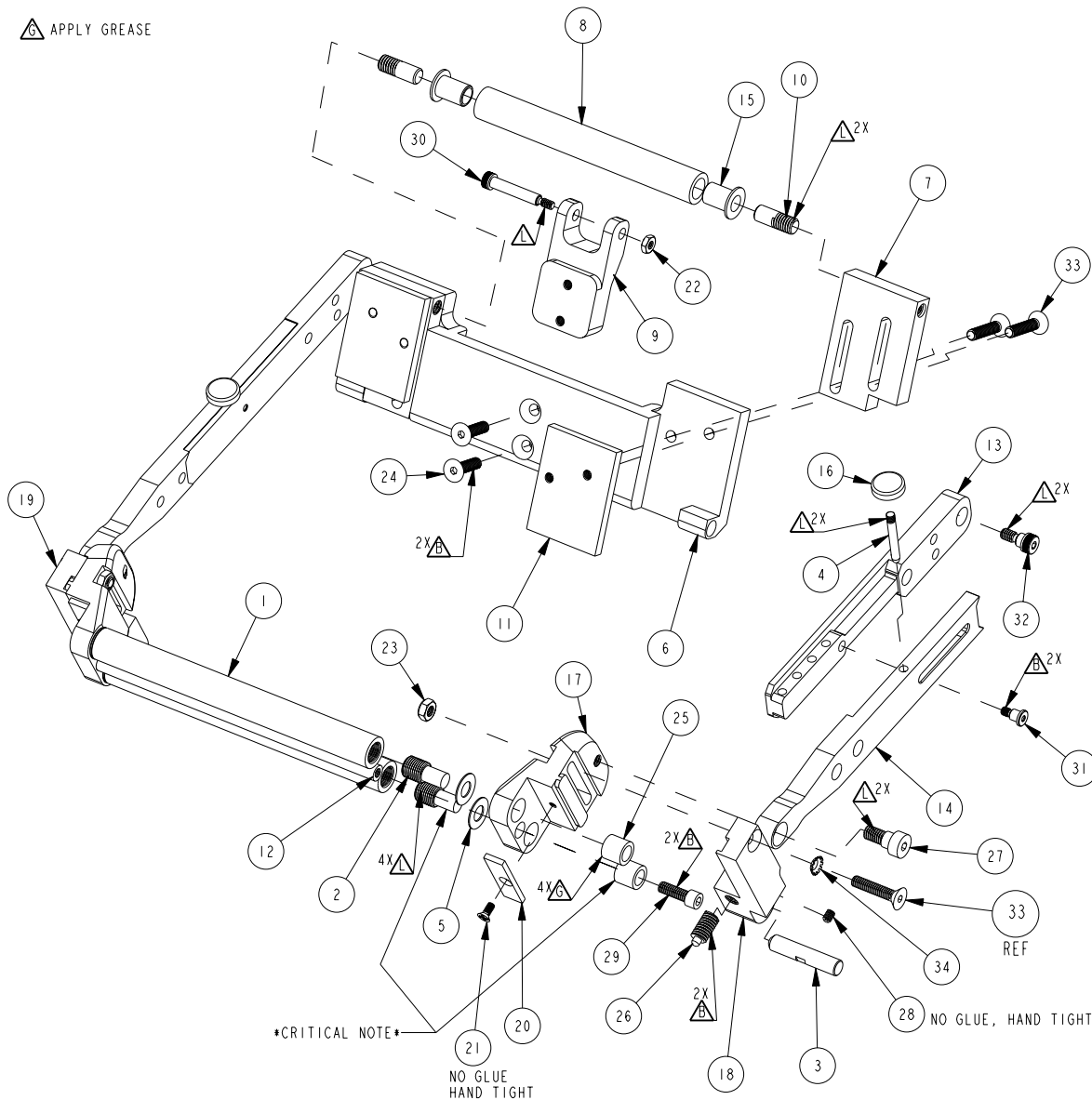
CRITICAL NOTE:
 PART 22225 SHOULD BE FLUSH WITH PART 95024. IF NOT, THREAD PART 22225 FURTHER IN UNTIL FLUSH. PART 22225 CANNOT BE PROTRUDING OUT FURTHER THAN PART 95024, THIS WILL EFFECT FINAL TUG ASSEMBLY.

A Touch of Brass
 A TOUCH OF BRASS INC
 13832 MAGNOLIA AVE.
 CHINO, CA 91710-7027
 909-464-1000

TIX2 ADJUSTABLE CRADLE

DWG. NO. **09561** REV **0**
 SCALE **0.250** APPR. SHEET **1** OF **1**
 UNLESS OTHERWISE SPECIFIED, DIMENSIONS ARE IN INCHES.