



1. Components

2. Installation Guide

2-1. Initial Setup

2-2. Loading

2-3. Warranty

1. Components

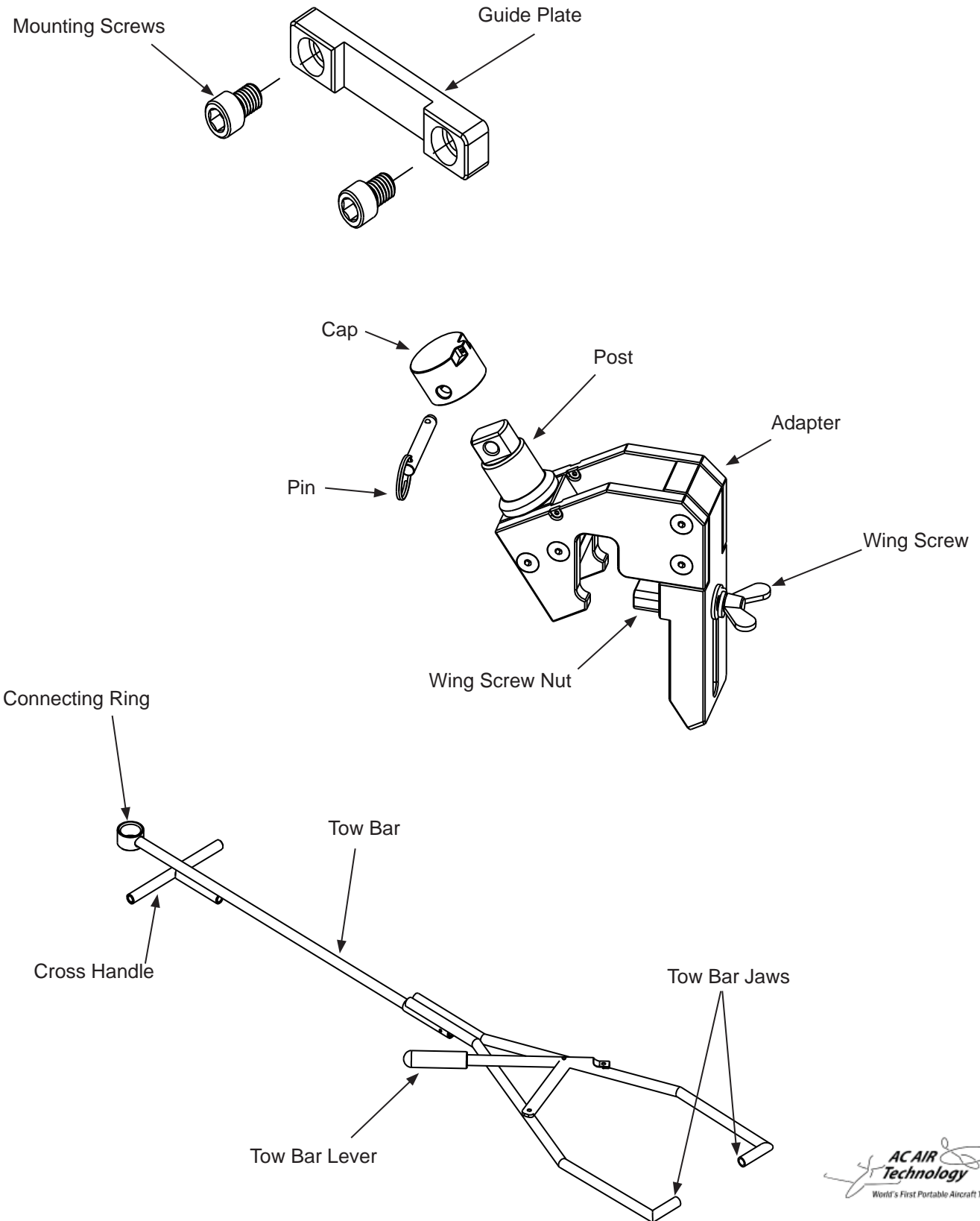

2. Installation Guide

2-1. Initial Setup

Required for installation :

5/16" Hex Drive

Removeable Threadlocker

1. Apply threadlocker onto the two mounting screws.
Note: The threads must be clean and dry for maximum strength.
2. With a 5/16" hex drive install the guide plate centered on the back gate brace of the lazy susan cradle.

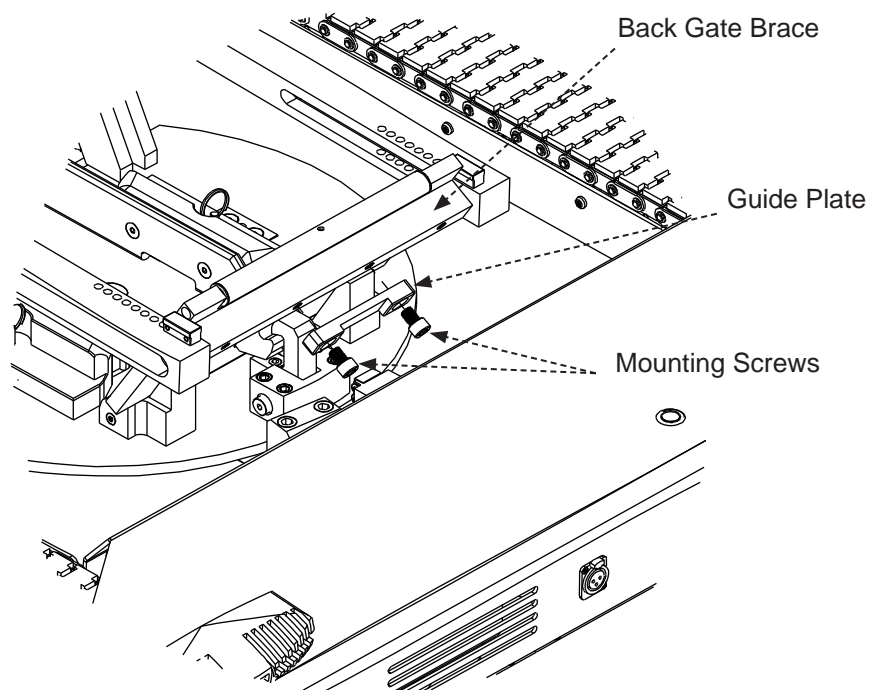

Note: The guide plate and mounting screws are installed once. They will not need to be removed for normal, non-cirrus, tug use.

2. Installation Guide

3. Loosen the wing screw allowing it to sit in the lowest position (keep wing screw loose).

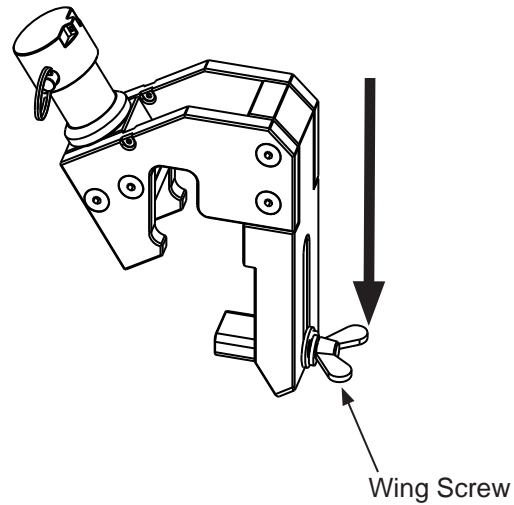

4. Position the wheel cradle in the up-position and confirm that the cradle latch is fully engaged. Position the adapter over the lazy susan back gate.

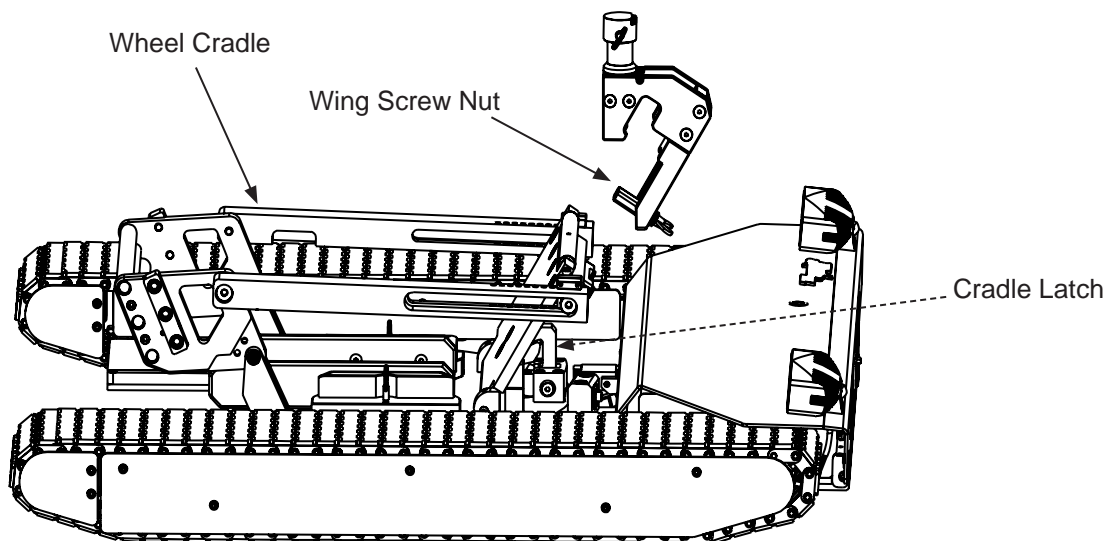

2. Installation Guide

5. The wing screw nut should sit underneath the back gate brace.

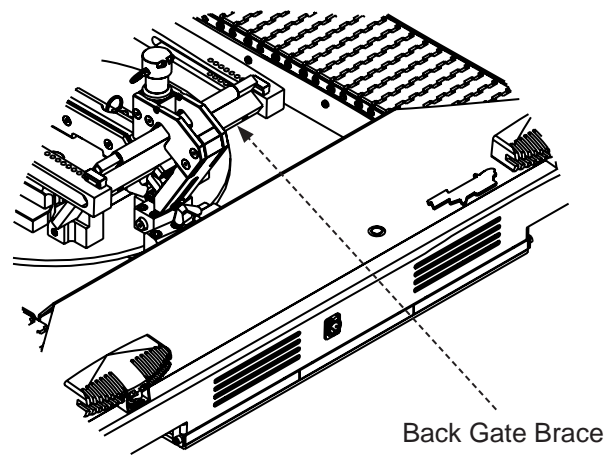

6. The adapter should sit in-between the guide plate step.

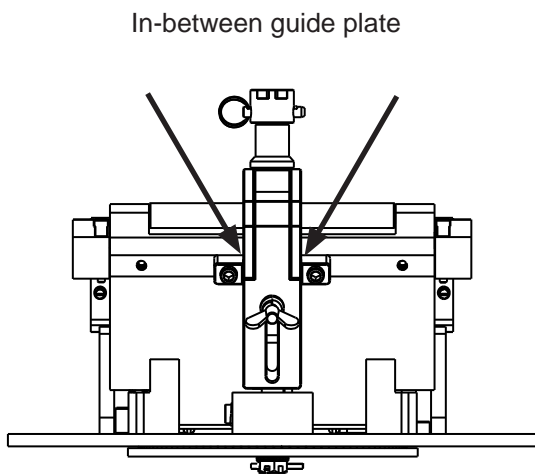

(View shows lazy susan only for clarity)

7. The adapter should sit against the front side of the back gate and over the back gate roller.

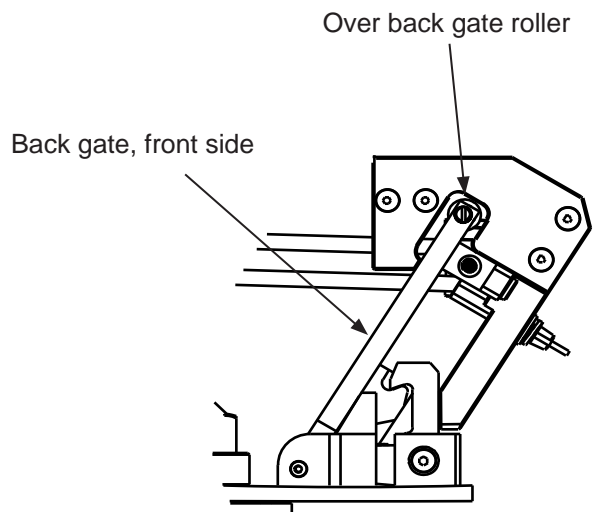

(View shows lazy susan only for clarity)

2. Installation Guide

8. Raise the wing screw until it sits flush with the bottom of the the back gate brace and tighten the wing screw to secure the adapter in place.

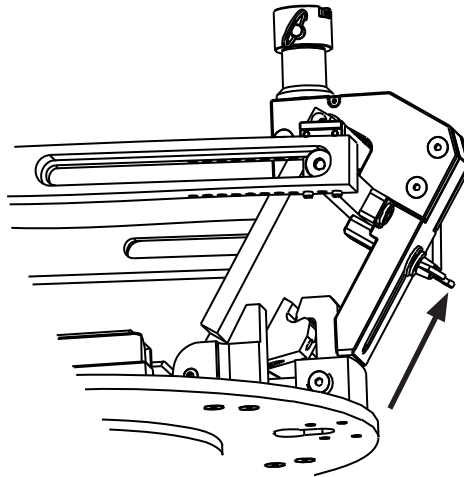

(View shows lazy susan only for clarity)

9. Open the tow bar jaws by rotating the tow bar lever to the open position and connect the tow bar to the front wheel.

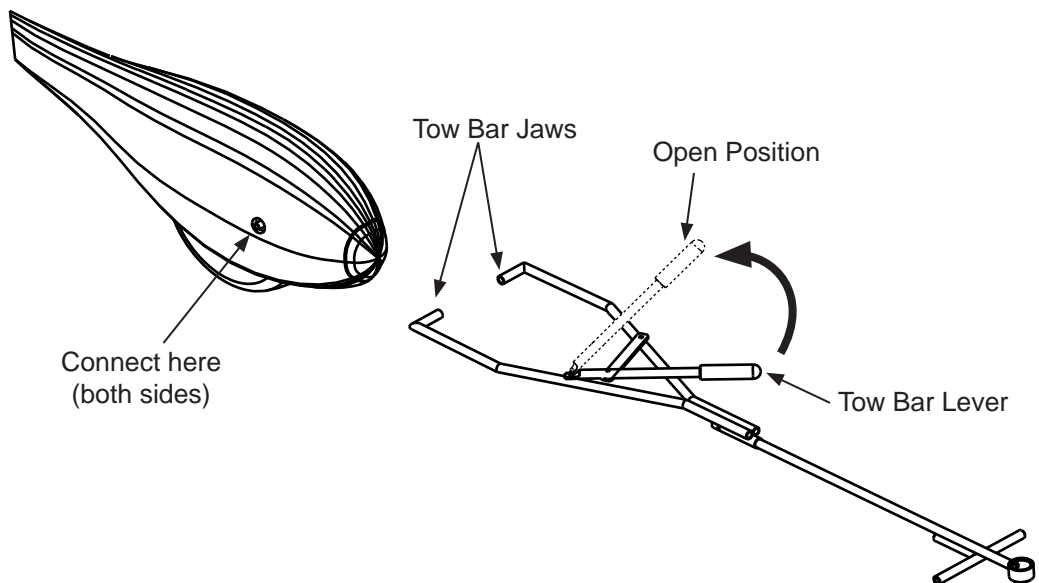

2. Installation Guide

10. Close the tow bar jaws to secure the tow bar into the front wheel.

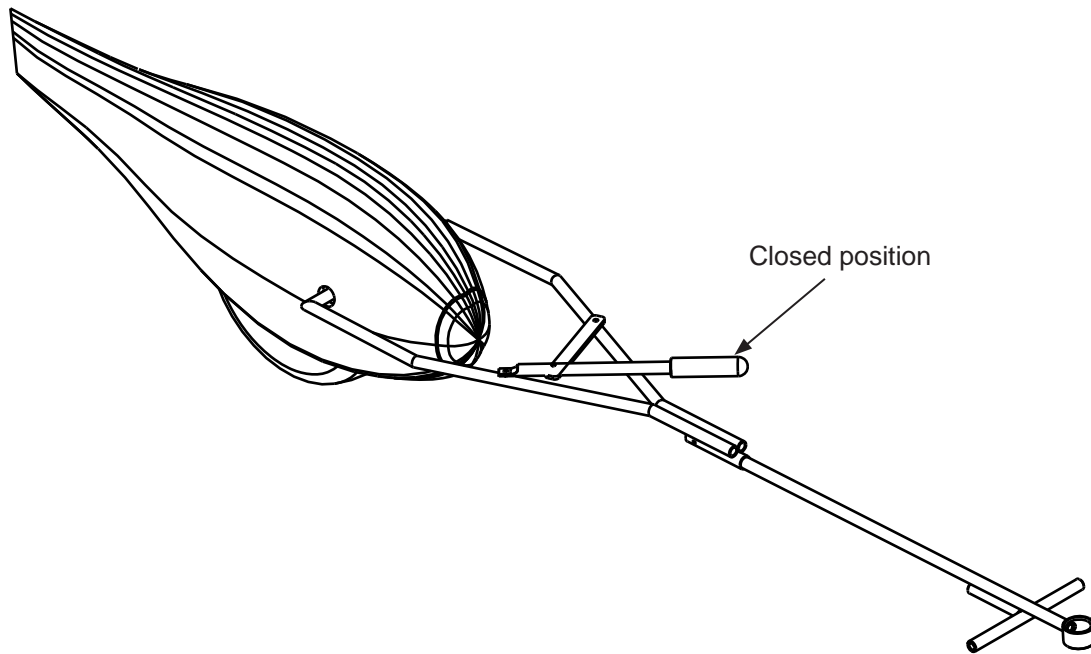

2. Installation Guide

2-2. Loading

1. Remove the pin and cap from the adapter post.

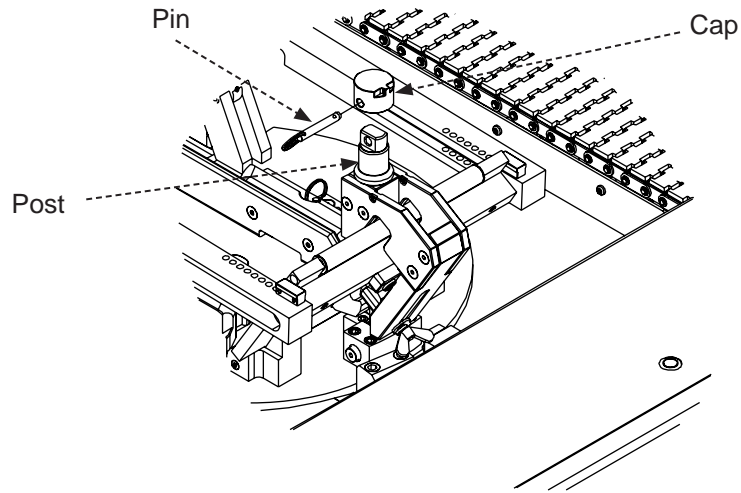

2. Maneuver the tug over to the tow bar and position the tow bar connecting ring onto the adapter post.

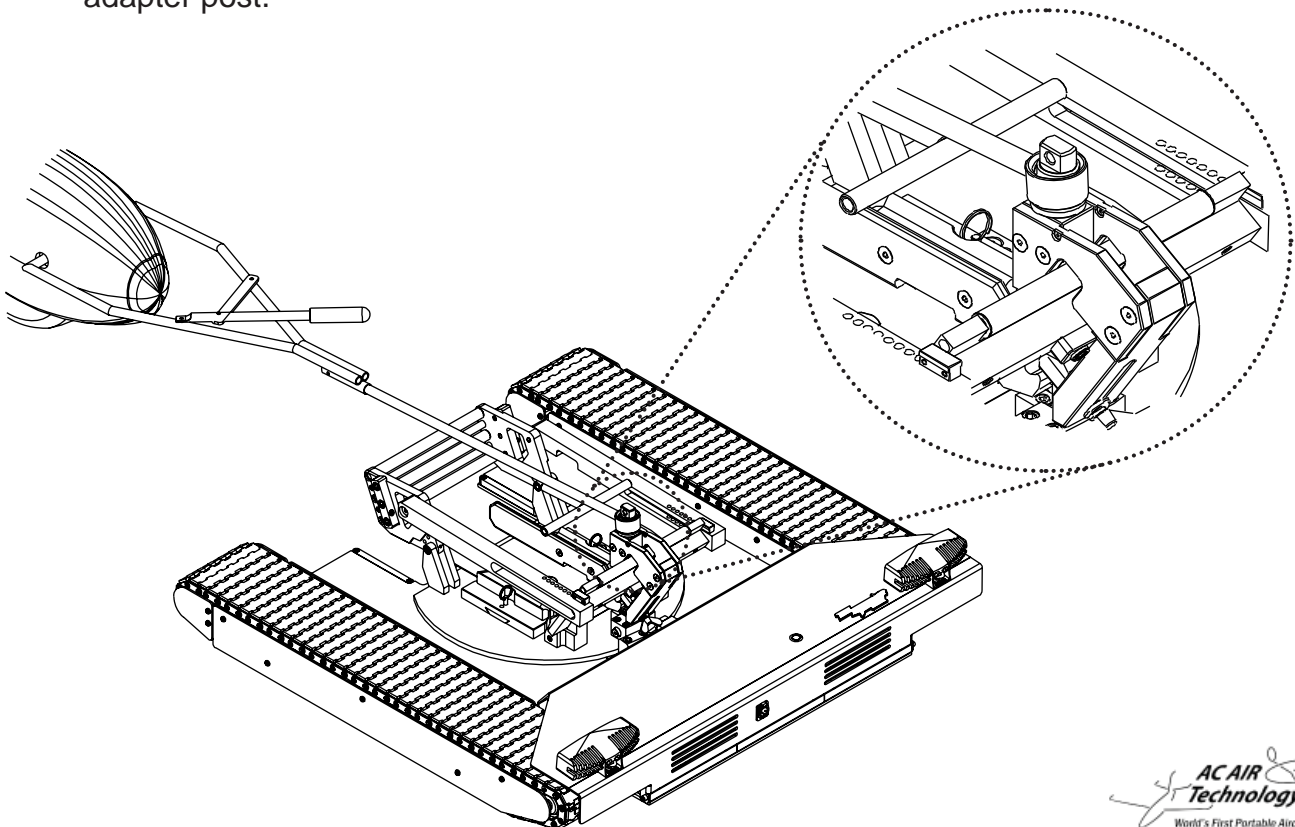

3. Reinstall the post cap and pin to secure the tow bar onto the adapter.

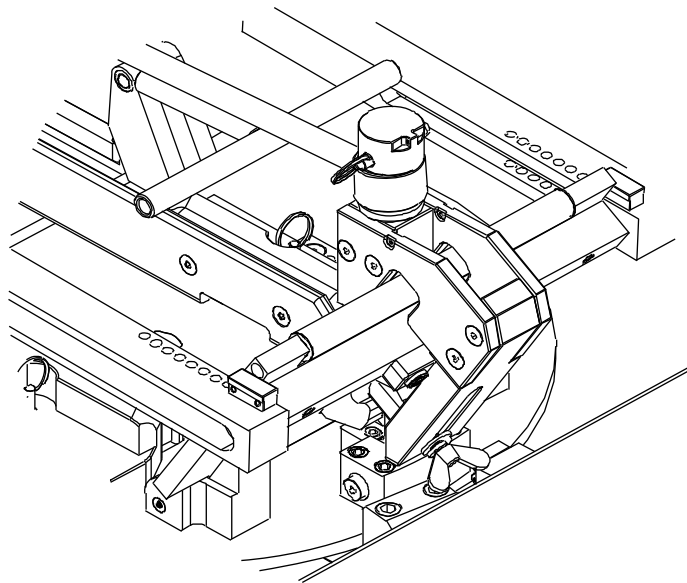

Tips for maneuvering with the Cirrus Towing Adapter

1. Moving your aircraft forward is the easiest way to control the aircraft.
2. Before moving your aircraft backward with the towing adapter have **ample** practice in an open space.
 - * When moving backwards with the towing adapter it is best to move in a straight line with the aircraft nose, tire, and tug facing the same direction.
 - * When moving backwards in a small space, the final position of the aircraft can be achieved by disconnecting the tow bar from the Cirrus towing adapter and manually maneuvering the aircraft to the desired final location.

2-3. Warranty

LIMITED WARRANTY

Your new AC Air Technology Tug is warranted to the original purchaser (only) for one full year from the date of purchase to be free from factory defects in material and workmanship. During this 12-month period, AC Air Technology will repair or replace, at our discretion, the defective component determined by AC Air Technology to be defective.

This warranty does not apply to damage or defect resulting from mis-use, improper application, commercial use, or attempted repair by “non-AC Air Technology” service staff. The warranty does not cover shipping or handling cost or any incidental or consequential damage. Batteries and tracks are not covered by warranty.

DAMAGE LIMITS

AC Air Technology shall not be liable for any damage, indirect or consequential, loss of profits or commercial or production loss, or other special loss or damage in any way connected with this product regardless whether such claim is based on warranty, in contract, negligence, or strict liability. In no event shall the liability of AC Air Technology exceed the individual price of the product on which liability is asserted. AC Air Technology has no control of the set up, application, use, modification, or misuse of this product, thus no liability shall be assumed or accepted for any resulting damage or injury. By the first act of use, set up or assembly, the user in using the product accepts all resulting liability. Failure to operate this product in a safe and responsible manner can result in damage or injury, both to the user as well as to others, the product, or property. This product is not a toy and is NOT intended to be used by children without adult supervision. It is essential to read the entire manual and warranty/liability information prior to first use/application/installation of this product to operate correctly and avoid damage/injury,

In cases where the purchaser or user are not prepared to accept liability associated with the use of this product, the user or purchaser is advised to return the unused product immediately in unused condition to the place of purchase.

RETURN PROCEDURE

When sending equipment in for requested warranty service, please include a note describing the problems/concerns with the equipment. You must include your name, address, telephone number and email for prompt service. To request warranty service, a copy of your original sales receipt must be included. Warranty is approved and performed at the discretion of AC Air Technology service department. You are required to pay all postage, shipping and insurance charges.

