

4-INCH INCANDESCENT LOW VOLTAGE NEW CONSTRUCTION NON - IC



ET400LVAT

FEATURES

- All-Nail bar hangers
- Bar hangers may be shortened for narrow joist spaces
- NM cable pry-outs and conduit knockouts in junction box
- Quick Connect wiring connectors included in junction box
- AIR-TITE™
- Die-formed housing and plaster frame
- Housing may be removed from plaster frame for junction box access
- Integral 120V transformer steps line voltage down to lamp voltage

Compliances may not apply to all product configurations. Please consult the product spec sheet for compliance details.

COMPLIANCES: UL/cUL Listed - Wet Location, UL/cUL Listed - Damp Location, UL/cUL Listed 1598 Luminaire, UL/cUL Listed for Feed Through, IP Rated, AIR-TITE™ Certified ASTM E283

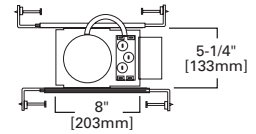
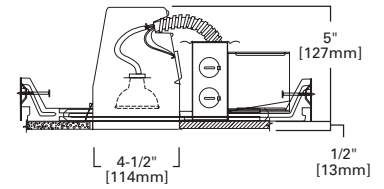

ORDERING INFORMATION: ORDER HOUSING AND TRIMS SEPARATELY^Δ

SAMPLE NUMBER: ET400LVAT - ERT401LVW

Housing	Trims	Reflectors
ET400LVAT=4" Aperture, New Construction, Non-IC, AIR-TITE™, 12V Low Voltage, MR16	<p>Adjustables</p> <p>ERT402LV Eyeball - 30° Tilt, 12V 50W MR16, OD: 5" [127mm] ERT402LV=High Gloss Appliance White Trim Ring with White Eyeball</p> <p>Baffles</p> <p>ERT401LV Baffle, 12V 50W MR16, OD: 5" [127mm] ERT401LV=High Gloss Appliance White Trim Ring with Black Baffle ERT401LVW=High Gloss Appliance White Trim Ring with White Baffle</p>	<p>Reflectors</p> <p>ERT403LV Reflector, 12V 50W MR16, OD: 5" [127mm] ERT403LV=High Gloss Appliance White Trim with Clear Specular Reflector ERT403LVG=High Gloss Appliance White Trim with Gold Reflector</p> <p>Slot Aperture</p> <p>ERT404LV Slot Aperture, 12V 50W MR16, OD: 5" [127mm] ERT404LV=High Gloss Appliance White Trim and Slot</p>

NOTES: Δ UL/cUL Listed for Wet Location with select trims. Δ Trim cover glass may be substituted with optional color or optical lens media. See accessories.

4-INCH INCANDESCENT LOW VOLTAGE REMODEL NON - IC



ET400LVRAT

FEATURES

- Quick Connect wiring connectors included in junction box
- Thermally protected
- AIR-TITE™
- Die-formed housing
- Remodel springs accommodate 1/2" and 5/8" ceiling material
- NM cable pry-outs and conduit knockouts in junction box
- Integral 120V transformer steps line voltage down to lamp voltage

Compliances may not apply to all product configurations. Please consult the product spec sheet for compliance details.

COMPLIANCES: UL/cUL Listed - Wet Location, UL/cUL Listed - Damp Location, UL/cUL Listed 1598 Luminaire, AIR-TITE™ Certified ASTM E283

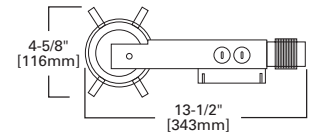
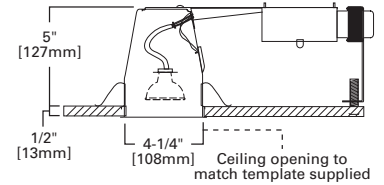

ORDERING INFORMATION: ORDER HOUSING AND TRIMS SEPARATELY^Δ

SAMPLE NUMBER: ET400LVRAT - ERT401LW

Housing	Trims	Reflectors
ET400LVRAT=4" Aperture, Remodel, Non-IC, AIR-TITE™, 12V Low Voltage, MR16	<p>Adjustables</p> <p>ERT402LV Eyeball - 30° Tilt, 12V 50W MR16, OD: 5" [127mm] ERT402LV=High Gloss Appliance White Trim Ring with White Eyeball</p> <p>Baffles</p> <p>ERT401LV Baffle, 12V 50W MR16, OD: 5" [127mm] ERT401LV=High Gloss Appliance White Trim Ring with Black Baffle ERT401LVW=High Gloss Appliance White Trim Ring with White Baffle</p>	<p>Reflectors</p> <p>ERT403LV Reflector, 12V 50W MR16, OD: 5" [127mm] ERT403LV=High Gloss Appliance White Trim with Clear Specular Reflector ERT403LVG=High Gloss Appliance White Trim with Gold Reflector</p> <p>Slot Aperture</p> <p>ERT404LV Slot Aperture, 12V 50W MR16, OD: 5" [127mm] ERT404LV=High Gloss Appliance White Trim and Slot</p>

NOTES: Δ UL/cUL Listed for Wet Location with select trims. Δ Trim cover glass may be substituted with optional color or optical lens media.

Specifications and dimensions subject to change without notice. Consult your Cooper Lighting Solutions Representative or visit www.cooperlighting.com for available options, accessories and ordering information.

FEATURES

- All-Nail bar hangers
- Bar hangers may be shortened for narrow joist spaces
- Quick Connect wiring connectors included in junction box
- NM cable pry-outs and conduit knockouts in junction box
- AIR-TITE™
- Die-formed housing and plaster frame
- Housing may be removed from plaster frame for junction box access
- Integral 120V transformer steps line voltage down to lamp voltage

Compliances may not apply to all product configurations. Please consult the product spec sheet for compliance details.

COMPLIANCES: UL/cUL Listed - Wet Location, UL/cUL Listed - Damp Location, UL/cUL Listed 1598 Luminaire, UL/cUL Listed for Feed Through, UL/cUL Listed for Insulation Contact, AIR-TITE™ Certified ASTM E283



4-INCH INCANDESCENT LOW VOLTAGE NEW CONSTRUCTION ICAT

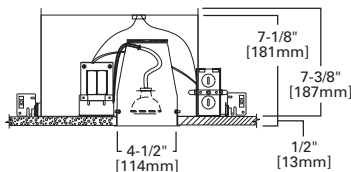

EI400LVAT

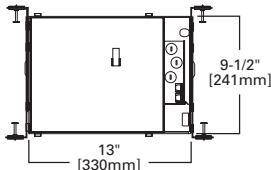

ORDERING INFORMATION: ORDER HOUSING AND TRIMS SEPARATELY^A

SAMPLE NUMBER: EI400LVAT - ERT401LVW

Housing	Trims
EI400LVAT=4" Aperture, New Construction, IC AIR-TITE™, 12V Low Voltage, MR16	<p>Adjustables ERT402LV Eyeball - 30° Tilt, 12V 50W MR16, OD: 5" [127mm] ERT402LV=High Gloss Appliance White Trim Ring with White Eyeball</p> <p>Baffles ERT401LV Baffle, 12V 50W MR16, OD: 5" [127mm] ERT401LV=High Gloss Appliance White Trim Ring with Black Baffle ERT401LVW=High Gloss Appliance White Trim Ring with White Baffle</p> <p>Reflectors ERT403LV Reflector, 12V 50W MR16, OD: 5" [127mm] ERT403LV=High Gloss Appliance White Trim with Clear Specular Reflector ERT403LVG=High Gloss Appliance White Trim with Gold Reflector</p> <p>Slot Aperture ERT404LV Slot Aperture, 12V 50W MR16, OD: 5" [127mm] ERT404LV=High Gloss Appliance White Trim and Slot</p>

NOTES: ^Δ Not to be used in direct contact with spray foam insulation. ^Δ UL/cUL Listed for Wet Location with select trims. ^Δ Trim cover glass may be substituted with optional color or optical lens media. See accessories.

ERT401LV Baffle



ERT401LVW High Gloss Appliance White Trim Ring with White Baffle
 ERT401LV High Gloss Appliance White Trim Ring with Black Baffle

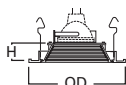

HOUSING / LAMP:

EI400LVAT: 12V 50W MR16
 ET400LVAT: 12V 50W MR16
 ET400LVRAT: 12V 50W MR16

DIMENSIONS: Height: 1-1/4" [31mm]; OD: 5" [127mm]

ERT402LV Eyeball 30° Tilt



ERT402LV High Gloss Appliance White Trim Ring with White Eyeball

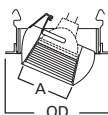

HOUSING / LAMP:

EI400LVAT: 12V 50W MR16
 ET400LVAT: 12V 50W MR16
 ET400LVRAT: 12V 50W MR16

DIMENSIONS: Aperture: 2" [51mm]; OD: 5" [127mm]

ERT403LV Reflector



ERT403LV High Gloss Appliance White Trim with Clear Specular Reflector
 ERT403LVG High Gloss Appliance White Trim with Gold Reflector

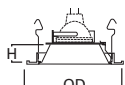

HOUSING / LAMP:

EI400LVAT: 12V 50W MR16
 ET400LVAT: 12V 50W MR16
 ET400LVRAT: 12V 50W MR16

DIMENSIONS: Height: 1-1/4" [31mm]; OD: 5" [127mm]

ERT404LV Slot Aperture



ERT404LV High Gloss Appliance White Trim and Slot

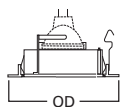

HOUSING / LAMP:

EI400LVAT: 12V 50W MR16
 ET400LVAT: 12V 50W MR16
 ET400LVRAT: 12V 50W MR16

DIMENSIONS: Slot: 1-3/8" x 2-1/8" [35mm x 54mm]; OD: 5" [127mm]

Specifications and dimensions subject to change without notice. Consult your Cooper Lighting Solutions Representative or visit www.cooperlighting.com for available options, accessories and ordering information.