

EiCon
Electric Conversions

Model : HK-MF-312-10
Configuration : CANXXXX
AC Input : 90~264VAC 16A
DC Output : Max 450VDC 10A

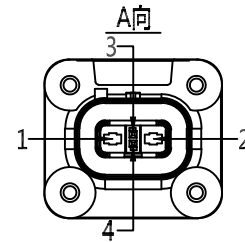

2103124-5(2310540-5) OBC output

Brand	Pin	Definition	Color/Dia. (mm ²)
TE	1	Positive+	Red/2.5
	2	Negative-	Black/2.5
	3, 4	HVIL	Black/0.5

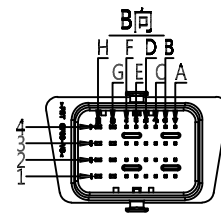

0643340100 OBC Signal Connector

Brand	Pin	Definition	Mark
Molex	2H	12V5A	LV output
	4A	CAN_H	
	4B	CAN_L	
	4G	GND	
	rest	NC	

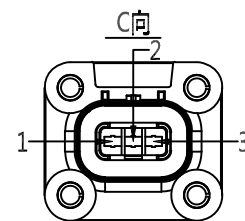

2103247-1 OBC Input

Brand	Pin	Definition	Color/Dia. (mm ²)
TE	1	Line (L)	Brown/2.5
	2	Earth (PE)	Yellow Green/2.5
	3	Null (N)	Blue/2.5

Recommended Connectors List(Reference. included in charger)

Part No.	Part No.	Part No.	Quantity
4-2103015-1	300102500679	1	1
2103154-2	300102500690	1	1
1-2103157-2	300102500681	2	2
2103155-2	300102500684	1	1
2103153-1	300102500682	1	1
2103306-1	300102500686	1	1
2103013-2	300102500685	1	1
4-2103177-5	300102500671	1	1
(2310537-5)	300102500671	1	1
1-968853-3	300102500676	5	5
1587826-3	300102500677	1	1
2103181-3	300102500678	1	1
0643193211	300102501166	1	1
0643231029	300102501281	2	2
0643221039	300102501231	2	2
0643251023	300102501282	6	6
0643251010	300102501283	22	22
0643191201	300102501284	1	1

Model: HK-MF-144-23

Technical requirements:

1. Vehicle Models: According to customers
2. Parts number: According to customers
3. Working temperature: -40°C to +85°C
4. Storage temperature: -55°C to +100°C
5. Rated output voltage: 144 VDC; Output Voltage Range: 100-215VDC
6. Max output current: 23A;
7. Enclosure Grade: IP 67
8. Rated Power: 3.3 KW;
9. The Input Voltage Range: 90 VAC - 265 VAC
10. Insulation resistance: Under 1000VDC, the isolation resistance value meeting the requirements of input, output terminal to case >= 20M ohm;
11. Ground Resistance: Under 25A DC, the resistance value meeting the requirements of AC PE pin to ground pin <= 100mΩ;
12. Power Factor >= 0.98;
13. Full Load Efficiency: >= 93%;
14. The protection function of OBC: Reverse Protection; Short Circuit Protection; Under Voltage Protection; Over Voltage Protection; Over Heating Protection;
15. All adapting connectors are tightly and neatly pressed, and well connected;
16. The crimping should be neat and tight, well contacted.
17. For parts, there is no tolerance marked, should be complied with GB/T 1804-2000 class v.
18. Other requirements comply with QC/T 895-2011
19. CAN Algorithm Number: TBD

EiCon
Electric Conversions