

Installation Instructions

TOP DOWN BOTTOM UP ROMAN BLINDS

Tools Required

Tape measure | Pencil | Drill & drill bits | Screw Driver (Philips Head) | Step Stool

Step 1: Mount the brackets

Recess/Inside Mount – Install inside the window recess.

Face/Outside Mount – Install above the window frame/recess.

Install the two outside brackets first, no further than 80mm from either end of the headrail. Install the remaining brackets evenly spaced, no more than 600 mm apart. Use a pencil to mark screw positions and pre-drill holes prior to securely fixing the brackets. Care should be taken to ensure the brackets are level and square. For face/outside mount, once the face bracket is positioned in place, mount the recess bracket onto the face bracket by inserting the hole (recess bracket) into the hook (face bracket) and turning it 90° to secure into position. Note: Only screws for timber surfaces are included. If you require installation on metal, brick or hollow dry walls, use appropriate screws and anchor mechanisms. If unsure contact us prior to installation.

NOTE: TDBU Roman Blind recess bracket is smaller than standard bracket to suit the TDBU cassette. It can be installed with a single screw instead of two screws as indicated for a standard bracket.

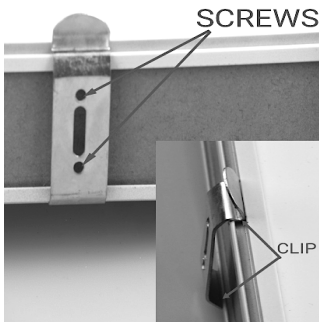

Recess / Inside Mount

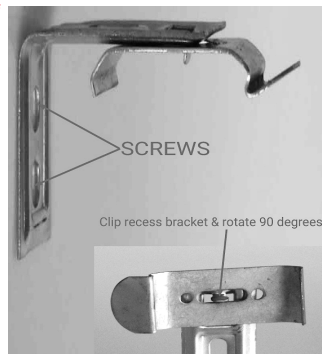

Face / Outside Mount

Step 2: Mount the blind

Place the rear lip of the headrail on to the rear hook of all brackets. Push the bottom front of the headrail upwards to click the front lip of the headrail into the front hook of all brackets.

Step 3: Install the Safety Device

Tension & secure the cord/chain using the cord guide safety device supplied with your window blind. Place the device on the wall, insert & secure the two screws through holes in it. Mounting screws must be secured onto a solid surface. It is essential to use this device to reduce the hazards of strangulation and entanglement of young children and pets. Ensure that the safety warning tag is attached to the cord/chain of the window blind at all times.



Step 4: Operate

Ensure that the blind is secure and the safety device (along with the safety warning tag) is in place prior to operating the blind. Use the chain/cord to operate the blind. Top Down Bottom Up Roman Blinds have two operating chains/cords, one on either side of the blind. Pulling gently on one of the cords in one direction raises the blind; pulling it in the other direction lowers it. The second cord is used to lower/raise the blind from top for the top down functionality. Ensure that the cord/chain does not rub against the fabric during operation to avoid fabric edge from fraying/damage.

Thank you for your purchase. We hope our product meet your expectations.
If you have any questions or concerns, please email us at contactus@foreverblinds.com.au

Mandatory Installation Instructions

Window Blinds operated by Cords / Chains

To avoid creating a possible strangulation hazard for children, the corded internal window covering must be installed in such a way that a loose cord cannot form a loop 220 mm or longer at a height of less than 1600 mm above floor level.

- A cord/chain guide may be installed lower than 1600 mm above floor level if the cord is sufficiently secured or tensioned to prevent a loop 220 mm or longer from being formed.
- If a cord/chain guide is installed lower than 1600 mm above floor level it must be designed to prevent a child from being able to remove the cord/chain.
- If a cleat is used to secure the cord it must be at least 1600 mm above floor level because a child is capable of unwinding a cord from a cleat.

Note:

All our corded window blinds operated by chains/cords consists of continuous cord loop system and comes with cord/chain guides only. These should be installed using two screws as shown below and secured on a solid surface. Note: Only screws for timber surfaces are included. If you require installation on metal, brick or hollow dry walls, use appropriate screws and anchor mechanisms. If unsure, contact us prior to installation.

