

EC	REP
----	-----

Name: Pegasus Trading GmbH
Add: Sperberweg 4G Neuss NRW 41468 Germany
Contact: Wells
Tel: 004916098658323
E-mail: info@apex-ce.com

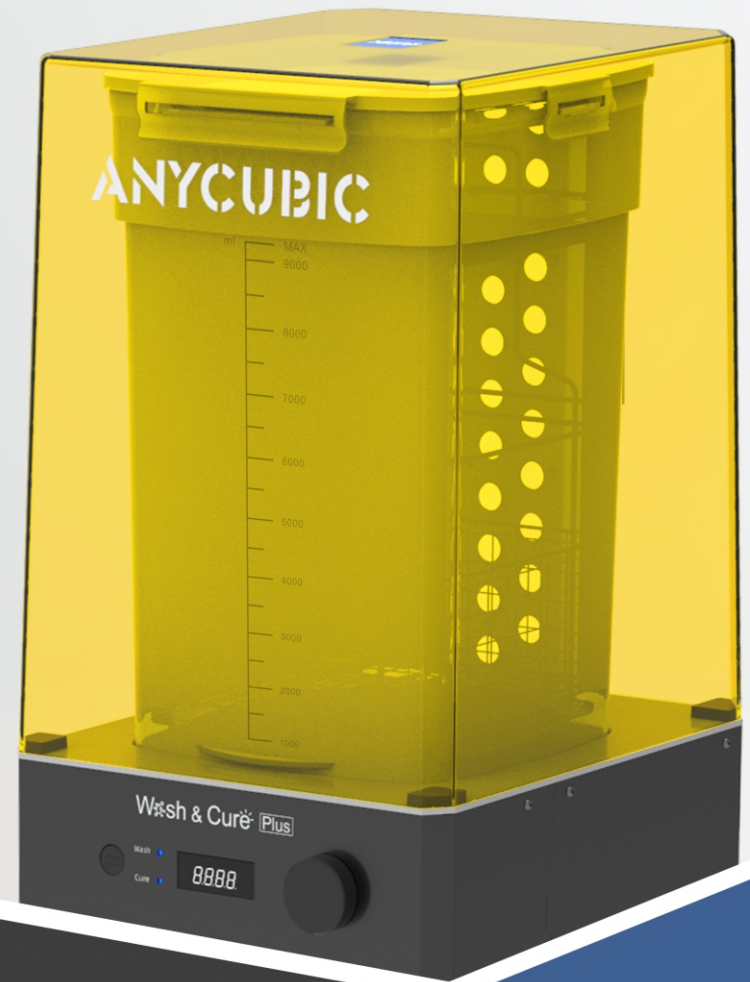

 User Manual

Wash & Cure Plus

Thank you for choosing Anycubic products.

Please read this manual carefully. The installation techniques and precautions in this manual can help you avoid any unnecessary damage or frustration.

More information please refer to :

1. <http://www.anycubic.com/>

Anycubic website provides software, videos, models, after-sale service, etc.

Please visit our website for technical support and we are likely to answer or solve all the questions for you!

2. Facebook page and Youtube channel as shown below.



Anycubic Website



Facebook page













Youtube channel

Copyrighted by “Shenzhen Anycubic Technology Co., Ltd ”, all rights reserved.

Team Anycubic

Safety instruction

Always follow the safety instructions during assembly and usage, to avoid any unnecessary damage to the machine or individual injury.









-  Please contact our customer service first if you have any issue after receiving the products.
-  The washing solvent should be sealed and stored in a cool and dry place after use. If the solvent is alcohol, please comply with regulations for use of alcohol.
-  In the curing mode, do not take off the cover of the machine to prevent potential hazard of UV light.
-  Do not clean the models directly without washing basket or washing rack. After washing, the models need to be air-dried.
-  Be cautious when using the scraper. Never direct the scraper towards your hands.
-  In case of emergency, please immediately cut off the power of Anycubic machine and contact the technical support.
-  Anycubic machine includes moving parts that can cause injury.
-  Keep the Anycubic machine and its accessories out of reach from children at all times.
-  Anycubic machine must not be exposed to water or rain.
-  Anycubic machine is designed to be used within ambient temperature ranging 8°C-40°C, and humidity ranging 20%-50%. Working outside those limits may result in low quality performance.
-  Do not disassemble Anycubic machine, please contact technical support if you have any question.

Technical Specification

Machine properties	Wash & Cure	
Control method	Digital Displays+LED Dual Light, Knob	
Rated power	40W	
Input voltage	AC110-240V 50/60Hz	
UV LED wavelength	405nm	
Time selection	1~60min	
Machine size	290mm(L)*270mm(W)*479mm(H)	
Maximum washing volume (without the platform)	192mm(L)*120mm(W)*290mm(H)	
Maximum washing volume (with the platform)	192mm(L)*120mm(W)*235mm(H)	
Maximum curing volume	190mm(D)*245mm(H)	
Net weight	~6.5kg	
Indicator light	Red	Idle
	Green	Working

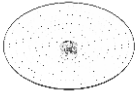

Packing List

			
	Washing rack 1PCS	Stainless steel washing basket 1PCS	Washing bucket 1PCS
			
Wash & Cure Plus	Reflector 1PCS	Curing table 1PCS	Tool kit
			
Power adapter 1PCS	After sale service card 1PCS	User manual 1PCS	

Product Overview

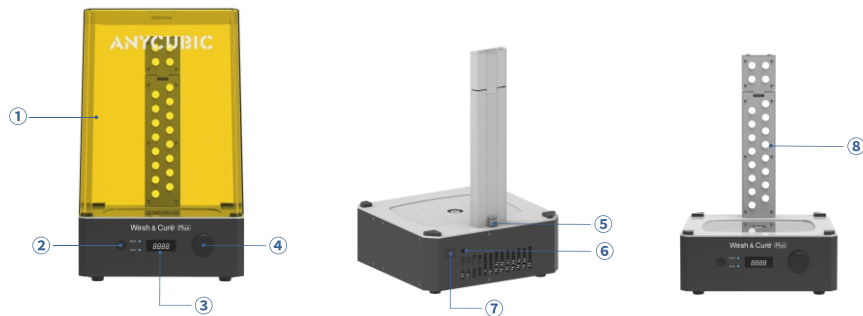

- ① **UV-blocking cover** - blocks 99.995% of UV light.
- ② **Mode button** - press it to switch the mode (wash or cure).
- ③ **Time display** - to show washing or curing time.
- ④ **Time knob** - turn the knob to set the washing or curing time, ranging from 1 to 60 minutes.

- ⑤ **UV-blocking cover sensor** - to detect whether the machine is covered or not.
- ⑥ **Power socket** - to connect the external adapter.
- ⑦ **Power switch** - turn on/off the machine
- ⑧ **UV LED panel** - for model curing.

*UV light tester: Linshang LS125 UV LIGHT METER

Instructions

This machine (Wash & Cure Plus) is suitable for washing and post-curing the printed objects of M-SLA 3D printers (such as the Anycubic Photon Series 3D printers). This machine has two working modes—wash and cure. The following parts illustrate its basic operation and precautions in different working modes. Please read the manual carefully before use.



① Wash mode

1. There are two methods for wash.

① **Wash the printed objects in the basket.** Place the objects in the basket after removing them from the printing platform.

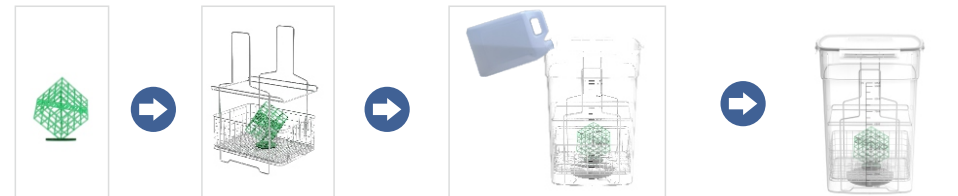

- Tips: 1. Washing solvent can be alcohol, detergent solution, etc..
- 2. Washing solvent cannot exceed the maximum scale on washing bucket.

② **Wash the objects with the platform.** For convenience, place Photon Mono X printing platform directly in the machine with basket or rack to wash the objects.

Washing basket: recommended for the object with a height of less than 135mm.

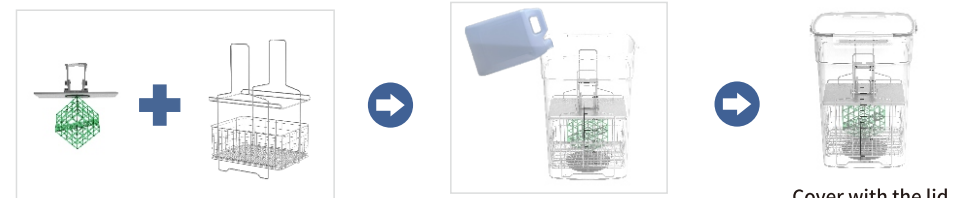

Washing rack: recommended for the objects with heights between 135mm and 235mm.

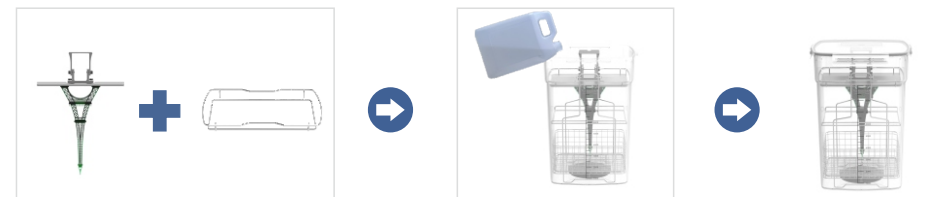

Place the washing basket under the rack Cover with the lid

Tips: It is recommended to place washing basket under the rack to avoid the damage of models and machine.

2. Align the washing bucket with the indentation and install it firmly on the platform.
(Note: The curing table and reflector must be took off if they are on the platform.)

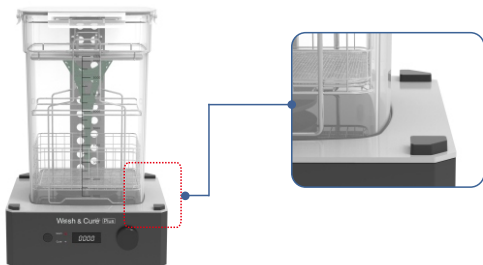

3. Switch the machine to wash mode by pressing the mode button (the default mode is wash). Then turn time knob to set washing time (not more than 1 h) and press the knob to start.



Tips: The washing will stop if time knob is pressed. During washing, the mode button is unavailable and the washing time cannot change.

Recommended washing time:

model size	wash solvent	recommended washing time
small (≤64*40*80mm)	alcohol	≤2min
	water*	10min
middle (64*40*80-96*60*122mm)	alcohol	2min
	water*	10-12min
large (96*60*122-192*120*245mm)	alcohol	2-4min
	water*	10-12min

***Only water washable resin model can be washed by water.**

Please increase the recommended wash time when:

- washing models with hollow, concave or complicated structure.
- the wash solvent becomes muddy or the alcohol is partially volatilized after long-time washing.

4. A beeping sound indicates the wash is finished. After wash, it is suggested to air dry the model before curing.

Tips: After wash, please seal and remove the washing bucket to avoid the washing solvent spills.

② Cure mode *After washing, post-curing can increase the strength of the printed objects.

• It is suggested to air dry the model before curing.

1. Install reflector, curing table and model.

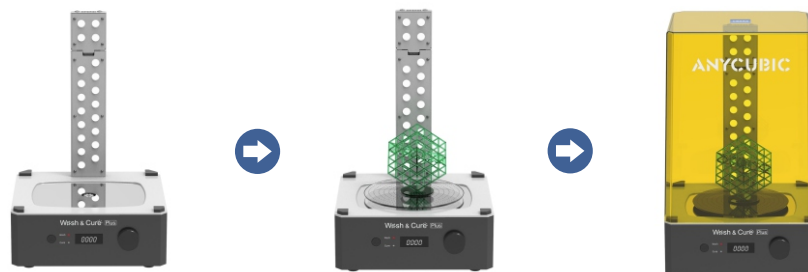

Tear off the protective film on one side of reflector and place this side upward on the platform. (The washing bucket needs to be removed first if it is on the platform.)

Align the curing table with the hole of the platform and install. Place the objects on the curing table.

Put on the cover and the side with "ANYCUBIC" needs to face forward.

• For better effects, bend the UV light board (with angle between 0-65°) to cure the top of objects. The height of the objects here should be less than 240mm.

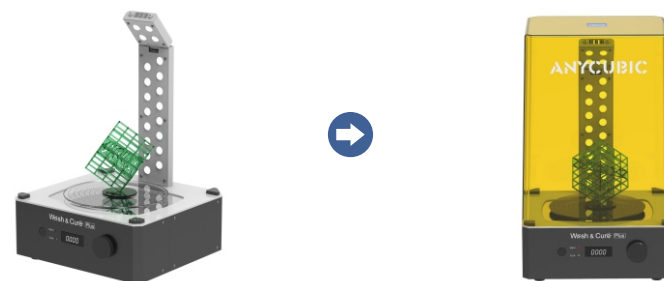

Bend the light board to the desired angle.

Put on the cover and the side with "ANYCUBIC" needs to face forward.

Note: Be cautious of the sharp edges to avoid injury.

2. Switch the machine to cure mode by pressing the mode button. Then turn the time knob to set curing time and press the knob to start.

- **Generally, the recommended curing time is 2 minutes. If the model has a very complicated surface structure, it is recommended to increase curing time.**



Notice: If the cover is removed during the operation, the program will be paused. And the program will resume after covering again. To ensure the curing effect, do not remove the cover during the curing process.

3. A beeping sound indicates the cure is finished.

Tips: If the machine has not been used for a long time, please cut off the power.

Maintenance

1 Recycling of washing solvent

Here we take "alcohol " as the washing solvent for example.



① After cleaning about 30 objects, the alcohol might become muddy, as shown above.



② Allow the solvent stays still for over 10 hours so the residue could be precipitated and settled.



③ Pour the top layer of alcohol into another container and then dispose the residue. **(Expose the residue in the sunlight until the alcohol is completely evaporated. Then the cured resin can be handled as general solid waste.)**



④ After disposing the waste, rinse the washing bucket several times with water. If the sediment at the bottom of the bucket is too viscous, remove the bucket rotor and brush them separately.

(The method of removing the bucket rotor is shown in "Cleaning rotor of the washing bucket" on the next page.)

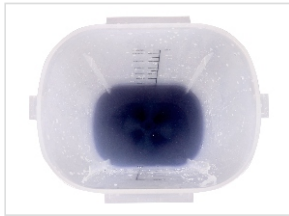

⑤ After cleaning the bucket, pour the filtered alcohol into the washing bucket and cover with lid.

The filtered alcohol may still contain dissolved resin, but it can be used to wash the printed objects.

2 Cleaning rotor of the washing bucket

When you wash the models, the rotor at the bottom of washing bucket rotates at high speed. If the rotor rotates abnormally after long-term use, you can remove the rotor from washing bucket to clean it.



After cleaning the rotor, install it by reversing the steps above.

Troubleshooting

1. The machine does not work.

① Poor power contact. Pull out the power cord and plug it in again.

2. The rotor inside the washing bucket does not rotate during the washing process.

- ① The rotor inside the washing bucket is stuck by foreign matter. After the power is turned off, pour out the solvent and remove the foreign matter. Then turn on the power to wash the model again.
- ② There are too much precipitation in the solvent, please replace the solvent and clean the bucket and rotor.

3. The machine has abnormal sound during operation.

- ① The ground where the machine is placed is not flat enough.
- ② The screw on the rotor is loose during the washing process. Tighten the screw.

4. The model turns white after wash and cure.

- ① The concentration of the alcohol which is used for washing is not high enough. Use alcohol with concentration exceeding 95%.
- ② The model is cured immediately after washing. Please air dry the model before post-curing.

5. When mode button is pressed to switch mode, the two mode lights are not lit.

① Try again or reboot the machine.

Thank you for purchasing Anycubic products! Under normal usage and service, the products and its parts have a warranty period up to one year. Please visit Anycubic support center (support.anycubic.com/en) to report any problem about Anycubic products. Our professional after-sale service team would respond within 24 hours and help you to solve the problems.