

## ② Cleaning rotor of the washing bucket

At washing mode, the rotor at the bottom of the washing bucket will rotate at high speed. If the rotor rotates abnormally after long-term use, you can replace the stainless steel bearing in the rotor (there is 1pcs spare bearing in the package). The process is shown below.

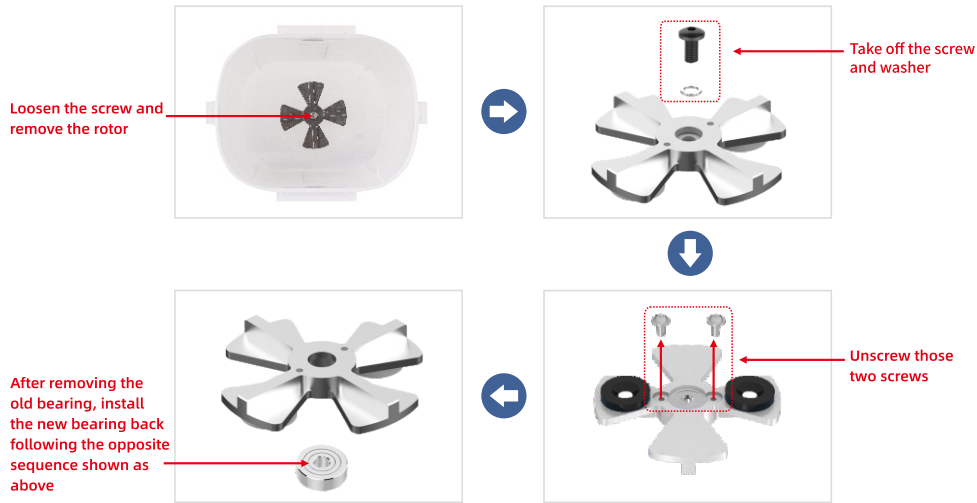

## Troubleshooting

### 1. The machine does not work.

- ① Poor power contact. Pull out the power cord and plug it in again.
- ② The lid is not covered. Try again after cover the lid.

### 2. The rotor inside the washing bucket does not rotate during the washing process.

- ① The rotor inside the washing bucket does not move because it is caught by foreign matter. After the power is turned off, pour out the alcohol and remove the foreign matter. Then turn on the power to wash the model again.
- ② There are too much precipitation in the washing liquid, please change the washing liquid and clean the bucket and rotor.

### 3. The machine has abnormal sound during operation.

- ① The floor on which the machine is placed is not flat enough.
- ② Z-axis motor bearings need oil. Inject normal grease into the oil hole of the motor.
- ③ The screw on the rotor is loose during the washing process. Fix the screw to the rotor.

### 4. The model turn white after washing and curing.

- ① The concentration of alcohol used for washing is not high enough. Wash with more than 95% alcohol.
- ② Curing is performed immediately after the model is washed. It needs to wait for the model to air dry before putting it into the machine for curing.

### 5. Touch to switch the mode button of the machine, the two mode lights are not bright.

- ① Try again or reboot the machine.

**Thank you for purchasing Anycubic products! Under normal usage and service, the products and its parts have a warranty period up to one year. Please visit Anycubic official website ([www.anycubic.com](http://www.anycubic.com)) for more details and report any issues with Anycubic products. Our professional after-sale service team would response within 24 hours and help you to solve the issue.**



 **User Manual**

# Wash and Cure 2.0

Thank you for choosing Anycubic products.

Please **read this manual carefully**. The installation techniques and precautions in this manual can help you avoid any unnecessary damage or frustration.

More information please refer to :

1. <http://www.anycubic.com/>

Anycubic website provides software, videos, models, after-sale service, etc.

Please visit our website for technical support and we are likely to answer or solve all the questions for you!

2. Facebook page and Youtube channel as shown below.



Anycubic Website



Facebook page













Youtube channel

Copyrighted by "Shenzhen Anycubic Technology Co., Ltd ", all rights reserved.

Team Anycubic

## Safety instruction

**Always follow the safety instructions during assembly and usage, to avoid any unnecessary damage to the machine or individual injury.**











-  Please contact our customer service first if you have any issue after receiving the products.
-  The washing liquid should be sealed and stored in a cool and dry place after use. If the liquid is alcohol, please strictly follow the instructions of alcohol.
-  In the curing mode, do not take off the cover of the machine to prevent potential hazard of UV light.
-  Do not clean the models directly without putting them in washing basket or washing rack. After cleaning, the models need air-dried before putting in the curing chamber.
-  Be cautious when using the scraper. Never direct the scraper towards your hands.
-  In case of emergency, please immediately cut off the power of Anycubic machine and contact the technical support.
-  Anycubic machine includes moving parts that can cause injury.
-  Keep the Anycubic machine and its accessories out of reach from children at all times.
-  Anycubic machine must not be exposed to water or rain.
-  Anycubic machine is designed to be used within ambient temperature ranging 0°C-40°C, and humidity ranging 20%-50%. Working outside those limits may result in low quality performance.
-  Do not disassemble Anycubic machine, please contact technical support if you have any question.

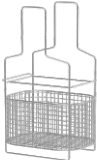

## Technical Specification

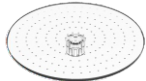
Model	Wash and Cure	
Control mode	Digital Displays+LED Dual Light, Knob	
Rated power	25W	
Input voltage	AC110/220V 50/60Hz	
UV LED	405nm	
Time Mode	1~60min	
Machine Size	225mm(L)*235mm(W)*365mm(H)	
Maximum Wash Volume	120mm(L)*74mm(W)*165mm(H)	
Maximum Curing Volume	140mm(D)*165mm(H)	
Net weight	~3.7kg	
Indicator light	Red	Idle
	Green	Working

## Packing list

			
	Washing rack 1PCS	Stainless steel washing basket 1PCS	Washing bucket 1PCS
			
Wash and Cure 2.0	Stainless steel bearing 1PCS	Reflector 1PCS	Curing table 1PCS
			
Power adaptor/Power cord 1PCS	After sale service card 1PCS	Tool kit 3PCS	User Manual 1PCS

## Product Overview



① **Anti-UV lid:** blocks 99.995% of UV light and plays a protective role.

② **Mode button:** press it to switch the mode (wash or cure).

③ **Time display:** to tell the time.

④ **Time knob:** turn the knob to set the cleaning or curing time, ranging from 1 to 60 minutes.

\*UV light tester: Linshang LS125 UV LIGHT METER

⑤ **Anti-UV lid sensor:** to detect if the anti-UV lid is covered in curing mode.

⑥ **Power socket:** to connect the external adaptor.

⑦ **Power switch:** turn on/off the machine

⑧ **UV LED panel:** for model curing.

## Instructions

This machine (Wash & Cure 2.0) is suitable for **washing and post-curing** of printed objects of M-SLA 3D printers (such as the Anycubic Photon Series 3D printers). This machine has two working modes, wash and cure. The following parts describe the basic functions and operation precautions in different working modes. Please read the manual carefully before get started.



① Plug in the power.



② Turn on the machine.



③ The default mode is wash.

### ① Wash mode

1. There are two cases for washing: ① the printed objects have been removed from the printing platform; ② the printed objects are on the Photon(S) printing platform.

- The holes on the washing basket is 12mm. If the objects are less than 12mm, please do not remove them from the platform and clean them together with the platform.

#### ① The printed objects have been removed from the Photon(S) printing platform



Seal with bucket lid

**Tips: 1. Washing liquid can be alcohol, detergent solution, etc..**

**2. Washing liquid cannot exceed the maximum scale on washing bucket.**

#### ② Two cases for the printed objects which are on the Photon(S) printing platform

Washing basket: recommended for the objects with height less than 100mm.



Seal with bucket lid

Washing rack: recommended for the objects with height between 100mm and 165mm.



Seal with bucket lid

2. Place the washing bucket firmly on the platform by the indentation.

**(Note: The curing table and reflector must be took off if they are on the platform.)**

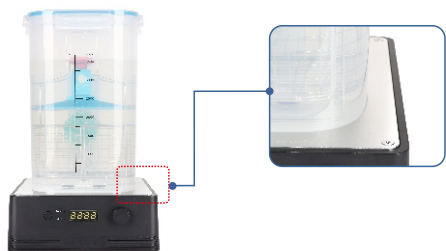

3. Switch the machine to wash mode by pressing the mode button (The default mode is wash). Then turn time knob to set washing time and press the knob to start.



**Tips:** The washing halts when time knob is pressed halfway.

4. When washing is completed, a beeping sound will indicate it's finished. **After the model is washed, it is suggested to air dry the model before proceeding to the next post-cure process.**

**Tips:** After washing, please remove and seal the washing bucket to avoid spilling the washing liquid.

## ② Cure mode

**\*After washing, post curing can increase the strength of the printed objects. (It is suggested to air dry the model before proceeding to the post-cure process.)**

1. Place reflector, curing table and model.

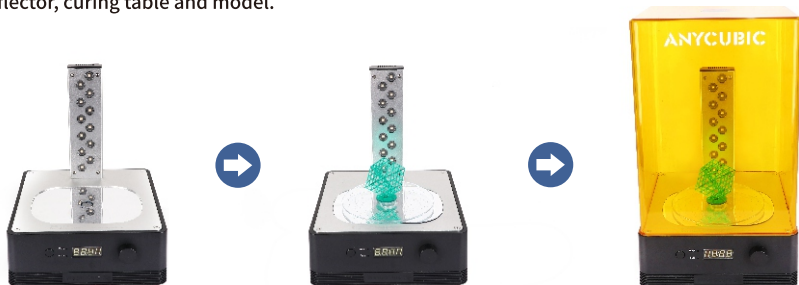

Tear off the protective film on one side of reflector and place the side up on the platform. **(The washing bucket needs to be removed first if it is on the platform)**

Align the curing table with the hole of the platform and install. Place the objects on the curing table.

Cover the lid and the side with "ANYCUBIC" needs to face forward.

2. Switch the machine to cure mode by pressing the mode button. Then turn the time knob to set curing time and press the knob to start.

**• Generally, a model with a diameter of less than 30mm is recommended to cure for 2 minutes. If the model has a very complicated surface structure, it is recommended to increase curing time.**



**Notice:** If the lid has been removed during the operation, the program will be paused. And the program will resume after cover back the lid. In order not to affect the curing effect, do not remove the lid during the curing process.

3. After the curing is completed, a beeping sound will indicate it's finished.

**Tips:** If the machine is not used for a long time, please cut off the power.

## Maintenance

### ① Recycling of washing liquid

Here we take "alcohol" as the washing liquid for example.



① After used for cleaning about 30 models, the alcohol might become muddy, as shown above.



② Allow the liquid stays still for over 10 hours so the residue could be precipitated and settled.



③ Pour the top layer of alcohol into another container and then dispose the residue. **(Expose the residue in the sunlight until the alcohol is completely evaporated. Then the cured resin can be treated as general solid waste.)**



④ After disposing the waste, rinse the washing bucket several times with water; if the sediment at the bottom of the bucket is too viscous, remove the bucket rotor and brush them separately. **(The method of removing the bucket rotor is shown in the first step of the "Cleaning rotor of the washing bucket" on the next page.)**

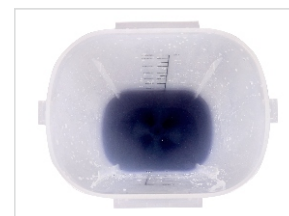

⑤ After cleaning the bucket, pour the filtered alcohol into the washing bucket and covered with lid for future use.

**The filtered alcohol may still contain dissolved resin, but it can be used to wash the printed.**