

Selector® 3780 Series Accessories

Short/Extended Lipped Strikes

Part Number	Lip Length A	Strike Length B
3782-STK32XX	32mm	46.1mm
3782-STK74XX*	74mm	88.5mm

To order, add finish code to part number.

XX designates the finish.

SS - Stainless Steel, **CP** - Chrome Plate, **PB** - Polished Brass

*Only available in Stainless Steel (**SS**) finish.

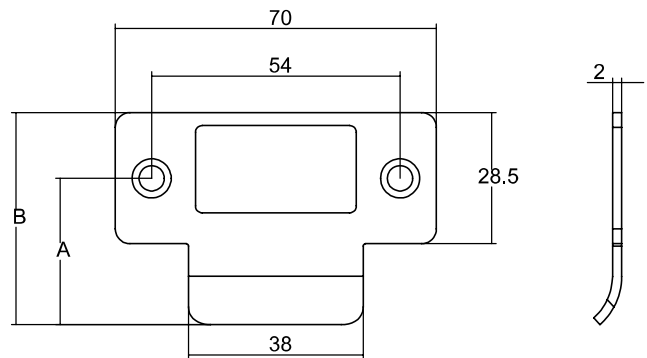

Fabricator Strikes

Part Number	Lip Length A	Strike Length B
3782-FSTK32SS	32mm	47.2mm
3782-FSTK64SS	64mm	80.2mm

Stainless Steel D shaped strike.

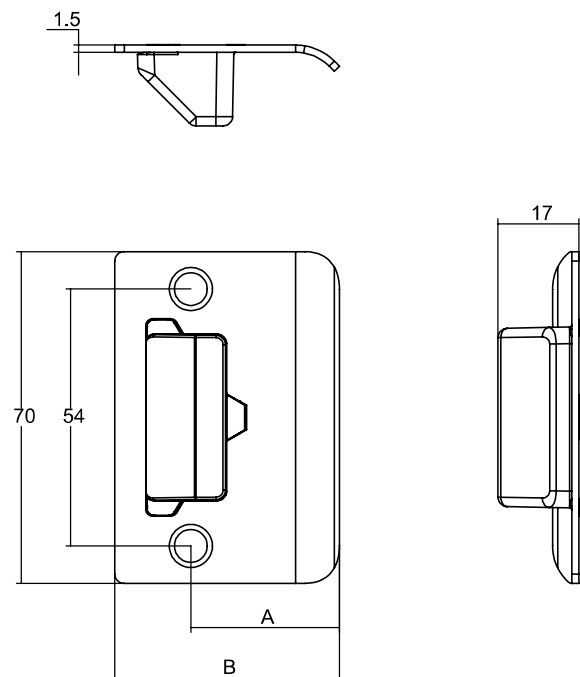

Selector® 3780 Series Accessories

Retrofit Strike Kits

Part Number	Finish
3782-RFSTKCP	Chrome Plate
3782-RFSTKSC	Satin Chrome Brushed

For replacement of existing installations where Lockwood 5900, 595 and Astra Short Backset are used. For replacement of Astra specify 25.4mm backset.

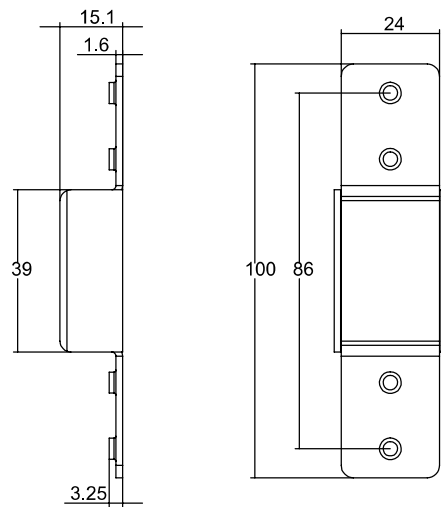
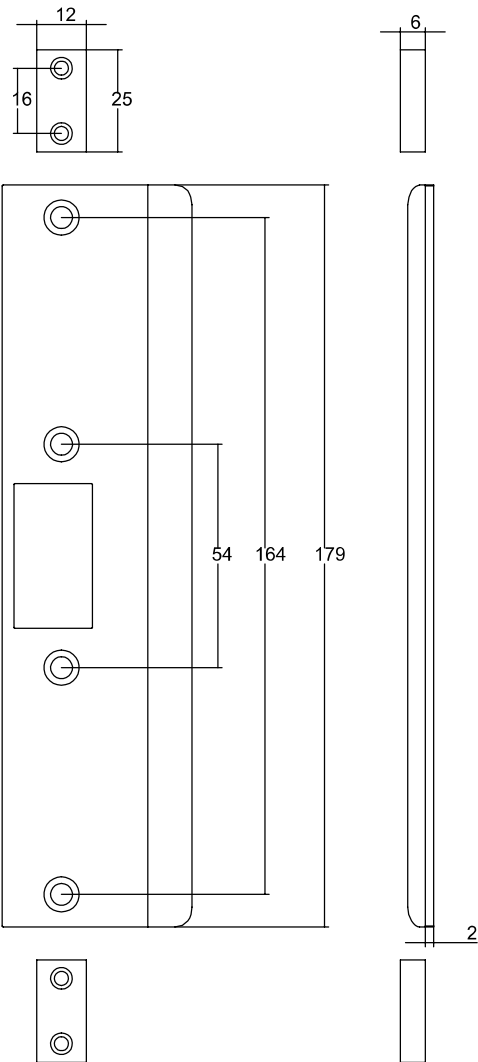

Selector® 3780 Series Accessories

Rebate Kits

Part Number	Finish
5782-RK ##CP	Chrome Plate
5782-RK ##SS	Stainless Steel
5782-RK ##PB	Polished Brass

Rebate kits to suit 13mm rebated timber doors with minimum backset of 30mm.

To order, add door handing to part number.

Refer to door handing guide at the bottom of page.

designates door handing.

CW - Clockwise

ACW - Anti-clockwise

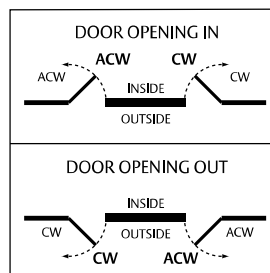
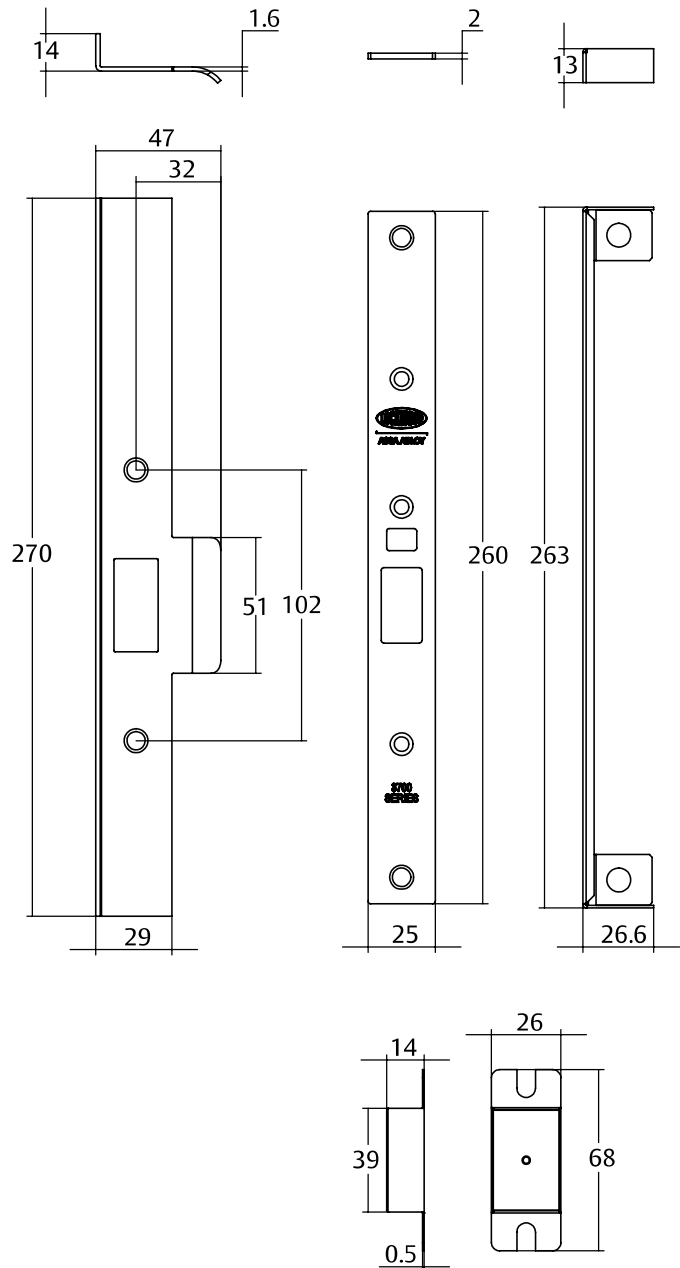

CW Left Hand open in
(Clockwise) Right Hand open out

ACW Left Hand open out
(Anti-Clockwise) Right Hand open in

Selector® 3780 Series Accessories

Mortice Lock Spindles

Part Number	Pack Size	Length "A"	Door Thickness	
			Min	Max
SP3570-5018	10	33mm	32	50
SP3570-5228	1	45mm	50	75
SP3570-5238	1	58mm	75	100
SP3570-5258	1	108mm	100	200

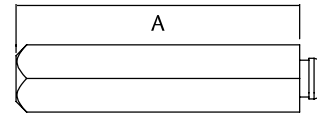
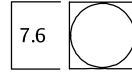

Single Cylinder Assemblies

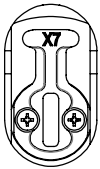

"X7" Cam Cylinder
570C4/X7

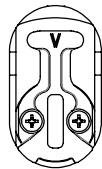

"V" Cam Cylinder
570C4/V

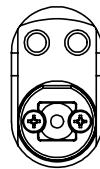

3787 Lower Cylinder
with Spindle Cam
570EC4/87

Cylinder Cams

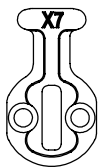

"X7" Cam
SP3700/X7CAM

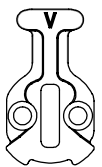

"V" Cam
SP3700/VCAM

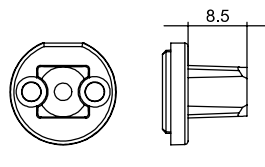

3787 Spindle Cam
SP3787/CAM

Adaptors

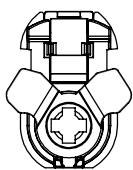

Locking Adaptor
3772-ADAPTOR

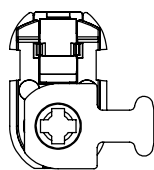

Latching Adaptor
3770M1-ADAPTOR

Selector® 3780 Series Cam and Adaptors Function Chart

Selector® 3780 Series Cam and Adaptors Function Chart

Selector® 3780 Series	Function Description	Primary Lock	Outside Cylinder Cam/Adaptor	Inside Cylinder Cam/Adaptor	Kit
Selector® 3780 Nightlatches					
3780-TSS	Nightlatch with Turn	3780TSS	-	3770M1-ADAPTOR	
3780X-SS	Nightlatch with Cylinder	3782SS	X7	-	
3780XTSS	Nightlatch with Cylinder and Turn	3780TSS	X7	3770M1-ADAPTOR	
3780XXSS	Nightlatch with Double Cylinder	3782SS	X7	X7	
Selector® 3782 Escape Locks					
3782SS	Escape Primary Lock	3782SS	-	-	
3782-SS	Escape Lock	3782SS	-	-	
3782V-SS#	Anti-vandal Escape Lock	3782SS	V	-	
3782VTSS#	Anti-vandal Escape Lock with Turn	3782TSS	V	3772-ADAPTOR	
3782X-SS	Key Entry Escape Lock	3782SS	X7	-	
3782XTSS#	Key Entry Escape Lock with Turn	3782TSS	X7	3772-ADAPTOR	
3782-VSS#	Escape Lock with Internal Cylinder	3782SS	-	V	
3782-TSS#	Escape Lock with Turn	3782TSS	-	3772-ADAPTOR	
3782XVSS#	Key Entry Escape Lock with Internal Cylinder	3782SS	X7	V	
3782-TASS	Anti-lockout Escape Lock with Turn	3782TSS	-	3772-ADAPTOR	
3782VTASS	Anti-lockout Anti-vandal Escape Lock with Turn	3782TSS	V	3772-ADAPTOR	
Selector® 3784 Combination Locks					
3784SS	Passage Latch	3782SS	-	-	
3784VTSS#	Anti-vandal Lock with Turn	3782TSS	V	3772-ADAPTOR	
3784VVSS#	Anti-vandal Lock with Internal Cylinder	3782SS	V	V	
3784XVSS#	Key Entry Lock with Internal Cylinder	3782SS	X7	V	
3784XXSS	Key Entry Double Cylinder Lock	3782SS	X7	X7	
3784-TSS	Combination Lock with Turn	3782TSS	-	3772-ADAPTOR	
3784-TASS	Anti-lockout Combination Lock with Turn	3782TSS	-	3772-ADAPTOR	
3784VTASS	Anti-lockout Anti-vandal Lock with Turn	3782TSS	V	3772-ADAPTOR	
3784VVASS	Anti-lockout Anti-vandal Lock with Internal Cylinder	3782SS	V	V	
Selector® 3787 Dual Entry Locks					
3787X-SS	Dual Entry Lock	3782SS	X7, 3787 SPINDLE CAM	-	3787-KIT570E
3787V-SS	Dual Entry Lock with Lower Cylinder Lockout	3782SS	V, 3787 SPINDLE CAM	-	3787-KIT570E

Selector® 3780 Series Cam and Adaptors Function Chart

Selector® 3780 Series Cam and Adaptors Function Chart

Selector® 3780 Series	Function Description	Primary Lock	Outside Cylinder Cam/Adaptor	Inside Cylinder Cam/Adaptor	Kit
Selector® Privacy Locks					
3782-TSS	Escape Privacy Lock	3782TSS	-	3772-ADAPTOR	
3782-TASS	Anti-lockout Escape Privacy Lock	3782TSS	-	3772-ADAPTOR	
3784-TSS	Privacy Lock	3782TSS	-	3772-ADAPTOR	
3784-TASS	Anti-lockout Privacy Lock	3782TSS	-	3772-ADAPTOR	
3787-TSS	Key Entry Privacy Lock	3782TSS	3787 SPINDLE CAM	3772-ADAPTOR	3787-KIT570E
3787-TASS	Key Entry Anti-lockout Privacy Lock	3782TSS	3787 SPINDLE CAM	3772-ADAPTOR	3787-KIT570E
Selector® 3782 DX Digital Locks					
3782DX-SS	DX Mechanical Digital Mortice Lock	3782SS	3770M1-ADAPTOR	-	3782-DXKITSC
3782DXVSS#	DX Mechanical Digital Mortice Lock with Internal Cylinder	3782SS	3770M1-ADAPTOR	V	3782-DXKITSC
3782DXKO-SS	DX Mechanical Digital Mortice Lock with Key Override	3782SS	3770M1-ADAPTOR	-	3782-DXKOKITSC
3782DXKOVSS#	DX Mechanical Digital Mortice Lock with Key Override and Internal Cylinder	3782SS	3770M1-ADAPTOR	V	3782-DXKOKITSC

Note: Items in Italics are Primary Locks and can be purchased from ASSA ABLOY.

#Lock function suitable for holdback application. Holdback can be activated at any time - unless anti-lockout is selected.

Cylinders sold separately, purchased configurations include adaptors as required.

Only 30mm and 38mm backset locks are suitable in DXs configurations on opening in doors.

Synergy Series Conversion Chart

Synergy Series Conversion Chart

Synergy Series	Selector® 3780 Series	Function Description	Note
Escape Locks			
3582SC	3782SS	Escape Lock	
3582-ASC			3782 series primary lock has anti-lockout functionality. To set anti-lockout function, refer to setting and operating instructions.
3582-T#SC	3782-TSS	Escape Privacy Lock	
3582WA#SC	3782VTASS	Anti-lockout Anti-vandal Escape Lock with Turn	V cam has the functionality of locking lock just as the W cam. V cam also retracts bolt after unlocking lock.
3582WT#SC	3782VTSS	Anti-vandal Escape Lock with Turn	V cam has the functionality of locking lock just as the W cam. V cam also retracts bolt after unlocking lock.
3582X-#SC	3782X-SS	Key Entry Escape Lock	X7 cam has the functionality of retracting bolt and locking lock. Does not have unlocking functionality.
3582XT#SC	3782XTSS	Key Entry Escape Lock with Turn	X7 cam has the functionality of retracting bolt and locking lock. Does not have unlocking functionality.
3582XZ#SC	3782XVSS	Key Entry Escape Lock with Internal Cylinder	V cam has the functionality of locking lock just as the Z cam. V cam also retracts bolt after unlocking lock. X7 cam has the functionality of retracting bolt and locking lock. Does not have unlocking functionality.
3582-Z#SC	3782-VSS	Escape Lock with Internal Cylinder	V cam has the functionality of locking lock just as the Z cam. V cam also retracts bolt after unlocking lock.
3582Z-#SC	3782V-SS	Anti-vandal Escape Lock	V cam has the functionality of locking lock just as the Z cam. V cam also retracts bolt after unlocking lock.
Combination Locks			
3584ET#SC	3784-TSS	Combination Lock with Turn	
3584#SC	3784SS	Passage Latch	
3584-T#SC	3784-TSS	Combination Lock with Turn	
3584WT#SC	3784VTSS	Anti-vandal Lock with Turn	V cam has the functionality of locking lock just as the W cam. V cam also retracts bolt after unlocking lock.
3584XX#SC	3784XXSS	Key Entry Double Cylinder Lock	X7 cam has the functionality of retracting bolt and locking lock. Does not have unlocking functionality.
3584XZ#SC	3784XVSS	Key Entry Lock with Internal Cylinder	V cam has the functionality of locking lock just as the Z cam. V cam also retracts bolt after unlocking lock. X7 cam has the functionality of retracting bolt and locking lock. Does not have unlocking functionality.
3584Z-#SC	3784V-SS	Anti-vandal Lock	V cam has the functionality of locking lock just as the Z cam. V cam also retracts bolt after unlocking lock.
3584ZZ#SC	3784VVSS	Anti-vandal Lock with Internal Cylinder	V cam has the functionality of locking lock just as the Z cam. V cam also retracts bolt after unlocking lock.
Timber Fixing			
3592SC			For timber fixing, specify the lock with an additional line 3782-TFKITxx where xx designates the required finish.

Synergy Series Conversion Chart

Synergy Series Conversion Chart

Synergy Series	Selector® 3780 Series	Function Description	Note
Extended Lip Strikes			
SP3580-53SC	3782-STK32SS	3782 STANDARD STRIKE 32MM LIP PK=10	
SP3580-53CP	3782-STK32CP	3782 STANDARD STRIKE 32MM LIP PK=10	
SP3580-53PB	3782-STK32PB	3782 STANDARD STRIKE 32MM LIP PK=10	
SP3580-A53SC	3782-STK74SS	3782 LONG LIP STRIKE 74MM LIP	
SP3580-52	3782-STKBOX	3782 STRIKE BOX PK=10	
Surface Mounted Fabricator Lip Strikes			
SP3P80-053SS	3782-FSTK32SS	3782 FABRICATOR STRIKE KIT 32MM LIP	
SP3P80-153SS	3782-FSTK64SS	3782 FABRICATOR STRIKE KIT 64MM LIP	
Retrofit Strikes			
3580-1902SC	3782-RFSTKSC	3782 RETROFIT STRIKE KIT	
3580-1902CP	3782-RFSTKCP	3782 RETROFIT STRIKE KIT	
3580-1902PB	3782-RFSTKPB	3782 RETROFIT STRIKE KIT	
Rebate Kits			
3580-2902ACWSC	5782-RKACWSS	5782/6782 REBATE KIT ANTICLOCKWISE	
3580-2902ACWCP	5782-RKACWCP	5782/6782 REBATE KIT ANTICLOCKWISE	
3580-2902ACWPB	5782-RKACWPB	5782/6782 REBATE KIT ANTICLOCKWISE	
3580-2902CWSC	5782-RKCWSS	5782/6782 REBATE KIT CLOCKWISE	
3580-2902CWCP	5782-RKCWCP	5782/6782 REBATE KIT CLOCKWISE	
3580-2902CWPB	5782-RKCWPB	5782/6782 REBATE KIT CLOCKWISE	

Selector® 3780 Series Short Backset Mortice Locks Functioning Matrix

Functioning Matrix

Sample part number 3782VTASS is made up of seven elements.

The description of this part number is an Anti-lockout Anti-vandal escape lock with cylinder and turn in satin stainless steel finish. Choose your product by selecting an option from each element.

Backset	Series	Platform	Function	Sub Function	Anit-lockout Selection	Finish
3	7	8	2	VT	A	SS

Backset

23mm	3
25.4mm	4
30mm	5
38mm	6

Series

Selector® Series Mortice Locks	7
--------------------------------	---

Platform

Short Backset	8
---------------	---

Functions

Nightlatch	0
Escape Lock	2
Combination Lock	4
Dual Entry Lock	7

Sub Function

e.g. Outside	Inside
V	T
Locking and Latching Cylinder with V Cam	V
Latching Cylinder with X7 Cam	X
Turnbutton Adaptor	T
No Sub Function	-
DX Digital	DX
DX Digital with Key Override	DXKO

Anit-lockout Selection

Neutral	
Anti-lockout	A

Finish

Stainless Steel	SS
-----------------	----

Code

1. Backset: Nominate backset as required, for example 3 = 23mm backset.

2. Function: Select function, for example 782 = Escape Lock

3. Sub Function: Determine sub function requirements for both exterior and interior.
For example:
Exterior – Locking function required – specify V (cylinder).
Interior – Turnknob function required – specify T (turnbutton adaptor).

4. Anti-lockout Selection: Determine if anti-lockout function is needed.
For example:
Anti-lockout - Specify A

5. Finish: Select appropriate finish, e.g. SS
Other finishes available by specifying finish kits.