

Blynclight Wireless

Quick Reference Guide



How to use your Blynclight Wireless

Charging your Blynclight

Connect the provided USB cable from your PC to the Blynclight to charge the device. The indicator at the front of the device will show a solid red light while charging. Once fully charged, around 2.5 hours, the red indicator will switch off.

When operating the device wirelessly, the front indicator will display a solid green light. When the device requires charge, the front indicator will begin flashing green.

Connecting your Blynclight

Plug the USB wireless adaptor into the USB port of your PC.

Beneath the Blynclight, push the switch into the 'On' position.

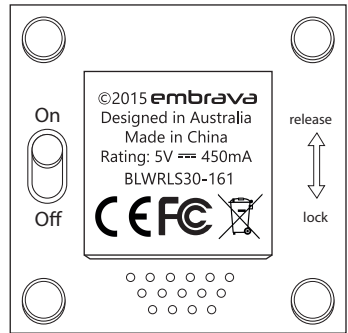
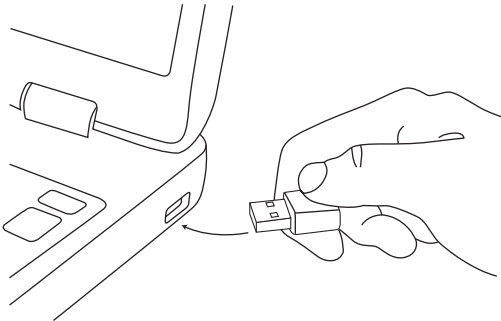

Download Embrava Connect software

To activate the Blynclight, download and install the Embrava Connect software at <http://www.embrava.com/software>.

Setting your Availability

With Embrava Connect installed and running, the Blynclight will automatically display the color matching your selected UC application status. Use the Embrava Connect application to configure how your Blynclight will function. For support on using Embrava Connect visit <http://www.embrava.com/support>.

Frequently Asked Questions

www.embrava.com/FAQ

Technical Support

www.embrava.com/support

Community Support

www.embrava.com/community

Mounting your Blynlight

Select a position to mount your device that is within 30 feet of the PC with the wireless adaptor connected. (Operating distance may vary if interrupted by walls.)

Clean and dry the surface you wish to apply the mount. Peel one side of the included 3M adhesive and apply it to the rear of the mount. Peel the other side of the 3M adhesive and apply to the cleaned surface with pressure for around 10 seconds. Slide your Blynlight down onto the mount to lock it in position. Sliding the device up will release the device.

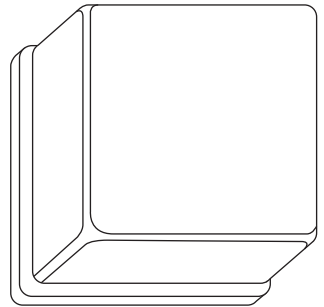
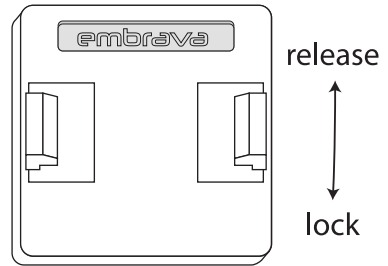

Uploading Ringtones

Connect the provided USB cable from your PC to the Blynlight and turn the Blynlight on via the switch on its base. You will now see a storage device appear within your PC.

To play your own ringtones on the device, copy and paste your mp3 ringtones onto this storage device. Use Embrava Connect to configure which ringtones should play for certain events.

Limited Warranty Statement

Embrava provides limited warranty on this product. This limited warranty covers any defect in material or workmanship under normal use during the Warranty Period.

This limited warranty does not cover any problem that is caused by misuse of the product.

During the Warranty Period, Embrava will repair or replace, at no charge, products or parts of a product that proves defective because of improper material or workmanship, under normal use and maintenance.

The Warranty Period for this product is two (2) years in Europe and one (1) year in the United States and all other countries from the date of purchase. A proof of purchase is required to access this Warranty. Without a proof of purchase the Warranty Period for this product will be two (2) years in Europe and one (1) year in the United States and all other countries from the date of manufacture.

If you find that your product is defective please visit www.embrava.com/support to log a support ticket requesting a Faulty Device Return Authorization. You will be provided a return address with this authorization where you will be asked to ship the defective device at your expense.

Once the defective device is received and investigated you will be shipped a new or repaired device free of charge.

FCC Regulatory Information

The Wireless Blynclight complies with part 15 of the FCC rules. Operation is subject to the following two conditions: (1) this device may not cause harmful interference, and (2) this device must accept any interference received, including interference that may cause undesired operation. Note: This equipment has been tested and found to comply with the limits for a Class B digital device, pursuant to part 15 of the FCC rules. These limits are designed to provide reasonable protection against harmful interference in a residential installation. This equipment generates, uses, and can radiate radio frequency energy and, if not installed and used in accordance with the instructions, may cause harmful interference to radio communications. However, there is no guarantee that interference will not occur in a particular installation. If this equipment does cause harmful interference to radio or television reception, which can be determined by turning the equipment off and on, the user is encouraged to try to correct the interference by one or more of the following measures:

- Reorient or relocate the receiving antenna.
- Increase the separation between the equipment and receiver.
- Connect the equipment into an outlet on a circuit different from that to which the receiver is connected.
- Consult the dealer or an experienced radio/TV technician for help.

Users are not permitted to modify the device. The user's authority to operate the equipment could be void if modifications are made without approval from Embrava Pty Ltd.

embrava

Embrava Pty Ltd

Level 10, 10 Shelly Street
Sydney, NSW 2000
Australia

Embrava USA Inc.

1732 1st Avenue #25279
New York, NY 10128
United States



Designed in Australia
Made in China

© 2015 Embrava Pty Ltd. All rights reserved.

embrava