



Promatic Clay target launchers.

Initial assembly, first use & safety instructions.



This guide contains only essential safety information, to fully understand your trap and get the most from it we recommend you view the full user manual specific to your trap model.

Detailed manuals are available free of charge on our website:

www.promatic.co.uk or www.promatic.biz

WARNING

Clay target launchers can be dangerous and must be treated with great care at all times to avoid accidents.

Never place any bodily part into the path of any mechanical piece whilst the machine is in motion or likely to be so.

You must treat a clay target launcher with the same caution that you would treat a loaded gun.

Assume at all times that a clay target launcher is armed and loaded and treat it accordingly.



This document must be read in full before attempting to operate the machine

Unpacking your Promatic Trap.

It may be that your Trap needs some assembly prior to first use. This is likely to be limited to fitting the carousel and fitting the spring.

Included in the box will be the following.

- 1) Top plate shaft
- 2) Large brass washer
- 3) Carousel
- 4) Blue tubular spacer
- 5) M12 washer
- 6) M12 nylock nut
- 7) The Main spring

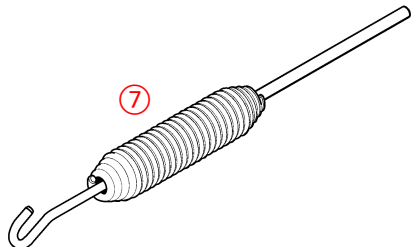
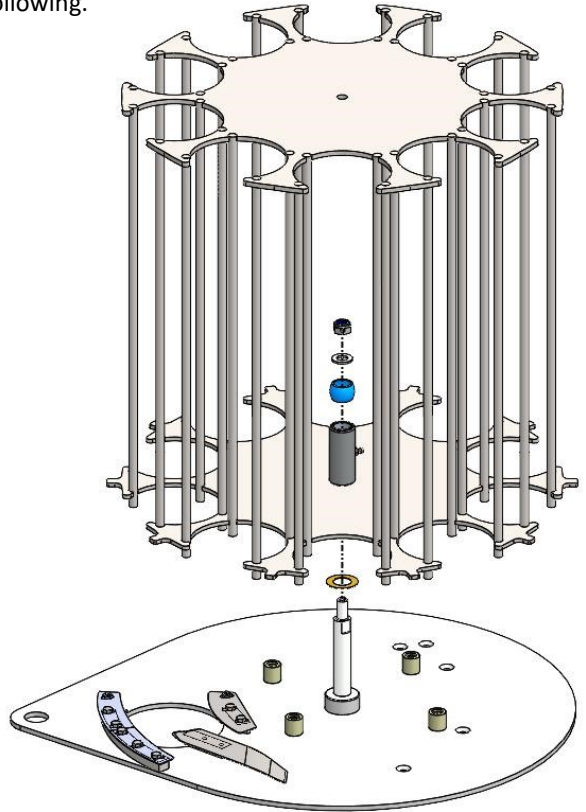
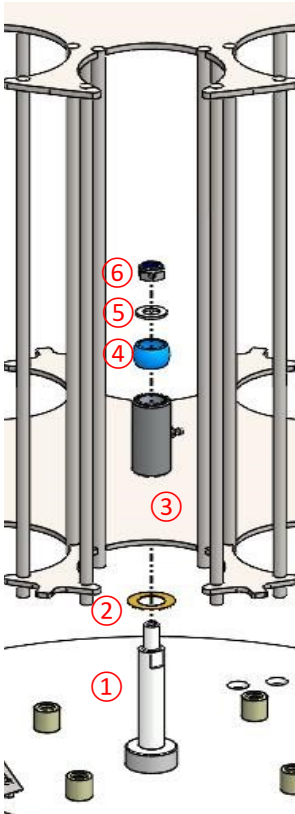

Check the knife edges.

This procedure is done before your trap leaves the factory and there is usually no need for adjustment but may be necessary for certain clays. It is prudent to check before fitting the carousel. Place a clay on the top plate and slide it half way under the two knife edges.

Use a 10mm spanner/wrench to adjust the height of the leading edges of each blade (Position A in diagram below) so that the clay has minimum clearance under the knife edges but can spin freely. Clay heights vary so tests with multiple clays from the box is advisable.

It is also important that the knife edges have the correct clearance around the diameter of the clay and that they support the clay for its entire travel along the knife edge. To set this, loosen the fixing bolts slightly and hold the clay against the inner two carousel bars and gently tap the inner knife edge until

there is about 1mm clearance between the dome of the clay and the entire length of the knife edge. Tighten fixing bolts. Now hold the clay against the two outer carousel bars. Again gently tap the outer knife edge until there is about 1mm clearance between the dome of the clay and the entire length of the knife edge. Tighten fixing bolts.

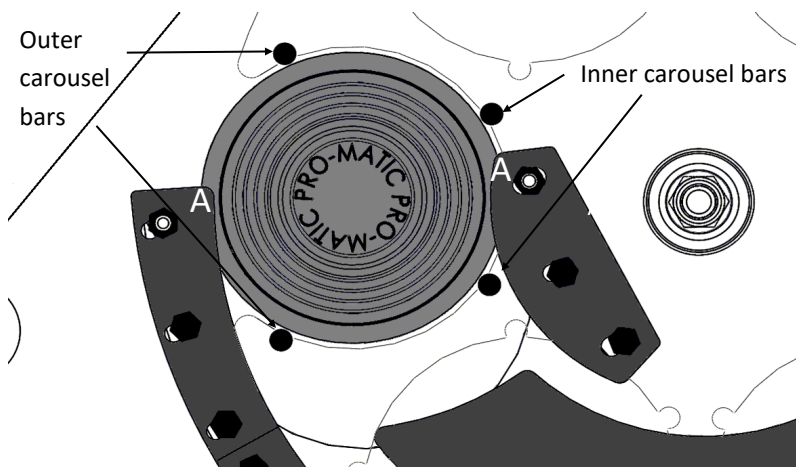
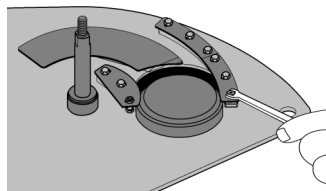
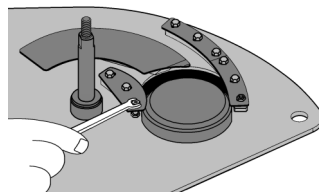
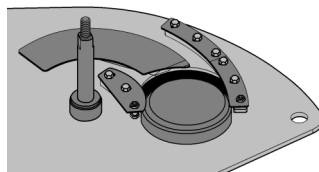

Fitting the carousel.

The fitting of the carousel is straightforward with the order of assembly following the list on page 2. Item 7 is fitted later.

First check to see if the Top plate shaft is fitted to the Top plate. This should be immediately apparent because the Shaft will be clearly visible at the centre of the top plate. If it needs to be fitted simply screw the Shaft into the Top plate. Note that on right handed traps the Shaft has a left handed thread so will need to be screwed in anti-clockwise. On left handed traps the Shaft has a right handed thread and so needs screwing in clockwise. In both cases tighten the Shaft into the Top plate firmly.

Place the large brass washer onto the Shaft. Lubricate with a general purpose grease. There is a grease nipple on the Carousel boss. This can be used to lubricate the bearings and washer during routine maintenance without dismantling the carousel.

Place the Carousel onto the Shaft.

Place the Blue tubular spacer onto the Shaft.

Place the M12 washer onto the Shaft.

Place the M12 nylock nut onto the Shaft and tighten only enough that the Carousel will turn but not spin freely. If the Carousel is spun firmly by hand it should stop in around $1/4$ to $1/2$ of a turn. Check that the Carousel spins through 360° and does not clash with any part of the Top plate.



Tighten the nut only enough that the Carousel will turn but not spin freely.

Check the carousel.

Check that there are no tight spots in any of the carousel pockets. Occasionally machines can suffer slight damage in shipping. This can be easily adjusted with a suitable piece of wood or the handle of a hammer. See photo below. Ensure that a handful of clays move up and down each of the pockets once adjusted.



Fitting the Main spring.

The necessary fasteners to secure the Main spring should be on the Spring shank. Prepare the Spring so there is a nut and then a washer on the shank close to the Spring coils. You will need to remove one nut and one washer if these have already been fitted to the Spring.

Swing the Throwing arm until it projects directly forwards.

Pass the Spring hook over the Nylon bush at the end of the Main shaft with the open end towards the outside of the machine. (See diagram).

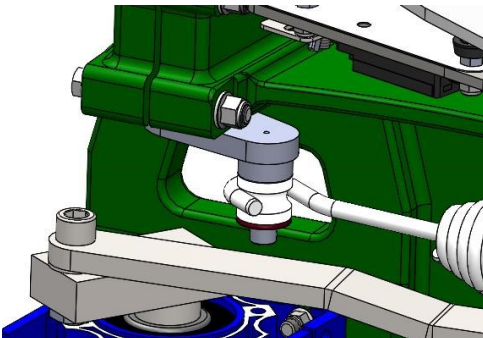

This is not critical but on rare occasions the leg on the open side of the hook can be slightly longer than normal and can bind on the side of the Mainframe.

Pass the threaded shank through the hole in the Spring mount towards the rear of the machine.

Pass a washer along the shank and then screw the second nut along the Spring shank and hand tighten so the Spring is retained around the Nylon bush.

Tighten the Spring using a 19mm spanner. The more the Spring is tightened, the more powerful the trap becomes and the further the Clay will be thrown. Using two spanners tighten the two nuts together to lock the spring tension.

Do not overtighten the Spring, leave around 30mm of shank between the Spring coils and the inner nut.

Removal is the reverse of this procedure.

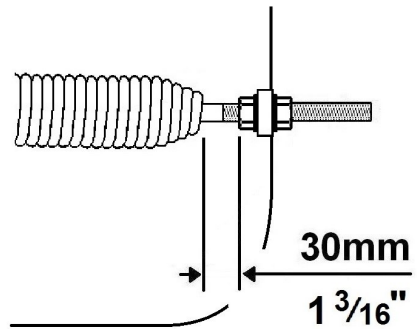

Positioning the machine

1. Clay Target Launchers must be situated on firm level ground in a position that will allow unrestricted access to rear of machine.
2. There must be no obstructions to the path of the throwing arm.
3. Ensure that the power supply can be easily disconnected and cables cannot become tangled in any part of the mechanism.

Connecting the battery

Ensure you are behind the machine, that the **ARM/DISARM** switch is in the **OFF** position and the trap in a safe condition (either disarmed or in safe mode). Connect the red cable to the Red (+) terminal and the black cable to the Black (-) Terminal. Ensure the terminal fasteners are tight, the battery is safely positioned and the charger has been removed.

Further operations

Refer to your traps specific User manual for information about the setup, general usage, and maintenance of your trap. It is important that you read and understand all instructions before beginning use of your trap.



This Trap is designed to be powered from a 12v DC battery.

NEVER CONNECT THE TRAP TO MAINS AC POWER.

Battery: Where a trap is connected to any other suitable power source i.e. a Transformer - the relevant sections of instructions should still be observed, i.e. "Disconnect the battery" and applied to this or any other power source.

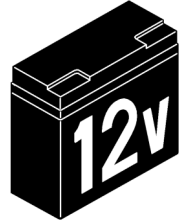

EYE PROTECTION MUST BE WORN when working on or around a clay target launcher as small pieces of clay may be ejected during use.



Never approach the machine from the front or sides, Do not assume the trap is safe, even without electrical power it may still be armed and can fire without power being applied.

Ensure the machine is stable on firm level ground before use. Traps should always be bolted to a solid base or the optional H Frame (which itself should be securely pegged) before use.

GENERAL WARNINGS - BEFORE OPERATING ANY TRAP

ALWAYS disarm the machine before any loading, adjustment or maintenance.

ALWAYS load clays from rear and **ONLY** if the machine is disarmed and safe.

NEVER approach the machine from the front or sides. **ALWAYS** from the rear.

NEVER allow children or untrained persons to approach or touch the machine.

NEVER move an armed/loaded machine. **ALWAYS** disarm and disconnect battery.

REMOVE the main throwing spring before transport in a vehicle.

BE AWARE of the fall zone of both broken and unbroken clays and that a change in wind direction will affect this.



Barclay Phelps CE Marking Consultants, 29/8 City Mill Lane, Gibraltar 646, Europe

CERTIFICATE & DECLARATION OF CONFORMITY FOR CE MARKING

Company contact details:

Promatic International Ltd.

Station Works, Hooton Road, Hooton, S Wirral, CH66 7NF, United Kingdom

Tel: +44(0)151 327 2220 Fax: +44(0)151 327 7075 e mail: info@promatic.co.uk

Promatic International Ltd. declares that their:

Clay Target Launchers listed as the following models

Elite, Hawk, Superhawk, Harrier, Harrier ABT/Wobble, Eagle, Eagle Battue, Falcon, Hobby / Merlin, Ranger 8, Osprey/All American Ranger, Ranger Battue, Ranger ABT/Wobble, Sporter 400TT, Sporter 400TT ABT/Wobble, Super Sporter Battue, Super Sporter, Super Sporter Downhill Thrower, Super Sporter ABT/Wobble, Rabbit, Squirrel, Ranger Chondell, Chondell, Hunter Wobble, Huntsman, Huntsman XP, Fieldsman, Club Skeet, Pro Skeet, Int Skeet, Olympic Trap, Club 275 DTL/ATA, International DTL/ATA, Pro ABT/Wobble, Auto Trap DTL/ATA/ABT/Wobble, International Doubles DTL/ATA/Wobble and Sporter Doubles DTL/ATA/Wobble

are classified within the following EU Directives:

Machinery Directive 2006/42/EC

Electromagnetic Compatibility Directive 2004/108/EC

and further conform with the following EU Harmonized Standards:

EN 12100-1:2003+A1:2009 EN 12100-2:2003+A1:2009

EN 61000-6-3:2007 EN 61000-6-1:2007

Dated: 19 April 2011

Position of signatory: Group Technical Director

Name of Signatory: Graham Stephen Fair

Signed below:

p.p. Promatic International Ltd.

Promatic Inc.

**801, Mid America Drive,
Plattsburg.
MO 64477
USA**

Promatic International Ltd.

**Hooton Road,
Hooton,
South Wirral
CH66 7PA,
United Kingdom.**

Toll Free: 888.767.2529

Fax: 816.539.0257

Tel: +44 (0) 151 327 2220 (General)

E-mail info@promatic.co.uk
Website: www.promatic.co.uk

E-mail: sales@promatic.biz
Website: www.promatic.biz