

All-in-one



## INSTALLATION GUIDE

RealRidge Slate is an all-in-one ridge tile system made from natural slate. Its patent pending, interlocking fixing system means it is very easy to install, but watertight whilst allowing for the required high level ventilation of modern building requirements. Natural materials and invisible fixings means RealRidge is the best looking, best performing ridge available.

## ADVANTAGES OF REALRIDGE

Fully vented  
All-in-one system with no need for roll-out  
Easy to install  
Natural slate with excellent aesthetics

**MAYAN**  
ROOFING SYSTEMS

**P:** 01305 858401  
**E:** [info@mayanroofingsystems.com](mailto:info@mayanroofingsystems.com)  
**A:** 7 Kent Close  
Granby Industrial Estate  
Weymouth, Dorset  
DT4 9TF

\* This fitting guide is subject to continued improvement. Please ensure you follow the latest version, which can be found at [mayanroofingsystems.com/resources](http://mayanroofingsystems.com/resources)

02/2022

[www.mayanroofingsystems.com](http://www.mayanroofingsystems.com)



- 2. Product Specification
- 2. RealRidge Technical Drawing
- 3. Site Safety
- 3. Full Installation Instructions
- 3. Ridge Batten
- 4-5. Installation of RealRidge Tiles

## PRODUCT SPECIFICATION

### RealRidge Slate - Natural slate ridge and hip system



<b>Colour:</b>	Natural Slate - Graphite
<b>Size (width x length) :</b>	200mm x 500mm
<b>Thickness:</b>	Approx 11mm
<b>Weight:</b>	19.8 kg (average)
<b>Vent:</b>	5mm continuous
<b>Angles:</b>	90° ; 105° ; 120° ; 135°

### RealRidge Fixings (included with RealRidge) - RidgeFix screws

#### RidgeFix<sub>60 / 100</sub>

<b>RidgeFix 100 screw with nitrile washer</b>	Stainless steel Pozi 4.5x100mm	1 per RealRidge
<b>RidgeFix 60 screw with nitrile washer</b>	Stainless steel Pozi 4.5x60mm	1 per RealRidge
<b>Ridge runner bracket</b>	Galvanised steel	1 per RealRidge

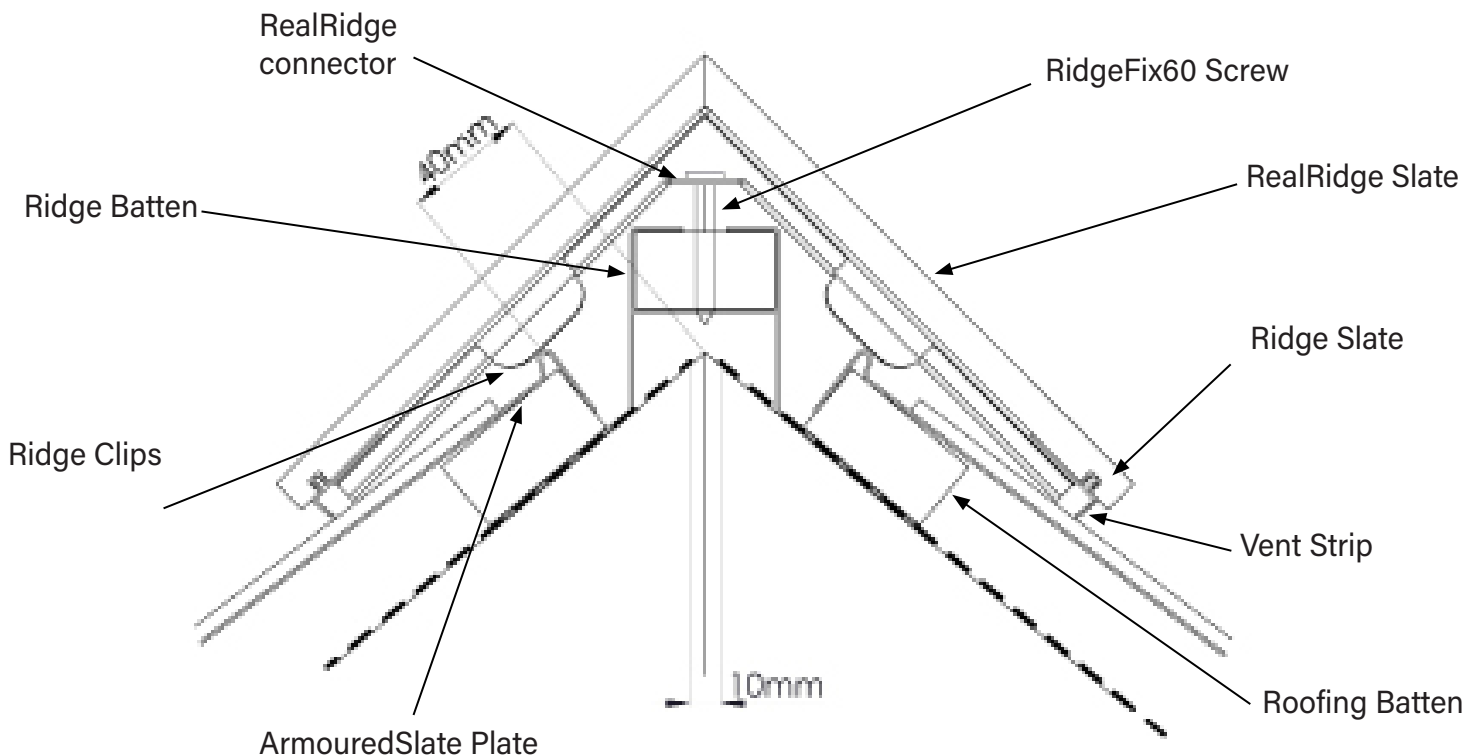

### RealRidge Slate installed in situ with the ArmouredSlate system

## Site Safety

In all cases ensure a safe working environment. Site health and safety measures must be properly adhered to.

- ☑ Personal protective equipment must always be worn where required.
- ☑ RealRidge is a heavy object. Care must be taken when lifting and handling to avoid injury.
- ☑ The products must be properly handled and stored to avoid becoming a dangerous missile on site.

## FULL INSTALLATION INSTRUCTIONS

### Ensure

- Ensure you meet the requirements for roof space ventilation and the roof is correctly ventilated.
- Install in accordance with BS 5534.
- Store all materials correctly.
- Ensure safe working practice at all times.

The Mayan RealRidge system must be installed in accordance with this installation guide using only high-quality Mayan Roofing Systems products, including self-adhesive ArmouredFlashing and all fixtures and fittings provided.

### Ridge Batten

If a vented ridge is required, then the membrane should be cut along the centre line of the ridge so that an air gap of at least 10mm is created.

The ridge runner brackets should be fixed over the rafters or truss and the timber runner batten should be fitted into the brackets.

Hip runner battens should also be fitted to either side of the central batten to ensure that mitred battens and cut slates are securely double fixed. Cut slates can be re-drilled to ensure a double fixing.

With consideration to the dry ridge system, the top batten should be positioned a minimum of 40mm down from the very apex of the rafters/truss.



## Installation of RealRidge

### Install the first ridge

If using a block / hip end, this should be the first piece fixed into position from one end.

If not using a block / hip end, starting from one side, the built in GRP RealRidge connector faces inward so that the next RealRidge connects onto it with the connector clips engaged beneath the connector.



The first ridge tile or block / hip end should always be double fixed into position using 2 RidgeFix stainless steel screws with nitrile washers -

- On the first ridge tile or block/hip end, drill a 5mm dia hole 100mm in from the end straight down from the apex into the ridge runner batten. Fix with a 100mm long RidgeFix screw (supplied).
- Fix the second 60mm RidgeFix screw (supplied) through the ridge connector hole and into the batten.



### Continue along the ridge

Install the next ridge tile by ensuring that the retaining clips are located under the ridge connector of the previous ridge.

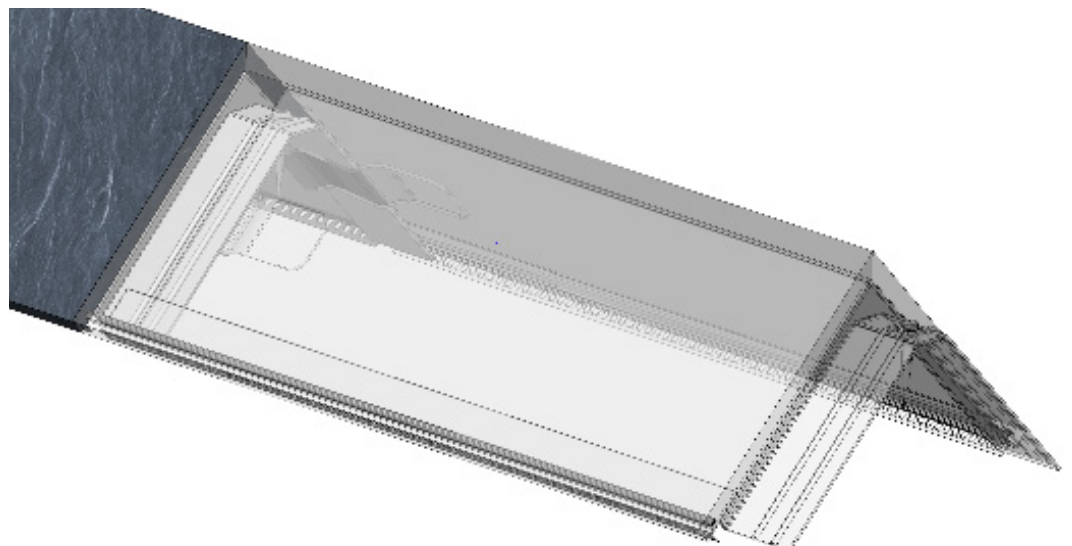

## Installation of RealRidge Tiles

### Continue along the ridge

Install the next ridge placing the retaining clips under the ridge connector of the previous ridge. Screw each ridge into place through the ridge connector and continue across the ridge.



### Install the last ridge

At the end of the course, the last ridge tile or block end should be reversed (ridge connector facing inward).

Install the final ridge using a double fixing as the first ridge-

- Drill a 5mm dia hole 100mm in from the end straight down from the apex into the ridge runner batten. Fix with a 100mm long RidgeFix screw through the top of the Ridge.
- Fix the second 60mm RidgeFix screw (supplied) through the ridge connector hole and into the batten.

### Cut the ridge to fit

Measure the gap remaining between the last ridge tile / block end and the last full ridge tile installed.

Cut the ridge tile to length to fit in this gap, cutting from the connector side so that the last cut piece does not have a ridge connector.

Drill 2 x 5mm dia holes straight down from the apex and cut off the underneath clips so the piece sits neatly in the space.

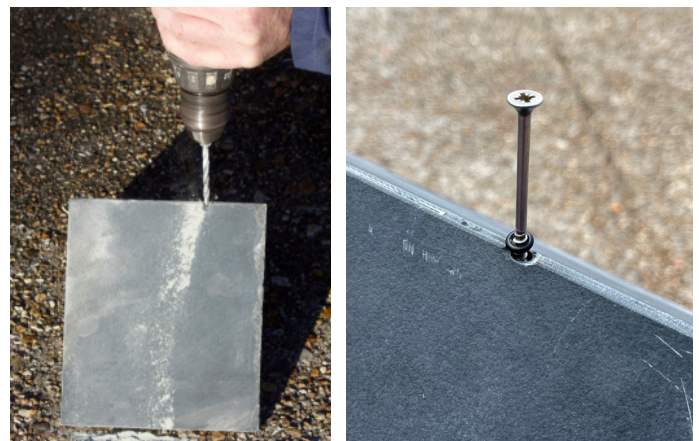

Place over the two connectors in the gap and double fix with 2 x 100mm RidgeFix screws (supplied).

