



**We love that you are rocking JLab!  
We take pride in our products and fully stand behind them.**

JLAB  
JBUDS AIR PRO  
|  
EARBUDS



**YOUR WARRANTY**

All warranty claims are subject to JLab authorization and at our sole discretion. Retain your proof of purchase to ensure warranty coverage.



**CONTACT US**

Reach out to us at [support@jlab.com](mailto:support@jlab.com) or visit [jlab.com/contact](http://jlab.com/contact)

**REGISTER TODAY**

[jlab.com/register](http://jlab.com/register)

[Product updates](#) | [How-to tips](#)  
[FAQs & more](#)

**BLUETOOTH PAIRING**

- 1 Take earbuds out of case and remove stickers. Place earbuds back in case and close door.

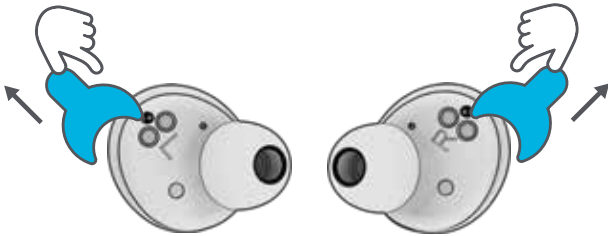

- 2 **Blue lights** on case indicates charging. Remove earbuds from case.

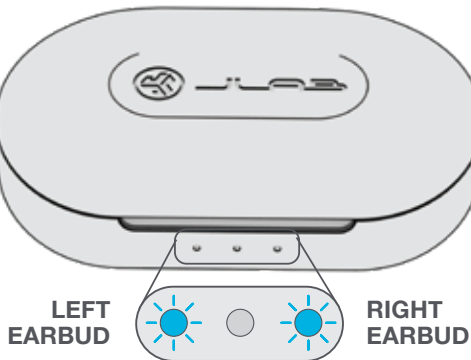

**ADDING NEW / ADDITIONAL BLUETOOTH DEVICES:**

**Turn OFF Bluetooth** from any previously connected device.  
**Turn ON Bluetooth** from new device.

Earbuds will automatically enter Bluetooth Pairing.  
Select "JLab JBuds Air Pro" in new device settings to connect.

- 3 **One earbud will blink blue/white** indicating ready to pair to your device.

Select "JLab JBuds Air Pro" in your device's Bluetooth settings.

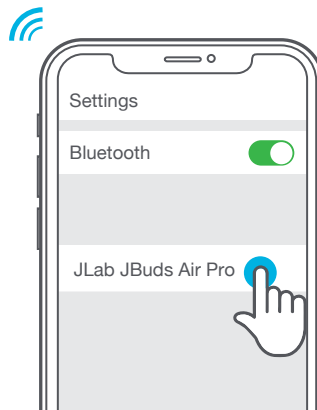
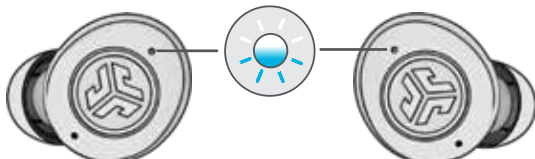

## BUTTON FUNCTIONS

LEFT  
EARBUD

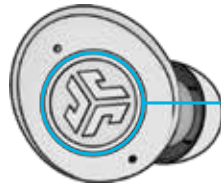
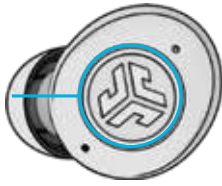

RIGHT  
EARBUD

**VOLUME DOWN:** Single tap  
**SIRI (iOS) or "OK GOOGLE" (ANDROID):** Double tap

**MUSIC / MOVIE MODE:**  
Press & hold 1+ sec

**TURN ON:** Press & hold 3+ sec

**CHANGE EQ:** Triple tap  
(JBuds Air Pro will cycle 3 EQ settings)

**VOLUME UP:** Single tap

**ANSWER:** Single tap

**HANGUP:** Double tap

**REJECT INCOMING CALLS:**  
Press & hold 1+ sec

**PLAY / PAUSE:** Double tap

**TRACK FORWARD:** Press & hold 1+ sec

**TURN ON:** Press & hold 3+ sec

**BE AWARE:** Triple tap

## VOICE PROMPTS

**"Ready to Pair":** JBuds Air Pro are ready to pair to Bluetooth device

**"Battery Full":** 100-80%

**"Battery Medium":** 80-20%

**"Low Battery":** Less than 20%  
When power decreases to 10%,  
"Low Battery" will play

## TURN OFF WITHOUT CHARGING CASE:

Turn off Bluetooth from device settings. Earbuds will power off after 3 minutes.

## CUSTOM EQ<sup>3</sup> SOUND MODES

Tap either the right or left earbud 3 times for different EQ settings (JBuds Air Pro will cycle 3 EQ settings).



**JLab SIGNATURE**  
JLab C3™ signature  
sound with amplified  
bass and vocals



**BALANCED**  
Even sound with  
no additional  
enhancements



**BASS BOOST**  
Amplified bass  
and sub-bass

## CHARGING EARBUDS

Placing in the charging case will auto power OFF and start charging.

**Blue lights** will indicate earbuds are charging and will turn OFF when fully charged.

Removing the earbuds will auto power ON and connect to last device.

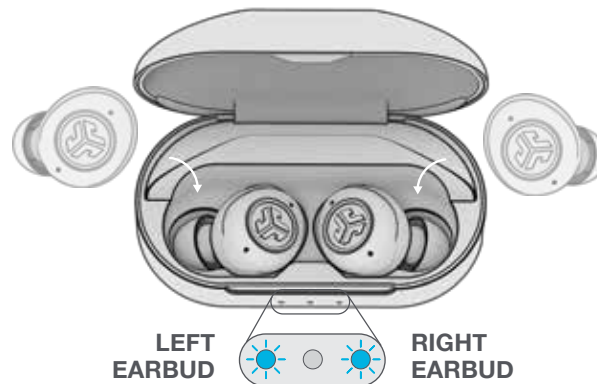

## CHARGING CASE

Connect the JBuds Air Pro to computer or USB 5V 1A (or less) output device.

LEDs **pulse white** when charging and **turn solid white** when fully charged.

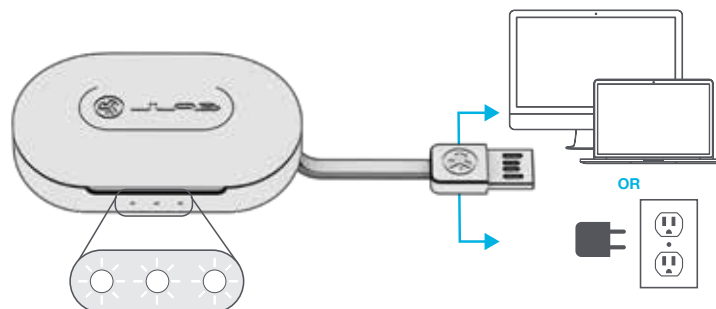

## MULTIPOINT (connect 2 devices simultaneously)

- 1 Once **FIRST** device is connected, turn off Bluetooth in device settings. JBuds Air Pro will auto enter Bluetooth Pairing.

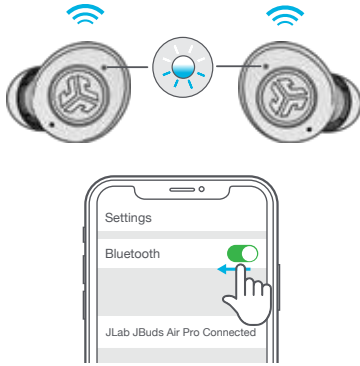

- 2 Enter your **SECOND** device Bluetooth settings and connect to JBuds Air Pro.



- 3 Enter your **FIRST** device Bluetooth settings. Turn on Bluetooth and connect to JLab JBuds Air Pro.

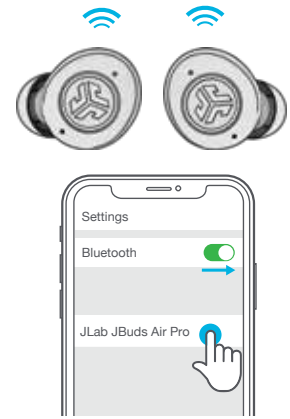

## FITTING

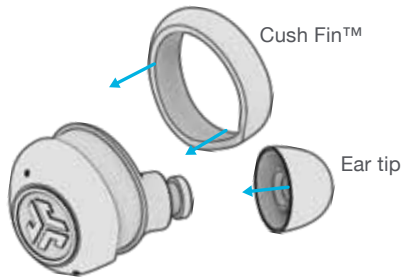

Try all the optional Cush Fins and ear tips for best fit and proper seal.

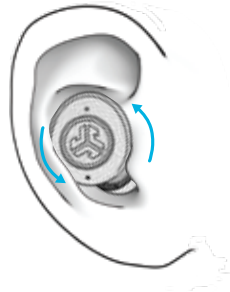

Place in ear and rotate for best fit.

## TROUBLESHOOTING

### NO AUDIO IN ONE EARBUD OR EARBUDS DISCONNECTED (MANUAL RESET)

- 1 Keep earbuds in the charging case and forget "JLab JBuds Air Pro" in your Bluetooth device settings.

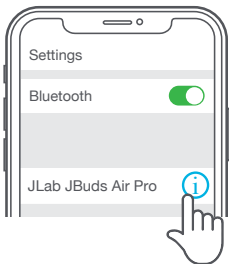

- 2 Quick tap 7x on one earbud in charging case. Earbud blinks blue 4 times.

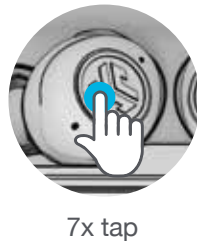

- 3 Quick tap 7x on other earbud in charging case. Earbud blinks blue 4 times.



- 4 Take both earbuds out of the charging case. One earbud will blink blue/white indicating ready to pair to your device.



Instructional videos at: [JLAB.COM/MANUALS](https://www.jlab.com/manuals)

## QUICK TIPS

- Either earbud can connect to your device and be used independently. Simply take out the earbud from charging case and it will auto connect.
- Choosing the correct ear tip makes a significant improvement in audio quality due to proper seal for the driver. Try all ear tips for best results.

## WARNING

**Fully dry off the earbuds before putting in the charging case to avoid any damage to the case.**

The earbuds are sweat/water resistant but the case is not.

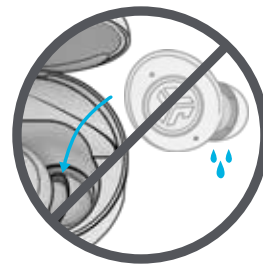

## CAUTIONS

- Avoid extreme heat, cold, and humidity.
- Avoid dropping or crushing the earbuds.
- Wax may build up in the earbud tips, lowering the sound quality. Carefully remove the wax with a cotton swab or other small tool to improve the sound quality.
- If you experience discomfort or pain, try lowering the volume or discontinuing use temporarily.
- If you experience regular discomfort while using this product, discontinue use and consult your physician.
- We recommend you treat your earbuds as you would a nice pair of sunglasses and keep them in safe location when not in use.



[Shop products](#) | [Product alerts](#) | [Burn-in your headphones](#)

JLab Store + Burn-in Tool

