



We love that you are rocking JLab!
We take pride in our products and fully stand behind them.

JLAB
JBUDS AIR ANC
|
EARBUDS



YOUR WARRANTY

All warranty claims are subject to JLab authorization and at our sole discretion. Retain your proof of purchase to ensure warranty coverage.



CONTACT US

Reach out to us at support@jlab.com or visit [jlab.com/contact](https://www.jlab.com/contact)

REGISTER TODAY

[jlab.com/register](https://www.jlab.com/register)

[Product updates](#) | [How-to tips](#)
[FAQs & more](#)

FIRST TIME SETUP

1 AUTO-CONNECTING EARBUDS

Press and hold **both buttons 3+ seconds** to power ON.
One earbud **blinks blue/white** indicating ready to pair to your device.

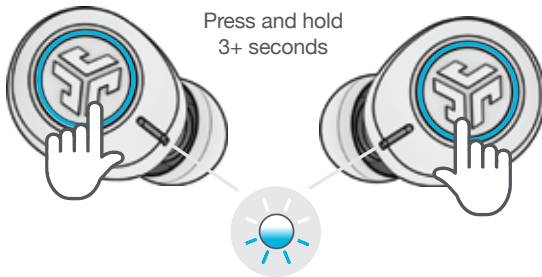

2 CONNECTING TO BLUETOOTH

Select "JLab JBuds Air ANC" in your device settings.
Voice prompt "Bluetooth connected" followed by **solid white lights** will indicate you are connected.

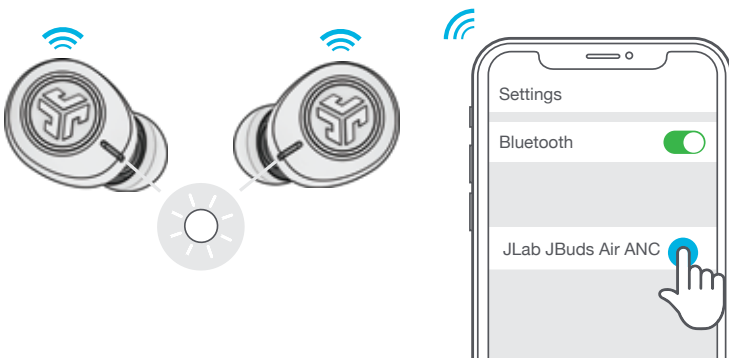

ADDING NEW / ADDITIONAL BLUETOOTH DEVICES:

Turn OFF Bluetooth from any previously connected device. Turn ON Bluetooth from new device.

Earbuds will automatically enter Bluetooth Pairing. Select "JLab JBuds Air ANC" in new device settings to connect.

BUTTON FUNCTIONS



VOLUME DOWN: Single Tap

SIRI (iOS) or "OK GOOGLE" (ANDROID): Double Tap

BE AWARE / ANC ON / ANC OFF:
Press & hold 1+ sec

TURN ON: Press & hold 3+ sec

CHANGE EQ: Triple Tap
(JBuds Air ANC will cycle 3 EQ settings)

VOLUME UP: Single Tap

ANSWER: Single Tap

HANGUP: Double Tap

REJECT INCOMING CALLS:
Press & hold 1+ sec

PLAY / PAUSE: Double Tap

TRACK FORWARD: Press & hold 1+ sec

TURN ON: Press & hold 3+ sec

CHANGE EQ: Triple Tap
(JBuds Air ANC will cycle 3 EQ settings)

VOICE PROMPTS

"Ready to Pair": JBuds Air are ready to pair to Bluetooth device

"Bluetooth Connected":
Earbud is connected to device

"Battery Full": 100-80%

"Battery Medium": 80-20%

"Low Battery": Less than 20%
When power decreases to 10%,
"Low Battery" will play

MUSIC / MOVIE MODE: Press and hold both touch sensors simultaneously 3+ seconds

POWER OFF WITHOUT CHARGING CASE: Turn off your Bluetooth from your device settings.
The earbuds will then power off after 3 minutes.

CUSTOM EQ³ SOUND MODES

Tap either the right or left earbud 3 times for different EQ settings (JBuds Air ANC will cycle 3 EQ settings).

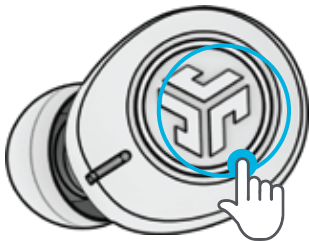

JLab SIGNATURE
JLab C3™ signature
sound with amplified
bass and vocals



BALANCED
Even sound with
no additional
enhancements



BASS BOOST
Amplified bass
and sub-bass

CHARGING EARBUDS

1 Match the corresponding L and R letters on the charging case for proper charging. The earbuds will auto power OFF and start charging.

Blue lights will indicate earbuds are charging and will turn OFF when fully charged.

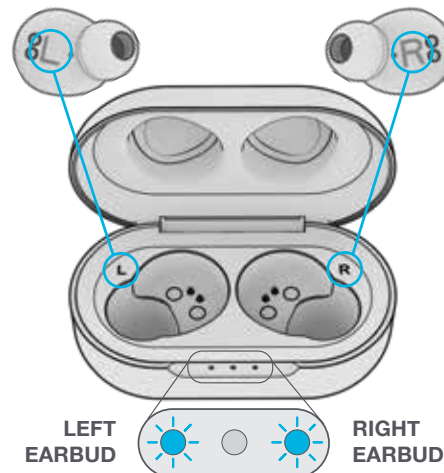

2 Earbuds will auto power ON and reconnect to your device when taken out of the case.



CHARGING CASE

Connect the JBuds Air ANC to computer or USB 5V 1A (or less) output device.

LEDs **pulse white** when charging and **turn solid white** when fully charged.

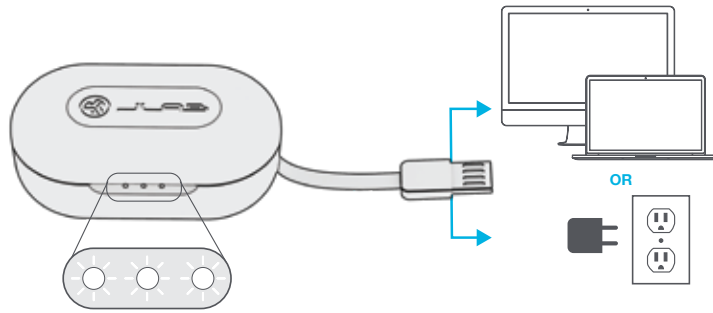

FITTING

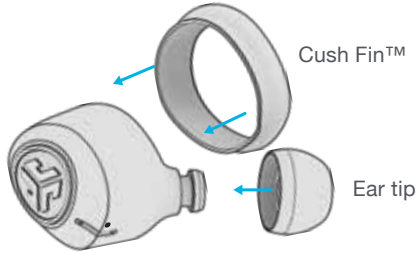

Try all the optional Cush Fins and ear tips for best fit and proper seal.

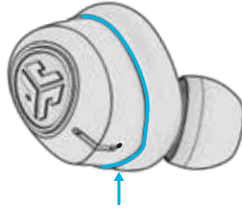

The Cush Fin should be aligned by positioning the contour around the microphone hole.

FIND YOUR EARBUDS

Download the Tile app and activate to find your earbuds.

Learn more at jlab.com/tileapp

Activating Tile will reduce earbud playtime.



DOWNLOAD THE APP

Customize JBuds Air ANC features and update the latest software.

Download the JLab Sound App in Apple/Google Play Store.



ECHOES ON CALLS

If you experience microphone echo/call quality with the JBuds Air ANC, make sure the Cush Fin is not blocking the microphone port.

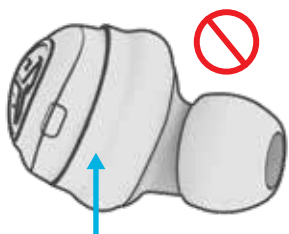

Microphone covered

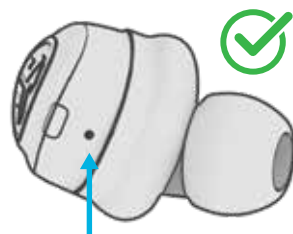

Microphone open

TROUBLESHOOTING

NO AUDIO IN ONE EARBUD OR EARBUDS DISCONNECTED (MANUAL RESET)

- 1 Enter your Bluetooth device settings and forget the JBuds Air ANC.

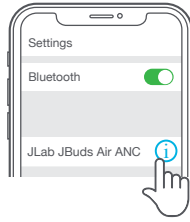

- 2 Open the charging case and keep the earbuds inside.



- 3 On ONE earbud, quickly tap 7x the touch sensor. The light **blinks blue 3x** then turns off.

Repeat same steps with other earbud. Quickly tap 7x the touch sensor. The **light blinks blue 3 times** then turns off.

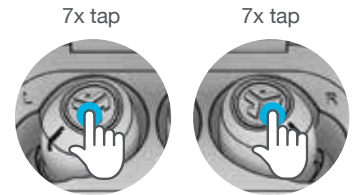

- 4 Wait 10 seconds and open the charging case. Wait for both of the earbuds to **blink blue/white**. You are now ready to pair to your Bluetooth device.



Instructional videos at: [JLAB.COM/MANUALS](https://www.jlab.com/manuals)

QUICK TIPS

- Either earbud can connect to your device and be used independently. Simply take out the earbud from charging case and it will auto connect.
- Choosing the correct ear tip makes a significant improvement in audio quality due to proper seal for the driver. Try all ear tips for best results.

WARNING

Fully dry off the earbuds before putting in the charging case to avoid any damage to the case.

The earbuds are sweat/water resistant but the case is not.



CAUTIONS

- Avoid extreme heat, cold, and humidity.
- Avoid dropping or crushing the earbuds.
- Wax may build up in the earbud tips, lowering the sound quality. Carefully remove the wax with a cotton swab or other small tool to improve the sound quality.
- If you experience discomfort or pain, try lowering the volume or discontinuing use temporarily.
- If you experience regular discomfort while using this product, discontinue use and consult your physician.
- We recommend you treat your earbuds as you would a nice pair of sunglasses and keep them in safe location when not in use.



[Shop products](#) | [Product alerts](#) | [Burn-in your headphones](#)

JLab Store + Burn-in Tool

