



JLAB AUDIO  
JBUDS  
EARBUDS

**We love that you are rocking JLab Audio!  
We take pride in our products and fully stand behind them.**



**YOUR SATISFACTION IS GUARANTEED**

You may exchange or return merchandise purchased within 30 days of the purchase date. Please return the item to the location you purchased it. If your item has been opened or used, restrictions may apply.



**YOUR WARRANTY**

You may register your product at [jlabaudio.com/register](http://jlabaudio.com/register). All warranty claims are subject to JLab Audio authorization and at our sole discretion. Retain your proof of purchase to ensure warranty coverage.



**CONTACT US**

Reach out to us at [support@jlabaudio.com](mailto:support@jlabaudio.com) or visit [jlabaudio.com/contact](http://jlabaudio.com/contact).

**INSTRUCTIONS FOR USE**

- 1 Lower the volume on your audio device.
- 2 Gently insert the earbuds into your ears.
- 3 Gradually raise the volume to a comfortable level.
- 4 In order to block outside noise, position the earbuds so they form a seal inside your ear.
- 5 Test the various gel tip options to find the best fit.

**ADJUSTABLE TIP PLACEMENT**

- 1 Choose your tip size
- 2 Adjust the position



**CUSH FIN PLACEMENT JBuds Pro Feature Only**

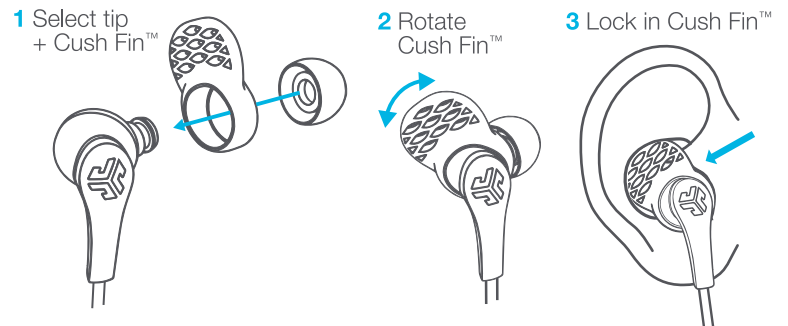

**MICROPHONE + BUTTON FUNCTIONS JBuds Pro Feature Only**



**UNIVERSAL MIC**  
Goes with both Android + Apple

**PLAY / PAUSE  
ANSWER / HANG UP:**  
Single click

**TRACK FORWARD:**  
Double click

**TRACK BACKWARD:**  
Triple click

**WARM-UP YOUR HEADPHONES**

Optional: Burn-in is the process for exercising new audio equipment. We recommend 40 hours of burn-in time for most headphones to reach optimal performance. The main purpose of the process is to loosen the diaphragm of a newly crafted headphone and to stress the headphone driver. Normal, everyday use can also burn-in the headphones though JLab's proprietary burn-in provides an ideal mix of sounds and frequency sweeps to achieve this.

 **Burn-in your audio equipment with the JLab Audio app available on the App Store and Google Play.**  
Or access the burn-in method at: [jlabaudio.com/burnin](http://jlabaudio.com/burnin)

**CAUTIONS**

- Avoid getting moisture or liquids into the tip of the earbuds.
- Avoid extreme heat, cold, and humidity.
- Avoid dropping or crushing the earbuds, stressing the cable by rapid pulling or extreme force, or bending the cable at a sharp angle.
- Wax may build up in the earbud tips, lowering the sound quality. Carefully remove the wax with a cotton swab or other small tool to improve the sound quality.
- If you experience discomfort or pain, try lowering the volume or discontinuing use temporarily.
- If you experience regular discomfort while using this product, discontinue use and consult your physician.
- We recommend you treat your earbuds as you would a nice pair of sunglasses and keep them in safe location when not in use.