



JLAB AUDIO
EPIIC AIR SPORT
EARBUDS

We love that you are rocking JLab Audio!
We take pride in our products and fully stand behind them.



YOUR WARRANTY

All warranty claims are subject to JLab Audio authorization and at our sole discretion. Retain your proof of purchase to ensure warranty coverage.



CONTACT US

Reach out to us at support@jlabaudio.com or visit jlabaudio.com/contact

REGISTER TODAY

jlabaudio.com/register

Product updates | How-to tips
FAQs & more

FIRST TIME SETUP

1 AUTO-CONNECTING EARBUDS

- A. Take earbuds out of the charging case and remove stickers.
- B. Press and hold both Power Buttons 2+ seconds to turn ON. Left earbud turns **solid white** and Right earbud **blinks blue/white** indicating ready to pair to your device.

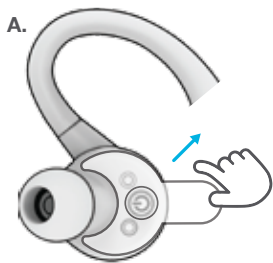

Remove stickers

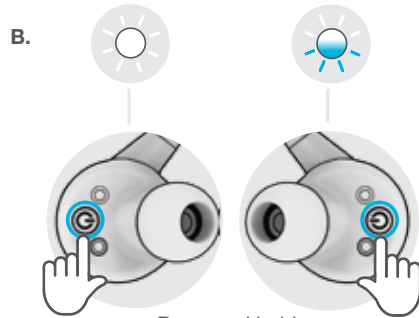

Press and hold 2+ seconds

2 CONNECTING TO BLUETOOTH

- Select "JLab Epic Air Sport" in your device settings. Voice prompt "Bluetooth connected" followed by **solid white lights** will indicate you are connected.

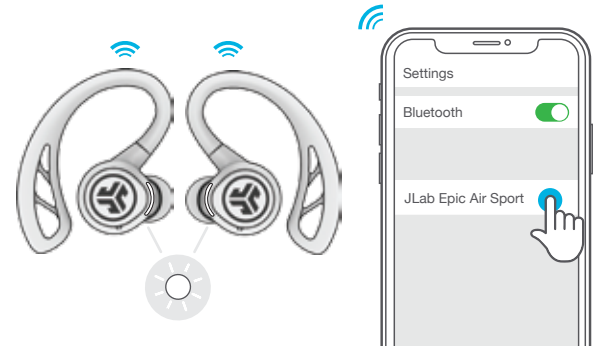

ADDING NEW / ADDITIONAL BLUETOOTH DEVICES:

Turn OFF Bluetooth from any previously connected device. Turn ON Bluetooth from new device. Take earbuds out of the case. Earbuds will automatically enter Bluetooth Pairing. Select "JLab Epic Air Sport" in device settings to connect.

IN THE BOX

EARBUDS

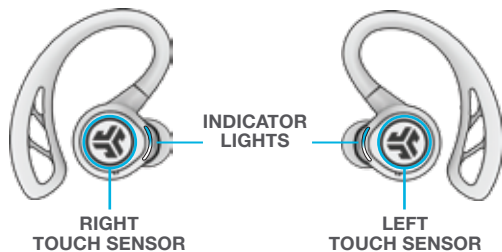

RIGHT TOUCH SENSOR

LEFT TOUCH SENSOR

EARTIPS

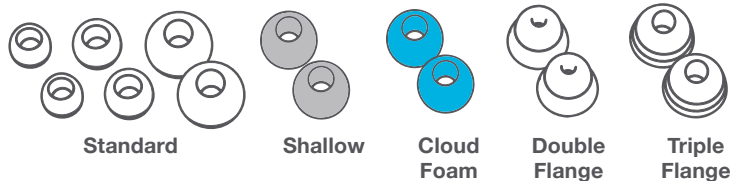

Standard

Shallow

Cloud Foam

Double Flange

Triple Flange

CHARGING CASE

USB CHARGE OUTPUT
For charging other devices

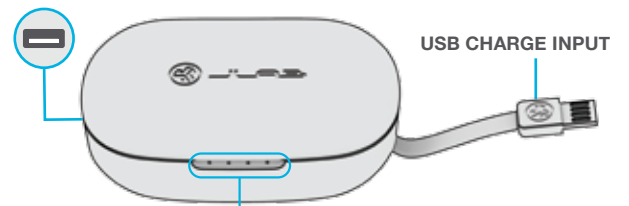

CHARGE INDICATOR LIGHTS

CONTROLS



VOLUME DOWN: Single tap
SIRI (iOS) or "OK GOOGLE" (ANDROID): Double tap
TRACK BACK: Press & hold 1+ sec
EQ CHANGE: Triple tap
(Epic Air Sport will cycle 3 EQ settings)

VOLUME UP: Single tap
PLAY / PAUSE: Double tap
TRACK FORWARD: Press & hold 1+ sec
ANSWER: Single tap
HANG UP: Double tap
REJECT INCOMING CALLS: Press & hold 2+ sec
BE AWARE ON / OFF: Triple tap

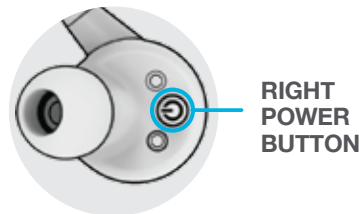
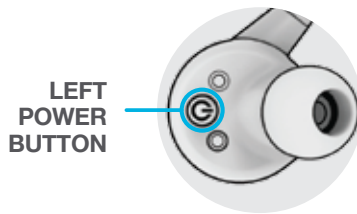

POWER ON: Press and hold 1+ second.
POWER OFF: Press and hold 3+ seconds.
BLUETOOTH PAIRING: (See FIRST TIME SETUP)

VOICE PROMPTS

"Hello": Power ON
"Earbuds joined": Earbuds paired to each other
"Ready to Pair": Epic Air Sport are ready to pair to Bluetooth device
"Bluetooth Connected": Earbud is connected to device
"Battery Full": 100-80%
"Battery Medium": 80-20%
"Low Battery": Less than 20%
When power decreases to 10%, "Low Battery" will play
"Goodbye": Power OFF

EQUALIZER MODES

Triple tap left earbud for different EQ settings. Voice prompts will indicate EQ settings (Epic Air Sport will cycle 3 EQ settings)



JLab SIGNATURE
JLab C3™ signature sound with amplified bass and vocals



BALANCED
Even sound with no additional enhancements



BASS BOOST
Amplified bass and sub-bass

AUTO-POWER ON / OFF

1 Placing the earbuds in the charging case will power OFF earbuds and start charging. **Blue lights** indicate earbuds are charging and will turn OFF when fully charged.

2 When earbuds are taken out of the case, they will auto power on and reconnect to your device.

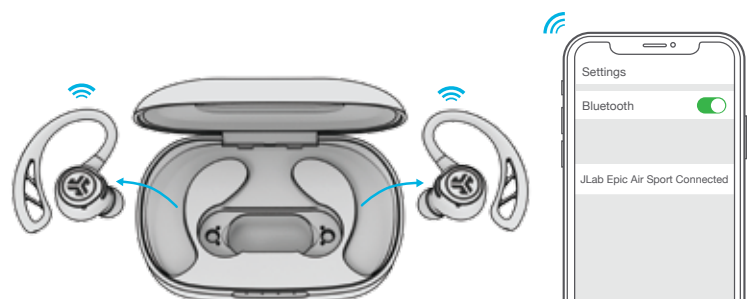
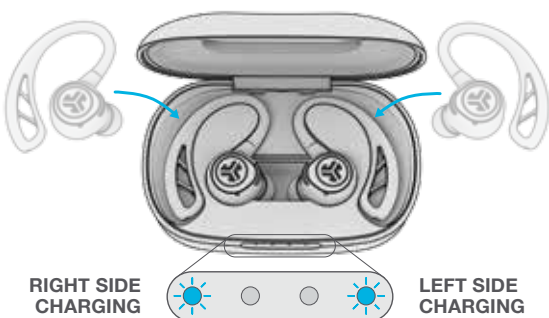

CHARGING CASE

Connect the Epic Air Sport to computer or USB 5V 1A (or less) output device.

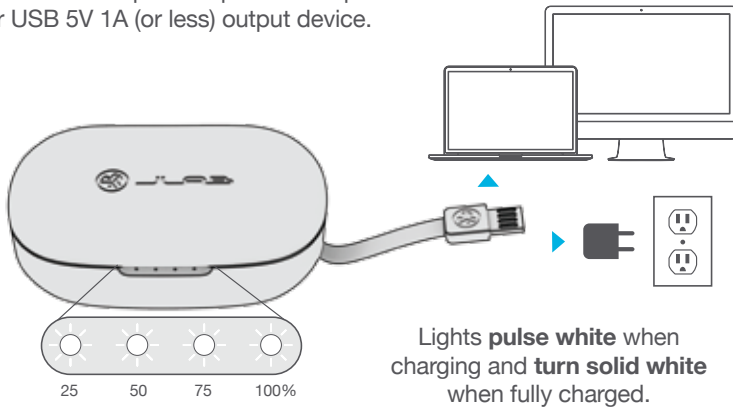

FITTING

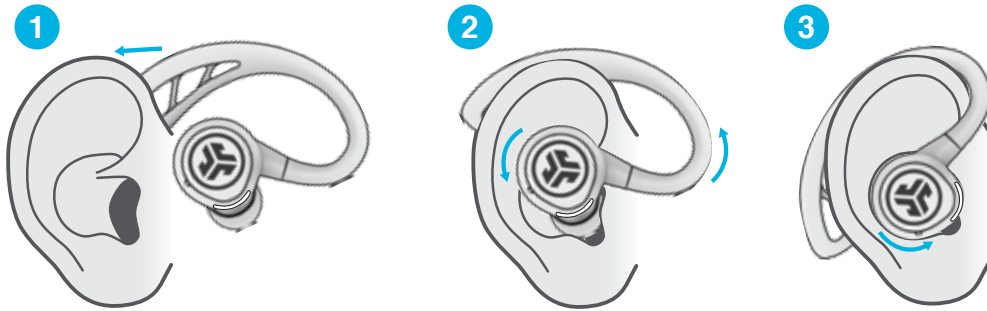

TROUBLESHOOTING

NO AUDIO IN LEFT EARBUD OR EARBUDS DISCONNECT FROM EACH OTHER (MANUAL RESET)

- 1 Enter your Bluetooth device settings and forget the Epic Air Sport. Fig **A**
- 2 Open the charging case door and leave both earbuds inside. Starting with **ONE** earbud, **quickly tap the touch sensor 4x times**. Light will **blink blue 4x times** then **turn solid blue**. Leave the earbuds in the charging case. Fig **C1**
- 3 Repeat with other earbud. **Quickly tap the touch sensor 4x times**. Light will **blink blue 4x times** then **turn solid blue**. Fig **C2**
- 4 Take both earbuds out of the charging case and keep them within 2 inches from each other. Wait for Left earbud to turn **solid white** and Right to **blink blue/white**. You are now ready to pair to your Bluetooth device.

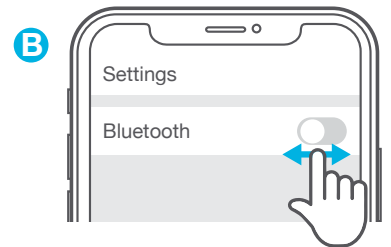
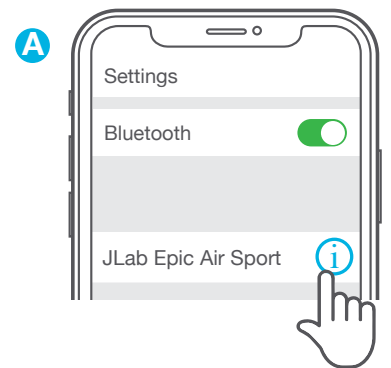

BLUETOOTH DEVICE DOES NOT CONNECT/RECONNECT

- 1 Enter your Bluetooth device settings and forget the Epic Air Sport. Fig **A**
- 2 On your device, turn OFF then ON Bluetooth. Fig **B**
- 3 Take the earbuds out of the case. Wait for Left to turn **solid white** and Right **blinking blue/white**.
- 4 Select "JLab Epic Air Sport" in device settings to reconnect.

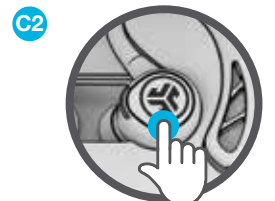
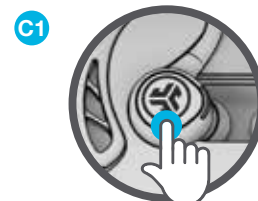

Instructional videos at: JLABAUDIO.COM/MANUALS

QUICK TIPS

- The Bluetooth connection is established from the right earbud. For the most stable connection, keep the device near right hand side or in right pocket.
- If you prefer to wear only one earbud, you must wear the **right earbud** as this is the main earbud connected to Bluetooth.
- Choosing the correct ear tip makes a significant improvement in audio quality due to the proper seal for the driver. Test all ear tips for best results.
- Only ONE Bluetooth device can be connected at a time. Turn off Bluetooth on unwanted devices and turn on Bluetooth on chosen device to connect.

WARNING



Fully dry off the earbuds before placing in the charging case.

If the earbuds are damp or wet, this will cause damage to the charging case. The warranty will be voided if the charging case shows damage by water/sweat.



Do not deform the ear hooks.

The ear hooks are a flexible silicone but also have an internal hard structure for the antenna. Prying on the ear hook may break or damage the antenna.

CAUTIONS

- Avoid getting moisture or liquids into the tip of the earbuds or charging port.
- Avoid extreme heat, cold, and humidity.
- Avoid dropping or crushing the earbuds, stressing the cable by rapid pulling or extreme force, or bending the cable at a sharp angle.
- Wax may build up in the earbud tips, lowering the sound quality. Carefully remove the wax with a cotton swab or other small tool to improve the sound quality.
- If you experience discomfort or pain, try lowering the volume or discontinuing use temporarily.
- If you experience regular discomfort while using this product, discontinue use and consult your physician.
- We recommend you treat your earbuds as you would a nice pair of sunglasses and keep them in safe location when not in use.



[Shop products](#) | [Product alerts](#) | [Burn-in your headphones](#)

JLab Audio + Burn-in Tool

