



JLAB AUDIO
CRASHER 2.0
SPEAKER

We love that you are rocking JLab Audio!
We take pride in our products and fully stand behind them.



YOUR SATISFACTION IS GUARANTEED

You may exchange or return merchandise within 30 days of the purchase date.
Learn more at jlabaudio.com/guarantee



YOUR WARRANTY

You may register your product at jlabaudio.com/register. All warranty claims are subject to JLab Audio authorization and at our sole discretion. Retain your proof of purchase to ensure warranty coverage.



CONTACT US

Reach out to us at support@jlabaudio.com or visit jlabaudio.com/contact

ACCESSORIES

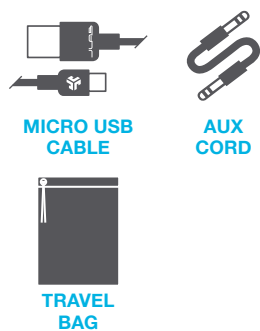

SPEAKER PORTS / BUTTONS

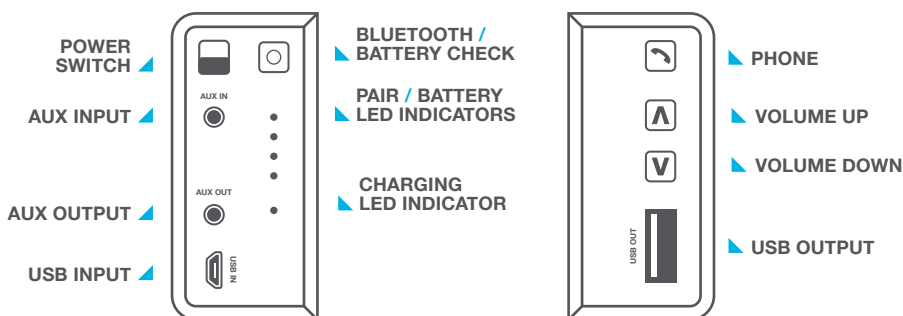

CHARGING

Note: For optimum performance, charge overnight with Micro USB cable prior to using.

- 1 Before charging, it is recommended you turn off the Crasher 2.0.
- 2 Connect the Crasher 2.0 to your computer or wall outlet using the Micro USB cable (provided) and/or 5V power adapter.
- 3 The indicator light on the front of the Crasher 2.0 will **turn red** indicating charging is in progress. When it **turns green**, charging is complete. Allow about 6 hours to fully charge.

Check Battery Life

The speaker is designed with a smart battery check feature for your convenience. Press the Battery Check button once to show the current battery capacity.

4 LEDs = app. 100% / **3 LEDs** = app. 75% / **2 LEDs** = app. 50% / **1 LED** = app. 25% (needs charging)

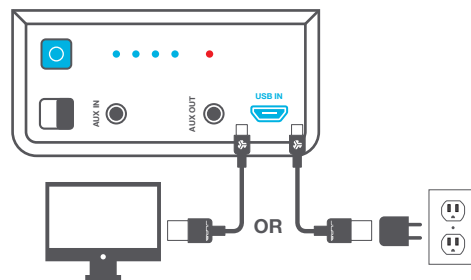

POWER + BLUETOOTH FUNCTION

- 1 Once the Crasher 2.0 is fully charged, slide the Power button down to power on. LED lights and sound should further indicate that the Crasher 2.0 is on.
- 2 Press the Bluetooth/Battery Check button and hold for about 5 seconds or until the 4 LEDs flash.
- 3 Use your mobile device to search for the Bluetooth signal. The Crasher 2.0 will appear on your Bluetooth device list. Enter PIN code "0000" if prompted.
- 4 When the Bluetooth connection is made, the first LED will flash slowly. Please allow 10-20 seconds for your device to connect. The unit will sync to play songs on your device when connected successfully.

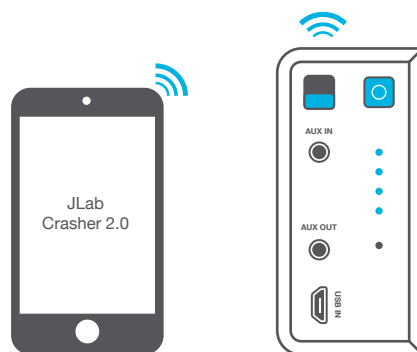

Notes:

- Bluetooth is a wireless radio technology, which means it is sensitive to objects between the speaker and the connected device. The speaker is designed to be used within 33 feet (10 meters) of a connected device, with no major objects in between (walls, etc.).
- Once successfully connected, the speaker will memorize your device and automatically pair when turned on in the future.
- Only one device may be connected at a time. To reset the Crasher 2.0 and void any existing connections, hold down the Bluetooth/Battery Check button for 12-15 seconds until the 4 LED lights begin to blink.
- The Bluetooth will enter a low power consumption status after 15 minutes without connection. At this time, the indicator light will flash blue every 5 seconds. To wake up the speaker, hold down the PLAY/PAUSE button for 3 seconds.
- If for any reason Bluetooth connection is lost, manually reconnect your Bluetooth device.

MAKE + RECEIVE TELEPHONE CALLS

Note: If a call is received while streaming music, the music will be muted and a ring tone will be heard.

- 1 Answer and end calls by pressing the talk button once.
- 2 Make calls by dialing on the cell phone and talking towards the speaker. Talk from 3-5 feet away.
- 3 To decline an incoming call, hold the talk button for 2-3 seconds or until the phone call stops ringing and returns to your music.
- 4 Check the instruction manual for your cell phone to ensure no further steps are required.

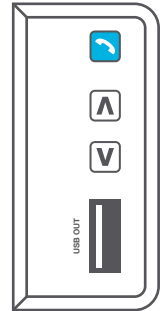

AUX IN FUNCTION

The Crasher 2.0 has an AUX IN port. You can use audio from devices such as a mobile phone, computer, MP3 player, etc. with a 3.5mm AUX cable.

Use a 3.5mm AUX cable (not included) to connect the audio output terminals of your chosen device to the audio input terminal (AUX IN) of the Crasher 2.0. The blue indicator light will flash slowly.

Note: The Crasher 2.0 will give priority to AUX playback whenever both the AUX input terminal and the Bluetooth are connected simultaneously. Once the 3.5mm device is disconnected, the Crasher 2.0 will return to the music on the Bluetooth connected device.

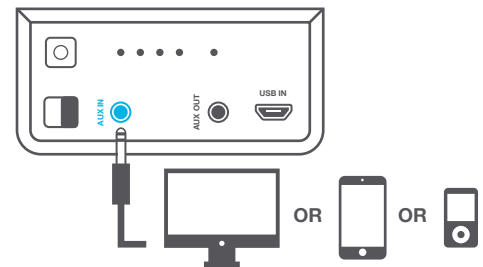

AUX OUT FUNCTION (ie. Daisy Chain)

The Crasher 2.0 also has an AUX OUT port. You can connect the Crasher 2.0 to an external speaker with a 3.5mm AUX cable to expand the audio playing.

Use a 3.5mm AUX cable (not included) to connect the audio input (AUX IN) terminals of your chosen device to the audio output terminal (AUX OUT) of the Crasher 2.0. The blue indicator light will **flash slowly**.

You may connect as many external speakers together in this manner so long as they all have an AUX OUT port.

Note: The Crasher 2.0 will give priority to AUX playback whenever both the AUX input terminal and the Bluetooth are connected simultaneously. Once the 3.5mm device is disconnected, the Crasher 2.0 will return to the music on the Bluetooth connected device.

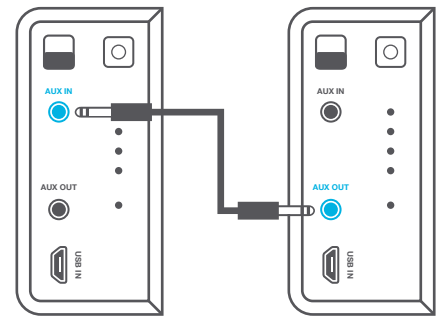

CHARGE YOUR PORTABLE DEVICES

The Crasher 2.0 delivers a portable battery pack that can charge your favorite music devices on-the-go including cell phones, tablets, MP3 Players and more.

Connect your portable device with its own charging cable (not included) to the USB port on the Crasher 2.0 speaker.

Note: The built-in power pack will supply a current of 1A. This will charge most cell phones and portable devices. Some tablets, including the iPad, require at least 2.1A of power to charge up quickly or if their battery is less than 30%. While the Crasher 2.0's power pack might not charge certain tablets as fast as it would a cell phone, it can still offer a power boost when your tablet's battery is over 30%.

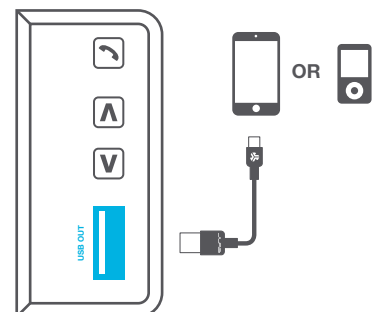

CAUTIONS

- Listen to music at a suitable volume for enjoyment in order to not cause damage to your hearing and/or speaker system.
- Store in a well ventilated area.
- To reduce the risk of fire or electric shock, do not expose this speaker or the accessories to rain, water drops or moisture.
- Keep the unit away from an open flame such as fire, candle, etc.
- Avoid extreme heat, cold and humidity.
- Only use attachments/accessories specified by the manufacturer.
- Do not drop any objects into the unit through the openings.
- Do not place anything heavy on the unit.
- To ensure proper ventilation and proper operation, never cover or block the slots and opening with a cloth or other materials.
- The maximum working temperature is 95°F/35°C.
- Lithium batteries (like all rechargeable batteries) are recyclable and should NOT be recycled or disposed of in normal household waste. Contact your local government for disposal or recycling practices in your area.