

**Gevi**

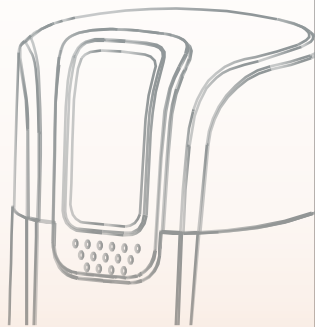

**COFFEE GRINDER**  
**GECG140-U**

Dear Gevi customer

Thanks for purchasing our Gevi products.

Gevi has focused on creating perfect home appliances for our customers. In the past few years, it took us time to do lots of research and many prototypes to achieve our goal. We would like to give you a different user experience.

If you want FAQs and more information, please feel free to contact us.

## IMPORTANT SAFEGUARDS

Before using the electrical appliance, the following basic precautions should always be followed including the following:

1. Read all instructions.
2. To protect against risk of electrical shock do not put the cord, plug and the motor base in water or other liquid.
3. This appliance is not intended for use by persons (including children) with reduced physical, sensory, or mental capabilities, or lack of experience and knowledge, unless they are closely supervised and instructed concerning use of the appliance by a person responsible for their safety.

Close supervision is necessary when any appliance is used by or near children.

Children should be supervised to ensure that they do not play with the appliance.

4. Turn the appliance OFF, then unplug from the outlet when not in use, before assembling or disassembling parts and before cleaning. To unplug, grasp the plug and pull from the outlet. Never pull from the power cord.
5. Avoid contacting moving parts.
6. Do not operate any appliance with a damaged cord or plug or after the appliance malfunctions, or is dropped or damaged in any manner. Contact the manufacturer at their customer service telephone number for information on examination, repair, or adjustment.
7. The use of attachments not recommended or sold by the manufacturer may cause fire, electric shock or injury.
8. Do not use outdoors.
9. Do not let cord hang over edge of table or counter.
10. Check hopper for presence of foreign objects before using.

11. Do not operate the appliance for other than its intended use.
12. This appliance can be used by children aged from 8 years and above if they have been given supervision or instruction concerning use of the appliance in a safe way and if they understand the hazards involved. Cleaning and user maintenance shall not be made by children unless they are older than 8 and supervised. Keep the appliance and its cord out of reach of children aged less than 8 years.

**△NOTE**

**SAVE THESE INSTRUCTIONS**

THIS PRODUCT IS FOR HOUSEHOLD USE ONLY .

*For more details especially for the operation, please  
refer to our electronic instruction manual by  
contacting Gevi support team.*

## KNOW YOUR COFFEE GRINDER

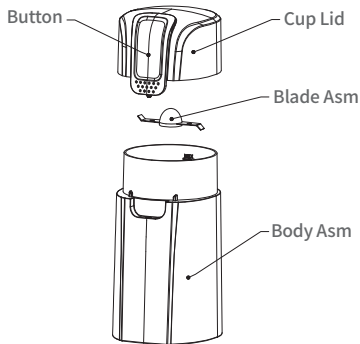

Electrical parameters: 120V~ 60Hz 150W

### BEFORE THE FIRST TIME

Carefully unpack your coffee grinder and remove all packing materials. To remove any dust that may have accumulated during packaging, wipe the grinding bowl, blades with

a damp lint-free cloth or sponge.

Use extreme care as the blades are sharp. The transparent cover can be immersed in water for cleaning, dry thoroughly.

**CAUTION:** Never immerse the motor base in water for cleaning and do not fill the grinding bowl with water for cleaning.

## CLEANING AND MAINTENANCE

1. **CAUTION:** Be sure to unplug this appliance before cleaning. To protect against electrical shock, do not immerse cord, plug or motor base in water or liquid. After each use, always make sure plug is first removed from wall outlet.
2. Wash cover with water and mild detergent. The cover is not dishwasher-safe. Rinse thoroughly and dry. Never immerse motor base or filling water into the grinding bowl.
3. Wipe the grinding bowl, blades with a

lint-free cloth. Extreme care should be exercised as the blade is sharp.

## NOTES ON THE CORD PLUG

This appliance has a polarized plug (one blade is wider than the other).

To reduce the risk of electric shock, this plug will fit in a polarized outlet only one way. If the plug does not fit fully into the outlet, reverse the plug. If it still does not fit, contact a qualified electrician.

Do not modify the plug in any way.

## USING YOUR COFFEE GRINDER

1. Place the coffee grinder on a flat surface.
2. Assemble the grinding bowl into the motor base, then turn the bowl clockwise until a click sound is heard. When disassembling,

turn the bowl anti-clockwise to detach it.

Pour coffee beans into the grinding bowl, it must be noted the quantity of coffee beans shall not exceed 60g.

Recover the transparent cover and plug into the power outlet.

Press and hold the power switch, the appliance will start operating, once release the power switch, the appliance will stop operating.

NOTE: Do not operate this appliance continuously for more than 30Second, allow appliance to cool down for 3 minute between two continuous cycles.

View the consistency of coffee grounds from the transparent cover.

IMPORTANT: If you want to remove the cover to check the consistency of the coffee grounds. It must be noted never remove the cover until blades come to a complete stop.

Once the desired grind has obtained, release power switch and unplug the power cord

from the outlet.

8. Remove the transparent cover, disassemble the grinding bowl and pour out the coffee ground directly.

## GRINDING TIPS

1. The COARSE grind is generally used for percolators and coffee urns. MEDIUM grind is used for drip coffee makers and steam-type espresso machines. A FINE grind is used for espresso machines with an electric pump.
2. Vary the grinding times to suit your taste and type of beans you grind.
3. For the freshest, most flavorful coffee, grind only enough for the pot you are making. Coffee beans keep up to 2 months in the freezer in an airtight container and can be ground while still frozen. Coffee grounds left in your grinder can become stale and affect the flavor of freshly ground coffee. Be sure to

clean grinding chamber , blades and cover after each use.

4. This grinder can only grind dry, brittle foods. It will not grind anything moist, extremely hard, or gummy such as whole ginger, chocolate, sesame seeds or oily spices such as cinnamon, cloves or nutmeg. Do not grind peanuts or grains such as wheat, rice, barley, or dried corn. Attempting to grind any of these foods may damage the unit. Never use it to chop ice cubes.
5. Freshly ground peppercorns have a strong aroma and taste that may affect the flavor of coffee beans ground afterward. You may want to purchase a separate grinder if you plan to grind peppercorns.