

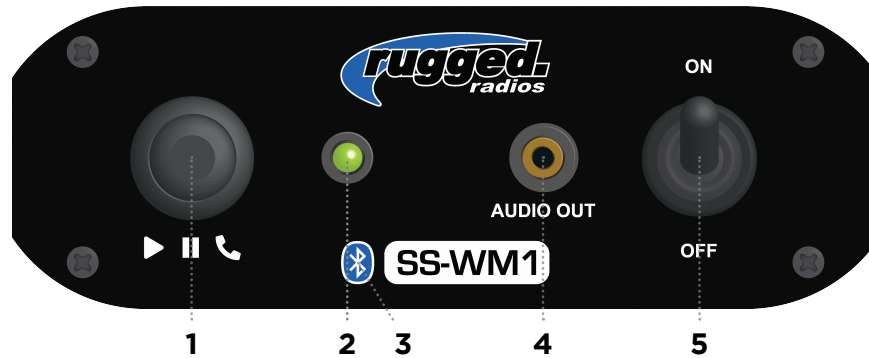

SS-WM1 USER MANUAL



1. **PLAY / PAUSE / PHONE** plays or pauses music; answers or ends phone calls.
2. **LED** green indicates power is on, red indicates transmitting.
3. **BLUETOOTH** pairing mode active when SS-WM1 is powered on.
4. **AUDIO OUT** for recording audio; e.g. a GoPro.
5. **ON / OFF** SS-WM1 power switch.

Bluetooth Pairing for Music and Cell

Start with the intercom powered off and the bluetooth function of your phone or device powered off.

1. Turn on the SS-WM1.
2. Turn on the phone or device's bluetooth.
3. Wait for "SS-WM1" to be displayed on the device.
4. Select "SS-WM1" and wait for the device to pair.
5. If pairing is not successful, restart the process.

Pro Tips:

- Audio volume is controlled by the paired device.
- Some devices may need to enter pairing mode; e.g. pair new device, pair +, etc.

2-Way Radio Use

Received audio is controlled by your radio's volume control, not the intercom volume control. The Push-To-Talk (PTT) Button is used for transmitting over a 2-way radio connected to your intercom. To transmit, press and hold the PTT button, speak, and release when finished.

Pro Tips:

- When transmitting, the LED on both the intercom and radio should illuminate red.
- Music (Bluetooth) volume will dim down when transmitting and receiving.

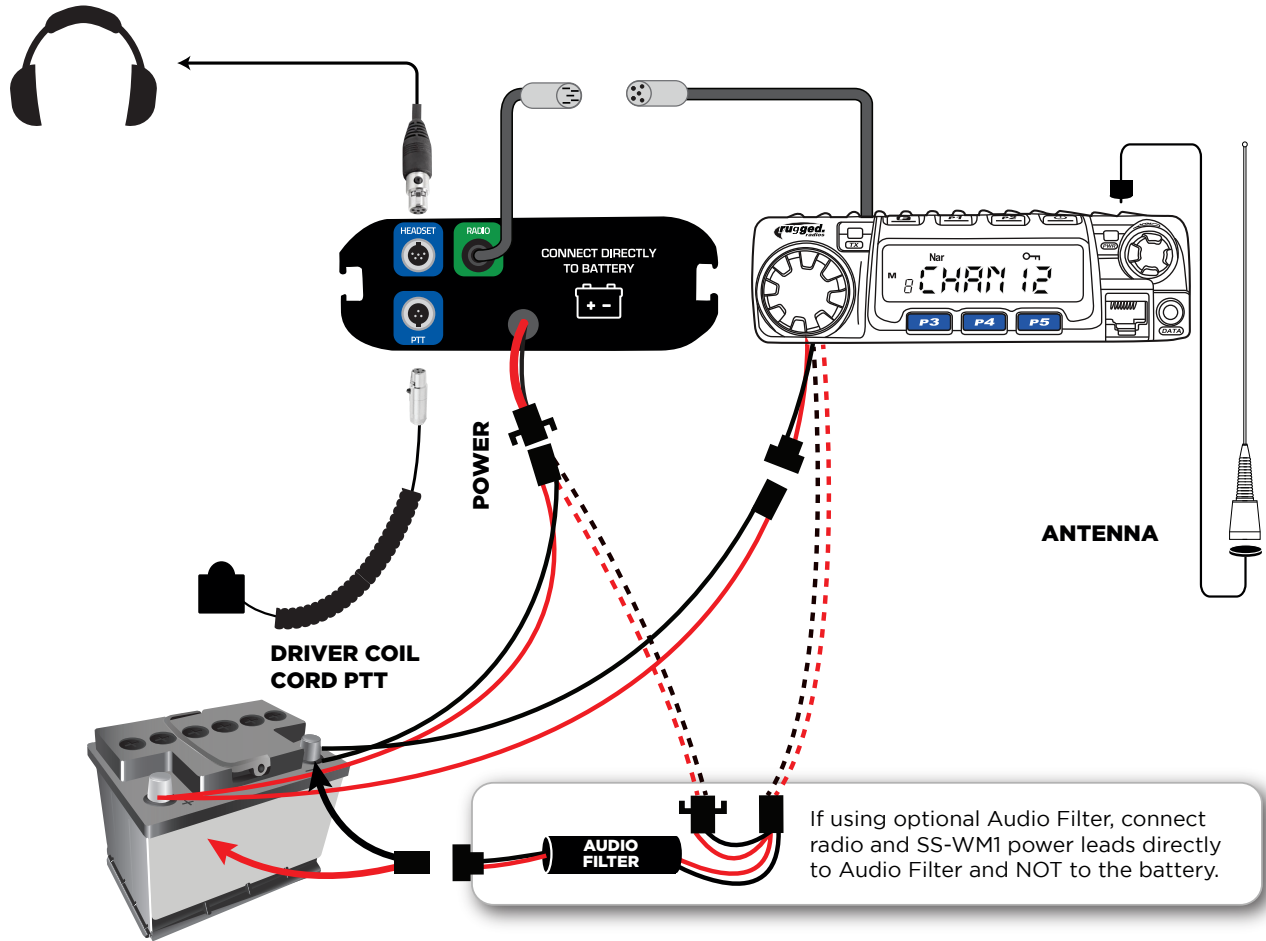

This is a universal wiring diagram. Your exact configuration might vary depending on the system purchased.



HEADSET connects driver headset to SS-WM1. Route away from power and antenna cables.



RADIO connects to optional radio.



PUSH-TO-TALK connects driver PTT to SS-WM1.



POWER connect +/- directly to 12v battery.

Radio & SS-WM1 Mounting

- Both the SS-WM1 and radio come with universal mounting brackets. Vehicle specific mounting options are sold separately.
- DO NOT mount the radio or SS-WM1 near an ignition box to avoid RF interference.
- Route antenna cable away from power leads.

Connect Power

- Route all power cables directly to the battery.
- DO NOT connect inline with other components. If power is tied to ignition, lights or other power sources, a ground loop problem may occur, causing noise in the system.
- DO NOT remove any fuses that are in line with factory cables or otherwise modify power cables.