

MidnightRallyClub.com

@MidnightRallyClub

MRC Midnight™
Rally
Club

STAGE ONE

Forced Air Off Road Helmet

Owner's Manual

CHOOSING THE CORRECT SIZE HELMET

WARNING - *FOR ADEQUATE PROTECTION, THIS HELMET MUST FIT SNUGLY AND BE SECURELY ATTACHED*

While it is not possible for any helmet to protect the user against all foreseeable impacts and accidents, proper use of this helmet will provide a far greater level of protection, in the event of an accident, than if no helmet were worn. For a helmet to function properly, to help reduce the risk of injury or death and for maximum protection the helmet must fit firmly on the head, and the retention system must be securely fastened. With the retention system comfortably but firmly adjusted, it should not be possible for the helmet to be removed from the head when pulled at the rear in an upward and forward direction.

Helmet fit is critical to helmet protective performance. Different helmets fit differently due to differences in design and construction. The correct helmet size can only be checked and confirmed by physically fitting the helmet to the user. Always try the helmet on in a store, before purchasing it, to be sure you are purchasing the correct sized helmet for you. If you are unable to find a size of this helmet style that fits you properly, please try another certified helmet style.

To determine which helmet size to choose, first measure your head size by passing a tape measure around your head approximately 2 cm above the eyebrow line. Use the largest measurement from this process. Select the helmet size that closest matches this measurement.

Stage One

Forced Air Intake Helmet

Since helmet sizes do not always match perfectly with this basic measurement, use the helmet size closest to your head measure that fits snugly, but without pressure points.

SIZING

ADULT	XS	S	M	L	XL	XXL
INCH	20 7/8 - 21 1/4	21 5/8 - 22	22 1/2 - 22 7/8	23 1/4 - 23 5/8	24 - 24 3/8	24 3/4 - 25 1/4
CM	53 - 54	55 - 56	57 - 58	59 - 60	61 - 62	63 - 64
HAT	6 5/8 - 6 3/4	6 7/8 - 7	7 1/8 - 7 1/4	7 3/8 - 7 1/2	7 5/8 - 7 3/4	7 7/8 - 8

CHECKING THE FIT OF THE HELMET

Grasp the chinstraps as seen in **[SEE DIAGRAM 5, pg7]** and expand the helmet opening. Slide your head into the helmet. If the helmet does not fit snugly or if the helmet feels loose in any way, you should try a smaller size. **IT IS IMPERATIVE THAT THE FIT OF THE HELMET BE SNUG FOR IT TO PERFORM PROPERLY.** To check for proper fitting, place the helmet on your head. Make sure the helmet lining fits snugly around your head and the cheek pads are pressed close on your cheeks. There should be no space between your brow and the lining. Grasp the helmet on each side with your hands and try to move the helmet up and down as well as side to side **[SEE DIAGRAM 2, pg5]**. You should feel the skin on your face and head being pulled by the lining. If the helmet is able to move freely without rubbing your skin, the helmet is too large and you need a

smaller size. Repeat this procedure grasping the helmet at the front and back while trying to roll the helmet forwards and backwards.

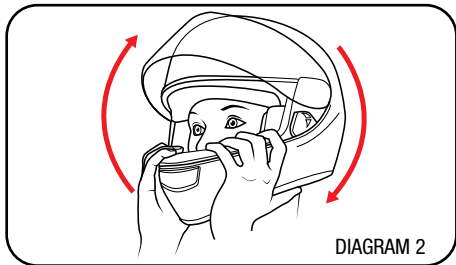
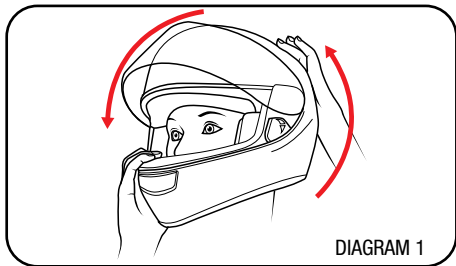

Test the chinstrap retention system. Securely fasten the chinstrap, according to the instructions in the section of this information notice titled “USE AND ADJUSTMENT OF THE RATCHET RETENTION SYSTEM”, such that it is as tight as possible without choking. There should be no slack and the strap should fit snugly under the chin. Place your hand on top of the helmet and on the chin bar **[SEE DIAGRAM 1]** and attempt to push the helmet off by rolling it forward. Next, place your hands on the chin bar **[SEE DIAGRAM 2]** and attempt to push the helmet off by rotating it towards the rear. If in either case, the helmet is able to come off your head, do not use this helmet.

Check the position of the helmet on your head with the retention system fastened. The helmet must not sit too low or high on the head, so as to interfere with your line of sight **[SEE DIAGRAM 3, pg6]**. Eyes should be central to the eye aperture.

Stage One

Forced Air Intake Helmet

EN

06

Please note that the visor is adjustable. Try the helmet with the visor in all positions, prior to purchase, to make sure that the helmet meets your requirements and that the visor does not interfere with your vision when in the open position.

These steps should be repeated until you are able to find the right size helmet for you.

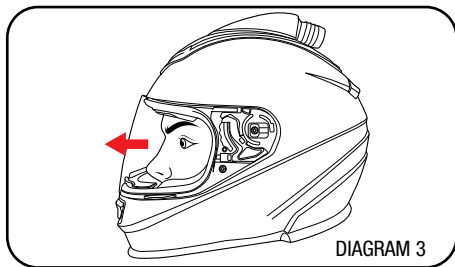

Close the face shield and insure that vision is not impaired

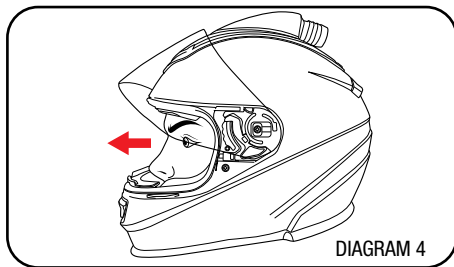

Completely open the face shield and ensure that vision is not impaired

RATCHET RETENTION SYSTEM

WARNING - *PROPER FASTENING AND TIGHTENING OF THE CHINSTRAP IS CRITICAL TO THE FUNCTIONALITY OF THIS HELMET. FAILURE TO PROPERLY FASTEN AND TIGHTEN THE CHINSTRAP WHEN USING THE HELMET MAY RESULT IN FATAL INJURY OR DEATH.*

With the helmet on your head, place the grooved end of the strap through the receiver as shown in diagram 5. Use the receiver end to ratchet the strap until snug. To undo the strap, pull on the red tab of the receiver to release the grooved end from its locked position as seen in **[SEE DIAGRAM 5]**. Simple pulling the two ends away from each other will undo the strap.

When riding, always wear the helmet with the chin strap securely fastened and snug under your chin and against your throat or the helmet may be more likely to eject in an accident. If the helmet does not stay on, serious injury or death may result. Check to make sure the chin strap is tight periodically while you ride. If the chin strap has become loose, stop safely and immediately to re-

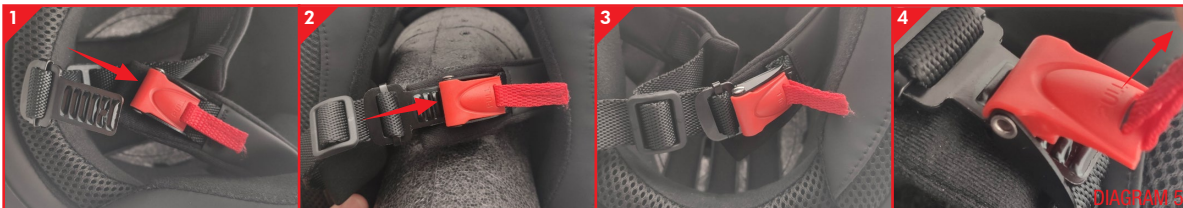

Stage One

Forced Air Intake Helmet

EN **08**

tighten the chin strap. Do not use a chin cup or wear the strap on the point of the chin. If the chin strap is not in the proper position or used properly, the helmet may be less likely to stay in position and serious personal injury or death may result.

RATCHET RETENTION SYSTEM

To install neck curtain, align the front of the neck curtain, with the zipper opening, with the front of the helmet **[SEE DIGRAM 6]** Attach the neck curtain to the helmet with the hook and loop around the base of the helmet. At the back o the helmet close the neck curtain by securing the hook and loop tab **[SEE DIGRAM 6]**.

To remove the neck curtain, reverse the installation directions. Unzip front closure of neck curtain before putting on helmet. Once helmet is on, zip up the front to close the neck curtain.



DO NOT MODIFY YOUR HELMET

It is extremely dangerous to modify or alter your helmet. No attachments should be made to the helmet except those recommended by the helmet manufacturer. Do not drill or cut the shell or modify it or the liner in any way. Do not apply paint, stickers or transfers, petrol or gasoline, adhesives, cleaning agents or other solvents to this helmet. Any such actions will weaken the helmet and may cause serious injury in the event of an accident. Removing any parts such as vents, liners, cheek pads, mouth guards, rubber trimming, etc. before use will also disrupt the intended design of the helmet and may increase your risk of severe injury or death in the event of an accident.

WARNING - *THE LINER IS ESSENTIAL TO THE INTENDED PERFORMANCE OF THE HELMET IT MUST BE PROPERLY INSTALLED WHEN USING THE HELMET.*

WARNING - *THE PROTECTION OF THIS HELMET MAY BE SEVERELY REDUCED BY THE APPLICATION OF PAINT, ADHESIVE STICKERS OR TRANSFERS, CLEANING FLUIDS OR OTHER SOLVENTS. USE ONLY MATERIALS RECOMMENDED BY THE HELMET MANUFACTURER*

Stage One

Forced Air Intake Helmet

EN

10

BEFORE EVERY USE

Make sure your helmet is in proper working condition before every use. Always check your helmet for loose components, screws, rivets, worn chinstrap, cracks and another wear or damage to the helmet or its components that might prevent you from fastening and wearing the helmet. prior to every use. Be sure that the liner and cheek pads are properly in place and that the chinstrap system is secured.

CLEANING AND CARE OF YOUR HELMET

Do not use any solvents, contact cleaner, gasoline, glass cleaners, or hot water, to clean your helmet they can cause severe damage to the helmet and weaken its structural integrity. Do not spray disinfectants into your helmet as they may contain propellants and other chemicals that can damage your helmet. Any such damage to the helmet can prevent the helmet from performing properly in the event of an accident, which could result in serious injury or death. To clean your helmet, use lukewarm water, and a clean damp soft cloth. Rinse off with clean water and dry using clean soft cloth.

STORAGE

Protect your helmet if it is stored for a period of time. Store your helmet inside a helmet bag in a secure, dry place out of direct exposure to sunlight and extremely high or low temperatures.

FACE SHIELD INSTRUCTIONS

This helmet is unsuitable for use with goggles.

SAFETY WARNING: Visors marked with the statement "IF TINTED.FOR DAYTIME USE ONLY" or the EU Sun pictogram marking are not suitable for use during the hours of twilight, darkness or in conditions of poor visibility or inclement weather. Be sure to choose a shield that is appropriate for the conditions it will be used it. Colored visors that prevent the recognition of road signals are not suitable for on-road use. Make sure the face shield is always in perfect condition and that no damage or wear obscures the riders view through the visor.

INSTALLING FACE SHIELD



Align the sides of the face shield with the ratchet system on each side of the helmet



Place matching curves of shield into the slots on side of the helmet



Use the tab to open the slot, press the shield into the helmet and release the tab

Stage One

Forced Air Intake Helmet

EN

12

REMOVING FACE SHIELD



Open the face shield



use the tab to release the shield from the helmet



Pull the side of the shield out to release it from its ratchet base

BEFORE EVERY USE

Inspect your face shield. Check that the mechanisms of the face shield are working properly and that the face shield will provide sufficiently clear visibility. Any dirt, bugs, residues, or anything that would affect the visibility of the face shield should be removed before riding. A dirty face shield will seriously impair visibility. For your own safety, clean it immediately. Check the face shield for physical damage, cracks and scratches. A scratched or cracked or otherwise damaged face shield will considerably impair your vision and must be replaced.

CARE AND STORAGE INSTRUCTIONS

The surface of the face shield must be cleaned carefully to prevent scratching. Lay a clean, warm, wet, soft cloth on the exterior of the face shield helmet for at least 5 minutes to help soften dried on bugs. (Do not skip this step!). Then clean gently with clean, soft, cloth using mild soap and warm water. Rinse using a clean, soft cloth and clean water to remove any soap residue. Then dry gently using a clean, soft cloth. Never use any solvent, window or glass cleaner or other cleaning agents on the face shield. Never attach labels, adhesive tape or stickers to the face shield.

VENT OPERATION



Stage One

Forced Air Intake Helmet

EN

14

HEARING

Wearing any helmet reduces the wearer's ability to hear. A wearer needs to be aware of this audible reduction and their surroundings. Not being aware this audible reduction may lead to an accident that could result in injury or death.

INNER LINER & CHEEK PADS



PAD LINER CARE INSTRUCTIONS

Our helmets come with a removable liner and or cheek pads to make cleaning and upkeep of your helmet interior easy. Remove the liner and cheek pads according to the preceding instructions and gently **HAND WASH** with baby shampoo in cold water. Let air-dry. **DO NOT WASH IN MACHINE OR TUMBLE DRY.** **HAND WASH AND AIR-DRY ONLY.**



OBSOLESCENCE AND HELMET DISPOSAL

A helmet has a limited lifespan in use and should be replaced when it shows obvious signs of wear, e.g. change of fit, cracks, rust or fraying or other signs of normal “wear and tear” that can contribute to helmet degradation.

HELMET REPLACEMENT RECOMMENDATION

A helmet has a limited lifespan in use and should be replaced when it shows obvious signs of wear, e.g. change of fit, cracks, rust or fraying or other signs of normal “wear and tear” that can contribute to helmet degradation.

SAFETY WARNING: If you buy a new helmet, destroy the old one to ensure it cannot be reused. Do not sell or give away your old helmet, even if it has not been damaged. Over time, the protective layer in the helmet will adjust to the contours of your head. If someone else uses this helmet it will not provide them with as much protection.

THE
RALLY
NEVER
STOPS

mrc Midnight™
Rally
Club