

Pedestal Multi-Purpose Table



© Copyright 2017
Living Earth Crafts®

All rights reserved. This document or any portion thereof may not be reproduced in any way, including photocopying or translation to another language without the prior written permission from Living Earth Crafts.

Living Earth Crafts® is a registered trademark of Earthlite, LLC.

Legal Notice

The information provided in this document is intended for informational purposes only and is subject to change without notice. The information provided in this document should not be construed as a commitment by Living Earth Crafts®.

Living Earth Crafts® assumes no responsibility for the accuracy or suitability of the information contained in this document. This document may contain technical inaccuracies or errors. Living Earth Crafts® makes no expressed or implied warranties of any kind concerning the information contained in this document, including, but not limited to, the implied warranties of merchantability and fitness for purpose.

Living Earth Crafts® shall not be liable for incidental or consequential damages in connection with or arising out of the product, performance, or use of this document and the information and material it describes.

Introduction

Congratulations on your purchase of the simply elegant Pedestal multi-purpose table. The Pedestal is the choice of five-star resorts and spas worldwide because it offers a striking presence with incredible comfort. With a smooth and subtle electric lift actuator, hardwood Maple trim, and luxurious cushioning system, the Pedestal table provides truly discerning clientele with the ultimate spa experience.

Pedestal tables are designed for licensed therapists and are intended to be used in a professional spa, massage studio, or similar commercial environment. While no special training is needed to operate the table, for safety reasons it is important that the instructions contained in this manual are reviewed in detail before the first use. This manual should be read in its entirety by each professional who will be operating the table to ensure the safety of both operator and client. This manual should be saved for future reference.

The Pedestal table should not be used in any other manner than described in this manual. Please read, understand, and follow all safety warnings, labels, and instructions. Misuse, use of unnecessary force, or using the product for unintended or unauthorized procedures can result in injury to operator, client, and/or equipment.

Detailed instructions for use and maintenance can be found in this user manual. If you have further questions, please contact us at (800) 872-0560 for US customers, or (760) 597-2155 for international customers. We can also be reached via e-mail at info@livingearthcrafts.com

Table of Contents

Section 1: Safety Information	
Safety Symbols	2
Warnings	2-3
Section 2: Product Overview	
Product Photos	4
Product Specifications	4
Section 3: Installation	
Moving Your Table	5
Basic Setup	5
Leveling Instructions	5
Section 4: Operating Instructions	
Hand/Foot Control	6
Weight/Lift Capacities	7
Electrical Specifications	7
Section 5: Care & Maintenance	
Care Instructions	8
Troubleshooting	8
Warranty Information	9
Contact Us	back cover

SAFETY INFORMATION

Safety Symbols

Familiarize yourself with the following Safety & Warning symbols. They are designed to prevent damage and injury to you, your clients, and your new Earthlite product.

IMPORTANT: The important safety instructions and warnings in this manual cannot cover all possible problems and conditions that can occur. Use common sense and caution when installing, operating, or maintaining this appliance.



Indicates an imminently hazardous situation which could result in serious or fatal injury.



Indicates a potentially hazardous situation which could result in serious injury.



Indicates a potentially hazardous situation which could result in equipment damage and/or injury.

IMPORTANT SAFETY INSTRUCTIONS - FOR COMMERCIAL USE ONLY

Read all instructions before using this product.



RISK OF ELECTRIC SHOCK, FIRE, AND EXPLOSION

- 1) Always unplug this furnishing from the electrical outlet before servicing.
- 2) Never use this furnishing if it has a damaged cord or plug, if it is not working properly, if it has been dropped or damaged, or dropped into water. Return the furnishing to a service center for examination and repair.
- 3) Keep the cord away from heated surfaces.
- 4) Do not use outdoors.
- 5) Do not operate where aerosol (spray) projects are being used or where oxygen is being administered.
- 6) To disconnect, turn all controls to the off position, then remove plug from outlet.
- 7) Connect this furnishing to a properly grounded outlet only. See Grounding Instructions.

GROUNDING INSTRUCTIONS:

POWER SUPPLY: (120V AC grounded) Electrical limitations: Do not use extension cord with this product, plug directly into grounded outlet. **This product must be grounded.** If it should malfunction or breakdown, grounding provides a path of least resistance for electric current to reduce the risk of electric shock. This product is equipped with a cord having an equipment-grounding conductor and a grounding plug. This three prong grounded plug will only fit into wall outlet one way. If the plug does not fit fully in the outlet, contact a qualified electrician to install the proper outlet. Do not change the plug in any way.

NORTH AMERICA ONLY

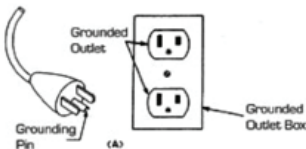

INTERNATIONAL VERSIONS ONLY

This product is for use on a nominal 220V-240V circuit and has a grounding plug (plug type varies by country). Make sure that the product is connected to an outlet having the same configuration as the plug. No adapter should be used with this product.

WARNING

To reduce the risk of burns, fire, electric shock, or injury to persons:

- 1) Use this furnishing only for its intended use as described in these instructions. Do not use attachments not recommended by the manufacturer.
- 2) Do not operate this equipment unless properly trained.
- 3) Install this furnishing in treatment area not accessible to the public.
- 4) Close supervision is necessary when this furnishing is used by, or near children, invalids, or disabled persons.
- 5) This product does not have “pinch point” protection. Only operate when no possibility of any portion of the body could be caught and injured while moving the table top upward/downward, or activating the back/foot tilt.
- 6) Do not use this furnishing to support video equipment such as televisions or computer monitors.
- 7) Never attempt to use the Head or Leg lift section to support concentrated weight such as sitting or standing

CAUTION

- 1) When lowering any section of the table, make sure that no supplies or any part of yours or your client's body is between the top of your table and its base. This could result in injury, or could damage your table as well as the item. It is recommended that you always return your table top to the lowest flat position to avoid leaving the base exposed.
- 2) When lowering the table height, be sure there are no foreign obstacles underneath your table that could obstruct it from lowering completely. This could damage your table.
- 3) Never set anything under the table frame to avoid collision if lowered.
- 4) Never operate your table on an uneven surface. Adjust the leveling feet so that your table is stable.
- 5) Never raise the head or leg section with a client in the prone position (face down.)
- 6) Never use or store your table in a wet or very humid environment. Water and excessive moisture can damage the wood cabinet and electrical components. Evidence of exposure to water or moisture will void your warranty.
- 7) If you have purchased the Flexible Armrest Option, never use the Armrests as handholds or body support mechanisms, especially when setting clients on or off the table.
- 8) Never drop or insert any object into any opening.

SECTION 2: PRODUCT OVERVIEW



Basic Specifications	
Width Options	28", 30", 32" (71 cm, 76 cm, 81 cm)
Length	73" (185 cm)
Height Range	25" - 37" (64 cm - 94 cm)
Cushioning	3.5" Deluxe Spa Cushioning
Upholstery	Natursoft™ (16 colors)
Controls	Heavy duty foot control
Trim	Hardwood Maple
Lift Capacity	600 lbs (295 kg)

**table shown with optional accessories and/or finishes. Measurements may vary due to natural material variations.*

SECTION 3: INSTALLATION

Your Pedestal table comes completely assembled and ready to use.

Once the table is unpacked, follow the “Moving Your Table” instructions below.

Moving Your Table



Your Pedestal table is very heavy - extreme caution should be used to avoid injury to yourself, others around you, and your table. DO NOT lift or move without using proper safety procedures/equipment. DO NOT turn the table on its side for any reason.

Lift your table by grasping firmly from the bottom of the metal frame underneath the upholstered top. Do not try to lift from the upholstered top.

Basic Setup Instructions

Once your Pedestal table is positioned for use, follow these steps:

- Plug the power cord into a grounded outlet that is properly rated for the table.
- Arrange and secure the power cord so it will not create a tripping hazard.
- Place the hand and foot controls in locations where they are safe and accessible.
- Ensure the controls are not in danger of being crushed by the lift or tilt mechanisms.
- Follow the “Leveling Your Table” instructions on the next page.

Leveling Your Table

Leveling, or balancing, your table is very important during initial setup and routine maintenance. Your Pedestal table is equipped with leveling feet that can adjust to uneven floors.

To adjust the leveler feet:

1. Place the table in the position you plan to use it.
2. To determine which foot needs adjusting, attempt to “rock” your table. If there is any movement, the leg that is lifting is the one that will need adjusting.
3. Raise table height approximately 6 inches.
4. Using your hand, or a wrench if necessary, turn the leveling foot in the needed direction. (Counterclockwise will lower the overall height, clockwise will raise the overall height)

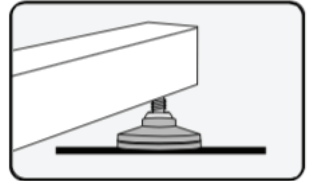
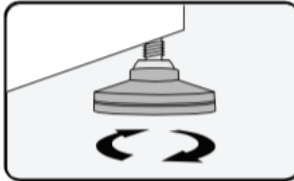
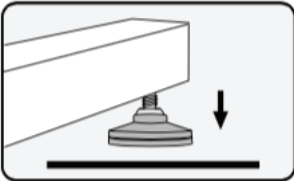
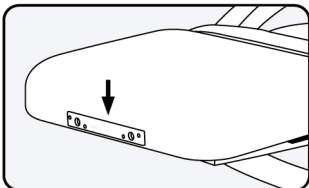

Table Accessories

All Pedestal tables come with outlets at both ends, specifically designed for providing a fixed location for FacePillow platforms, salon pillows, and other accessories.



See the Living Earth Crafts website for all available accessories that will fit into the table outlets.

SECTION 4: OPERATING INSTRUCTIONS

Pneumatic Tilt Adjustment

The hydro-pneumatic gas assisted tilt top has infinite angle settings from flat to 70 degrees.

To adjust, stand at the head end of the table and reach under the right side of the head section to locate the One-Touch lever. With your forefinger, compress the lever to release the hold and allow you to reposition the angle of the table top. Using your left hand, assist the table top until the desired angle is reached, and release the lever to lock into place.

Note: This can be done with a client on the table, however, use caution to ensure that the client's weight is supported with your supporting hand that is guiding the table top.

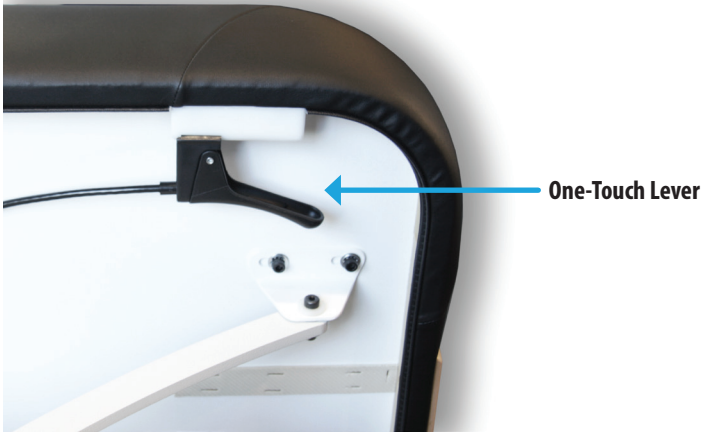

Foot Control Operation

Your Pedestal foot control is already connected and ready for use. The foot control allows you to simply raise and lower the table, allowing convenient hands-free adjustments.



SECTION 4: OPERATING INSTRUCTIONS

Weight & Lift Capacities

600 lbs.

The Pedestal is powered by a heavy-duty Quietech hydraulic lift actuators. The recommended lift capacity for the Pedestal table is 600 lbs.

100 lbs.

The back section and leg section has a maximum weight capacity of 100 lbs. These sections are not meant to hold full body weight.

Important Safety Notes

WARNING

Always use extreme caution when making any position adjustments to your table. Ensure all body parts and objects are clear from all moving parts. The described adjustments can be done with a client on the table, but use caution to ensure that the client's weight is supported while positioning the table section(s).

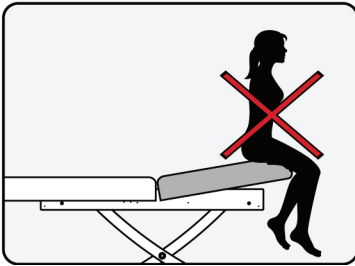

Do not sit or put unnecessary amounts of pressure on the back section of the table when it is in tilt position of any level. This can damage or destroy the tilt mechanism and cause harm or bodily injury to persons. The tilt mechanism is intended solely to be used when a client is properly seated or laying on the table top. Damage caused in this manner may void the warranty.

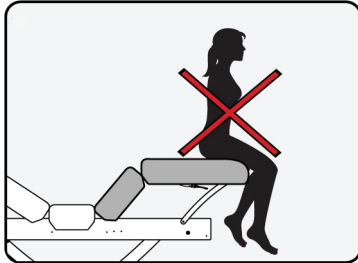

Do not sit or put unnecessary amounts of pressure on the leg section of the table when it is in tilt position of any level. This can damage or destroy the tilt mechanism and cause harm or bodily injury to persons. The tilt mechanism is intended solely to be used when a client is properly seated or laying on the table top. Damage caused in this manner may void the warranty.

CAUTION

DO NOT store or place anything under the backrest - this can damage the top and/or tilting mechanism. This area is not designed for storage or as an area to hold accessories and/or massage supplies while performing any type of service. Placing anything in this area can cause damage to the table and/or object and will void your warranty.

Electrical Specifications

Spec	North America	Europe/Asia
Input Voltage	120 VAC	220 VAC
Input Frequency	60 Hz	50 Hz
Consumption	2.7 Amps, 324 Watts	1.5 Amps, 345 Watts
Output	12-24 VDC	12-24 VDC
Duty Cycle	10%, 2 min/18 min	10%, 2 min/18 min

SECTION 5: CARE & MAINTENANCE

Cleaning & Ongoing Maintenance



RISK OF ELECTRIC SHOCK

Always unplug this furnishing from the electrical outlet before cleaning.



DO NOT USE acetone, "Armor All" type cleaners, citrus-based cleaners, or industrial cleaners. These can seriously damage the upholstery. Such damage would not be covered under warranty.

With proper maintenance, your Pedestal is designed to give you years of trouble-free operation. To ensure your table will continue to function properly and keep its appearance, we recommend the following.

Category	Care Recommendation
Upholstery	After each treatment on your table, clean thoroughly, removing all residue. This and other residues may cause upholstery to dry out and become brittle. We recommend a mild detergent and warm water mix, or environmentally friendly disinfectant cleaners, such as Viraguard®. Apply with cloth or spray directly onto the upholstery. Ensure surface is wiped clean of residue. Use caution when attempting to remove stains as you could damage your upholstery. Any stains should be treated immediately with a solution of 1 part alcohol to 10 parts water. Restore the luster to the spot with a light application of spray furniture wax.
Wood	To maintain the wood finish and retouch scratches, use a high quality furniture wax.
Electronics	Anti-static electronic aerosol dusters can be used to keep the surfaces of electronic components, power cables, and plugs free of dust.
Lubrication & Mechanical	The actuator or mechanical lift is maintenance free. Do not lubricate. Be careful to avoid application of sticky substances to the mechanism.
Leveling Feet	Regularly check to ensure the table is level and stable. See page 7 for leveling instructions.

SECTION 5: CARE & MAINTENANCE

Troubleshooting

This helpful troubleshooting guide will provide you with information about how to recognize a problem with your table, determine possible causes, and find a solution.

In the event your specific situation is not covered in this guide, please contact Living Earth Crafts so our technical support department can assist you. Beyond the troubleshooting guide below, do not attempt to repair the table yourself. This can void your warranty.

Unauthorized service will not be covered. Please be sure to contact Living Earth Crafts Customer Service first at (800) 358-8292, (760) 597-2155 Int'l.

Issue	Solution
Table does not raise or lower	<ol style="list-style-type: none">1. Ensure the table is plugged in.2. If using a dimmer switch, ensure it is turned to full power.3. Ensure the outlet in your room is receiving power. This can be done by plugging in a small appliance and turning it on.4. Ensure the switch on the attached power strip is turn on.5. Check the fuse or circuit breaker for blown fuse or tripped breaker.6. Ensure the controls are securely plugged into the junction box.
One-Touch Lever is difficult to move	Check the cable for any kinks or sharp bends from the lever to the gas springs. The cable should have a soft radius in order to allow the inner cable to travel freely in the cable sheath. If the cable is kinked, contact Living Earth Crafts.

Warranty Information

Living Earth Crafts (LEC) offers an industry best warranty against defects in materials, design, and workmanship, to the original owner, as follows:

- Frame - limited lifetime warranty*
- Foam and upholstery covering - warranted for three (3) years
- Motors, controls, electronics - warranted for two (2) years, including parts and labor
- Accessories and options - warranted for one (1) year, unless otherwise noted

LEC may repair or replace defective components at our discretion. LEC will return the warranted product, standard shipping pre-paid, to customers in the continental US. International customers are responsible for any applicable duties and taxes, as well as all shipping charges inbound and outbound. Normal wear and tear, and costs associated with maintenance procedures, and damage caused by accident, misuse, improper maintenance, harsh operating environments or neglect (which includes tears in the upholstery and damage caused by harsh chemical-based cleaners) are not covered under this warranty. All warranties are limited to repair or replacement, at LEC's discretion, unless otherwise stated.

*Lifetime warranty applies to the original owner, as long as you own your table for 5 years after the model is discontinued, or 5 years for private label tables.



Contact Us

Living Earth Crafts
990 Joshua Way
Vista, CA. 92081
(800) 358-8292
(760) 597-2155 Int'l
(866) 449-8872 fax
info@livingearthcrafts.com

Hours of operation:
Monday - Friday
8:00 a.m. to 5 p.m. PST
Saturday - Sunday
Closed

Visit us online at: livingearthcrafts.com

Read our blog at: livingearthcrafts.com/blog

Join us on Facebook®

