

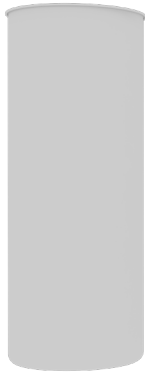

ENGINEERING BETTER BEER

Ss Hop Spider | Product Guide

IN THE BOX



(1) Hop Spider Basket

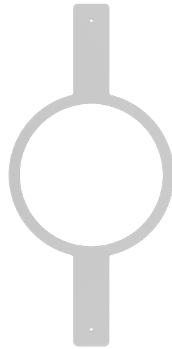

(1) Upper Support

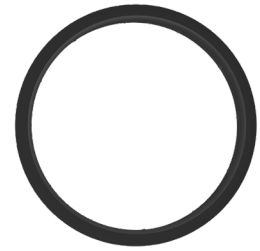

(1) Lifting Ring



(2) Adjustment Arms



(2) M5 Truss Head Screws

Stainless Steel Prep

Pre-Clean: Prior to first time use, thoroughly wash all surfaces of the Ss Hop Spider with Tri-Sodium Phosphate (TSP) in hot water, mixed to the manufacturer's recommendations. Scrub with a soft terry cloth, and after the initial TSP wash, rinse thoroughly and dry all surfaces. Check out our TSP Cleaning FAQ knowledge base article for more info!

Passivation: It is good practice to periodically passivate all stainless steel equipment with an acid-based solution to establish a uniform passive oxide layer that will maximize corrosion resistance. Following the preclean step, fill any vessel (such as a Ss Brew Kettle) with hot water (at 140-180°F) mixed with Citric Acid (at a concentration of 4% by weight) and then fully submerge the Hop Spider for at least 30 minutes (up to 2 hours.) Drain, dry, and then rinse with purified water. Most tap water contains various salts and chlorides (either naturally or for taste) which can undermine the passive oxide layer you just worked to create. Check out our Passivation FAQ knowledge base article for more info!

ASSEMBLY

1. Begin by completely removing all components from the box. Next, locate the **Upper Support**, **Adjustment Arms**, and **M5 Truss Head Screws**. Starting on one side, slide an Adjustment Arm onto the Upper Support and then use an 5mm hex driver to screw the M5 Truss Head Screw into the Upper Support. Do not fully tighten yet. Repeat this step for the other side.

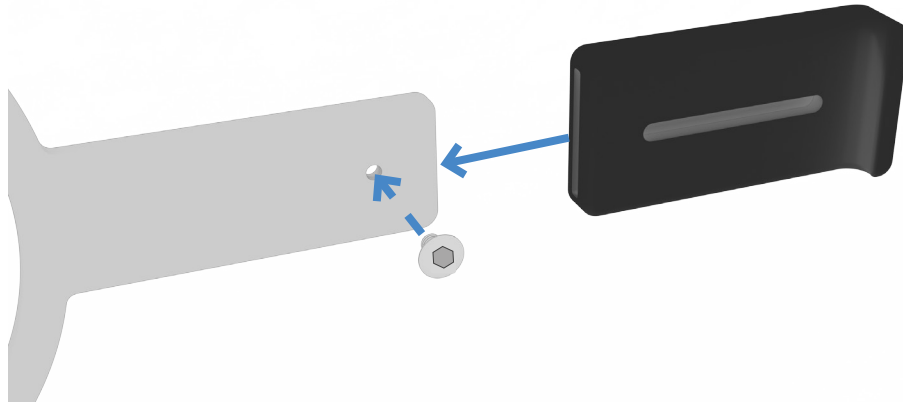

Note: Before fully tightening the screws, test fit the assembly on your kettle to ensure it is set to the correct size.

Note: Do not over-tighten the screws as this can cause the Adjustment Arm to deform. Once the screw head makes contact with the Adjustment Arm, an additional 1/4 to 1/2 turn should be enough to hold the Arm in place.

2. Next, locate the **Hop Spider Basket** and the **Lifting Ring**. Place the Hop Spider Basket upside down and then carefully slide the Lifting Ring down the body of the Hop Spider Basket until it rests against the rim of the Hop Spider Basket. Note the orientation of the lifting ring when installing. The rim around the top of the Hop Spider Basket should rest in the groove of the Lifting Ring when fully installed

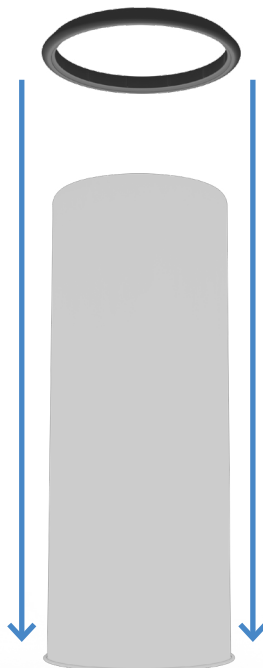

INSTRUCTIONS

ASSEMBLY (CONTINUED)

3. To assemble the Ss Hop Spider for use, place the Hop Spider Basket through the circular opening in the Upper Support Assembly.

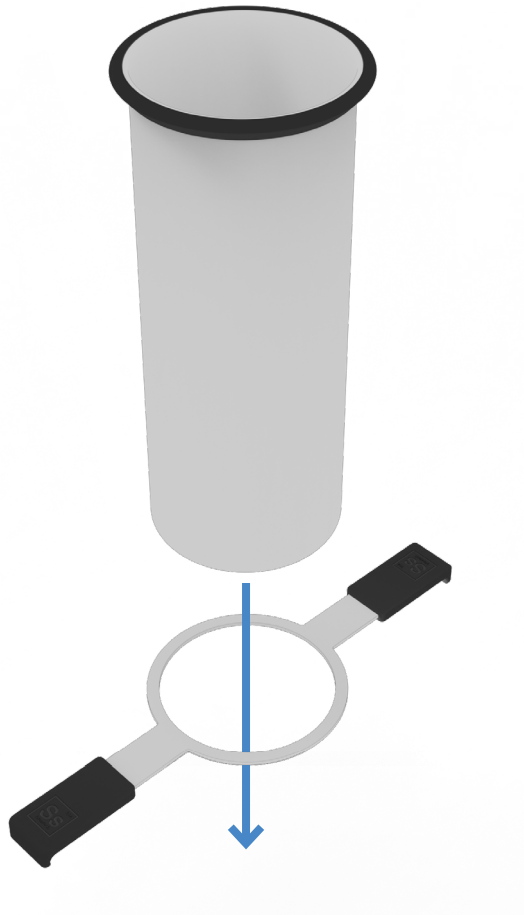

4. The Ss Hop Spider is now ready for use!

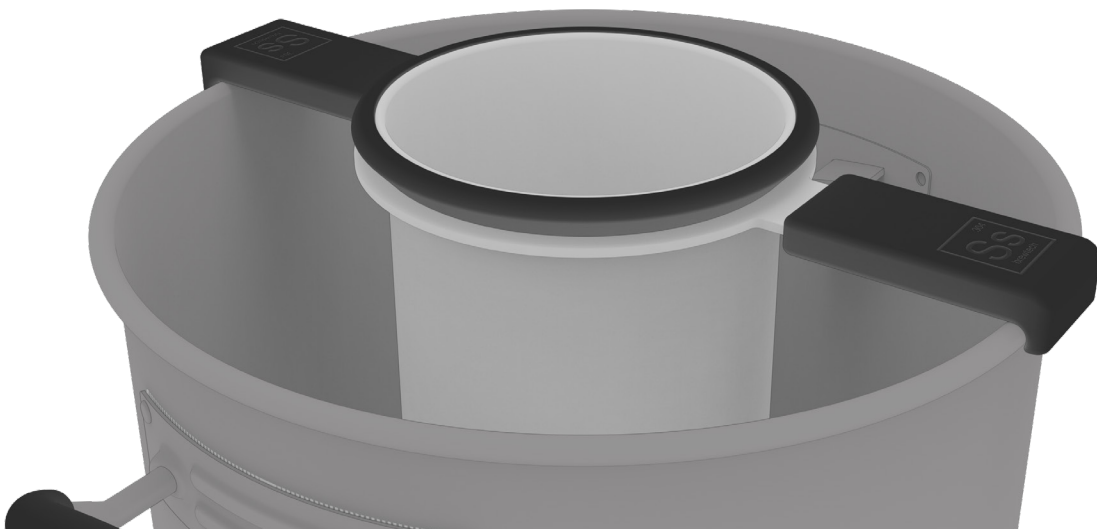

INSTRUCTIONS

Operation

To use the Ss Hop Spider, carefully place the assembly so that the Upper Support spans the middle of the kettle and the Adjustment Arms are secure and snug on the top edge. The Hop Spider Basket should hang into the kettle with the lowest point submerged in liquid.

According to your recipe, add hops by dropping them into the opening of the hop spider. A wooden or plastic spoon may be useful to stir the hops to allow them to become fully submerged. Once you are finished using the Hop Spider, you can grab the Hop Spider Basket by the Lifting Ring to pull it up and out of the kettle and the Upper Support and dispose of the hop material inside.

Cleaning

To clean the Ss Hop Spider, remove as much of the hop material by dumping it out into a trash can or compost container. Then spray the Hop Spider Basket with hot water to remove any residual hop matter from the assembly. As part of a regular cleaning regimen after use, wash the interior surfaces of your Ss Hop Spider with an alkali cleaner such as PBW at a ratio of 0.75 ounce per gallon.



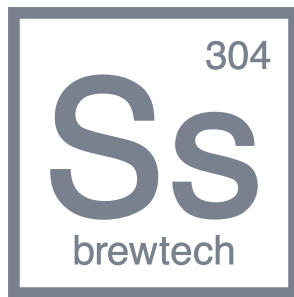

SsBrewtech.com