



Brazed Plate Heat Exchanger's



Model

B3-16A-20	(20 Plate)
Heat Exchange Area	0.288Sq,m
Operating Pressure (Mpa)	1.0 -1.5
Test Pressure (Mpa)	2.0
Brazing medium	99% Copper
Max operating Temp	225°

Model

B3-16A-30	(30 Plate)
Heat Exchange Area	0.432Sq,m
Operating Pressure (Mpa)	1.0 -1.5
Test Pressure (Mpa)	2.0
Brazing medium	99% Copper
Max operating Temp	225°

Flow Direction F3 - F1 & F2 - F4

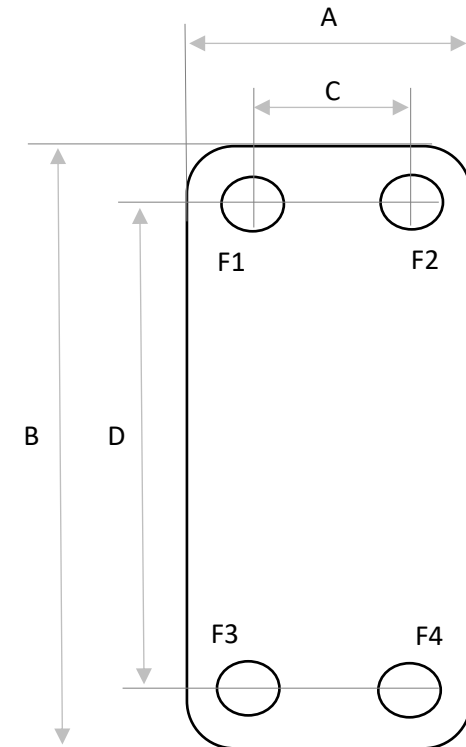

A	88mm
B	218mm
C	52mm
D	182mm

Suitable for water / Water Glycol solutions
Refrigerants other than Amonia