

## TR-TC2 INSTRUCTIONS

### FROST THERMOSTAT

Frost thermostat gas filled bellows operating, SPDT or SPST contacts, is particularly suitable for commercial premises besides applications in the field of home industrial heating and air conditioning.

**ASSEMBLY** - The thermostat must be assembled at approx. 1.5 m. from the floor, in a zone reflecting the medium room temperature.

Avoid the installation in zones where there is air stagnation, near the doors, the windows, heat sources and so on.

**INSTALLATION** - Remove the cover by releasing clip "C". Fix the device to the wall by means of two screws, max. diam. 3.5 mm, using the holes (B-B) provided in the base.  
N.B. The thermostat is for use on fixed wiring only.

### ELECTRICAL CONNECTIONS-

Thread the cables through the slot of the base; make the connections to the terminals as shown here

### TECHNICAL DATA

Contacts rating: 10 (2.5) A / 250V-  
Temperature range: -5° / 15°C  
Differential:  $\Delta 1.0-4K/0.8K$   
Protection class: 1  
Degree of protection: IP 20  
Number of automatic cycles: II (100,000)  
Temperature rate of change: 1K/15min.  
Switch action: 2B

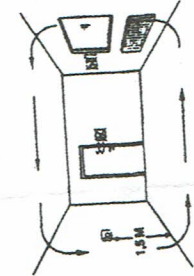
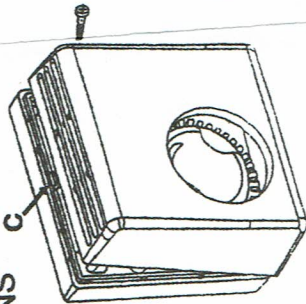
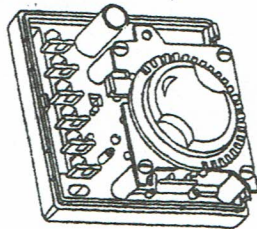
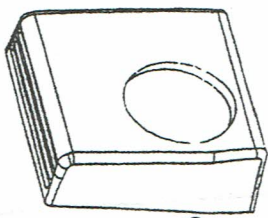

OPTIONAL FOR LIMITING  
TEMPERATURE RANGE  
OR LOCKING SET  
TEMPERATURE

