

# GRIPPS®

## GRIPPS Technical Specification Sheet:

### GRIPPS® Lockjaw Riggers Bag Models: H02106



**H02106**  
Lockjaw Riggers Bag  
**Max Load (D-Ring):** 2.5kg | 5.5lbs  
**Max Load (Pouch):** 5.0kg | 11lbs

#### FOR PRODUCT SUPPORT CONTACT:

support@gripps.com | +61 3 8383 9458

WWW.GRIPPS.COM

## GRIPPS® Lockjaw Riggers Bag

### SAFETY INFORMATION

**⚠️ WARNING** Before using the GRIPPS® Lockjaw Riggers Bag, read all provided safety information pertaining to the use of your Dropped Tool Prevention (DTP) device. **FAILURE TO DO SO COULD RESULT IN INJURY OR DEATH.**

The user of a DTP device bears the responsibility of reading all safety information contained herein. Keep this manual for future reference.

#### Intended Use:

When used properly, the GRIPPS® Lockjaw Riggers Bag can prevent workplace hazards resulting from dropped tools. These may include personal injury and material damage.

GRIPPS® does not approve use of this device for any activities not described in the User Instructions. This device is not intended to be used in any recreational activity, as a personal fall-arrest device or in any other manner not described herein.

**⚠️ WARNING** Misuse of this device could result in serious injury or death.

Adhere to all manufacturer recommendations regarding the operation and maintenance of this device. For additional information, contact GRIPPS® customer support.

Read and adhere to the following in order to ensure correct operational functionality:

- Your DTP should never be used as a personal fall-arrest device or restraint system.
- Do not use this device with tools that exceed the specified maximum load/weight.
- A DTP device used in applications that exceed the limits of operation specified by the manufacturer should be considered unsafe and should be replaced.
- Do not tether a tool over 2.5kg/5.5lbs directly to your clothing or person.
- Inspect your DTP device before each use.
- Ensure the DTP device is securely connected to a load rated tool connector or anchor point before use.
- Inspect any tool connector point before it is connected to the DTP device.
- Modification of the DTP device voids all warranties and violates manufacturer recommendations.
- Do not use a tool that cannot be connected to your DTP in the manner specified by GRIPPS®.
- It is unsafe to extend the length of the DTP product by any means.
- Do not use this product if it will create an unsafe working environment.
- Use extra precaution around moving machinery, moving parts, electrical hazards, extreme temperatures, chemical hazards, or combustion hazards.
- Avoid contact between the E-Tether and rough or sharp edges.
- All connected tools and equipment, including connection points, must be compatible for use with this DTP device.
- Always wear appropriate personal protective equipment.

- If a tether has arrested a dropped tool or object, it should be taken out of service and replaced.
- All procedures shown in this instruction are for GRIPPS® Lockjaw Riggers Bag product only.

### GENERAL USE AND CARE

This practical tool bag packs a heap of features that make tool organisation, access and storage a breeze.

Featuring a robust metal snap frame built into the zip, the Lockjaw Riggers Bag can be locked open or closed, allowing you to access all contents of the bag without having to work around a flimsy lid.

Suited for a variety of small objects and hand tools, the inner lining features a variety of pouches, pockets and sleeves to keep everything at hand and organised.

#### Recommended Use of GRIPPS® Lockjaw Riggers Bag:

1. Use the Lockjaw Climbers Bag for transporting tools, equipment and/or objects with a combined weight of up to 10kg/22lbs.
2. Ensure that all contents are individually tethered to the integrated Tether Anchor D-Rings prior to commencing works.
3. The Metal-Snap opening should remain open only when inserting or removing contents from the bag, after which it should be zipped closed whilst works continue.
4. Only use the handle for transporting the bag at ground level, never use it as an anchoring point.
5. Ensure carabiner goes through both loops (either top or bottom) on the Lockjaw Climbers Bag.
6. Always connect the Rope Access Tool Bag directly to your harness.

#### Before Use:

Thoroughly inspect your GRIPPS® DTP device before each use. Do not use any component that presents deformities or deterioration. Before use: Thoroughly clean tool of any soiling and grease prior to application

### HOW TO USE / INSTRUCTIONS:

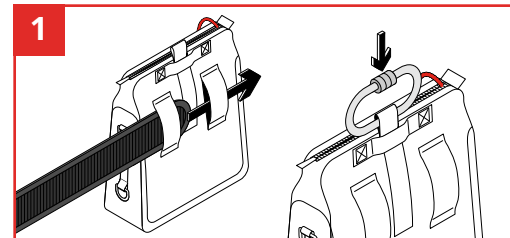

For applying to a work belt, feed work belt through rear loops and then secure belt to your waistline. Alternatively attach a carabiner to top loop, threading carabiner through and secure carabiner for harness work.

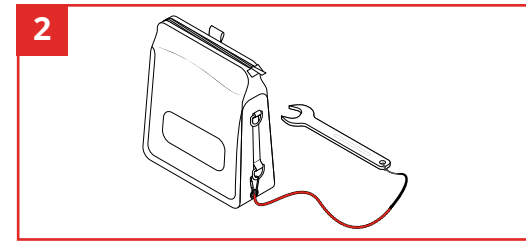

Connect your tool tethers to the D-Rings as required. Use the bag for holding or transporting loads. Only connect additional tethers to the load rated D-Rings.

**\* NEVER EXCEED MAX LOAD OF 2.5KG / 5.5LBS.**

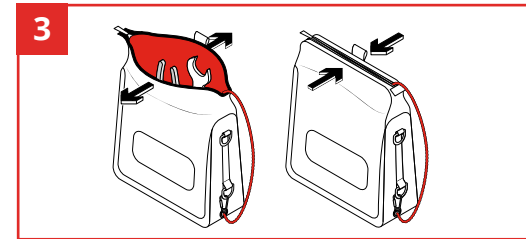

To operate the metal-snap mechanism, pull the opening apart and the closure will automatically spring open and lock into place.

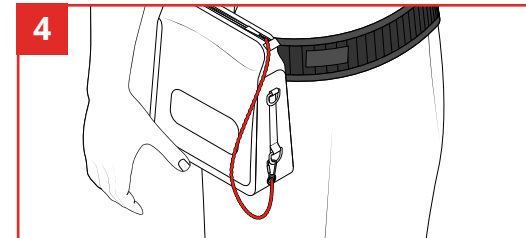

Ensure that the closure is zipped closed when not in use to prevent spills.

#### After Use Care:

Clean and inspect the Lockjaw Riggers Bag and connected tool. For tougher stains, use warm water and a mild soap or detergent. Do not use again until dry.

Store in a clean and dry environment. Proper care will help to ensure that it will operate effectively and extend its service.

# GRIPPS®



linkedin.com/company/grippsglobal



facebook.com/grippsglobal



youtube.com/@gripps3480grippsglobal



instagram.com/grippsglobal