

# GRIPPS®

GRIPPS® Technical Specification Sheet.

GRIPPS® Modular Drop Mat  
Model: H01307



**H01307**  
Modular Drop Mat  
**Max Load (D-Ring):** 3.0kg / 6.5lbs  
**ANSI/ISEA 121-2018 COMPLIANT**

**FOR PRODUCT SUPPORT CONTACT:**

support@gripps.com | +61 3 8383 9458

WWW.GRIPPS.COM

## GRIPPS® Modular Drop Mat

### SAFETY INFORMATION

**⚠️ WARNING** Before using the GRIPPS® Modular Drop Mats, read all provided safety information pertaining to the use of your Dropped Tool Prevention (DTP) device. **FAILURE TO DO SO COULD RESULT IN INJURY OR DEATH.**

The user of a DTP device bears the responsibility of reading all safety information contained herein. Keep this manual for future reference.

#### Intended Use:

When used properly, the GRIPPS® Modular Drop Mats can prevent workplace hazards resulting from dropped tools. These may include personal injury and material damage.

GRIPPS® does not approve use of this device for any activities not described in the User Instructions. This device is not intended to be used in any recreational activity, as a personal fall-arrest device or in any other manner not described herein.

**⚠️ WARNING** Misuse of this device could result in serious injury or death.

Adhere to all manufacturer recommendations regarding the operation and maintenance of this device. For additional information, contact GRIPPS® customer support.

**Read and adhere to the following in order to ensure correct operational functionality:**

- Your DTP should never be used as a personal fall-arrest device or restraint system.
- Do not use this device with tools that exceed the specified maximum load/weight.
- A DTP device used in applications that exceed the limits of operation specified by the manufacturer should be considered unsafe and should be replaced.
- Do not tether a tool over 2.5kg/5.5lbs directly to your clothing or person.
- Inspect your DTP device before each use.
- Ensure the DTP device is securely connected to a load rated surface using all available anchor points before use.
- Inspect any tool connector point before it is connected to the DTP device.
- Modification of the DTP device voids all warranties and violates manufacturer recommendations.
- Do not use a tool that cannot be connected to your DTP in the manner specified by GRIPPS®.
- Do not use this product if it will create an unsafe working environment.
- Ensure tethers do not become entangled with other workers, yourself or surrounding objects. Leave enough space between yourself and any hazards so that a tool on a fully extended tether can swing unobstructed should it fall.
- Avoid contact between tethers and rough or sharp edges.
- Use extra precaution around moving machinery, moving parts, electrical hazards, extreme temperatures, chemical hazards, or combustion hazards.
- All connected tools and equipment, including connection points, must be compatible for use with this DTP device.

- Always wear appropriate personal protective equipment.
- If a tether has arrested a dropped tool or object, it should be taken out of service and replaced.
- All procedures shown in this instruction are for GRIPPS® Modular Drop Mat products only.

### GENERAL USE AND CARE

The GRIPPS® Modular Drop Mats provide a safe personal work area for works conducted on Gridmesh or steel grate flooring. Raised edges prevent tools and objects from rolling off the mat, and a reinforced zipper running along each side allows you to connect multiple Modular Drop Mats for even broader coverage.

#### Recommended Use of GRIPPS® Modular Drop Mats:

1. Only use in combination with GRIPPS® Tethers.
2. Compatible with the GRIPPS® Mule Bag for easy transportation.
3. Ensure that tools are tethered to one of the 8, D-Ring Tether Anchor points on the Modular Drop Mat when working at height.
4. Anchor the Modular Drop Mat using all anchors on the bottom side of the mat using Zip Ties.

#### Before Use:

Thoroughly inspect your GRIPPS® DTP device before each use. Do not use any component that presents deformities or deterioration. Inspect all material including the carabiner and tether.

### HOW TO USE / INSTRUCTIONS:

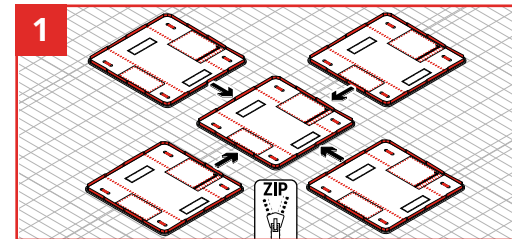

To connect multiple Modular Drop Mats together, align zips on both Modular Drop Mats and zip end-to-end.

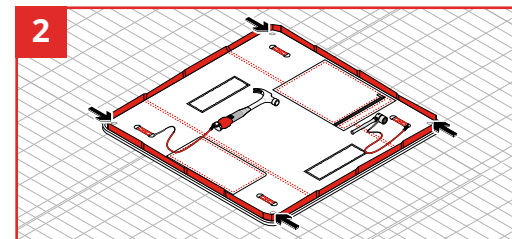

To secure the Modular Drop Mat, use cable ties to secure all of the eyelets to the workplace.

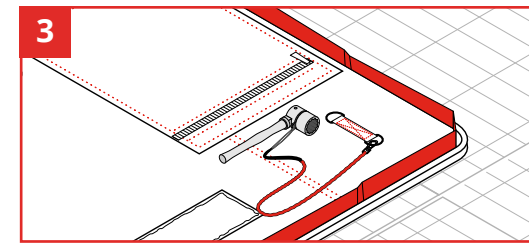

Ensure that tools are tethered to one of the 8 D-Ring anchor points on the Modular Drop Mat when working at height.

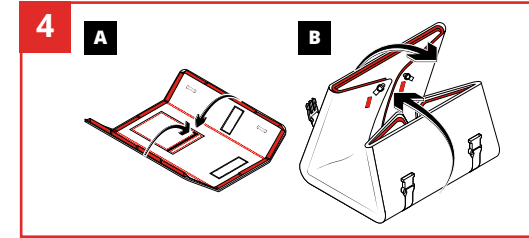

Once folded and secured, connect to the GRIPPS® Mule Bag using the carabiners and Mule Bag D-Rings for easy transportation.

# GRIPPS®



linkedin.com/company/grippsglobal



facebook.com/grippsglobal



youtube.com/@gripps3480grippsglobal



instagram.com/grippsglobal